

## 7. Knock Sensor

### A: REMOVAL

- 1) Disconnect the ground cable from battery.

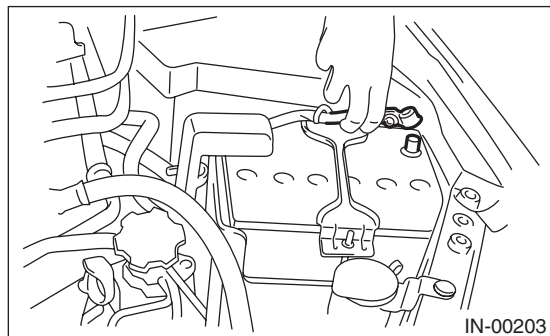

- 2) Remove the intercooler. <Ref. to IN(w/o STI)-12, REMOVAL, Intercooler.>
- 3) Disconnect the connector from the knock sensor.

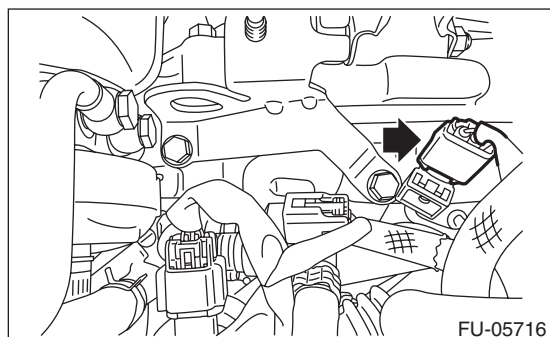

- 4) Remove the knock sensor from cylinder block.

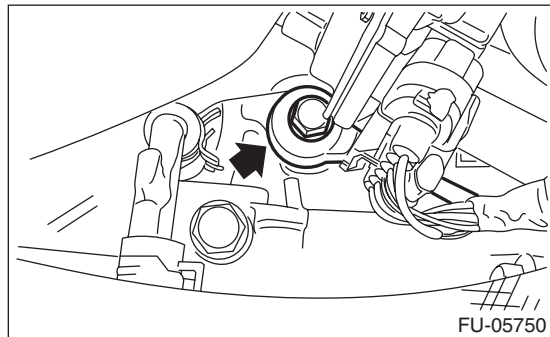

### B: INSTALLATION

- 1) Install the knock sensor to the cylinder block.

#### NOTE:

The portion of the knock sensor cord that is pulled out must be positioned at a 60° angle relative to the engine rear.

#### Tightening torque:

**24 N·m (2.4 kgf-m, 17.7 ft-lb)**

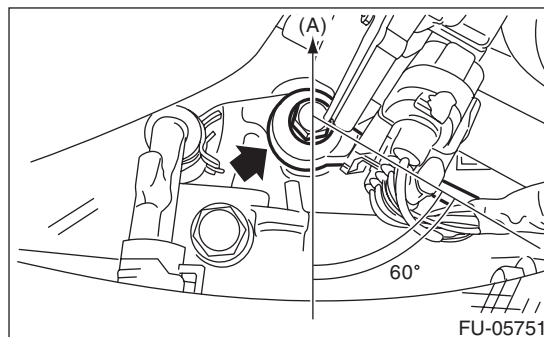

(A) Front side of vehicle

- 2) Connect the connector to the knock sensor.

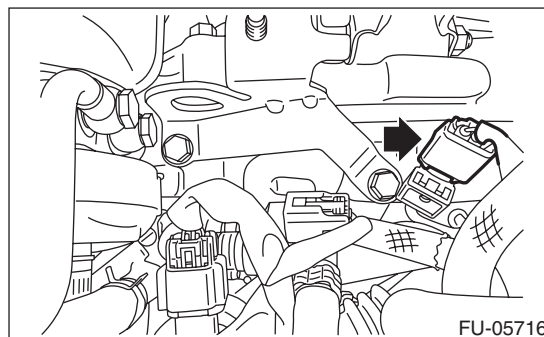

- 3) Install the intercooler. <Ref. to IN(w/o STI)-12, INSTALLATION, Intercooler.>
- 4) Connect the battery ground terminal.

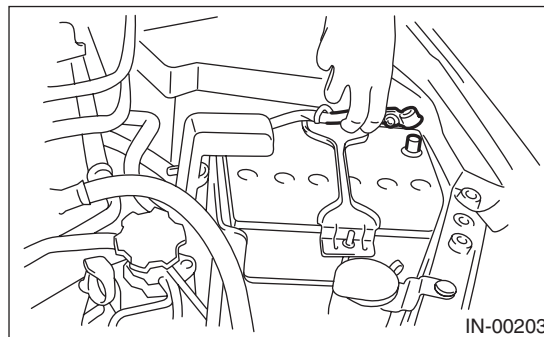

# Knock Sensor

## FUEL INJECTION (FUEL SYSTEMS)

### C: INSPECTION

- 1) Check that the knock sensor has no deformation, cracks or other damages.
- 2) Measure the resistance between knock sensor terminals.

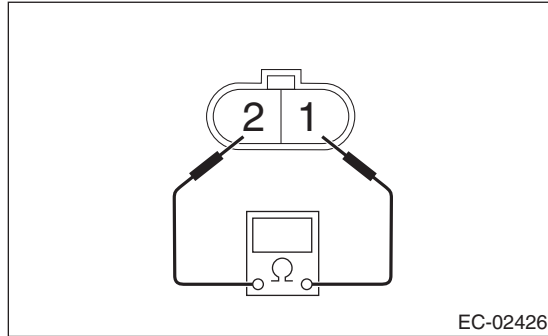

| Terminal No. | Standard                     |
|--------------|------------------------------|
| 1 and 2      | $560 \pm 28 \text{ k}\Omega$ |