

22. Fuel Pump Control Unit

A: REMOVAL

1) Disconnect the ground cable from battery.

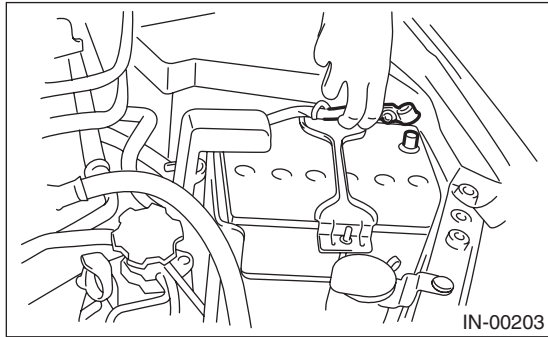

2) Remove the right side trunk side trim. (4 door model) <Ref. to EI-63, REMOVAL, Trunk Room Trim.>

3) Remove the right side rear quarter trim. (5 door model) <Ref. to EI-60, REMOVAL, Rear Quarter Trim.>

4) Disconnect the connector (A) from the fuel pump control unit, and remove the fuel pump control unit.

- 4 door model

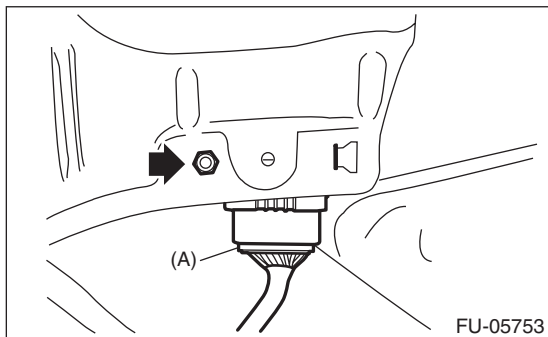

- 5 door model

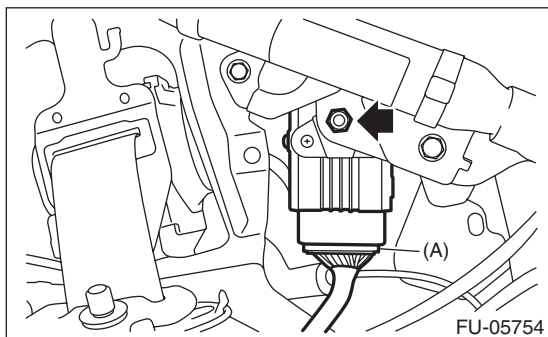

B: INSTALLATION

Install in the reverse order of removal.

Tightening torque:

5 N·m (0.5 kgf-m, 3.7 ft-lb)

C: INSPECTION

Check that the fuel pump control unit has no deformation, cracks or other damages.