

11. Fuel Injector

A: REMOVAL

1. RH SIDE

1) Release the fuel pressure. <Ref. to FU(STI)-67, RELEASING OF FUEL PRESSURE, PROCEDURE, Fuel.>

2) Disconnect the ground cable from battery.

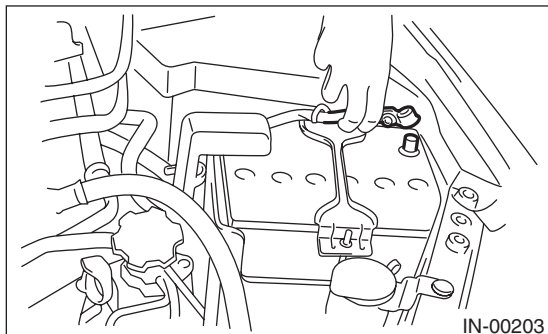

3) Open the fuel filler lid and remove the fuel filler cap.

4) Remove the intake manifold. <Ref. to FU(STI)-17, REMOVAL, Intake Manifold.>

5) Remove clip (A) holding the engine harness to the fuel pipe protector RH, and remove the fuel pipe protector RH from the intake manifold.

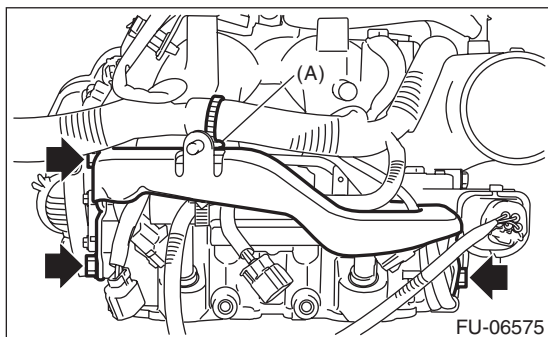

6) Remove the harness band (A) which holds the engine harness to the fuel injector pipe RH.

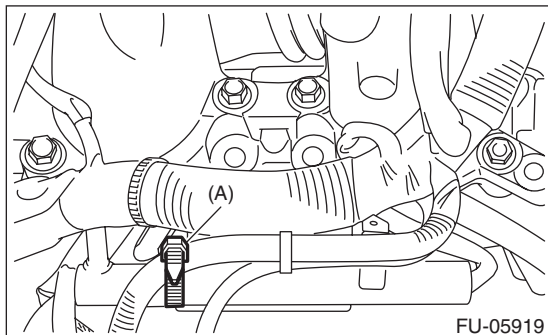

7) Disconnect the connector from fuel injector.

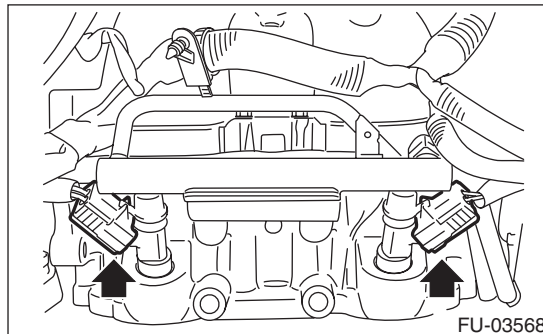

8) Remove the bolts which hold fuel injector pipe RH.

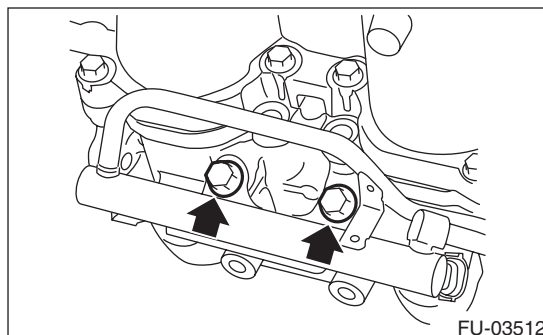

9) Remove the fuel injector.

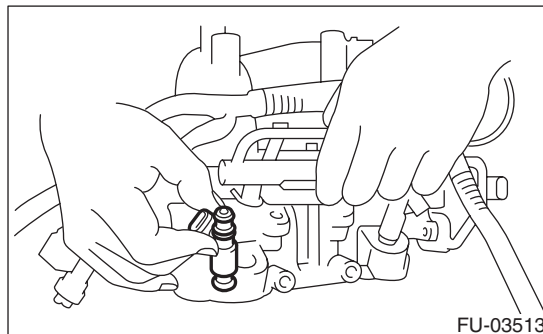

Fuel Injector

FUEL INJECTION (FUEL SYSTEMS)

2. LH SIDE

1) Release the fuel pressure. <Ref. to FU(STI)-67, RELEASING OF FUEL PRESSURE, PROCEDURE, Fuel.>

2) Disconnect the ground cable from battery.

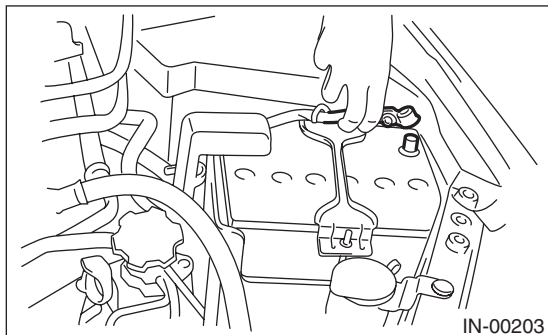

3) Open the fuel filler lid and remove the fuel filler cap.

4) Remove the intake manifold. <Ref. to FU(STI)-17, REMOVAL, Intake Manifold.>

5) Remove the fuel pipe protector LH from the intake manifold.

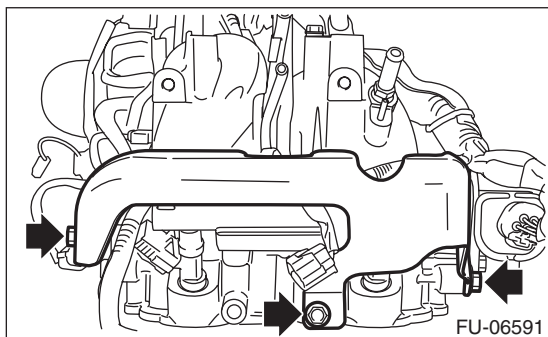

6) Remove the harness band (A) which holds the engine harness to the fuel injector pipe LH.

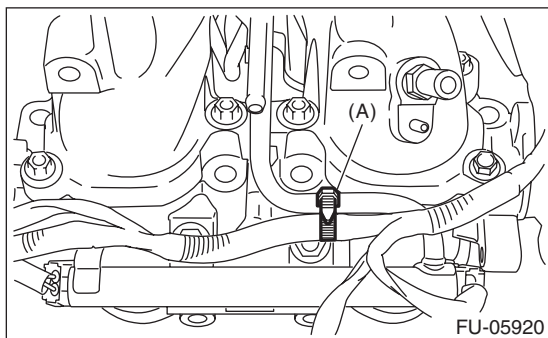

7) Disconnect the connector from fuel injector.

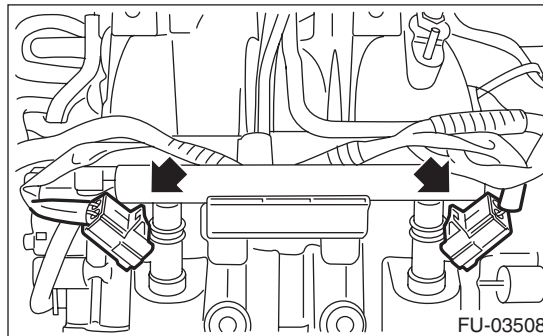

8) Remove the bolts which hold fuel injector pipe LH.

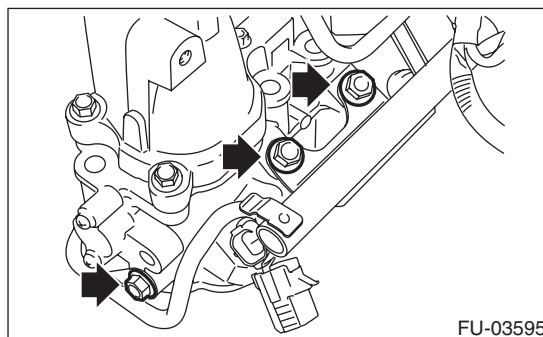
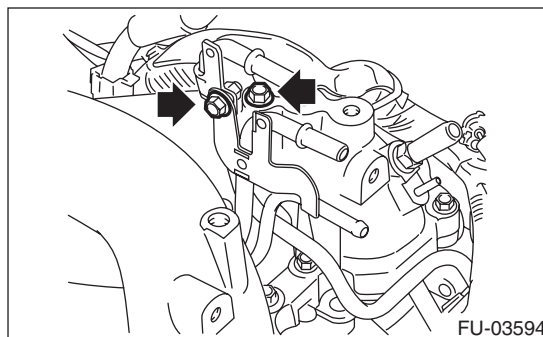

9) Remove the fuel injector.

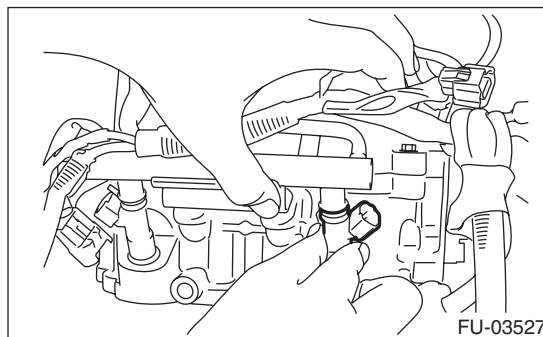

B: INSTALLATION

1. RH SIDE

Install in the reverse order of removal.

NOTE:

Use new O-rings.

Tightening torque:

19 N·m (1.9 kgf-m, 14.0 ft-lb)

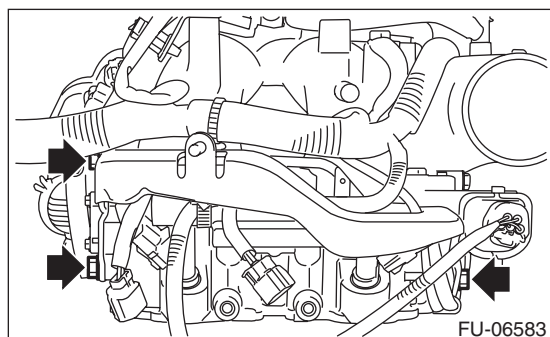
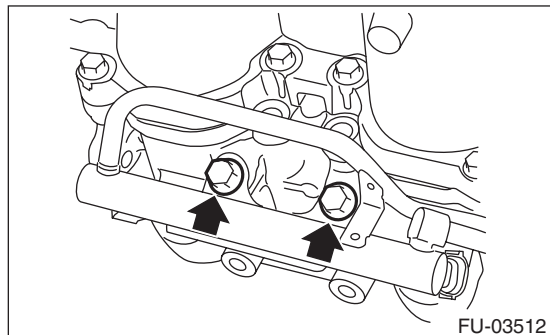

2. LH SIDE

Install in the reverse order of removal.

NOTE:

Use new O-rings.

Tightening torque:

6.4 N·m (0.7 kgf-m, 4.7 ft-lb)

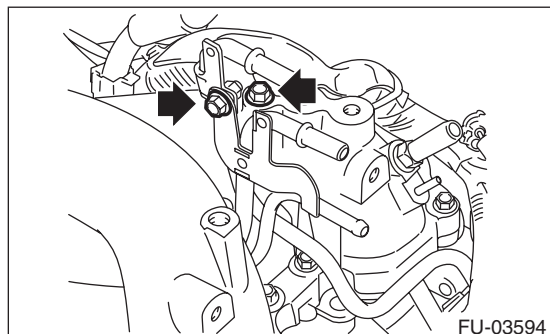

Tightening torque:

19 N·m (1.9 kgf-m, 14.0 ft-lb)

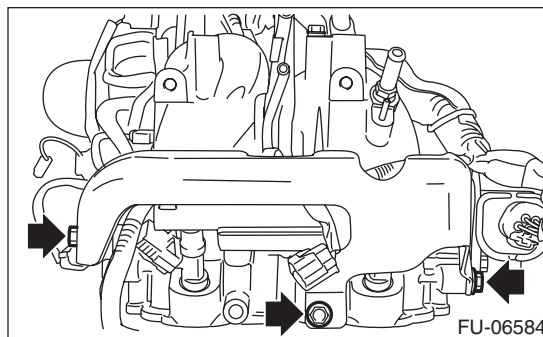
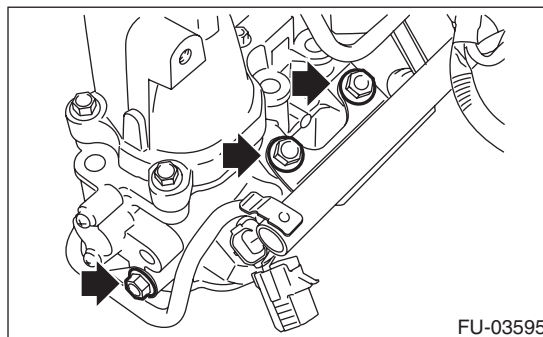

C: INSPECTION

- 1) Check that the fuel injector has no deformation, cracks or other damages.
- 2) Measure the resistance between fuel injector terminals.

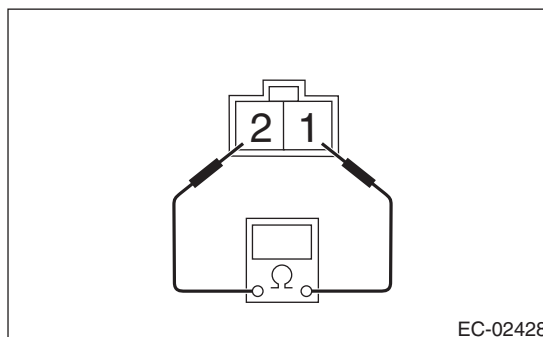

Terminal No.	Standard
1 and 2	Approx. 12.0 Ω (when 20°C (68°F))