

# Tire Pressure Monitoring System

## WHEEL AND TIRE SYSTEM

### 4. Tire Pressure Monitoring System

#### A: REMOVAL

##### 1. TRANSMITTER (SNAP IN TYPE)

- 1) Remove the wheels from the vehicle. <Ref. to WT-4, REMOVAL, Tire and Wheel.>
- 2) Remove the tires from wheels.

##### CAUTION:

**Use a tire changer when removing the tire from the wheel.**

- 3) Loosen the screw to remove the transmitter from the valve stem.

##### NOTE:

Replace the valve and screw with a new part when reusing transmitter.

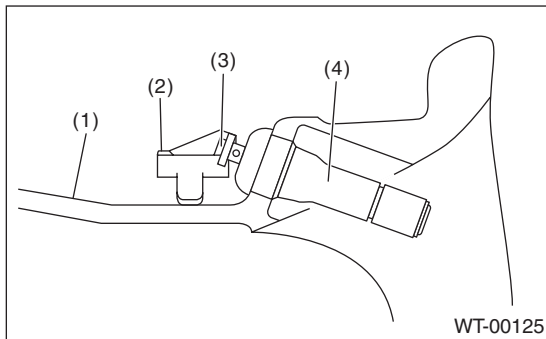

- (1) Wheel
- (2) Transmitter
- (3) Screw
- (4) Valve

- 4) Remove the valve from the wheel.

##### 2. TPMS & KEYLESS ENTRY CONTROL MODULE

##### NOTE:

TPMS control module is integrated into keyless entry control module.

- 1) Disconnect the ground cable from battery.
- 2) Remove the left rear quarter trim. (5 door model) <Ref. to EI-60, REMOVAL, Rear Quarter Trim.>
- 3) Remove the rear shelf trim. (4 door model) <Ref. to EI-62, REMOVAL, Rear Shelf Trim.>
- 4) Disconnect the harness connector.

- 5) Remove the bolt and then remove the TPMS & keyless entry control module.

- 5 door model

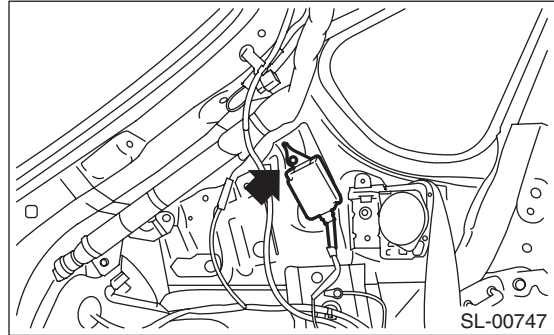

- 4 door model

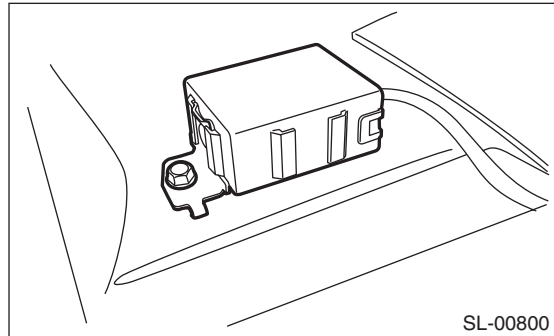

#### B: INSTALLATION

##### 1. TRANSMITTER (SNAP IN TYPE)

##### CAUTION:

**Use the new transmitter assembly or replace the new valve and screw, when installing.**

- 1) Replace the valve and screw with a new part when reusing transmitter.

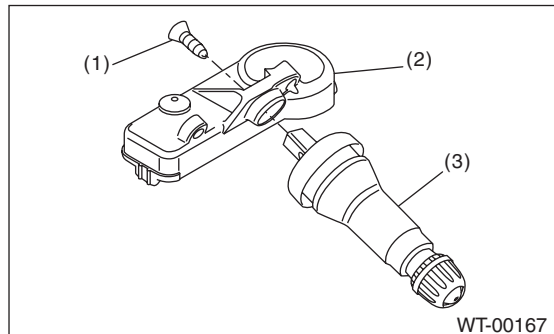

- (1) Screw
- (2) Transmitter
- (3) Valve

##### Tightening torque:

**1.4 N·m (0.14 kgf-m, 1 ft-lb)**

2) Install the transmitter to the wheel by aligning it with valve hole.

## NOTE:

When using the jig that pulls the valve cap by hooking its neck part, use another short-type cap.

3) Install the tires to wheels.

## CAUTION:

- Use a tire changer when installing tire to wheel.
- To prevent damaging the transmitter, set the tire changer boom in the position as shown in the figure.

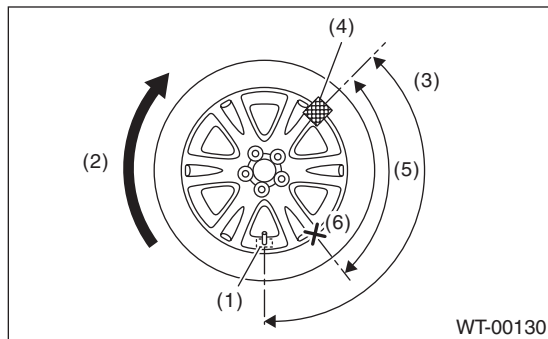

- (1) Transmitter
- (2) Direction of turn table rotation
- (3) 135°
- (4) Tire changer boom
- (5) 90°
- (6) Starting point for fitting the bead to the rim

4) Install the wheels to vehicle. <Ref. to WT-4, INSTALLATION, Tire and Wheel.>

5) Register the transmitter ID to the TPMS & keyless entry control module. <Ref. to TPM(diag)-9, REGISTER TRANSMITTER ID, OPERATION, Subaru Select Monitor.>

## 2. TPMS & KEYLESS ENTRY CONTROL MODULE

Install each part in the reverse order of removal.

### Tightening torque:

**13 N·m (1.33 kgf-m, 9.6 ft-lb)**

## C: ADJUSTMENT

Re-register the transmitter ID when transmitter has been replaced. <Ref. to TPM(diag)-9, REGISTER TRANSMITTER ID, OPERATION, Subaru Select Monitor.>

Re-register the keyless transmitter when TPMS & keyless entry control module has been replaced. <Ref. to SL-49, REGISTRATION OF KEYLESS TRANSMITTER WITH SUBARU SELECT MONITOR, REPLACEMENT, Transmitter.>