

General Description

WHEEL AND TIRE SYSTEM

1. General Description

A: SPECIFICATION

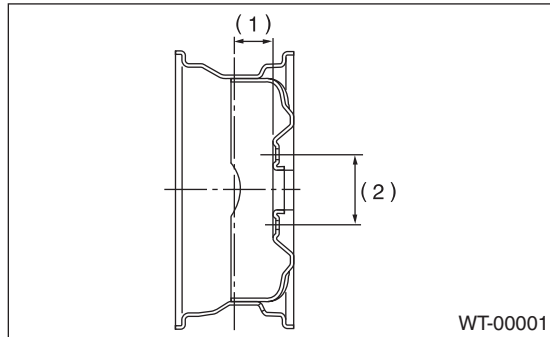

- (1) Inset
(2) P.C.D.

Model		Tire size	Wheel size	Inset mm (in)	P.C.D. mm (in)	Tire inflation pressure kPa (kgf/cm ² , psi)	
						Front wheel	Rear wheel
STI model	Standard type	245/40R18 93W	18 × 8 ¹ / ₂ J	55 (2.17)	114.3 (4.50)	*1	
	“T-type” Tire	T135/70D17 102M	17 × 4T	30 (1.18)			
Except for STI model	Standard type	235/45R17 94W	17 × 8J	53 (2.09)	100 (3.94)		
	“T-type” Tire	T135/70D17 102M	17 × 4T	30 (1.18)			

*1: Size and inflation pressure of the standard equipment tire, spare tire for emergency and appropriate tire for equipment are described on the "Tire inflation pressure" label attached to the body side of the driver's door.

NOTE:

"T-type" tire for temporary use is equipped as a spare tire.

1. SERVICE DATA

Part	Axial runout	Radial runout
Steel wheel	1.5 mm (0.059 in)	
Aluminum wheel	1.0 mm (0.039 in)	

B: COMPONENT

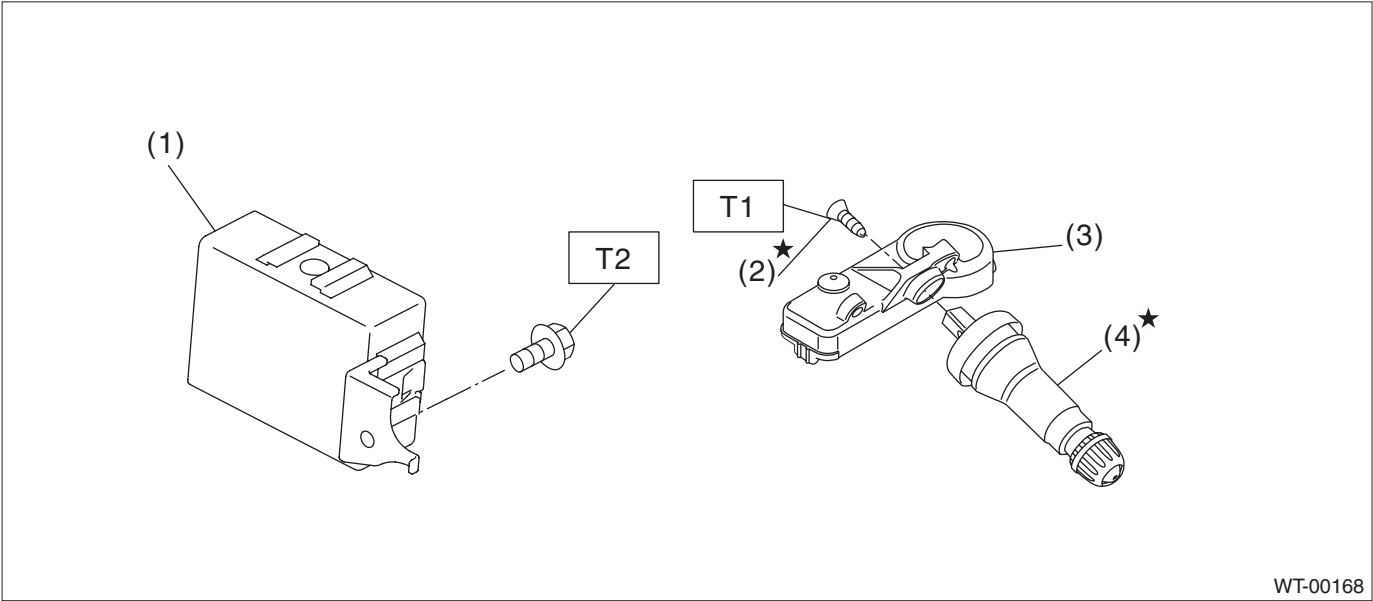

- (1) TPMS & keyless entry control module
- (2) Screw
- (3) Transmitter (snap in type)
- (4) Valve

Tightening torque: N·m (kgf·m, ft·lb)

T1: 1.4 (0.14, 1)

T2: 13 (1.33, 9.6)

C: PREPARATION TOOL

1. GENERAL TOOL

TOOL NAME	REMARKS
Air pressure gauge	Used for measuring tire air pressure.
Dial gauge	Used for measuring wheel runout.