

5. Rear Brake Pad

A: REMOVAL

1. BREMBO TYPE

- 1) Lift up the vehicle, and then remove the rear wheels.
- 2) Remove clips (1).

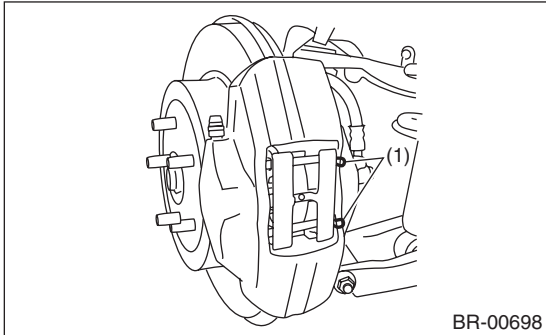

- 3) Remove the pad pins (1) and cross spring (2).

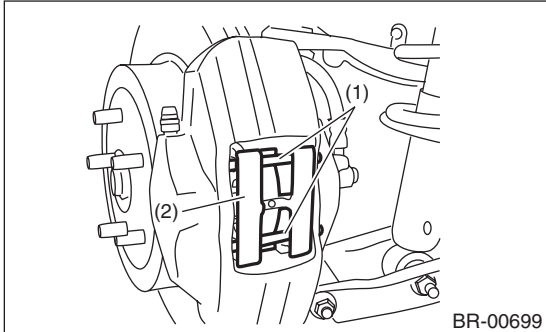

- 4) Spread apart the pads using a pair of wrenches and push back the piston.
- 5) Remove the pads.

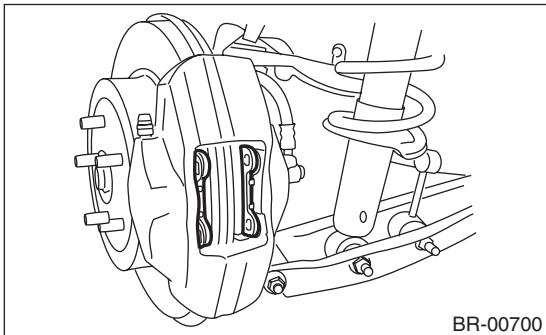

2. EXCEPT FOR BREMBO TYPE

- 1) Lift up the vehicle, and then remove the rear wheels.
- 2) Remove the brake hose bracket.

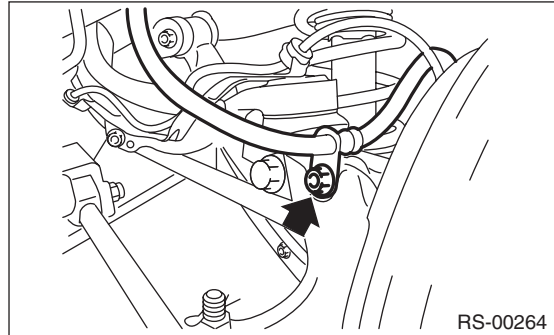

- 3) Remove the caliper bolt.

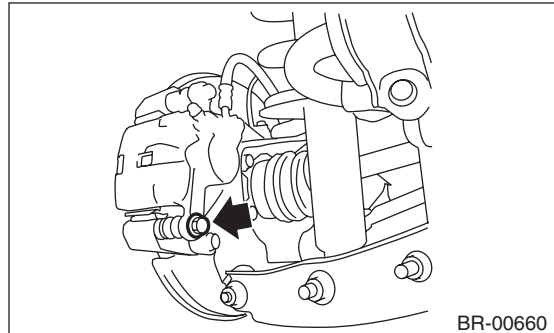

- 4) Raise the caliper body and support it.

NOTE:

Do not disconnect the brake hose from the caliper body.

- 5) Remove the pads.

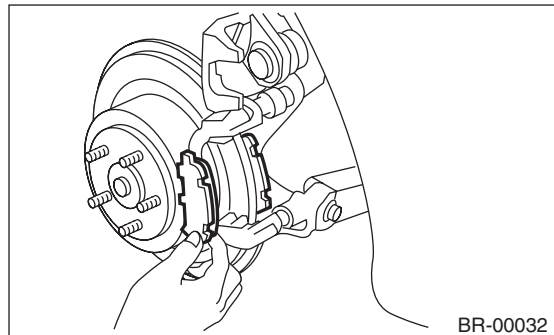

B: INSTALLATION

1. BREMBO TYPE

1) Apply a thin coat of Molykote M7439 or grease contained in the pad kit to the pad side.

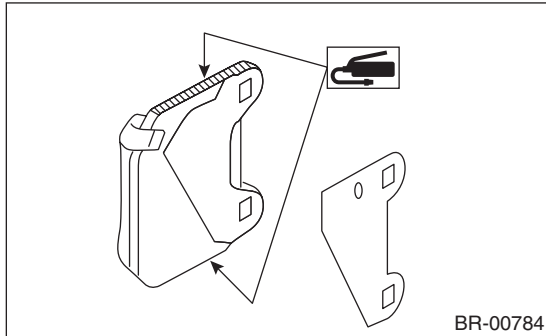

2) Apply a thin coat of Molykote AS880N (Part No. K0777YA010) or the grease contained in the pad kit to the contact surface between the pad and pad shim.

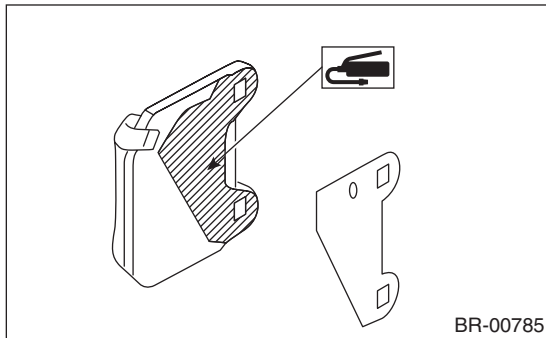

- 3) Install the pads to the caliper body.
- 4) Install the cross spring and pad pins.
- 5) Install the clips.

2. EXCEPT FOR BREMBO TYPE

1) Apply a thin coat of Molykote M7439 or grease contained in the pad kit to the pad clip.

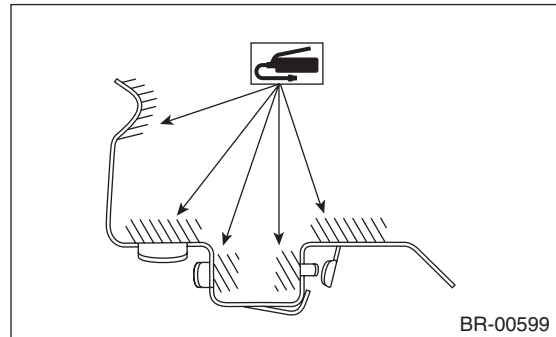

2) Apply a thin coat of Molykote AS880N (Part No. K0777YA010) or grease contained in the pad kit between the outer pad and shim.

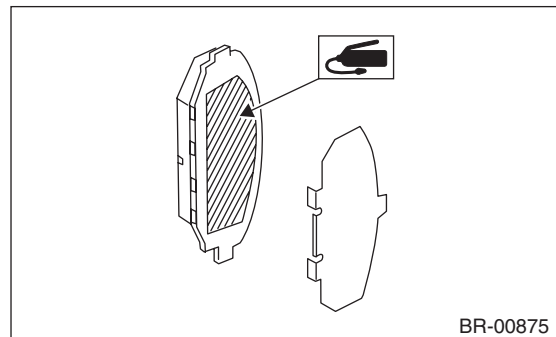

3) Apply a thin coat of Molykote AS880N (Part No. K0777YA010) or grease contained in the pad kit to both surfaces of the inner pad inner shim.

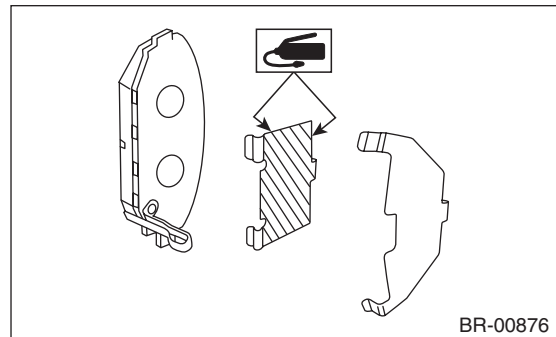

- 4) Install the pad to support.
- 5) Install the caliper body to the support.

Tightening torque:

27 N·m (2.75 kgf-m, 19.9 ft-lb)

- 6) Install the brake hose bracket.

Tightening torque:

33 N·m (3.36 kgf-m, 24.3 ft-lb)

C: INSPECTION

Check the pad thickness A.

- Brembo type

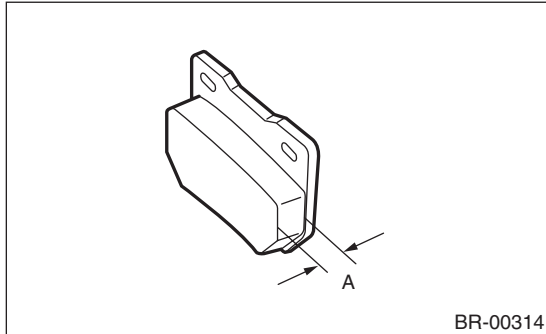

Pad thickness A mm (in)	Standard	9.0 (0.354)
	Wear limit	1.2 (0.047)

- Except for brembo type

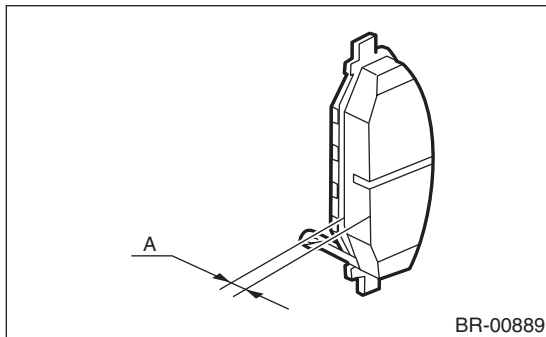

Pad thickness A mm (in)	Standard	9.0 (0.354)
	Wear limit	1.5 (0.059)

NOTE:

- Always replace the pads of both wheels and both sides as a set.
- Replace the cross spring and pad pins if they are twisted or worn. (Brembo type)
- A wear indicator is installed on the outer disc brake pad. (Brembo type)
- Wear indicators are installed on the inner and outer disc brake pads. (Except for brembo type)
- If the pad is worn to the limit, the end of wear indicator contacts disc rotor, and a squeaking sound is heard as the wheel rotates. If the sound is heard, replace the pad.
- Replace the pad if there is oil or grease on it.