

## 3. Glass Lid

### A: REMOVAL

- 1) Open the sunshade.
- 2) Remove the TORX® bolt, and then remove the glass lid carefully.

#### CAUTION:

- The thread locker is applied to the TORX® bolts, so use the new parts once they are removed.
- Be careful not to damage the glass lid.

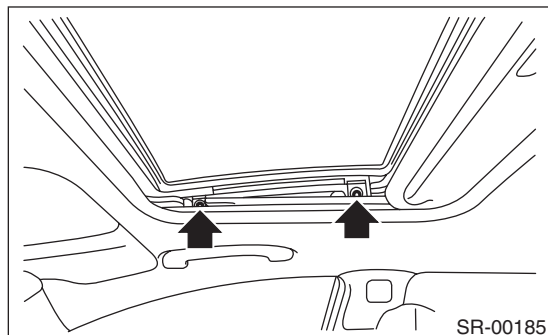

### B: INSTALLATION

Install each part in the reverse order of removal.

#### Tightening torque:

Refer to “COMPONENT” of “General Description”. <Ref. to SR-2, COMPONENT, General Description.>

### C: ADJUSTMENT

- 1) Open the sunshade.
- 2) Loosen the glass lid mounting TORX® bolts (A), and then adjust the height by moving the lid side.

**Difference in height between glass lid and roof panel L:**

**$0.75 \pm 1.0 \text{ mm } (0.03 \pm 0.04 \text{ in})$**

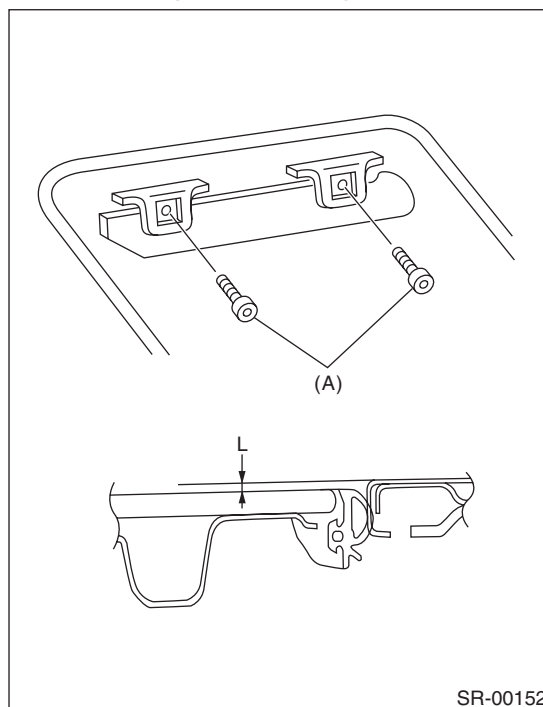

### D: FORCED DRIVE

#### CAUTION:

After a forced operation, make sure to perform an initialize operation. <Ref. to SR-4, INSPECTION, Sunroof Control System.>

#### NOTE:

If the glass lid does not operate or is not supplied with power, move the glass lid using the hexagon wrench.

- 1) Remove the spot map light. <Ref. to LI-33, REMOVAL, Spot Map Light.>
  - 2) Insert the hexagon wrench securely until it touches the motor shaft end.
  - 3) Turn the hexagon wrench, and move the glass lid.
- Turning right, the glass lid open.
  - Turning left, the glass lid close.

