

Ignition Key Lock

SECURITY AND LOCKS

16. Ignition Key Lock

A: REPLACEMENT

- 1) Disconnect the ground cable from battery.
- 2) Remove the steering column. <Ref. to PS-16, REMOVAL, Steering Column.>
- 3) Secure the steering column in a vise. Remove the bolt with a drill.

CAUTION:

Do not apply any impact to the set bolt by a chisel or punch.

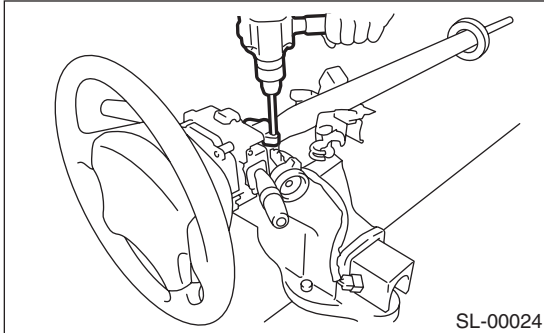

- 4) Remove the ignition key lock.
- 5) Use new bolts. Tighten the bolt until the bolt head is broken (bolt head wrenched off).

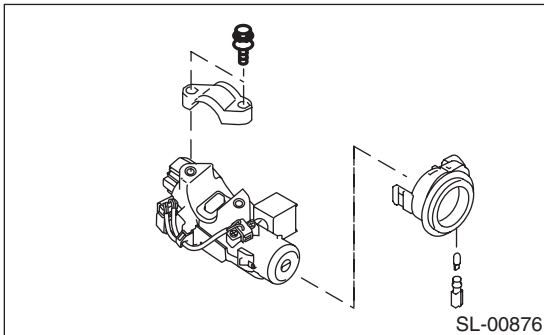

B: INSPECTION

- 1) Remove the instrument panel lower cover.
- 2) Remove the lower column cover.
- 3) Unfasten the fixing clip which secures harness, and then disconnect the connector of the ignition switch from body harness.
- 4) Turn the ignition key plate to each position and check the resistance between ignition connector terminals.

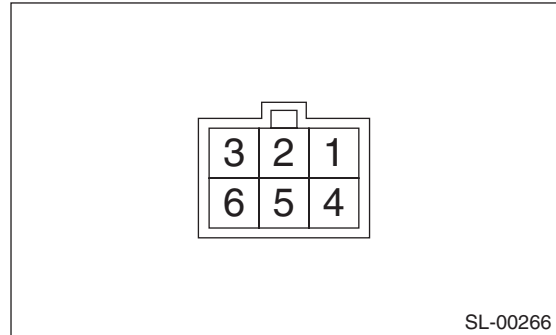

Switch position	Terminal No.	Standard
LOCK	—	—
ACC	3 and 5	Less than 1 Ω
ON	3 and 1 and 4 3 and 5	Less than 1 Ω
ST	3 and 2 3 and 1 and 6	Less than 1 Ω

- 5) Replace the ignition switch if the inspection result is not within the standard value.