

12.Headlight Assembly

A: REMOVAL

WARNING:

Because the headlight system uses high voltage, be careful not to perform work with wet hands. There is a possibility of electrical shock.

CAUTION:

The HID headlight uses very high voltages for the lighting circuit. Make sure that the power is turned OFF before working.

- 1) Disconnect the ground cable from battery.
- 2) Remove the clips and remove the air intake duct. (When removing the headlight RH)

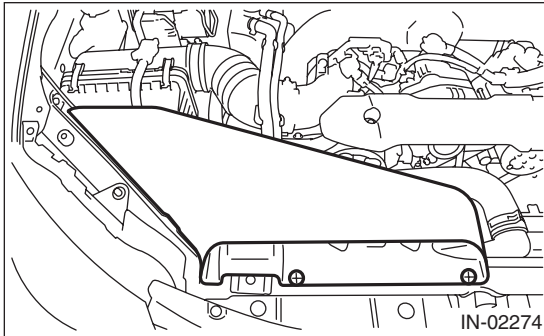

- 3) Remove the front bumper face. <Ref. to EI-31, FRONT BUMPER FACE, REMOVAL, Front Bumper.>
- 4) Disconnect harness connectors.
- 5) Remove the bolts and clips, and remove the headlight assembly.

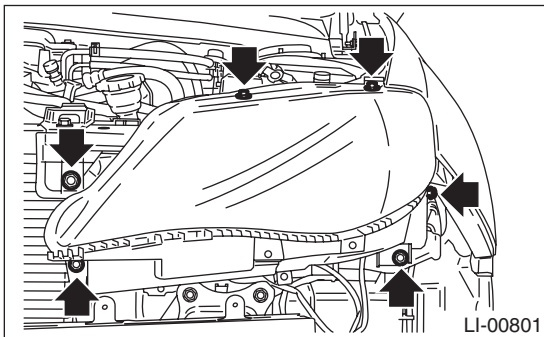

B: INSTALLATION

- 1) Install each part in the reverse order of removal.

Tightening torque:

7.5 N·m (0.76 kgf·m, 5.5 ft·lb)

- 2) Adjust the headlight beam and fog light beam.
 - Adjust the headlight beam. <Ref. to LI-16, HEADLIGHT BEAM ADJUSTMENT, ADJUSTMENT, Headlight Assembly.>
 - Adjust the fog light beam. (Model with fog light) <Ref. to LI-21, FOG LIGHT AIMING, ADJUSTMENT, Front Fog Light Assembly.>

C: DISASSEMBLY

1. HID HEADLIGHT BALLAST

WARNING:

Because the headlight system uses high voltage, be careful not to perform work with wet hands. There is a possibility of electrical shock.

CAUTION:

• The HID headlight uses very high voltages for the lighting circuit. Make sure that the power is turned OFF before working.

• Do not leave the headlight without the ballast for a long time. Dust, moisture, etc. entering the headlight may affect its performance.

- 1) Disconnect the ground cable from battery.
- 2) Remove the headlight assembly. <Ref. to LI-15, REMOVAL, Headlight Assembly.>
- 3) Remove the back cover.

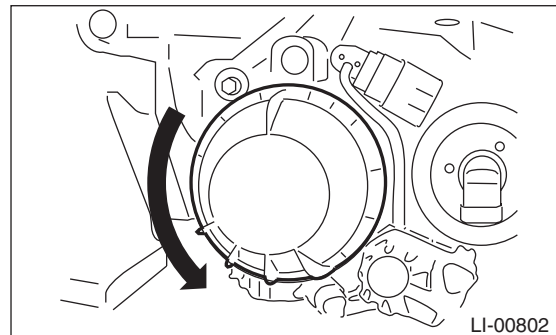

- 4) Disconnect the bulb connector.

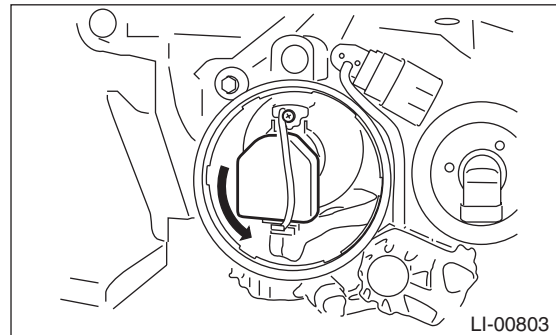

- 5) Remove the harness connector and screws to pull out the ballast.

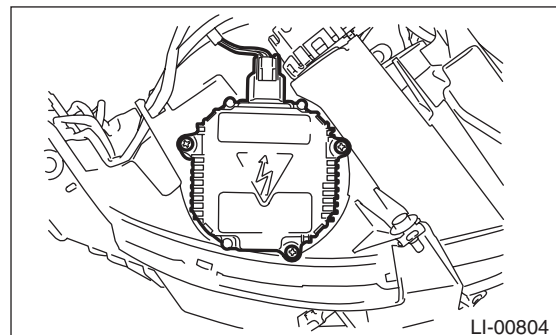

Headlight Assembly

LIGHTING SYSTEM

6) Remove the harness connector and screws on the back to remove the headlight ballast.

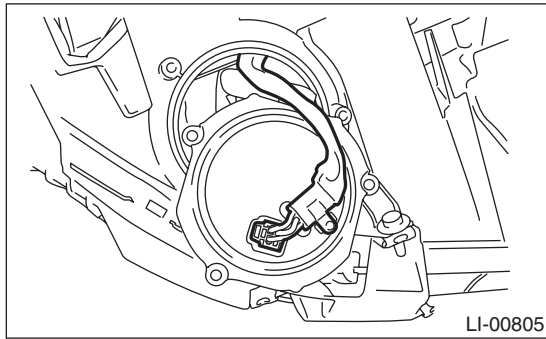

D: ASSEMBLY

1. HID HEADLIGHT BALLAST

CAUTION:

- When installing the ballast cover, be sure to install the gasket.
- After installing the ballast to the vehicle, be sure to perform beam adjustment.

Assemble each part in the reverse order of disassembly.

Tightening torque:

1.3 N·m (0.13 kgf-m, 0.96 ft-lb)

NOTE:

Adjust the projector lens to near the center of the extension opening before installing the ballast. This makes the beam adjustment work easier.

E: ADJUSTMENT

1. HEADLIGHT BEAM ADJUSTMENT

CAUTION:

Turn off the light before adjusting the headlight beam level. If it is necessary to inspect the beam level, do not keep the light on for two minutes or more.

1) Before checking the headlight beam level, be sure of the following:

- The area around the headlight has not sustained any scratches, damage or other type of deformation.
- Vehicle is parked on a level surface.
- The inflation pressure of tires is correct.
- Vehicle's fuel tank is fully filled.

2) For vehicle with a manual leveler, set the headlight beam leveler switch to the "0" position.

3) Bounce the vehicle several times to normalize the suspension.

4) Make certain that someone is seated in the driver's seat.

5) Measure the distance between the low beam bulb centers and the height of the bulb center.

6) Turn the headlights on and then adjust the low beam pattern.

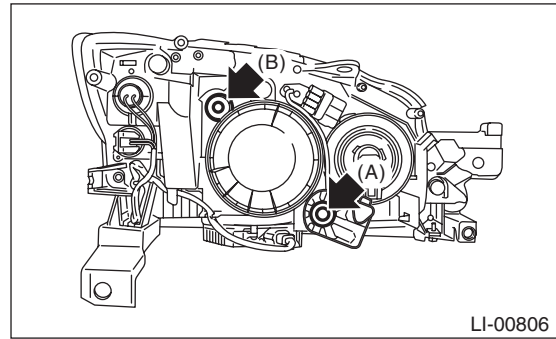

(1) Adjust the vertical beam level (A).

(2) Adjust the horizontal beam level (B).

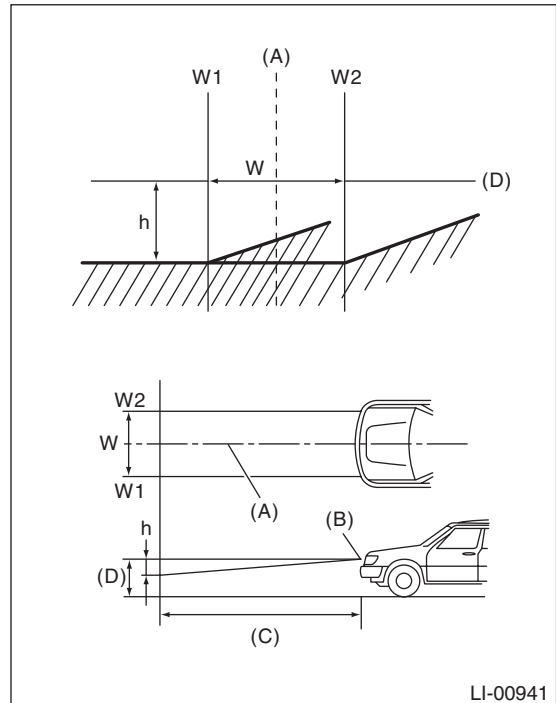

(A) Vehicle center

(B) Bulb center marking

(C) 3 m (10 ft)

(D) Height of headlight center

W mm (in)	h mm (in) at 3 m (10 ft)
1,160 (45.67)	30 (1.18)