

26.Heater Duct

A: REMOVAL

1. REAR HEATER DUCT

- 1) Remove the heater and cooling unit. <Ref. to AC-36, REMOVAL, Heater and Cooling Unit.>
- 2) Remove the front seats. <Ref. to SE-6, REMOVAL, Front Seat.>
- 3) Remove the lower inner trim (front). <Ref. to EI-57, REMOVAL, Lower Inner Trim.>
- 4) Pull off the floor mat to remove the rear heater duct center (A) and rear heater duct LH, RH (B).

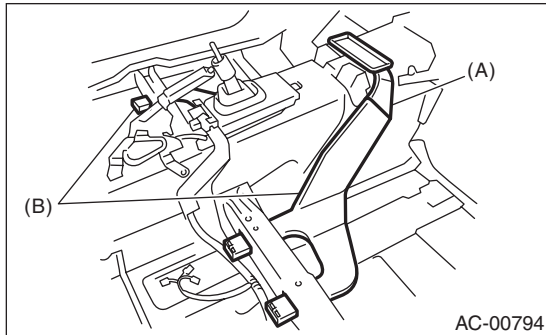

B: INSTALLATION

Install each part in the reverse order of removal.