

## 27. Roof Trim

### A: REMOVAL

#### 1. 5 DOOR MODEL

- 1) Disconnect the ground cable from battery.
- 2) Remove the spot map light. <Ref. to LI-33, REMOVAL, Spot Map Light.>
- 3) Remove the room light. <Ref. to LI-34, REMOVAL, Room Light.>
- 4) Remove the sun visor. <Ref. to EI-64, REMOVAL, Sun Visor.>
- 5) Remove the assist grip. <Ref. to EI-65, REMOVAL, Assist Grip.>
- 6) Remove the upper inner trim. <Ref. to EI-59, REMOVAL, Upper Inner Trim.>
- 7) Remove the rear quarter trim. <Ref. to EI-60, REMOVAL, Rear Quarter Trim.>
- 8) Disconnect the harness connectors of the right and left front pillars, and the rear quarter (LH).
- 9) Remove the sunroof opening trim. (Model with sunroof)

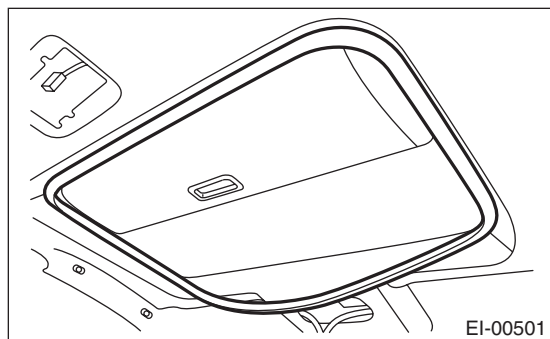

- 10) Remove the clips, and then remove the roof trim.

#### CAUTION:

**Do not remove the roof end trim with excessive force. Otherwise the roof trim may become damaged. Roof trim and roof end trim are fastened by tapping screws.**

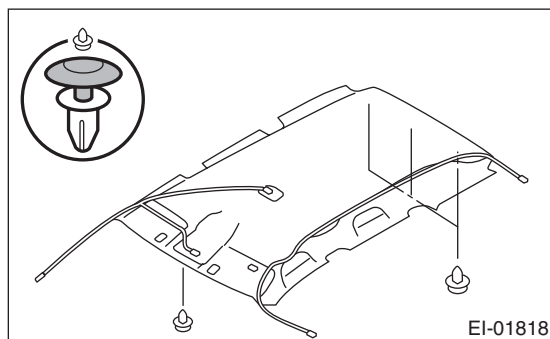

#### 2. 4 DOOR MODEL

#### CAUTION:

**When taking the roof trim out of the vehicle, be careful not to damage the room inner trim. Perform this work with 3 persons.**

- 1) Disconnect the ground cable from battery.
- 2) Apply protective tape, etc. to prevent damage to the face of the instrument panel.
- 3) Remove the spot map light. <Ref. to LI-33, REMOVAL, Spot Map Light.>
- 4) Remove the room light. <Ref. to LI-34, REMOVAL, Room Light.>
- 5) Remove the sun visor. <Ref. to EI-64, REMOVAL, Sun Visor.>
- 6) Remove the assist grip. <Ref. to EI-65, REMOVAL, Assist Grip.>
- 7) Remove the upper inner trim. <Ref. to EI-59, REMOVAL, Upper Inner Trim.>
- 8) Remove the rear quarter trim. <Ref. to EI-60, REMOVAL, Rear Quarter Trim.>
- 9) Disconnect the harness connectors of the right and left front pillars, and the rear quarter (LH).
- 10) Remove the console front panel. <Ref. to EI-52, CONSOLE FRONT PANEL, REMOVAL, Center Console.>

- 11) Remove the steering wheel. <Ref. to PS-13, REMOVAL, Steering Wheel.>
- 12) Remove the passenger's side door trim. <Ref. to EI-45, REMOVAL, Door Trim.>
- 13) Remove the passenger's side door checker.

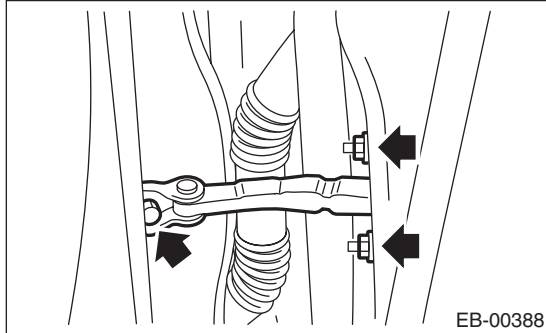

- 14) Fully recline the front seat.
- 15) Remove the sunroof opening trim. (model with sunroof)

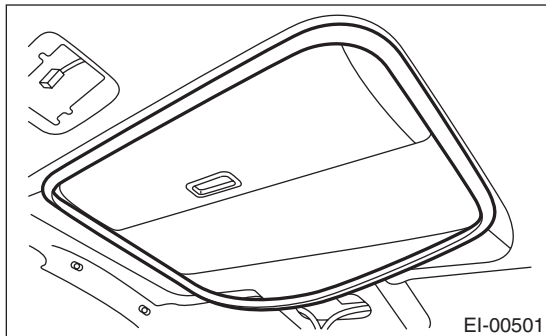

- 16) Remove the clips, and then remove the roof trim.

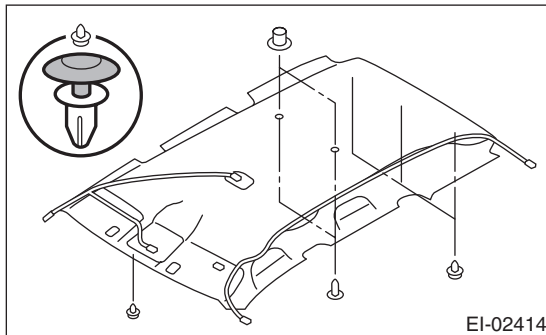

- 17) Open the passenger's side door all the way, and maintain at that position.
- 18) Take out the roof trim from the passenger's side opening.

**NOTE:**

Rotate the roof trim to go through the gap between the front accessory socket and airbag control unit.

# Roof Trim

## EXTERIOR/INTERIOR TRIM

### B: INSTALLATION

1) Apply the roof cord and feeder cord along the mark-off line of the roof trim.

#### CAUTION:

Route and apply each cord so that they pass over the mark-off line. If not doing so, the cord may interfere, thus preventing normal deployment of the curtain airbag when necessary.

#### Tape:

*Use the tape contained in the roof trim replacement parts.*

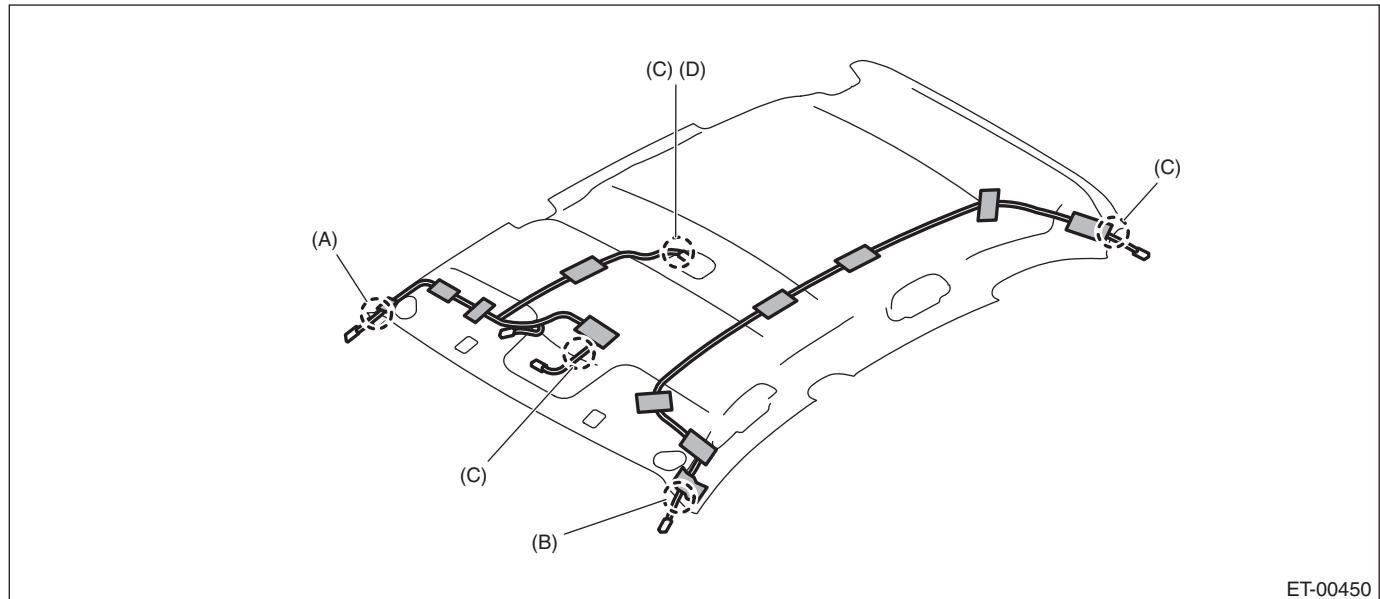

ET-00450

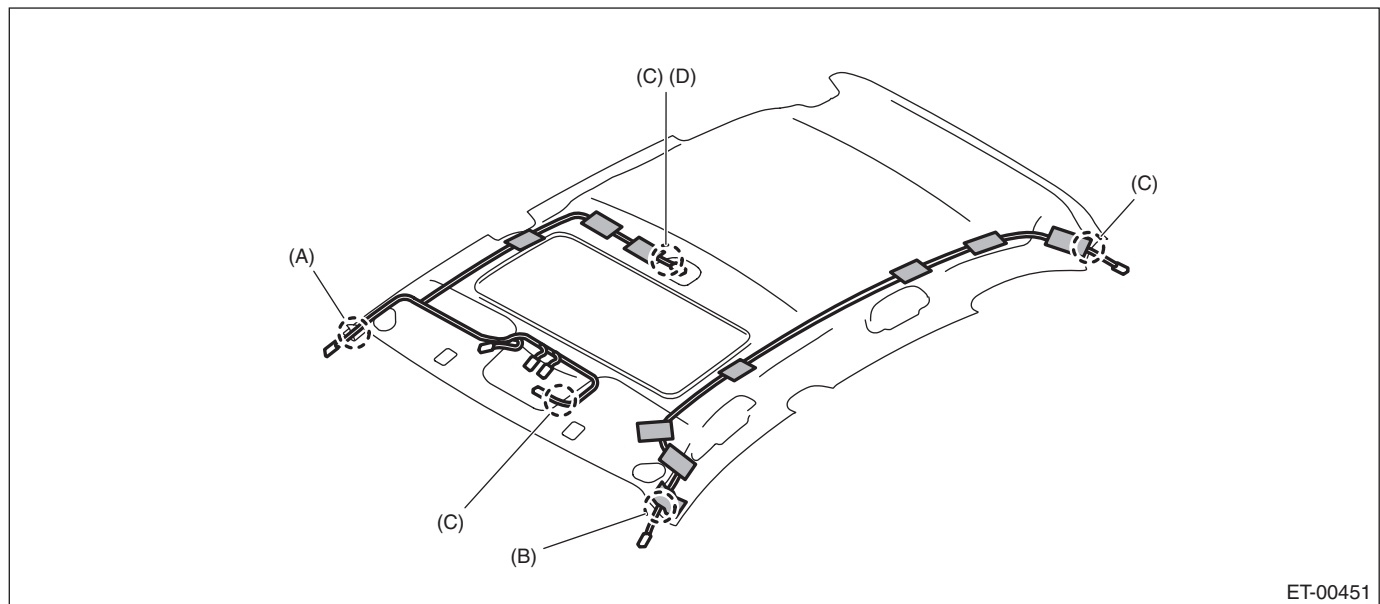

ET-00451

- |  |   |  |
|--|---|--|
| (A) Align the end of roof cord white tape and the end of roof trim, and route the cord along the mark-off line of roof trim, and then affix with tape.   | (C) Align the marking to the roof trim terminal end, and affix with tape. | (D) Affix the roof cord end to the patch area of room light. |
| (B) Align the end of feeder cord white tape and the end of roof trim, and route the cord along the mark-off line of roof trim, and then affix with tape. |   |  |

2) Install each part in the reverse order of removal.