

11.Trunk Lid

A: REMOVAL

1. TORSION BAR

- 1) Open the trunk lid.
- 2) Using the ST, remove the torsion bar from the hinge link.

CAUTION:

During removal and installation, handle the torsion bar carefully, because it will generate reactive force.

Preparation tool: REMOVER (927780000)

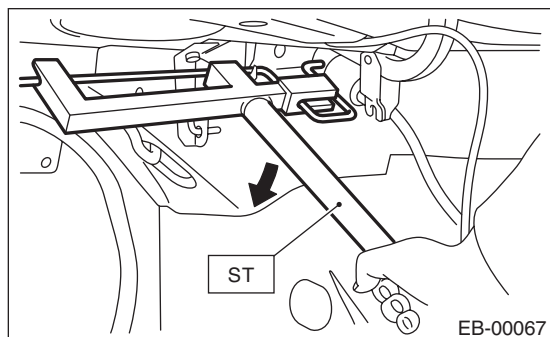

- 3) Remove the torsion bars RH/LH.

2. TRUNK LID ARM

- 1) Disconnect the ground cable from battery.
- 2) Open the trunk lid to remove the trunk room trim. <Ref. to EI-63, REMOVAL, Trunk Room Trim.>
- 3) Disconnect the trunk lid release cable. <Ref. to SL-38, REMOVAL, Trunk Lid Latch and Actuator Assembly.>
- 4) Disconnect the connectors, and remove the harness clip, etc.
- 5) Remove the trunk lid mounting bolts, to remove the trunk lid panel from the trunk lid arm.

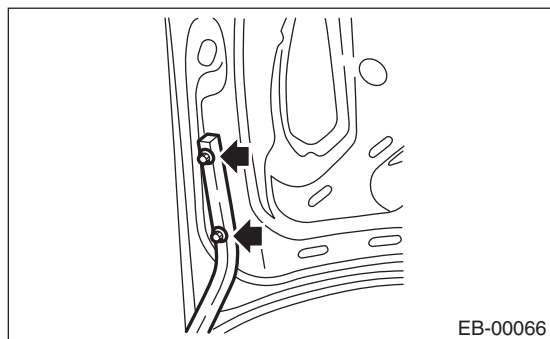

- 6) Remove the torsion bar from the trunk lid hinge link. <Ref. to EB-33, TORSION BAR, REMOVAL, Trunk Lid.>
- 7) Remove the rear shelf trim. <Ref. to EI-62, REMOVAL, Rear Shelf Trim.>

- 8) Remove the bolts, then remove the trunk lid arm.

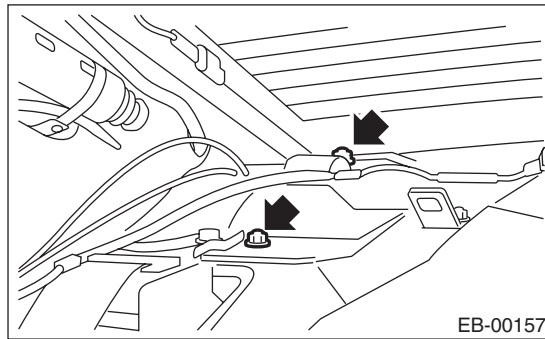

3. TRUNK LID PANEL

- 1) Disconnect the ground cable from battery.
- 2) Disconnect the connector to remove the trunk lid harness.
- 3) Detach the rear spoiler.
 - Small type: <Ref. to EI-42, SMALL TYPE, REMOVAL, Rear Spoiler.>
 - Large type: <Ref. to EI-42, LARGE TYPE, REMOVAL, Rear Spoiler.>

CAUTION:

The trunk panel become lighter after removing the rear spoiler, so be careful when opening/closing the trunk lid.

- 4) Remove the trunk lid latch and actuator assembly. <Ref. to SL-38, REMOVAL, Trunk Lid Latch and Actuator Assembly.>
- 5) Remove the trunk lid garnish. <Ref. to EI-73, REMOVAL, Trunk Lid Garnish.>
- 6) Remove the bolts, then remove the trunk lid panel from the trunk lid arm.

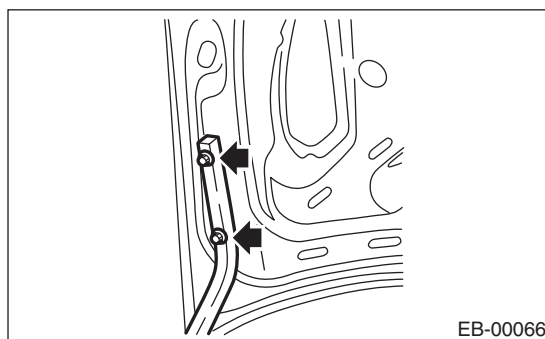

B: INSTALLATION

1) Install each part in the reverse order of removal.

CAUTION:

Make sure that the harness grommet for the license plate light is securely installed on the vehicle. If not properly installed, this may cause water leakage.

2) Apply grease to the rotating area of hinges and the torsion bar.

3) Install while paying attention to make a uniform clearance around the trunk lid panel. For the dimension of clearance, refer to "SPECIFICATION" in "General Description". <Ref. to EB-2, SPECIFICATION, General Description.>

Tightening torque:

Refer to "COMPONENT" of "General Description". <Ref. to EB-13, TRUNK LID PANEL, COMPONENT, General Description.>

C: ADJUSTMENT

For the dimension of panel around the trunk lid panel, refer to "SPECIFICATION" in "General Description". <Ref. to EB-2, SPECIFICATION, General Description.>

1) Adjust the trunk lid panel lateral position.

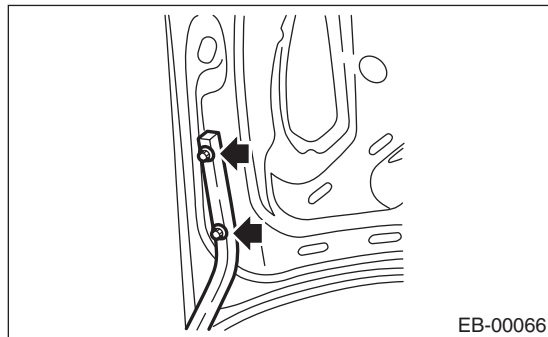

(1) Loosen the mounting bolt.

(2) Align the trunk lid panel lateral panel dimension.

2) Adjust the gap between trunk lid panel and body surface.

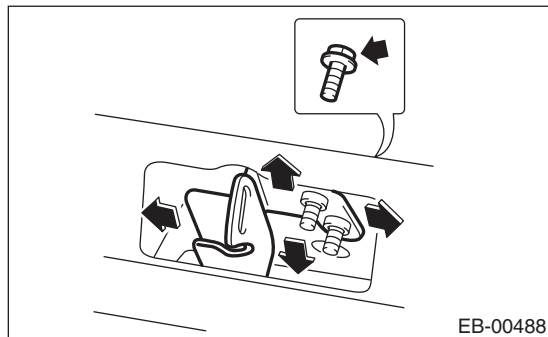

(1) Loosen the bolt.

(2) Tap striker using plastic hammer to adjust the gap between trunk lid panel and body surface.