

9. Airbag Control Module

A: REMOVAL

CAUTION:

- Do not disassemble the airbag control module.
- If the airbag control module is deformed or if there is any trace of water on the module, replace the airbag control module with a new one.
- Do not drop the airbag control module.
- After removal, keep the airbag control module on a dry, clean surface away from moisture, heat and dust.

1) Turn the ignition switch to OFF.

CAUTION:

Disconnect the ground cable from battery and wait for at least 60 seconds before starting work.

NOTE:

On CVT models, shift the select lever into "D" before disconnecting the battery ground cable.

2) Remove the console box assembly.

(1) Release the claws, and then remove the boot - hand brake.

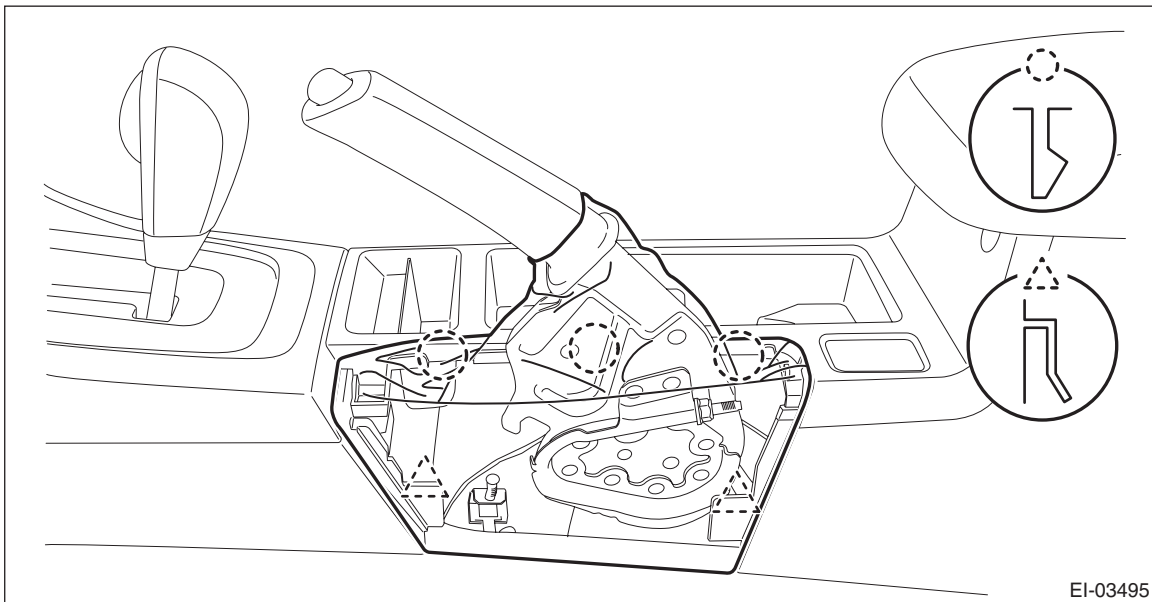

(2) Move the seat forward, and remove the bolts after detaching the left and right caps.

Airbag Control Module

AIRBAG SYSTEM

(3) Remove the screws, disconnect the harness connector and remove the console box assembly.

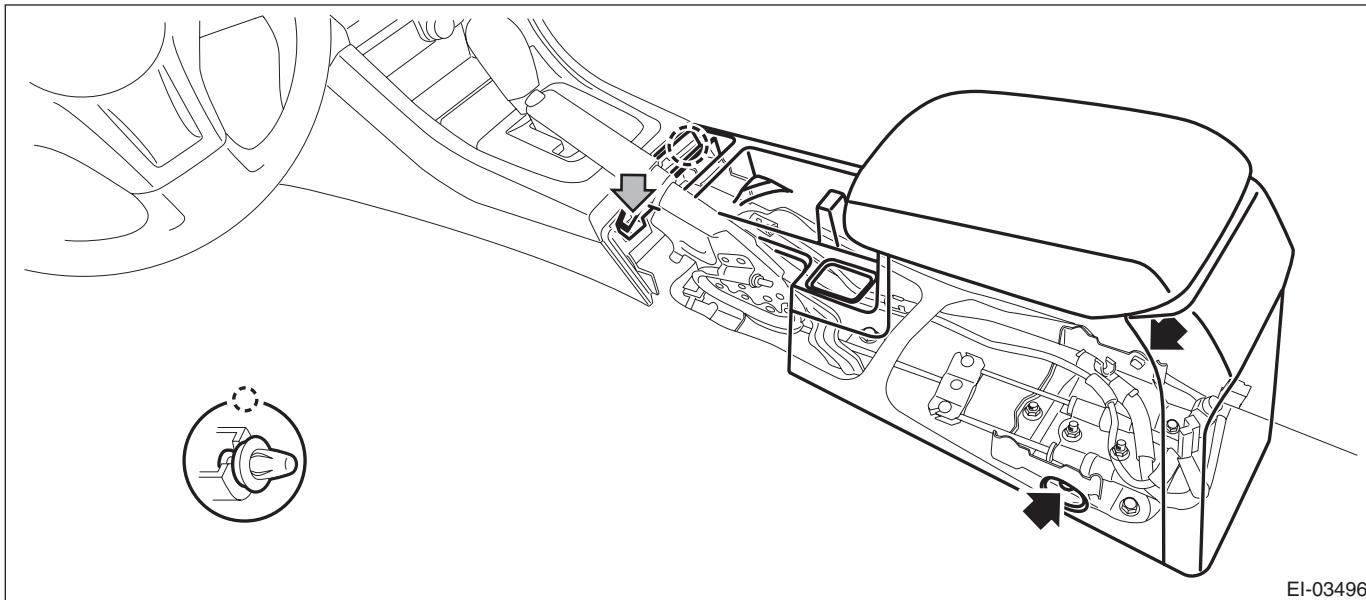

3) Remove the cover - shift lever.

(1) Remove the shift knob. (MT model)

(2) Release the clips and claws, then pull up the cover - shift lever.

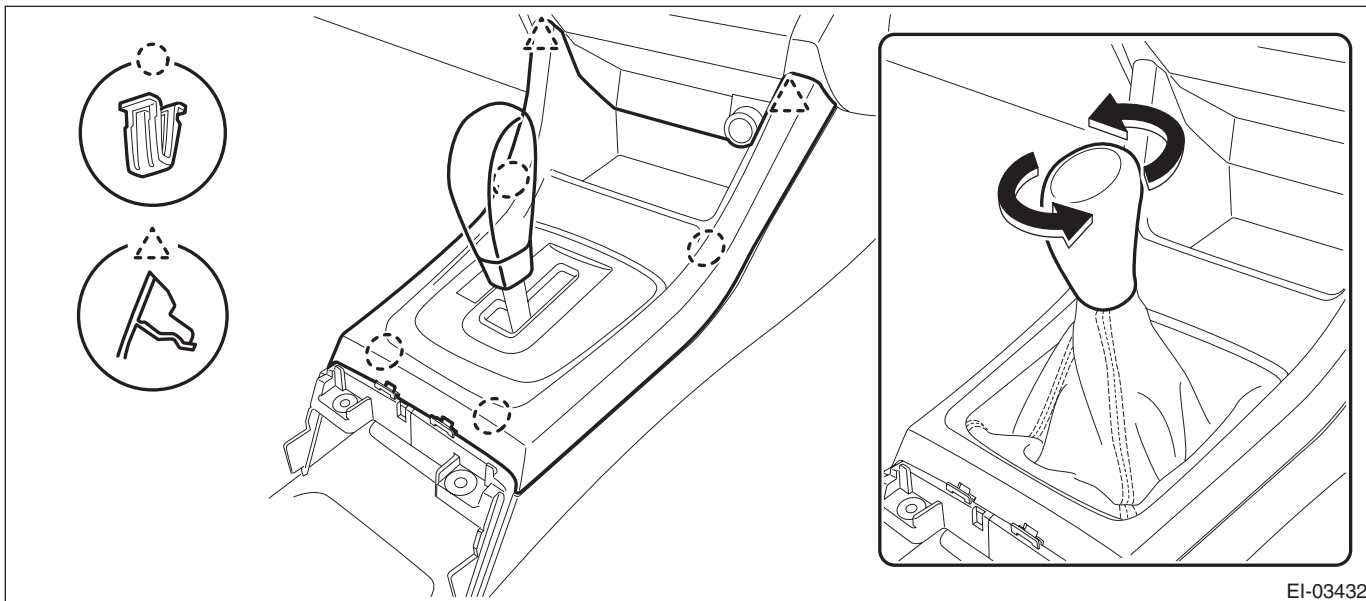

4) On manual A/C models, disconnect the control cables from both sides of the heater & cooling unit.

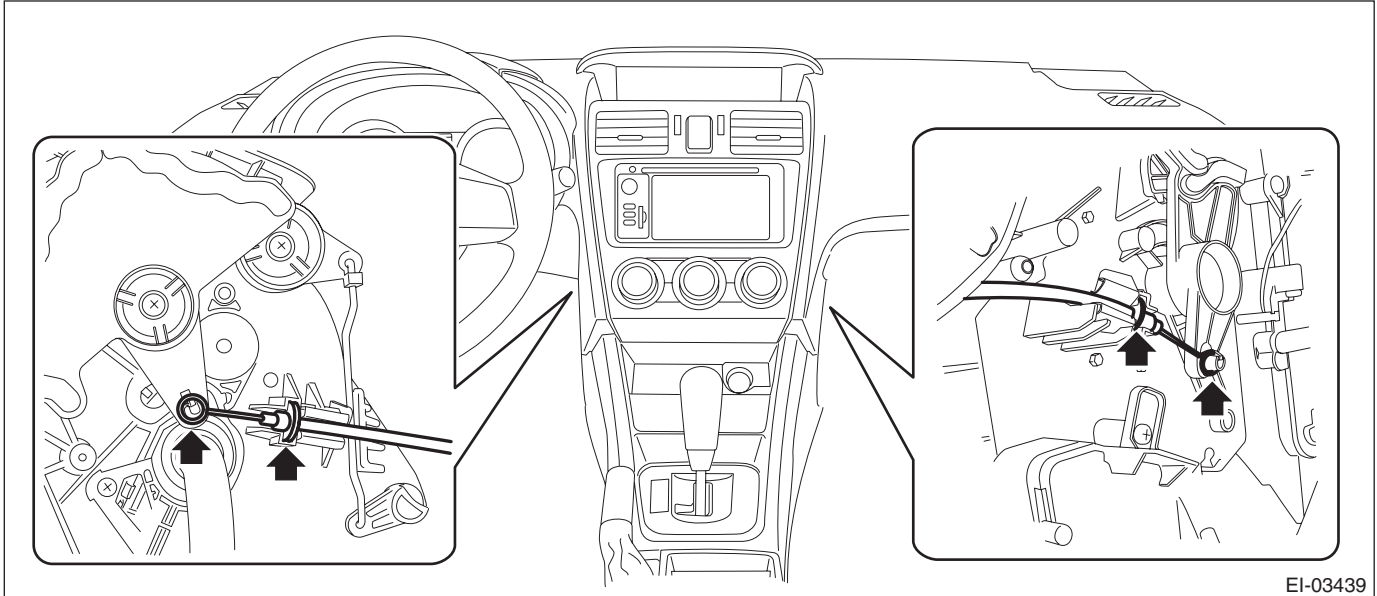

5) Remove the panel center assembly.

CAUTION:

- Do not put your finger on the fin of the air vent grille. Doing so may damage the fin.
 - Pull the panel center assembly slowly. Pulling with excessive force may damage the connector.
- (1) Insert a plastic remover to the three areas shown by the arrows, and lift up the panel center assembly slightly.
 - (2) With the panel center assembly lifted up slightly, release the claw by using a clip remover wrapped with protective tape.
 - (3) Release the rest of the claws, and pull out the panel center assembly.
 - (4) Disconnect the connectors, and remove the panel center assembly.

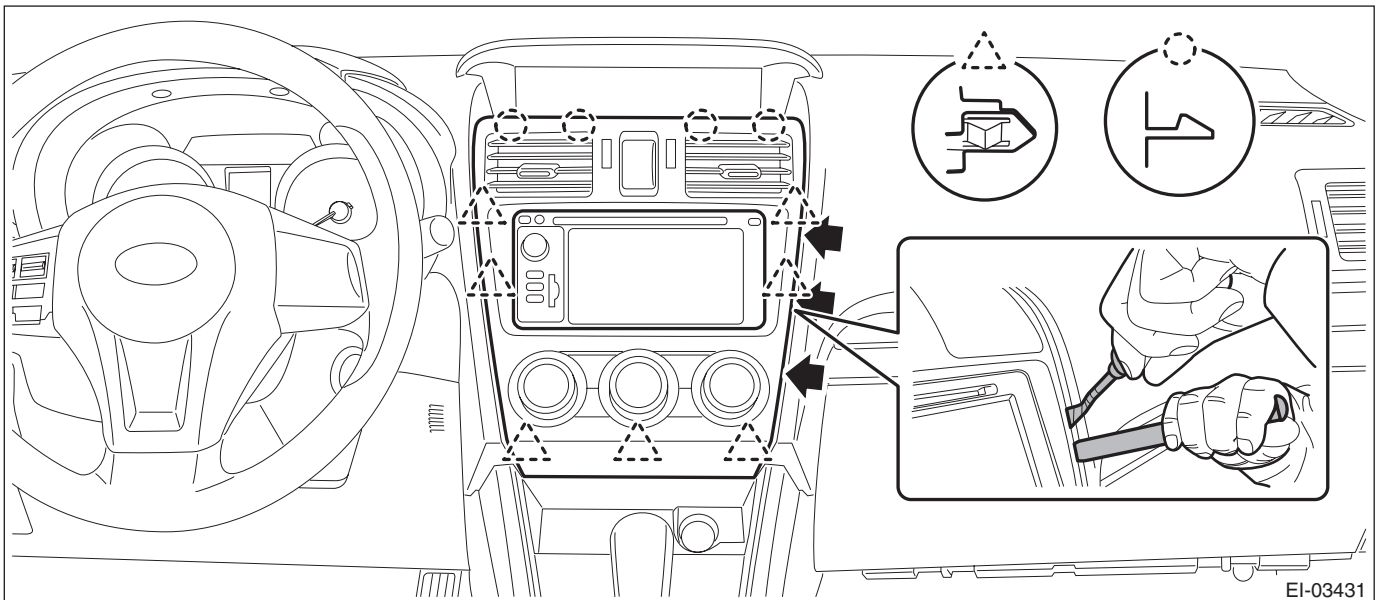

Airbag Control Module

AIRBAG SYSTEM

6) Remove the airbag control module.

(1) Disconnect the connector from airbag control module. <Ref. to AB-21, AIRBAG CONTROL MODULE, PROCEDURE, Airbag Connector.>

(2) Remove the bolt and nuts and remove the airbag control module.

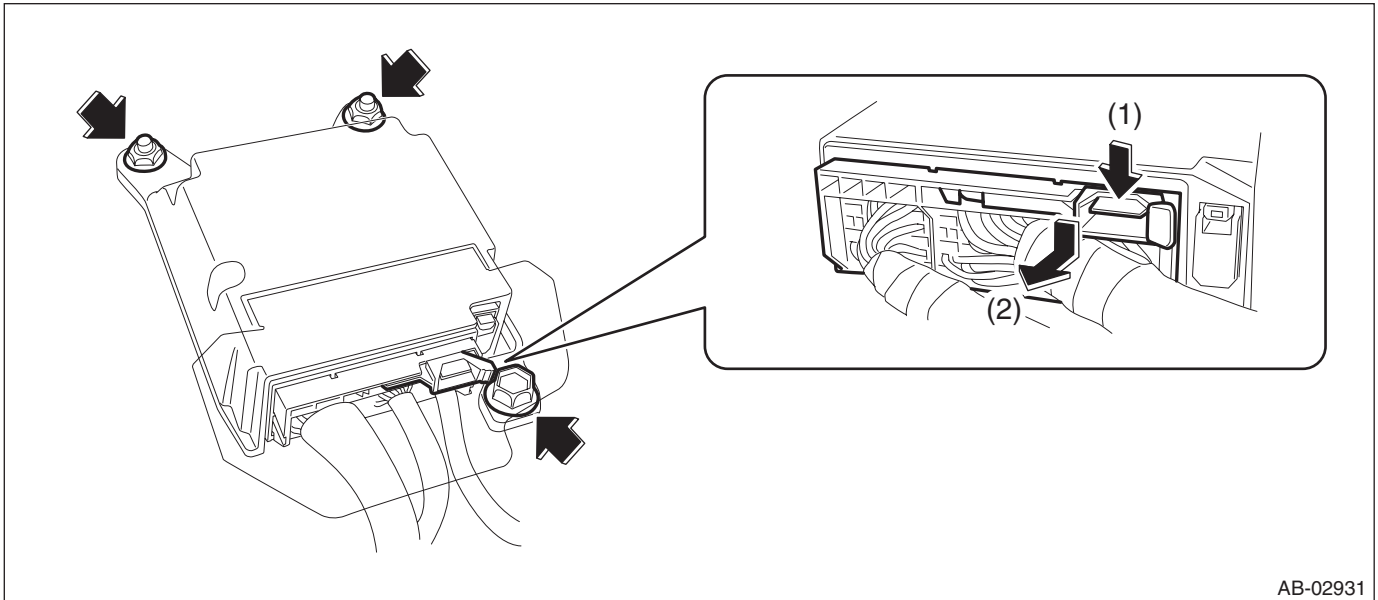

AB-02931

B: INSTALLATION

CAUTION:

Do not reuse the bolt and nut.

Always use new bolts and nuts for them.

1) Before installation, inspect the following items and replace any faulty part with a new one.

- Control module is deformed.
- Control module connector is damaged.
- Control module mounting bracket is damaged.

2) Install each part in the reverse order of removal.

Tightening torque:

Airbag control module: 25 N·m (2.55 kgf-m, 18.4 ft-lb)

Console box assembly: 6.5 N·m (0.66 kgf-m, 4.8 ft-lb)