

PCV Hose

EMISSION CONTROL (AUX. EMISSION CONTROL DEVICES)

13.PCV Hose

A: REMOVAL

CAUTION:

Do not remove except when the PCV hose is broken.

1) Disconnect the PCV hose A from the intake manifold and the PCV valve, and then remove the PCV hose A.

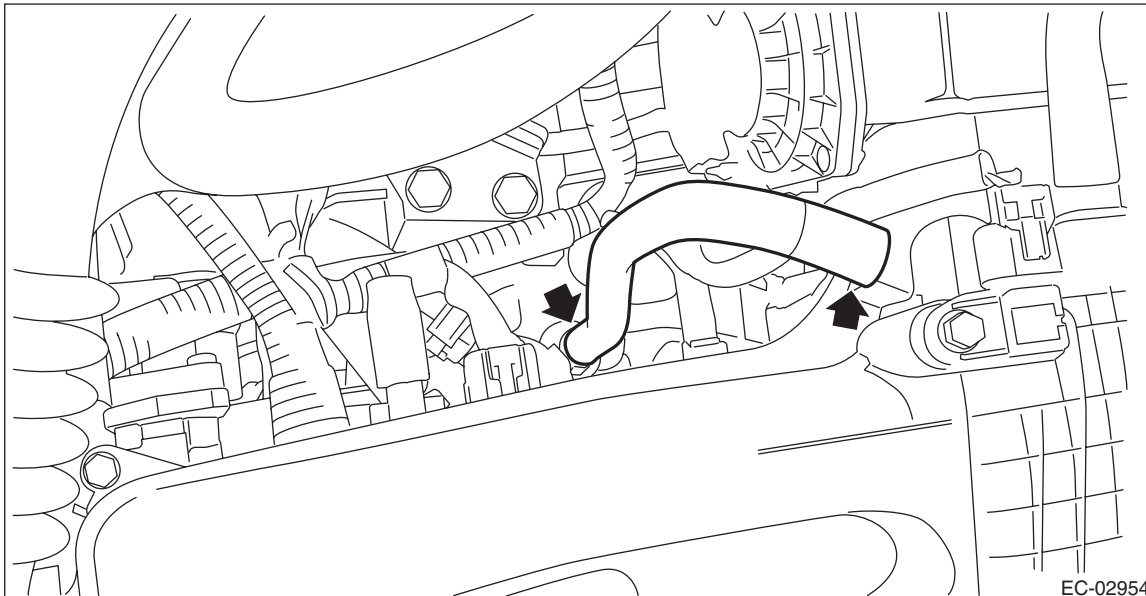

2) Remove the intake manifold. <Ref. to FU(H4DO)-23, REMOVAL, Intake Manifold.>

3) Remove the PCV hose B from the PCV connector.

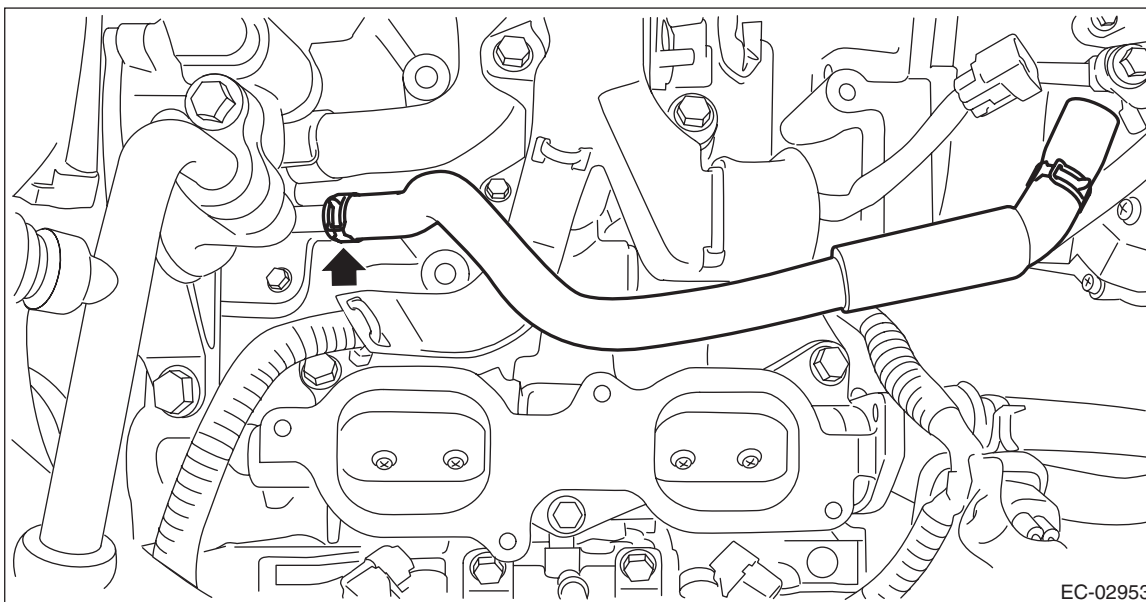

B: INSTALLATION

Install in the reverse order of removal.

C: INSPECTION

Check that the PCV hose has no cracks, damage or loose part.