

## Drive Plate

CONTINUOUSLY VARIABLE TRANSMISSION

### 25. Drive Plate

#### A: REMOVAL

1) Remove the transmission assembly from the vehicle. <Ref. to CVT-58, REMOVAL, Automatic Transmission Assembly.>

2) Set the ST.

ST 498497300 CRANKSHAFT STOPPER

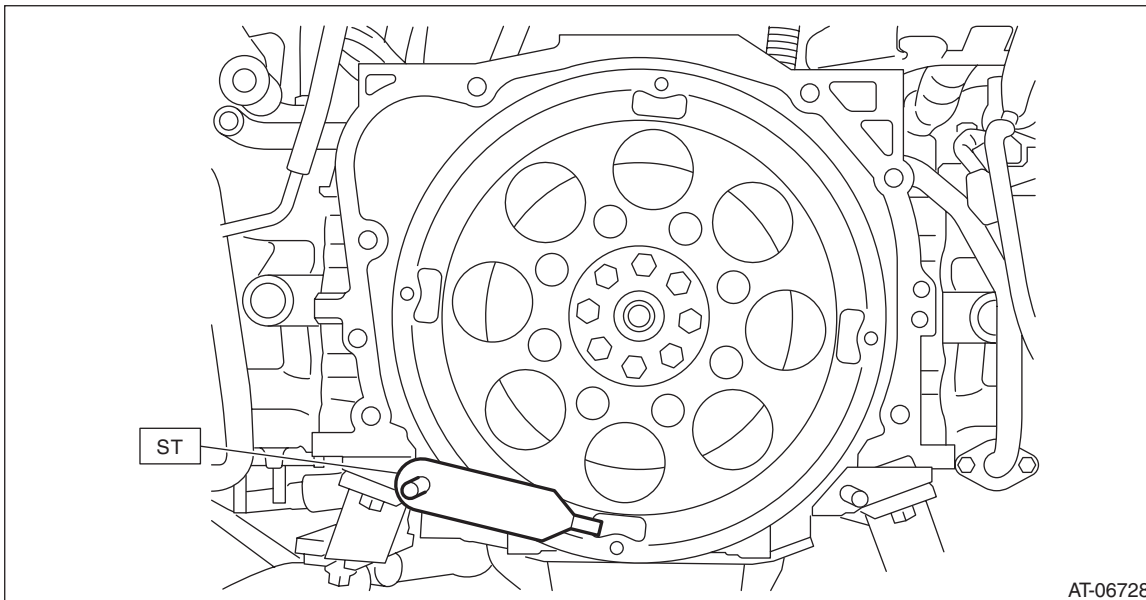

3) Remove the drive plate and reinforcement drive plate.

#### B: INSTALLATION

1) Temporarily install the drive plate and reinforcement drive plate.

2) Set the ST.

ST 498497300 CRANKSHAFT STOPPER

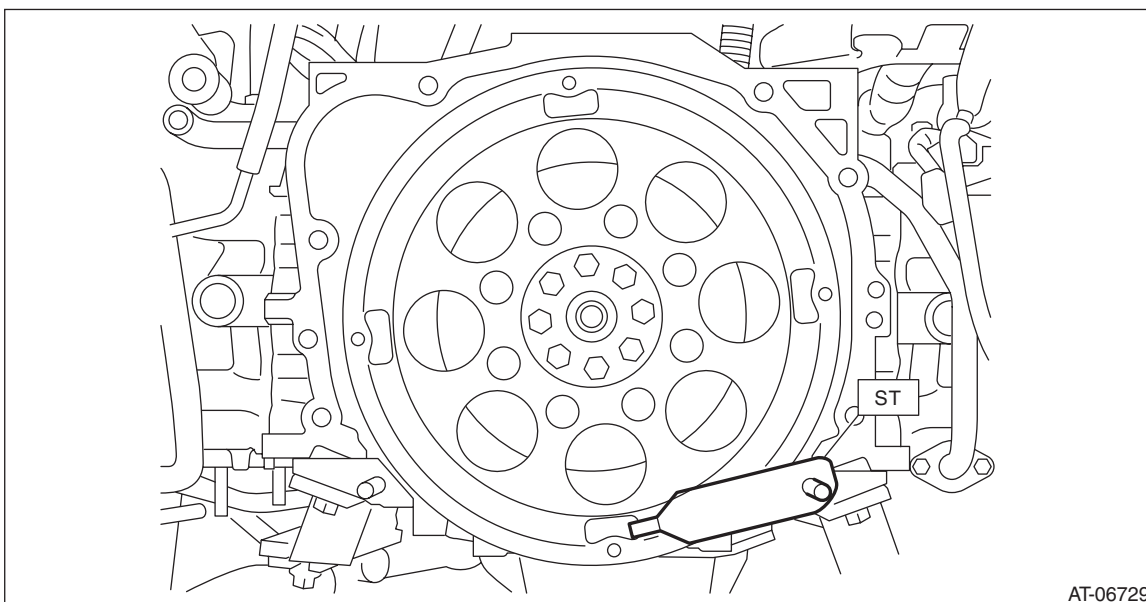

3) Tighten the drive plate mounting bolt in two stages.

(1) Tighten the drive plate mounting bolt.

**Tightening torque:**

**30 N·m (3.1 kgf-m, 22.1 ft-lb)**

(2) While checking the tightening angle with the ST, tighten the drive plate mounting bolts to the specified angle.

**Tightening angle:**

**30° — 35°**

ST 18854AA000 ANGLE GAUGE

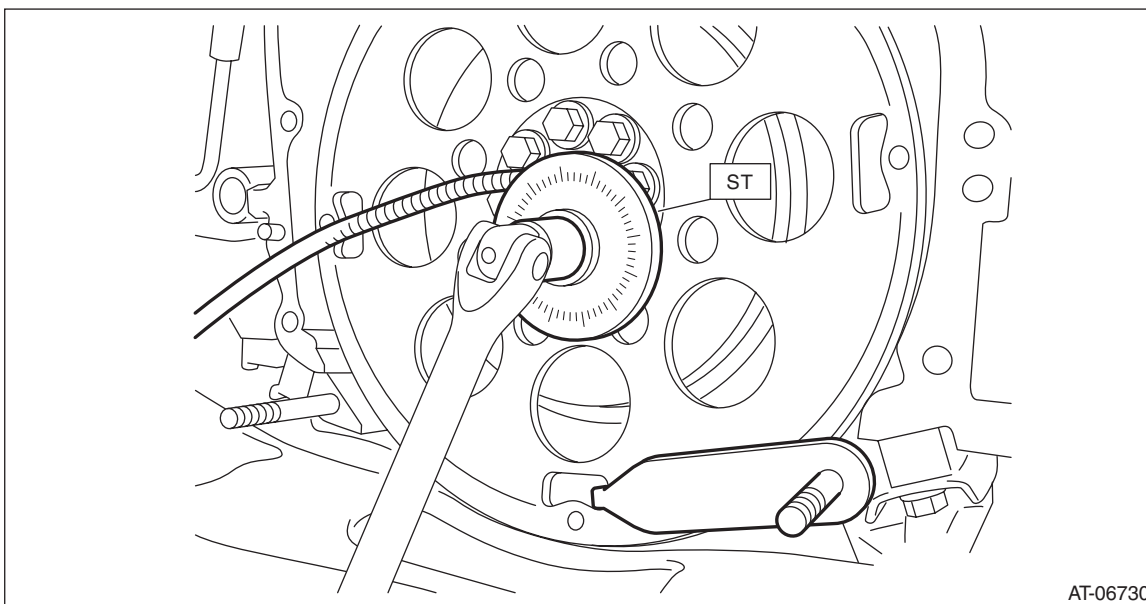

4) Install the transmission assembly to the vehicle. <Ref. to CVT-69, INSTALLATION, Automatic Transmission Assembly.>

### C: INSPECTION

Check the drive cable for damage.