

# General Description

## PARKING BRAKE

### 1. General Description

#### A: SPECIFICATION

Model		Rear disc brake
Type		Mechanical, drum in disc rear brakes
Effective drum diameter	mm (in)	170 (6.69)
Lining dimensions (Length × Width × Thickness)	mm (in)	147.7 × 30.0 × 3.5 (5.81 × 1.181 × 0.14)
Clearance adjustment		Manual adjustment
Lever stroke	Notches/N (kgf, lbf)	7 — 8/200 (20.4, 45)

#### B: COMPONENT

##### 1. PARKING BRAKE (REAR DISC BRAKE)

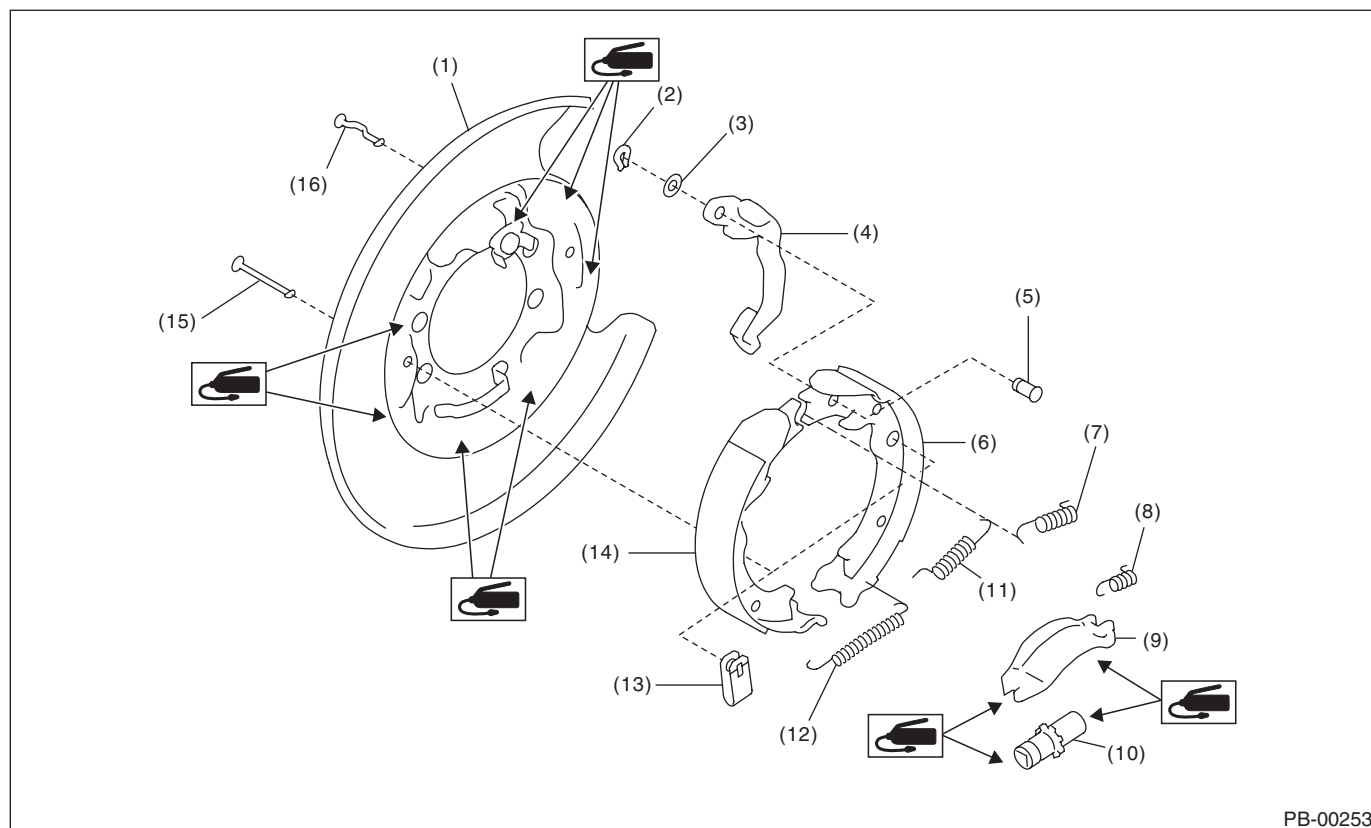

- |                                    |                                    |                                     |
|------------------------------------|------------------------------------|-------------------------------------|
| (1) Back plate - rear brake        | (7) Spring - secondary shoe return | (13) Cup - shoe hold-down           |
| (2) Retainer - rear brake          | (8) Spring - strut                 | (14) Parking brake shoe (primary)   |
| (3) Spring washer - rear brake     | (9) Strut - brake                  | (15) Pin - primary shoe hold-down   |
| (4) Parking lever - rear           | (10) Adjuster ASSY - rear brake    | (16) Pin - secondary shoe hold-down |
| (5) Pin - parking lever            | (11) Spring - primary shoe return  |                                     |
| (6) Parking brake shoe (secondary) | (12) Spring - adjuster             |                                     |

## 2. PARKING BRAKE LEVER & CABLE

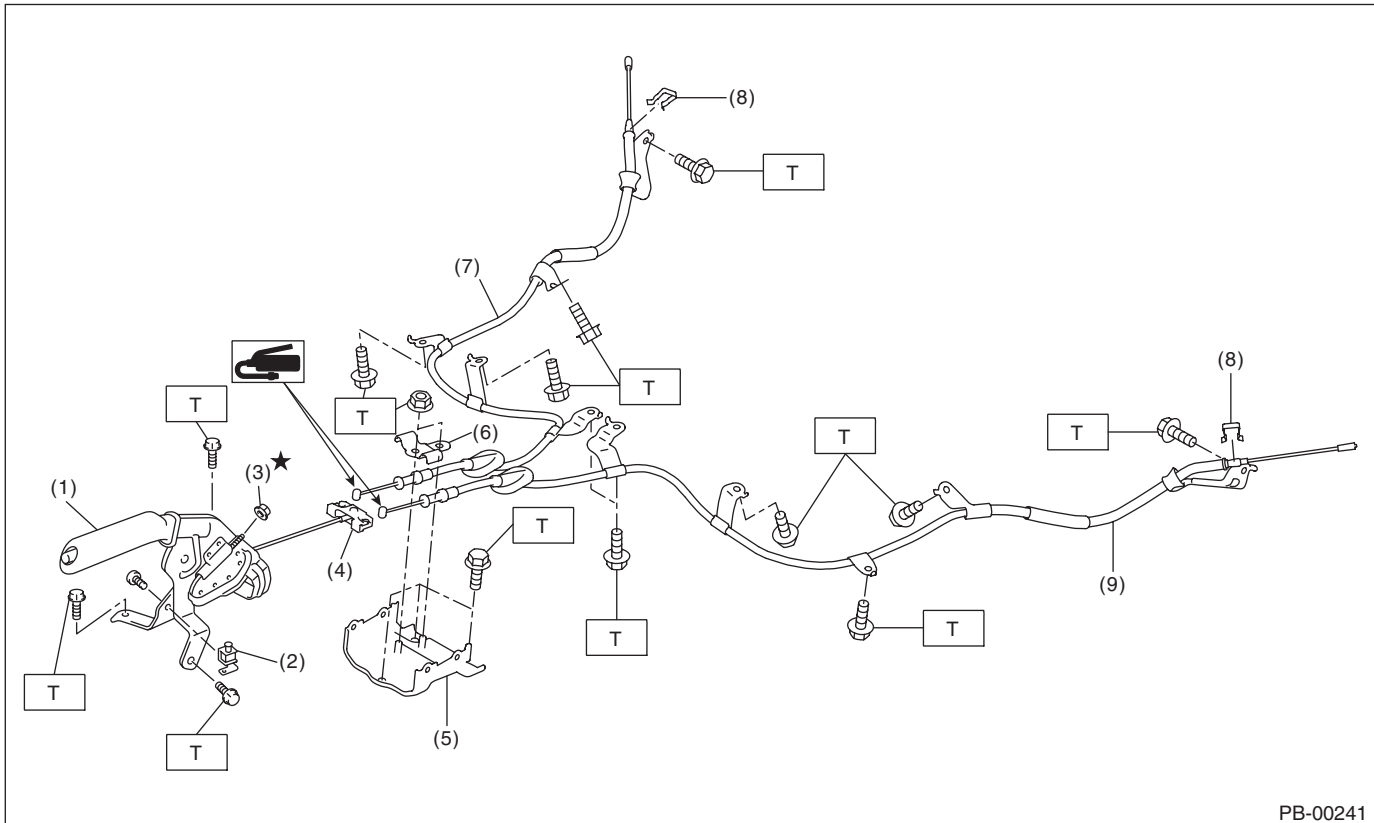

- |                                      |                                   |  |
|--------------------------------------|-----------------------------------|--|
| (1) Lever assembly - hand brake      | (5) Bracket                       | (9) Cable ASSY - parking brake LH            |
| (2) Switch ASSY - hand brake         | (6) Clamp A - hand brake cable    |  |
| (3) Adjusting nut (self-locking nut) | (7) Cable ASSY - parking brake RH | <b>Tightening torque: N·m (kgf-m, ft-lb)</b> |
| (4) Equalizer                        | (8) Clamp B - hand brake cable    | <b>T: 18 (1.84, 13.3)</b>                    |

### C: CAUTION

- Wear appropriate work clothing, including a helmet, protective goggles and protective shoes when performing any work.
- Before removal, installation or disassembly, be sure to clarify the failure. Avoid unnecessary removal, installation, disassembly and replacement.
- Vehicle components are extremely hot after driving. Be wary of receiving burns from heated parts.
- Use SUBARU genuine grease etc. or equivalent. Do not mix grease etc. of different grades or manufacturers.
- Be sure to tighten fasteners including bolts and nuts to the specified torque.
- Place shop jacks or rigid racks at the specified points.
- Make sure grease does not come into contact with the parking shoes.

### D: PREPARATION TOOL

#### 1. GENERAL TOOL

TOOL NAME	REMARKS
Circuit tester	Used for measuring resistance and voltage.