

8. Front Wiper Motor and Link

A: REMOVAL

- 1) Disconnect the ground cable from battery.
- 2) Remove the arm assembly - windshield wiper.
 - (1) Remove the cover - windshield wiper arm.
 - (2) Remove the nuts, and remove the arm assembly - windshield wiper.

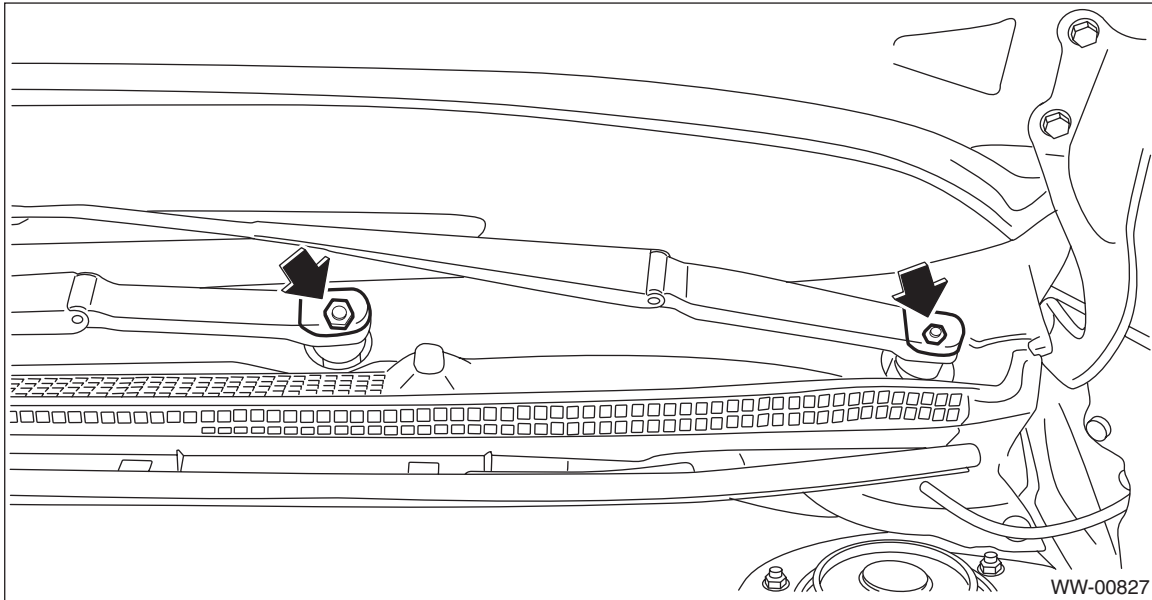

- 3) Remove the cowl panel - side.
 - (1) Remove the clips.
 - (2) Release the claws, and then remove the cowl panel - side.

CAUTION:

Pulling with excessive force may damage the cowl panel - side. If it is difficult to remove, use a plastic remover or equivalent tool.

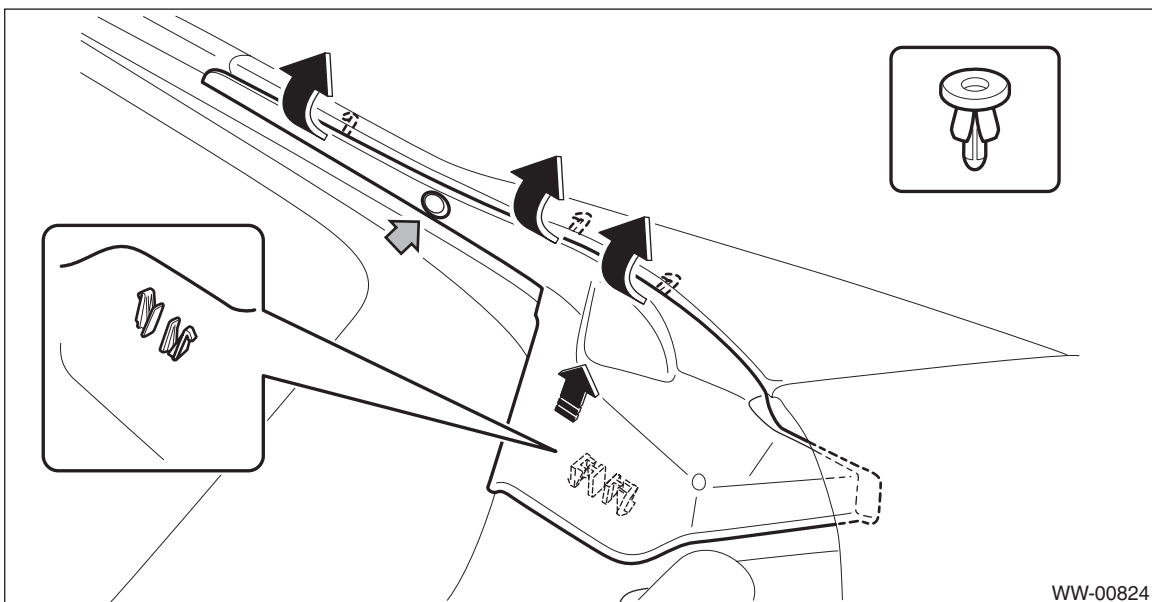

- 4) Remove the cowl panel assembly.
 - (1) Disconnect the hose - windshield washer.
 - (2) Remove clips (A).
 - (3) Check the direction of the clip (B), and push the claws from both sides to remove it.

CAUTION:

When removing the clip (B), push the claw of the clip from both sides.

Be careful because the clips (B) can be damaged if you pull unnecessarily hard on them.

- (4) Remove the cowl panel assembly by pulling it out towards the front of the vehicle.

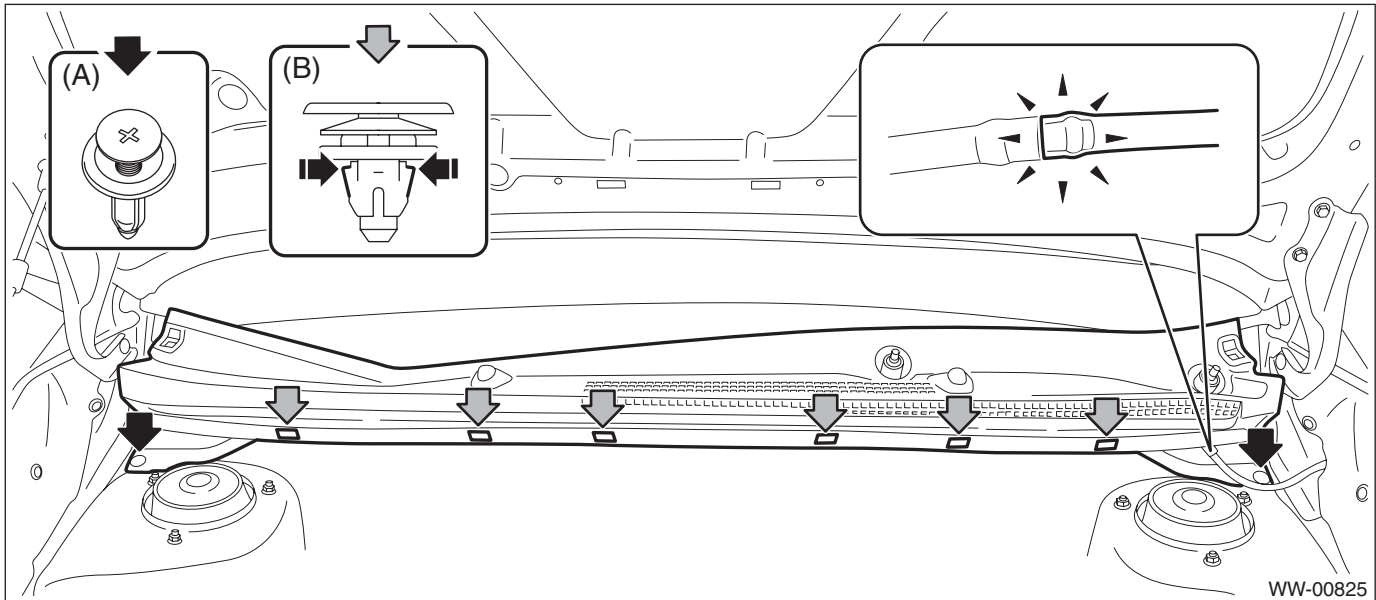

- 5) Remove the link assembly - windshield wiper.
 - (1) Disconnect the connector of the motor assembly - windshield wiper.
 - (2) Remove the bolts and harness clips, and remove the link assembly - windshield wiper.

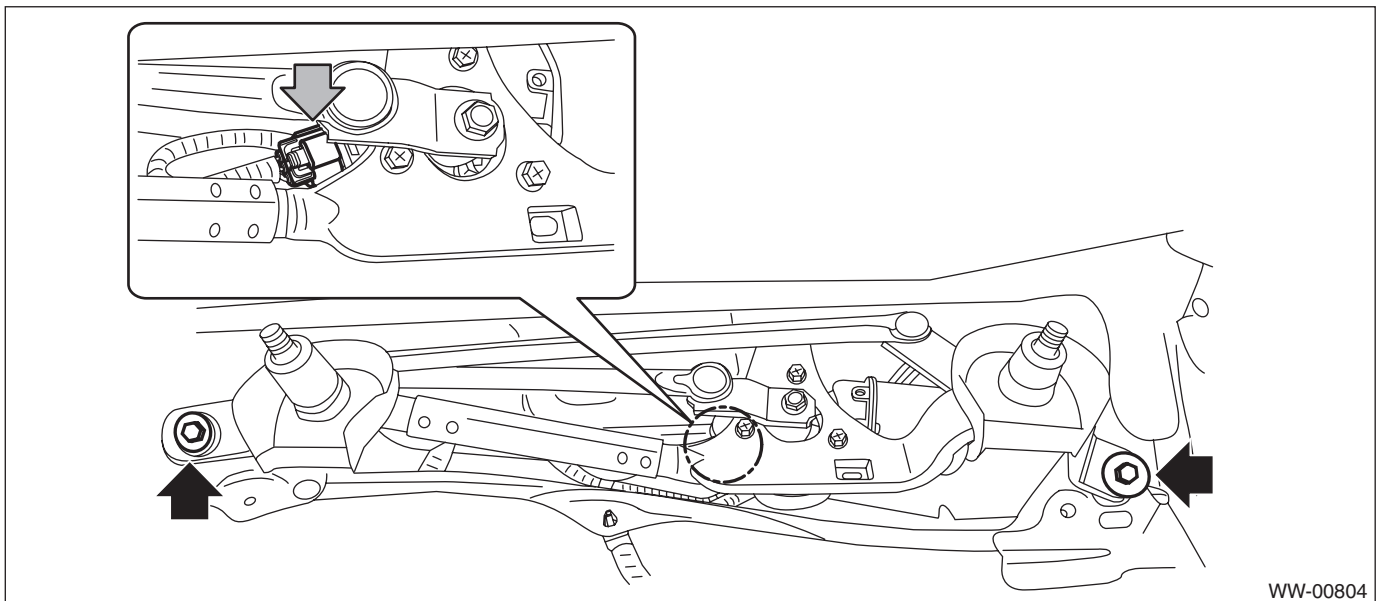

Front Wiper Motor and Link

WIPER AND WASHER SYSTEMS

6) Remove the motor assembly - windshield wiper.

(1) Remove the nuts on the link plate and the motor assembly - windshield wiper, and disconnect from the link assembly - windshield wiper.

(2) Remove the bolts, and remove the motor assembly - windshield wiper.

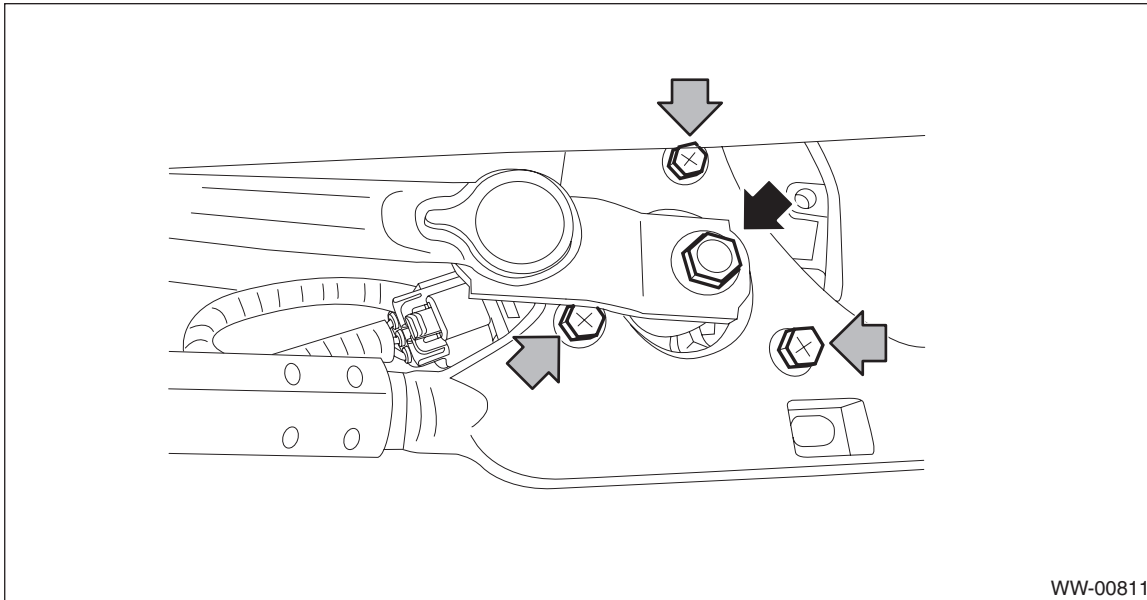

WW-00811

B: INSTALLATION

1) Connect the battery ground terminal.

2) To confirm that the motor assembly - windshield wiper is at the auto stop position, connect the harness to the motor and turn the wiper switch to ON/OFF once.

CAUTION:

During motor operation, do not touch the movable part.

3) Disconnect the ground cable from battery.

4) Install the motor assembly - windshield wiper.

CAUTION:

Tighten the nut where rod (B) and link plate (A) is aligned in a straight line.

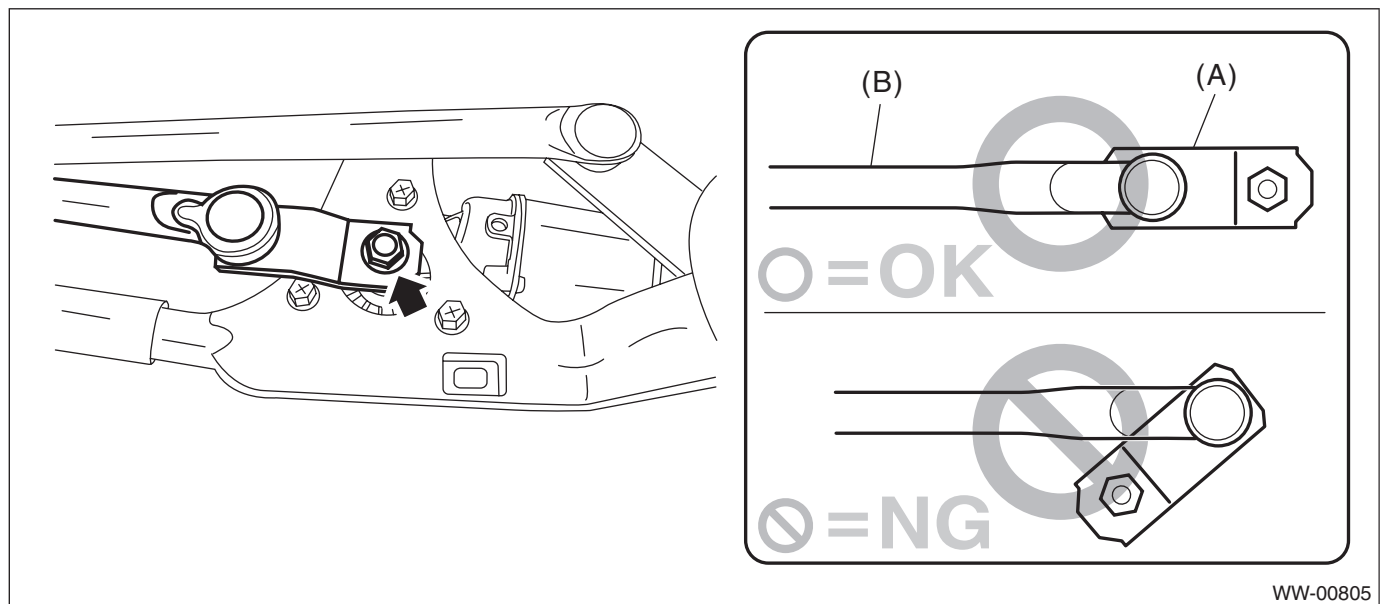

WW-00805

Tightening torque:

Tighten to 8.5 N·m (0.87 kgf-m, 6.3 ft-lb) by 115°.

5) Install the link assembly - windshield wiper and cowl panel in the reverse order of removal.

Tightening torque:

Refer to “**COMPONENT**” of “**General Description**”. <Ref. to WW-2, **FRONT WIPER, COMPONENT, General Description.**>

C: INSPECTION

- 1) When the battery is connected to the terminal of connectors, confirm that the motor operates at low speed.
- 2) When the battery is connected to the terminal of connectors, confirm that the motor operates at high speed.
- 3) Connect the battery to terminals of the connector, and remove the terminal connection with motor rotating at low speed, and stop the motor assembly - windshield wiper in mid-operation.
- 4) Connect the battery and check that the motor stops at the automatic stop position after the motor operates at low speed again.

CAUTION:

Fix the motor to prevent the motor from being shorted by moving during operation.

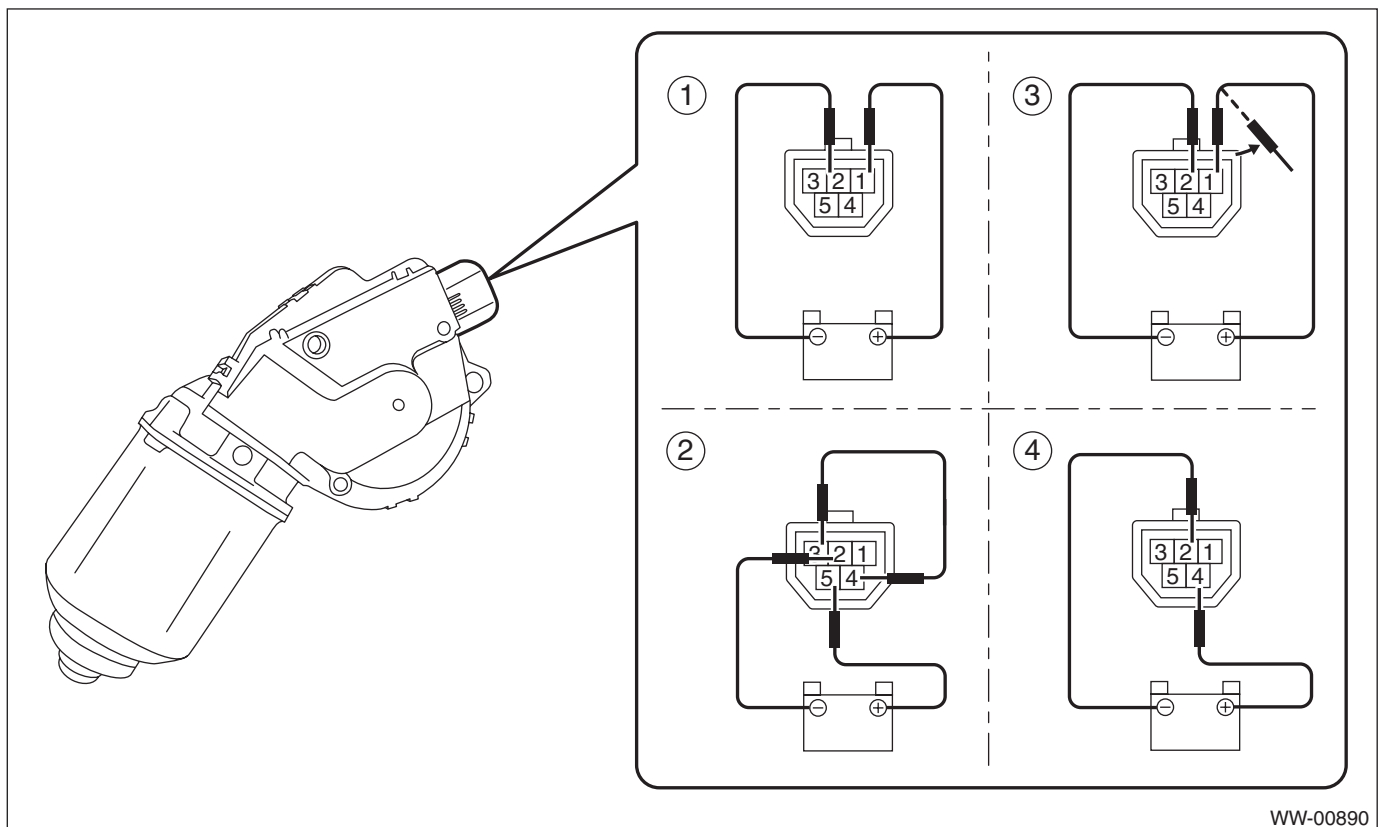

WW-00890