

### 36.Ignition Switch Illumination

#### A: REMOVAL

##### NOTE:

The ignition switch illumination is integrated into the immobilizer antenna assembly.

- 1) Disconnect the ground cable from battery.
- 2) Remove the cover assembly - column.
  - (1) Remove the screws by turning the steering wheel to right and left.

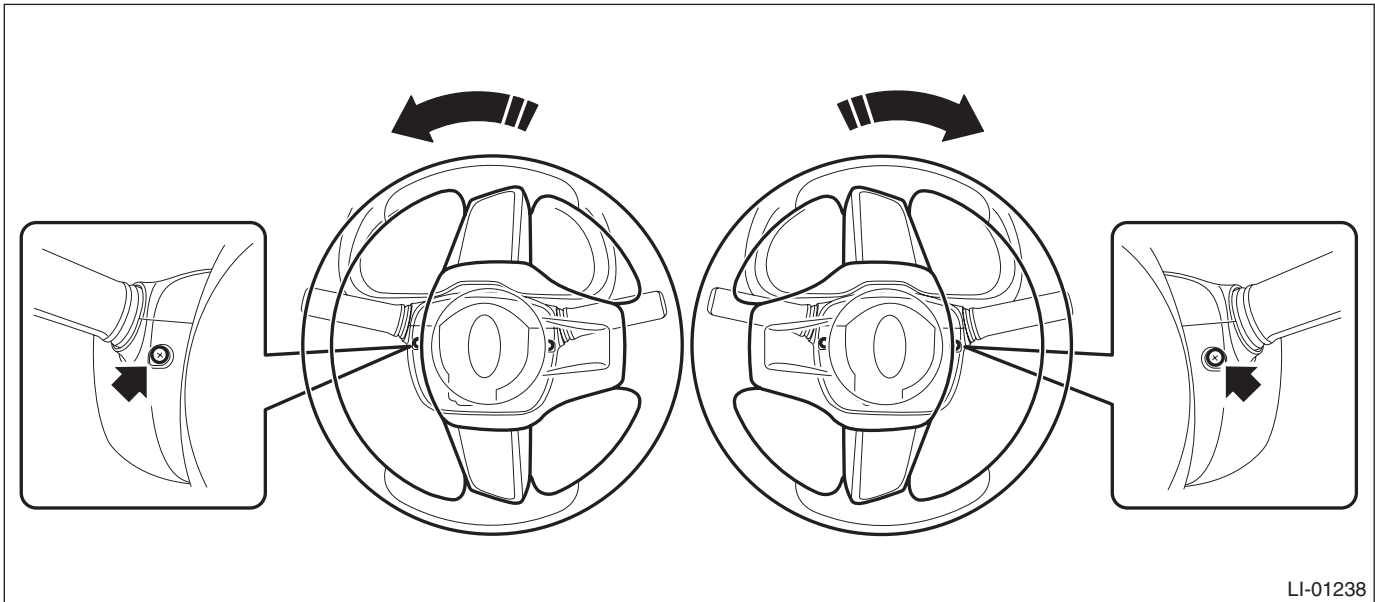

- (2) Release the claw, and remove the cover assembly - column UPR and the cover assembly - column LWR.

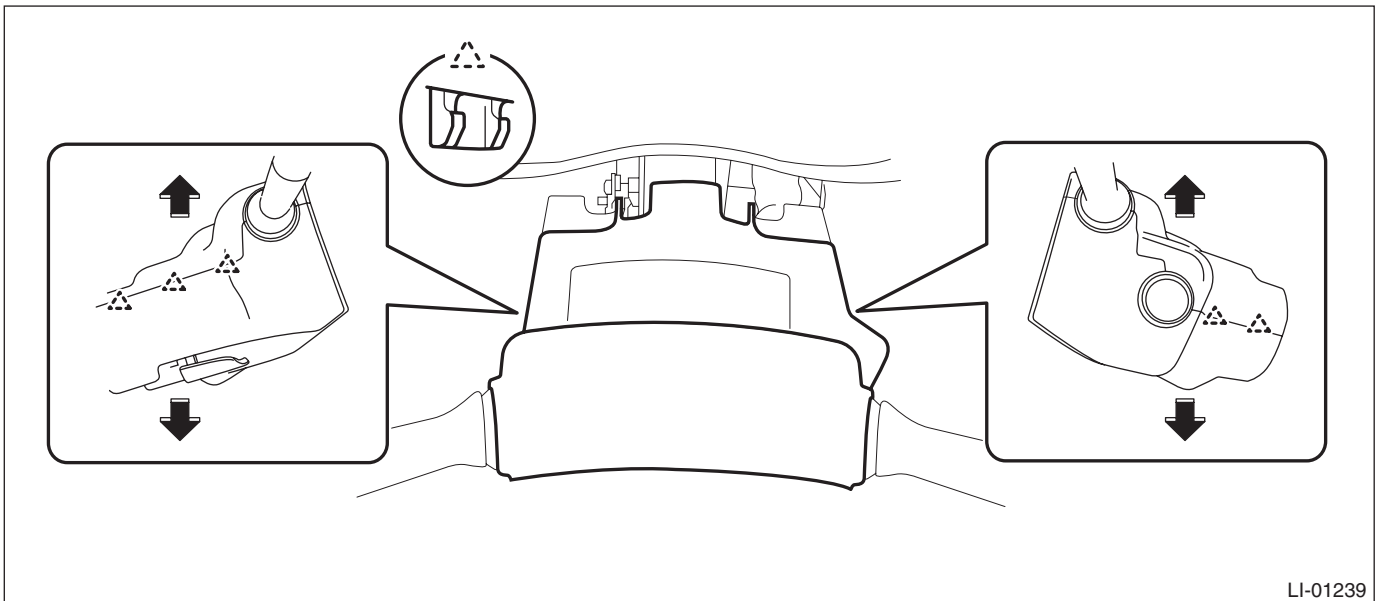

3) Disconnect the connector and remove the ignition switch illumination.

**CAUTION:**

Do not apply excessive force to remove the ignition switch illumination lock. Otherwise they may be broken because those parts are the products made of a plastic.

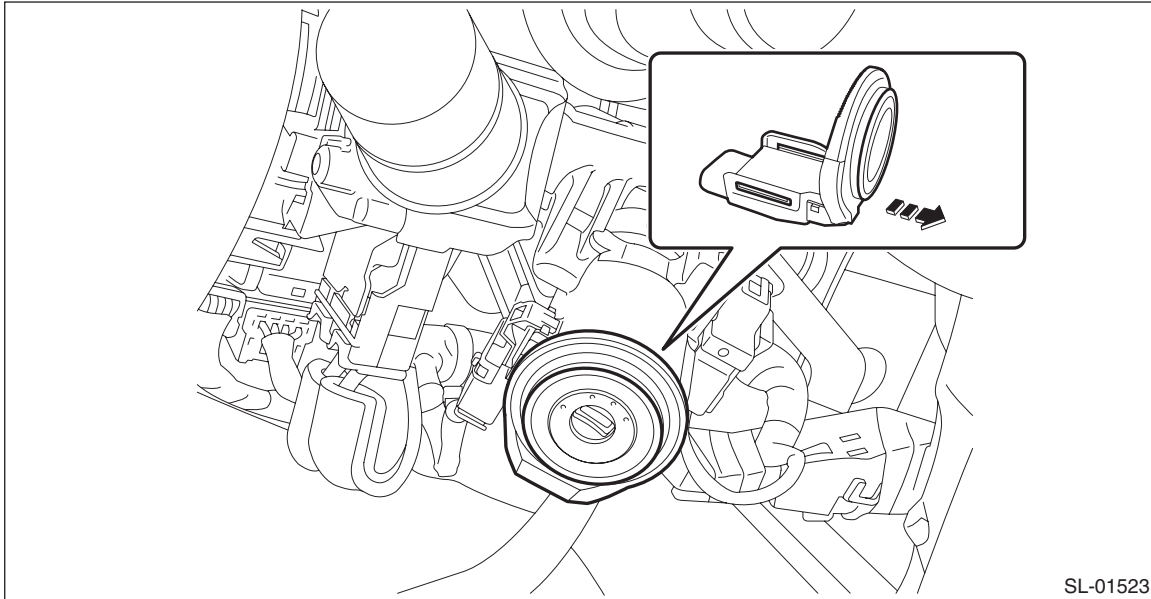

## B: INSTALLATION

Install each part in the reverse order of removal.

## C: INSPECTION

On- the vehicle inspection

**Preparation tool:**

**Circuit tester**

	Step	Check	Yes	No
1	<b>CHECK THE IGNITION SWITCH ILLUMINATION.</b> Make sure the ignition switch illumination illuminates when driver's side door is open.	Does the ignition switch illumination illuminate?	Ignition switch illumination is normal.	Go to step 2.
2	<b>CHECK THE IGNITION SWITCH ILLUMINATION.</b> Make sure the ignition switch illumination blinks when the ignition switch is turned to ON.	Does the ignition switch illumination blink?	Check the function setting of body integrated unit. <Ref. to BC(diag)-2, Basic Diagnostic Procedure.>	Check the ignition switch illumination circuit. <Ref. to SL-25, CHECK IGNITION SWITCH ILLUMINATION, INSPECTION, Keyless Entry System.>