

12.Rear Accessory Power Supply Socket

A: WIRING DIAGRAM

Refer to “Rear Accessory Power Supply Socket System” in the wiring diagram. <Ref. to WI-123, WIRING DIAGRAM, Rear Accessory Power Supply Socket System.>

B: REMOVAL

- 1) Disconnect the ground cable from battery.
- 2) Open the console box, and remove the rear accessory power supply socket.
 - (1) Release the claws inside the accessory power supply socket.
 - (2) Pull the accessory power supply socket out to remove.

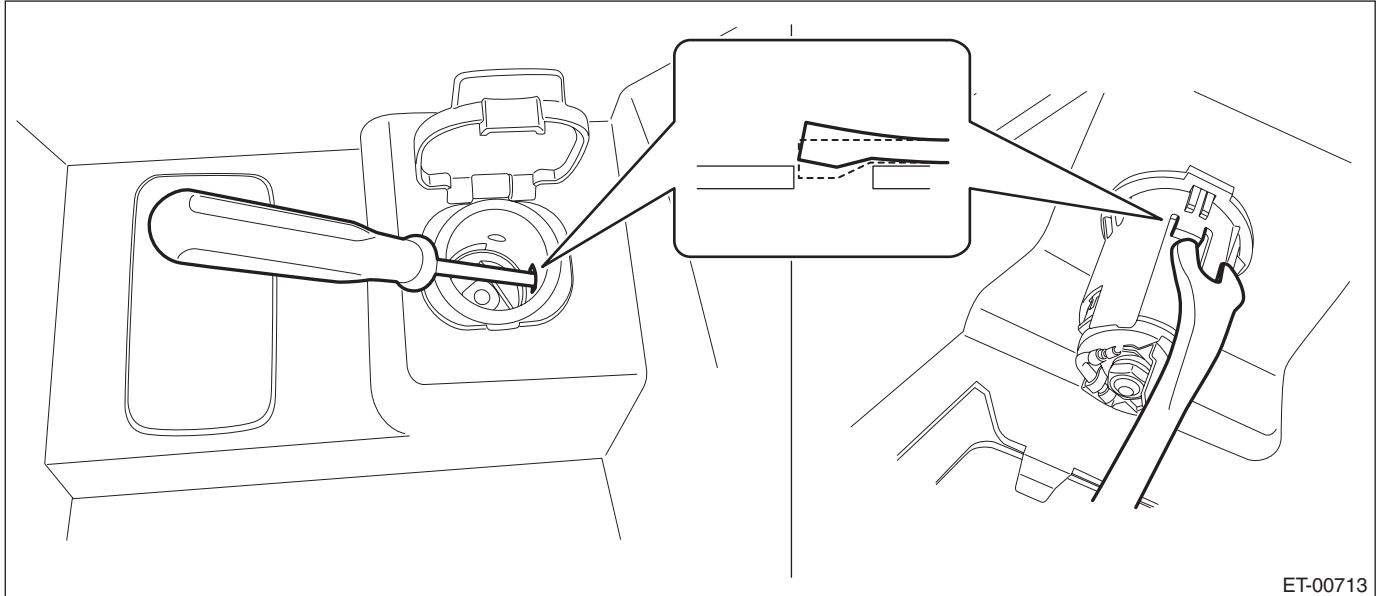

NOTE:

If it is hard to remove, remove the console box assembly and then release the claws from behind.

C: INSTALLATION

Install each part in the reverse order of removal.

NOTE:

Align the grooves of the holder with the claws of accessory power supply socket.

