

## 4. Horn

### A: REMOVAL

**CAUTION:**

Do not remove the bumper face - front when removing the horn, in order to prevent damaging the claws of the bracket - front bumper corner and the bracket - front bumper side.

- 1) Disconnect the ground cable from battery.
- 2) Remove the clip, and remove the bracket - grille.

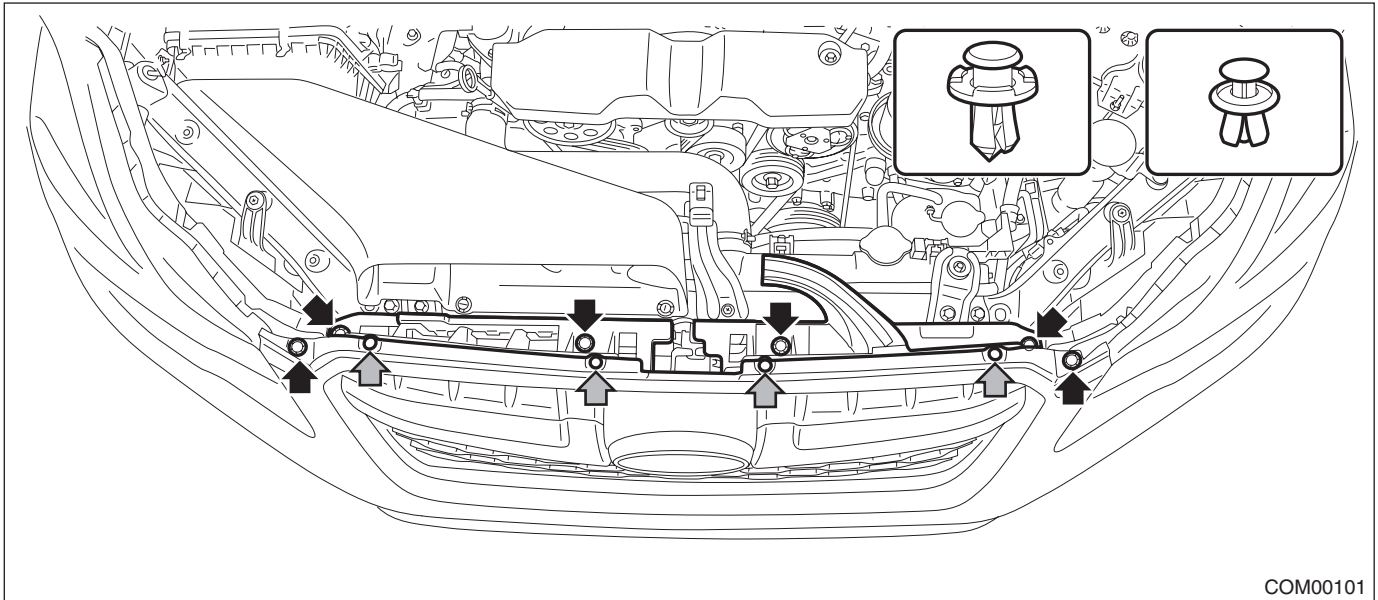

- 3) Remove the horn assembly - Lo.

- (1) Disconnect the connector.
- (2) Remove the horn bracket mounting bolt, and remove the horn assembly - Lo.

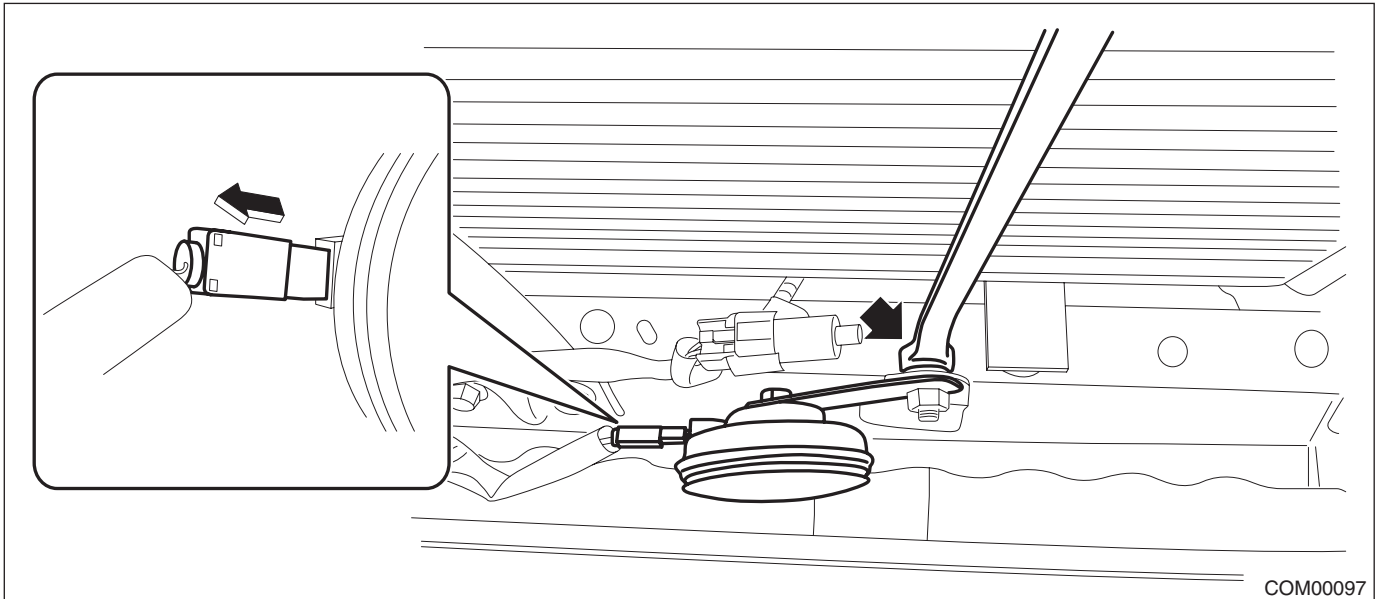

# Horn

## COMMUNICATION SYSTEM

### 4) Remove the horn assembly - Hi.

- (1) Remove the bolts and clips, and remove the under cover - front.

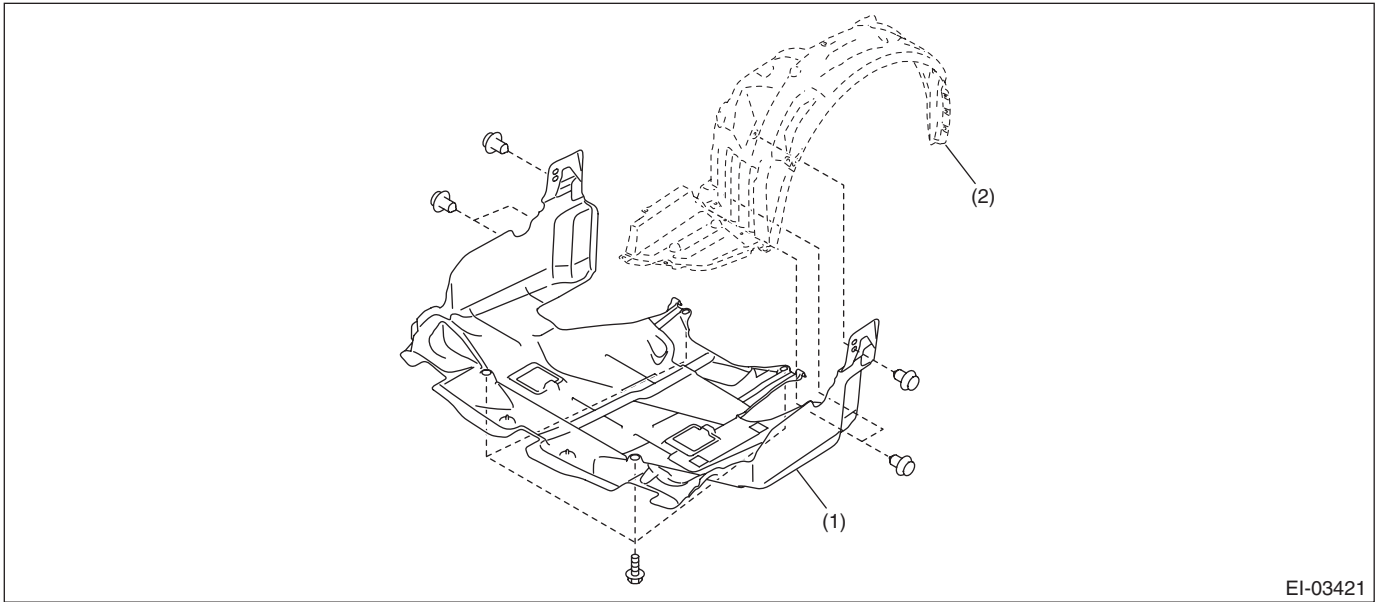

EI-03421

(1) Under cover - front

(2) Mud guard - front

- (2) Remove the clips, turn over the mud guard - front, and disconnect the horn connector.

- (3) Remove the horn bracket mounting bolt, and remove the horn assembly - Hi.

### CAUTION:

**The resistor may become hot. Be careful not to burn yourself.**

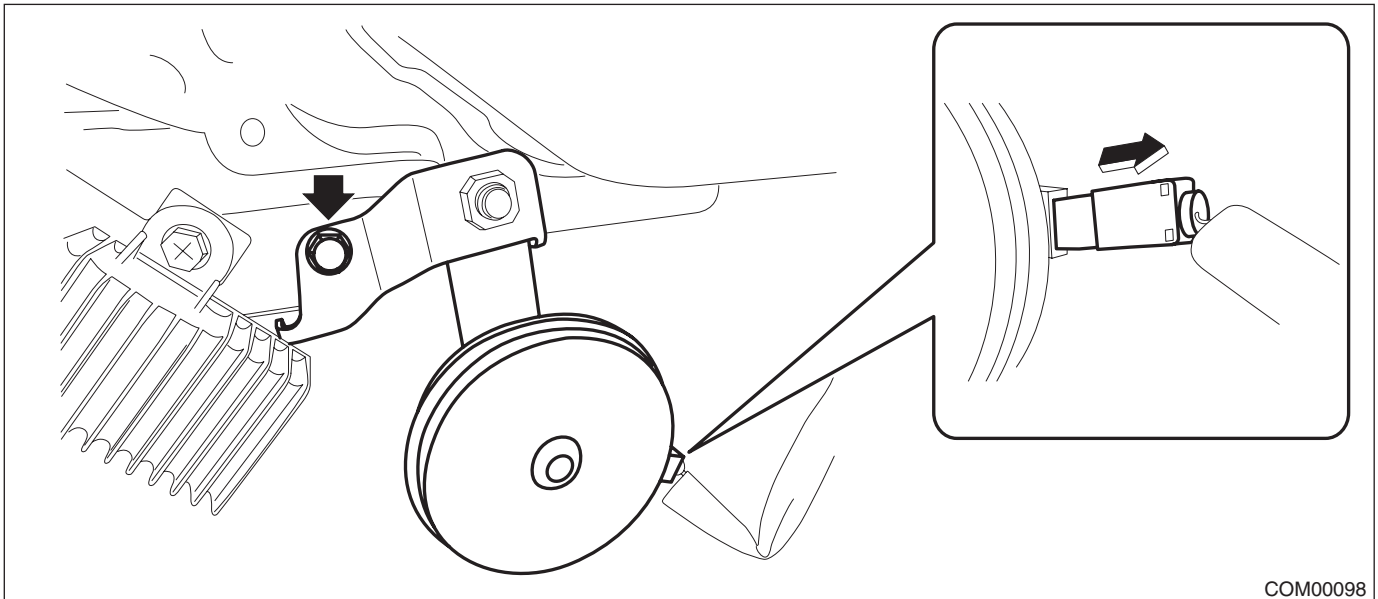

COM00098

## B: INSTALLATION

Install each part in the reverse order of removal.

### CAUTION:

Install the under cover so that the under cover front end (b) comes inside of the bumper face - front (a).

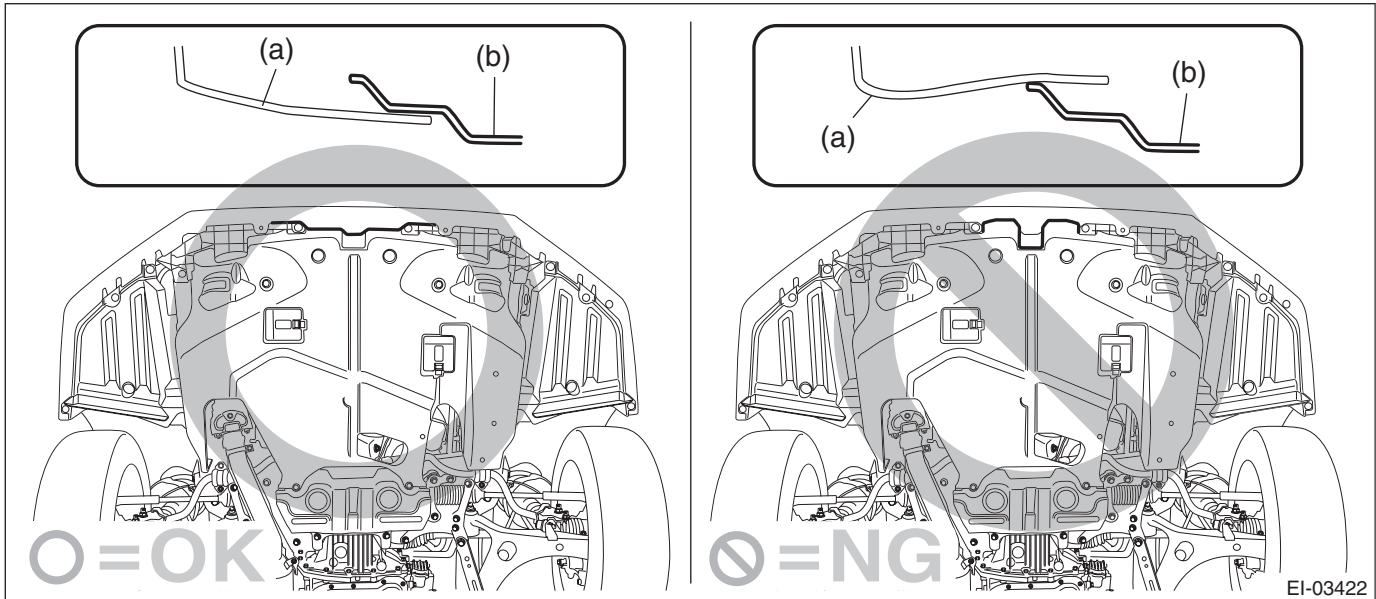

### Tightening torque:

**Horn assembly - Hi: 13 N·m (1.33 kgf-m, 9.6 ft-lb)**

**Horn assembly - Lo: 18 N·m (1.84 kgf-m, 13.3 ft-lb)**

## C: INSPECTION

### 1. CHECK HORN ASSEMBLY

- 1) Remove the horn assembly (Hi & Lo). <Ref. to COM-5, REMOVAL, Horn.>
- 2) Check the horn sounds when applying the battery voltage to the horn assembly.

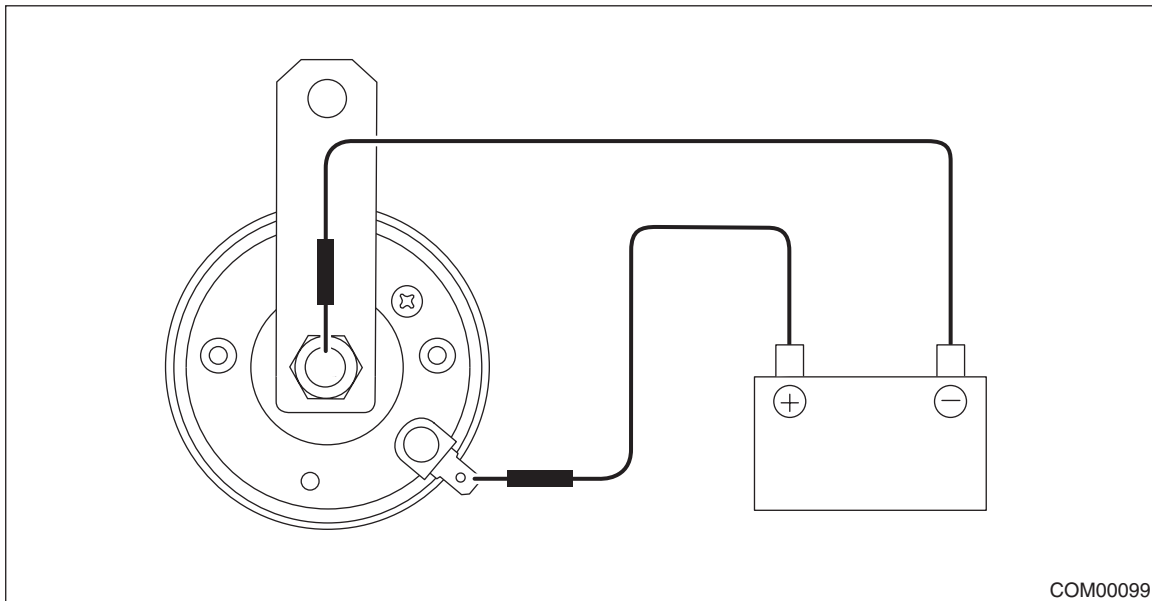

COM00099

Terminal No.	Inspection conditions	Specification
Horn terminal (+) — Horn case (-)	Connect battery to the terminals	Sounds

- 3) If it does not operate normally, replace the horn assembly.