

22.Oil Switching Solenoid Valve

A: REMOVAL

1. RH SIDE

1) Disconnect the ground cable from battery.

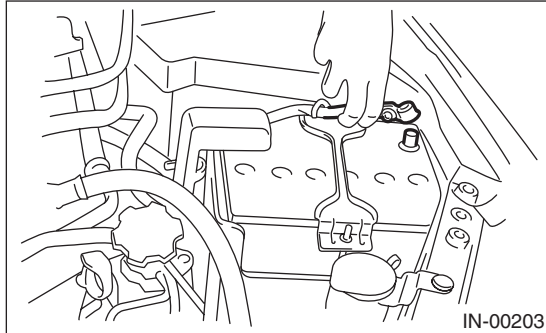

2) Remove the air intake chamber. <Ref. to IN(H4SO)-7, REMOVAL, Air Intake Chamber.>

3) Remove the bolt, and disconnect the engine harness connector from the bulkhead harness connector and rear engine hanger.

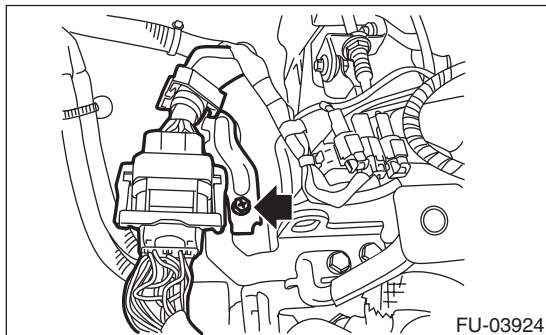

4) Slide the bulkhead harness connector in the direction of the arrow and remove it from the rear engine hanger.

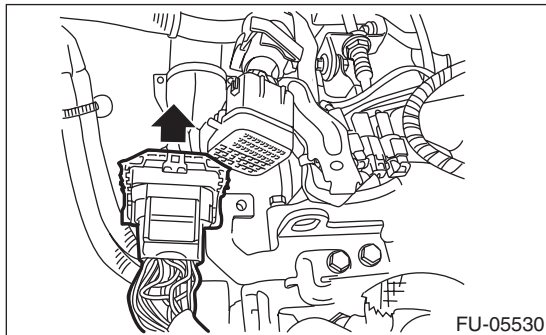

5) Disconnect the connector from the oil switching solenoid valve.

6) Remove the oil switching solenoid valve.

7) Remove the variable valve lift diagnosis oil pressure switch. <Ref. to FU(H4SO)-40, REMOVAL, Variable Valve Lift Diagnosis Oil Pressure Switch.>

8) Remove the oil temperature sensor. <Ref. to FU(H4SO)-41, REMOVAL, Oil Temperature Sensor.>

9) Remove the oil switching solenoid valve holder from the cylinder head.

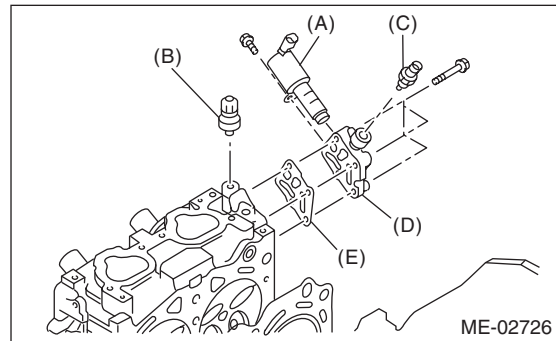

- (A) Oil switching solenoid valve
- (B) Variable valve lift diagnosis oil pressure switch
- (C) Oil temperature sensor
- (D) Oil switching solenoid valve holder
- (E) Gasket

2. LH SIDE

1) Disconnect the ground cable from battery.

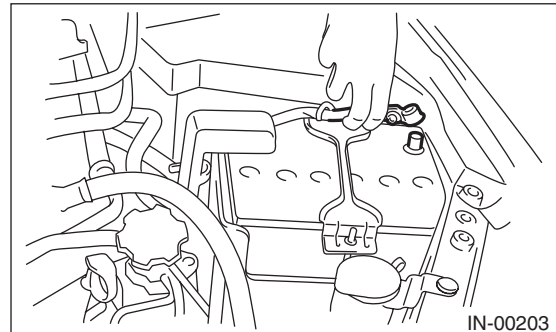

2) Remove the crank pulley. <Ref. to ME(H4SO)-46, REMOVAL, Crank Pulley.>

3) Remove the timing belt cover. <Ref. to ME(H4SO)-49, REMOVAL, Timing Belt Cover.>

4) Remove the timing belt. <Ref. to ME(H4SO)-50, REMOVAL, Timing Belt.>

5) Remove the cam sprocket. <Ref. to ME(H4SO)-55, REMOVAL, Cam Sprocket.>

6) Remove the timing belt cover No. 2 (LH).

7) Disconnect the connector from the oil switching solenoid valve.

8) Remove the oil switching solenoid valve.

9) Remove the variable valve lift diagnosis oil pressure switch. <Ref. to FU(H4SO)-40, REMOVAL, Variable Valve Lift Diagnosis Oil Pressure Switch.>

Oil Switching Solenoid Valve

MECHANICAL

10) Remove the oil switching solenoid valve holder from the cylinder head.

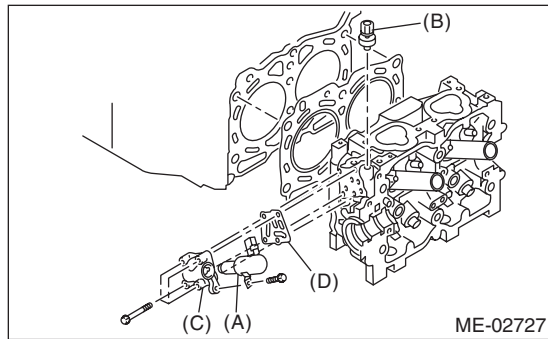

- (A) Oil switching solenoid valve
- (B) Variable valve lift diagnosis oil pressure switch
- (C) Oil switching solenoid valve holder
- (D) Gasket

B: INSTALLATION

1. RH SIDE

Install in the reverse order of removal.

NOTE:

- Use a new gasket.
- Apply liquid gasket to variable valve lift diagnosis oil pressure switch threads.
- Install the oil switching solenoid valve to the holder, then install it to the cylinder head.

Tightening torque:

T1: 6.4 N·m (0.7 kgf-m, 4.7 ft-lb)

T2: 10 N·m (1.0 kgf-m, 7.4 ft-lb)

T3: 17 N·m (1.7 kgf-m, 12.5 ft-lb)

T4: 18 N·m (1.8 kgf-m, 13.3 ft-lb)

Liquid gasket:

THREE BOND 1324 (Part No. 004403042) or equivalent

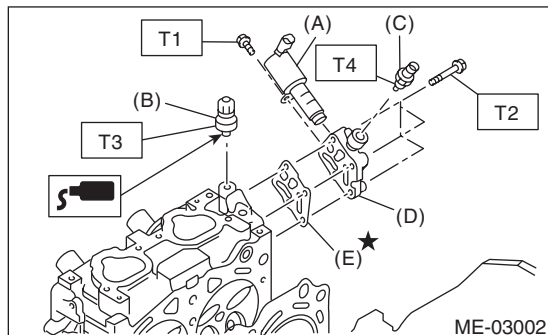

- (A) Oil switching solenoid valve
- (B) Variable valve lift diagnosis oil pressure switch
- (C) Oil temperature sensor
- (D) Oil switching solenoid valve holder
- (E) Gasket

Tightening torque:

6.4 N·m (0.7 kgf-m, 4.7 ft-lb)

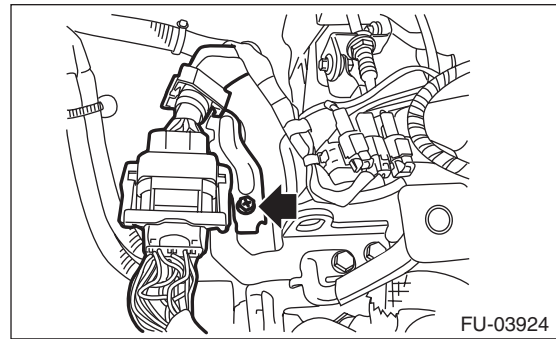

2. LH SIDE

Install in the reverse order of removal.

NOTE:

- Use a new gasket.
- Apply liquid gasket to variable valve lift diagnosis oil pressure switch threads.
- Install the oil switching solenoid valve to the holder, then install it to the cylinder head.

Tightening torque:

T1: 6.4 N·m (0.7 kgf-m, 4.7 ft-lb)

T2: 10 N·m (1.0 kgf-m, 7.4 ft-lb)

T3: 17 N·m (1.7 kgf-m, 12.5 ft-lb)

Liquid gasket:

THREE BOND 1324 (Part No. 004403042) or equivalent

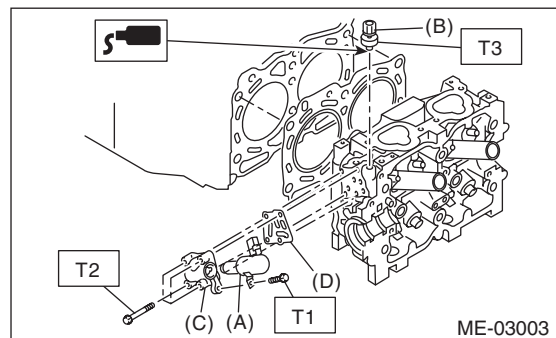

- (A) Oil switching solenoid valve
- (B) Variable valve lift diagnosis oil pressure switch
- (C) Oil temperature sensor
- (D) Oil switching solenoid valve holder
- (E) Gasket