

Front Oxygen (A/F) Sensor

FUEL INJECTION (FUEL SYSTEMS)

15.Front Oxygen (A/F) Sensor

A: REMOVAL

- 1) Disconnect the ground cable from battery.

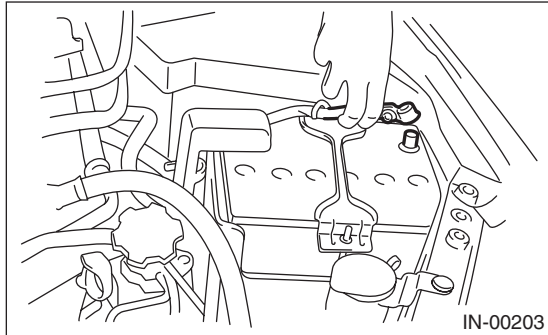

- 2) Remove the air intake duct. <Ref. to IN(H4SO)-8, REMOVAL, Air Intake Duct.>
- 3) Disconnect the front oxygen (A/F) sensor connector, and remove the clip holding the front oxygen (A/F) sensor harness.

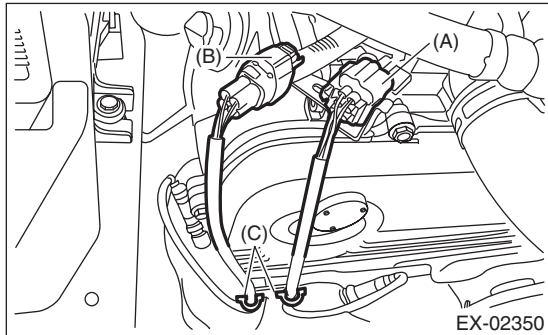

- (A) Front oxygen (A/F) sensor connector
- (B) Rear oxygen sensor connector
- (C) Clip

- 4) Lift up the vehicle.
- 5) Remove the under cover. <Ref. to EI-24, REMOVAL, Front Under Cover.>
- 6) Apply spray-type lubricant to the threaded portion of front oxygen (A/F) sensor, and leave it for one minute or more.
- 7) Remove the front oxygen (A/F) sensor.

CAUTION:

When removing the front oxygen (A/F) sensor, wait until exhaust pipe cools, otherwise it will damage the exhaust pipe.

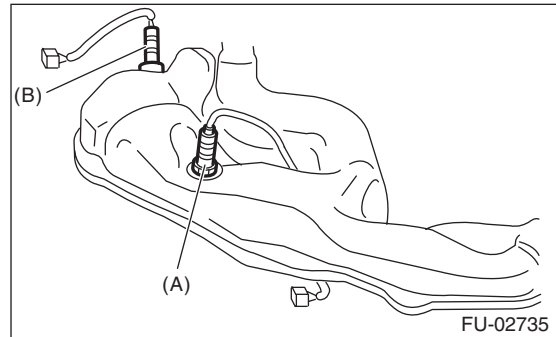

- (A) Front oxygen (A/F) sensor
- (B) Rear oxygen sensor

B: INSTALLATION

CAUTION:

If lubricant is spilt onto the exhaust pipe, wipe it off completely with cloth to avoid emission of smoke or causing a fire.

- 1) Before installing front oxygen (A/F) sensor, apply anti-seize compound only to the threaded portion of front oxygen (A/F) sensor to make the next removal easier.

CAUTION:

Never apply anti-seize compound to the protector of front oxygen (A/F) sensor.

Anti-seize compound:

NEVER-SEEZ NSN, JET LUBE SS-30 or equivalent

- 2) Install the front oxygen (A/F) sensor.

Tightening torque:

21 N·m (2.1 kgf-m, 15.5 ft-lb)

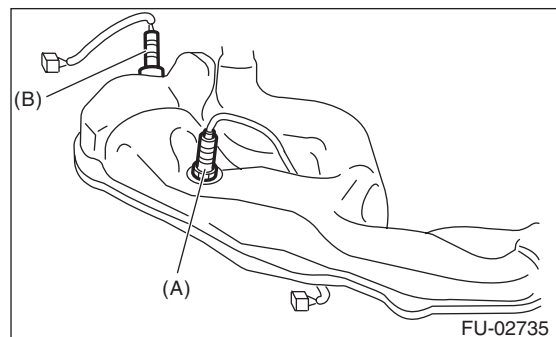

- (A) Front oxygen (A/F) sensor
- (B) Rear oxygen sensor

Front Oxygen (A/F) Sensor

FUEL INJECTION (FUEL SYSTEMS)

3) Install the under cover. <Ref. to EI-24, INSTALLATION, Front Under Cover.>

4) Lower the vehicle.

5) Connect the front oxygen (A/F) sensor connector, and secure the front oxygen (A/F) sensor harness by using the clip.

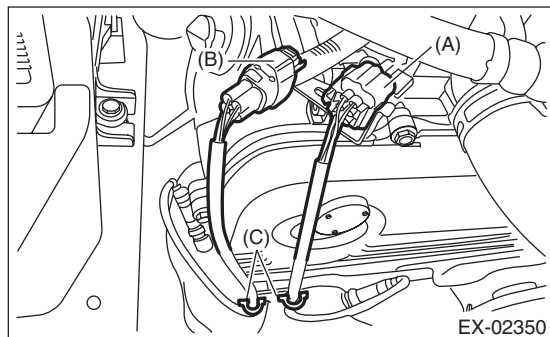

(A) Front oxygen (A/F) sensor connector

(B) Rear oxygen sensor connector

(C) Clip

6) Install the air intake duct. <Ref. to IN(H4SO)-8, INSTALLATION, Air Intake Duct.>

7) Connect the battery ground terminal.

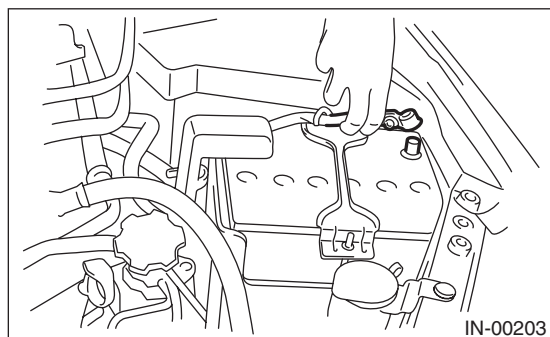

C: INSPECTION

1) Check that the front oxygen (A/F) sensor has no deformation, cracks or other damages.

2) Measure the resistance between front oxygen (A/F) sensor terminals.

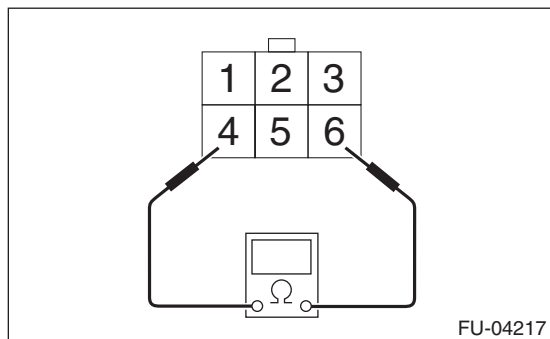

Terminal No.	Standard
4 and 6	$2.4 \pm 0.24 \Omega$ (20°C (68°F))