

# Front Exhaust Pipe

## EXHAUST

### 2. Front Exhaust Pipe

#### A: REMOVAL

##### CAUTION:

Vehicle components are extremely hot after driving. Be wary of receiving burns from heated parts.

- 1) Disconnect the ground cable from battery.

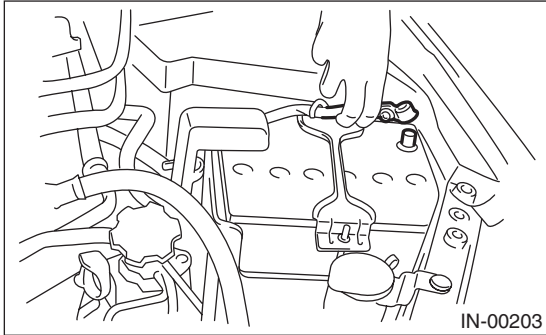

- 2) Remove the air intake duct. <Ref. to IN(H4SO)-8, REMOVAL, Air Intake Duct.>  
3) Disconnect the front oxygen (A/F) sensor connector (A) and rear oxygen sensor connector (B) and remove the clip (C) fastening the harness.

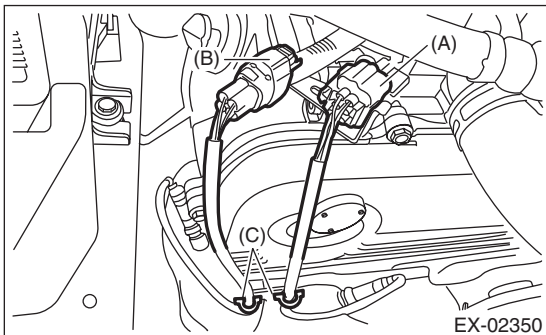

- 4) Lift up the vehicle.  
5) Remove the under cover. <Ref. to EI-24, REMOVAL, Front Under Cover.>  
6) Remove the rear exhaust pipe from center exhaust pipe.

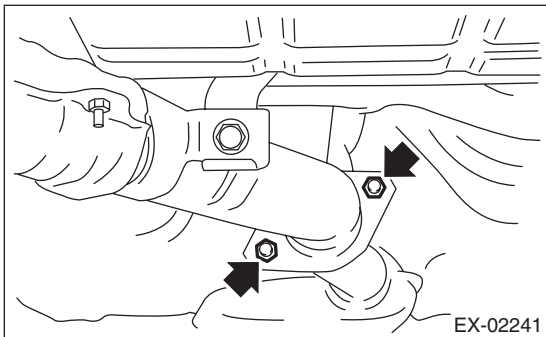

- 7) Remove the nuts which hold front exhaust pipe onto cylinder heads.

##### CAUTION:

Be careful not to drop the front exhaust pipe and center exhaust pipe assembly.

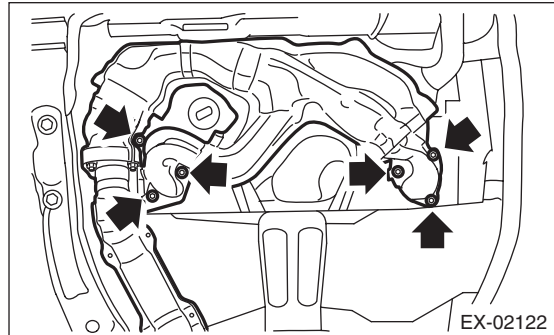

- 8) Remove the bolt which holds center exhaust pipe to hanger bracket.

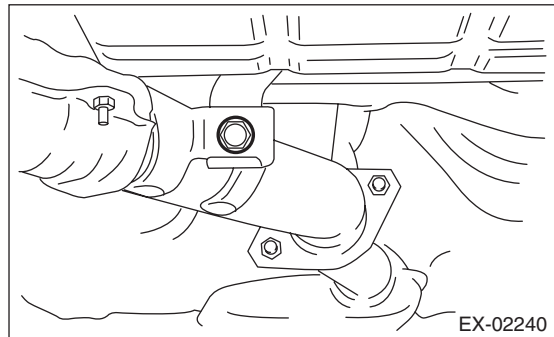

- 9) Remove the front exhaust pipe and center exhaust pipe from vehicle as a unit.

##### CAUTION:

- The front exhaust pipe and center exhaust pipe assembly are very heavy. Be careful not to drop the exhaust pipes when removing.
- After removing the front exhaust pipe and center exhaust pipe assembly, do not pull the rear exhaust pipe with excessive force.

- 10) Remove the center exhaust pipe from front exhaust pipe.

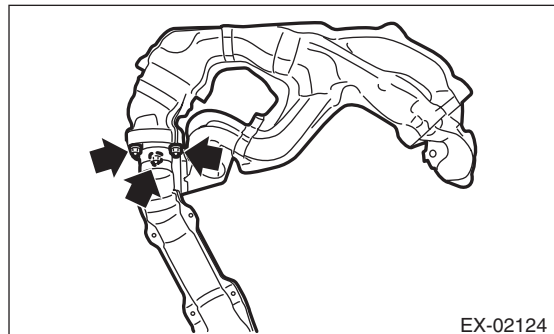

- 11) Remove the front oxygen (A/F) sensor and rear oxygen sensor from front exhaust pipe. <Ref. to FU(H4SO)-42, REMOVAL, Front Oxygen (A/F) Sensor.> <Ref. to FU(H4SO)-44, REMOVAL, Rear Oxygen Sensor.>

## B: INSTALLATION

1) Install the front oxygen (A/F) sensor and rear oxygen sensor to the front exhaust pipe. <Ref. to FU(H4SO)-42, INSTALLATION, Front Oxygen (A/F) Sensor.> <Ref. to FU(H4SO)-44, INSTALLATION, Rear Oxygen Sensor.>

2) Install the center exhaust pipe to front exhaust pipe.

NOTE:

Use a new gasket.

**Tightening torque:**

**40 N·m (4.1 kgf-m, 29.5 ft-lb)**

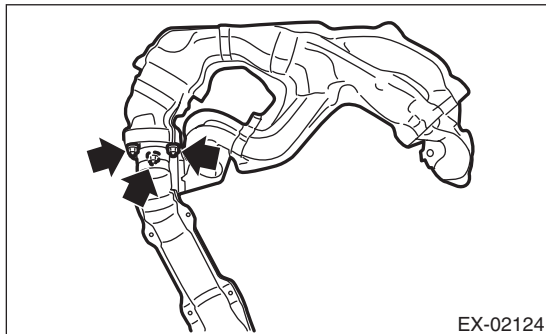

3) Install the front exhaust pipe and center exhaust pipe as a unit to the vehicle.

NOTE:

Use a new gasket.

4) Temporarily tighten the nuts which hold front exhaust pipe to cylinder heads.

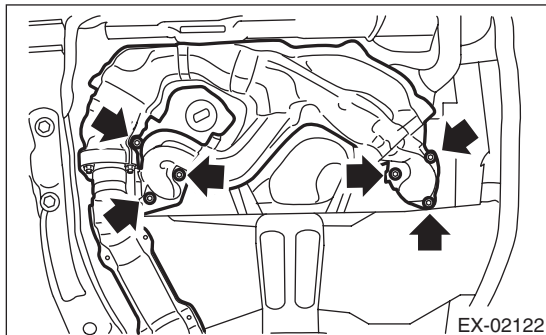

5) Install the rear exhaust pipe to center exhaust pipe.

NOTE:

Use a new gasket.

**Tightening torque:**

**18 N·m (1.8 kgf-m, 13.3 ft-lb)**

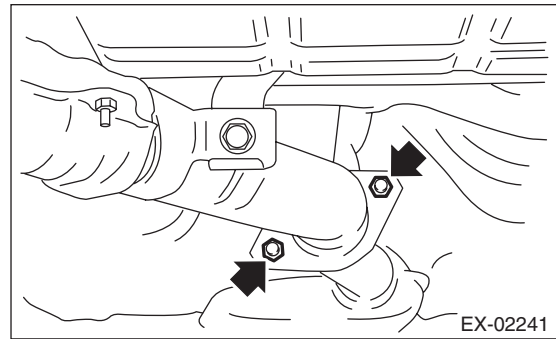

6) Tighten the bolts which secure the center exhaust pipe to the hanger bracket.

**Tightening torque:**

**35 N·m (3.6 kgf-m, 25.8 ft-lb)**

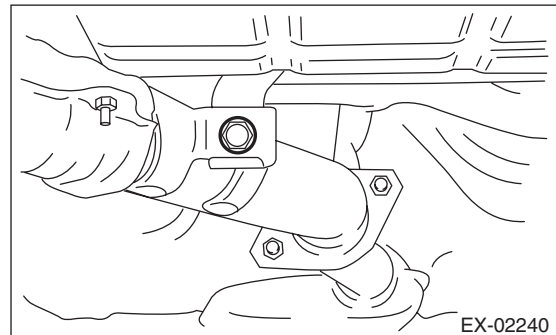

7) Tighten the nuts which hold front exhaust pipe to cylinder heads.

**Tightening torque:**

**30 N·m (3.1 kgf-m, 22.1 ft-lb)**

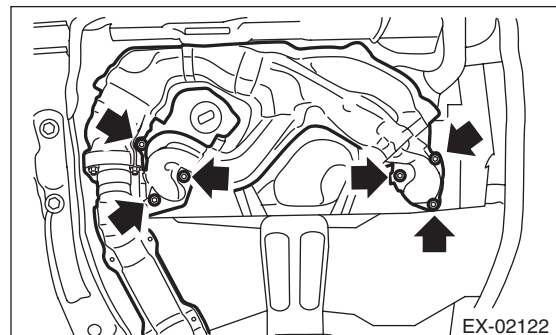

8) Install the under cover. <Ref. to EI-24, INSTALLATION, Front Under Cover.>

9) Lower the vehicle.

## Front Exhaust Pipe

### EXHAUST

---

10) Connect the front oxygen (A/F) sensor connector (A) and rear oxygen sensor connector (B), and fasten the harness with the clip (C).

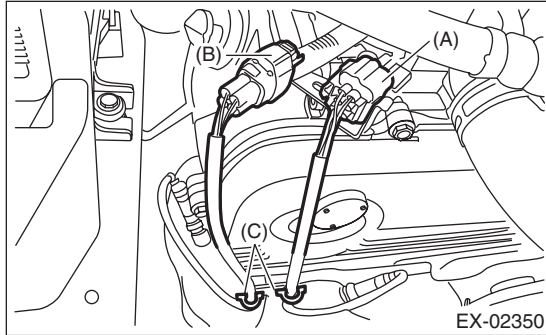

11) Install the air intake duct. <Ref. to IN(H4SO)-8, INSTALLATION, Air Intake Duct.>

12) Connect the battery ground terminal.

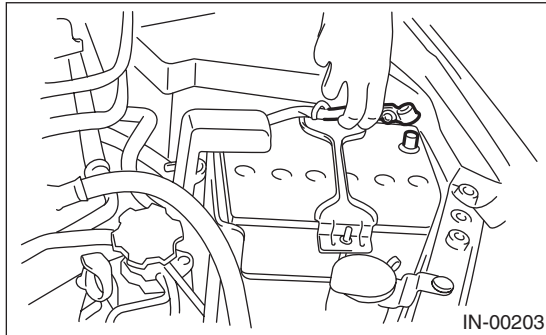

### C: INSPECTION

- 1) Check the connections and welds for exhaust leaks.
- 2) Make sure there are no holes or rusting.