

5. Upper Arm

A: REMOVAL

- 1) Remove the rear sub frame. <Ref. to RS-17, REMOVAL, Rear Sub Frame.>
- 2) Remove the rear ABS wheel speed sensor bracket.

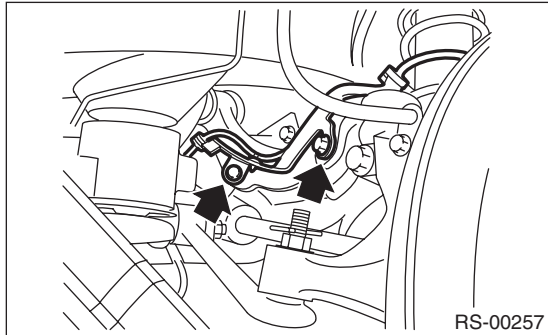

- 3) Remove the bolts, then remove the upper arm.

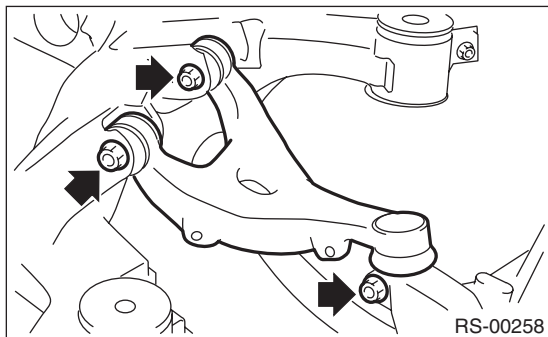

B: INSTALLATION

CAUTION:

- Be sure to use a new self-locking nut.
- Always tighten the bushing when the arm is positioned in the state where the vehicle is at curb weight and the wheels are in full contact with the ground.

- 1) Install each part in the reverse order of removal.
- 2) Inspect the wheel alignment and adjust if necessary.

Tightening torque:

Upper arm — Rear sub frame

150 N·m (15.3 kgf-m, 110.6 ft-lb)

Upper arm — Rear housing

80 N·m (8.2 kgf-m, 59 ft-lb)

Rear ABS wheel speed sensor bracket

7.5 N·m (0.76 kgf-m, 5.5 ft-lb)

C: INSPECTION

- 1) Visually check the upper arm for damage and deformation.
- 2) Visually check the bushing for abnormal cracks, fatigue or damage.