

## 16. Ignition Key Lock

### A: REPLACEMENT

- 1) Disconnect the ground cable from battery.
- 2) Remove the steering column. <Ref. to PS-15, REMOVAL, Tilt Steering Column.>
- 3) Secure the steering column in a vise. Remove the bolt with a drill.

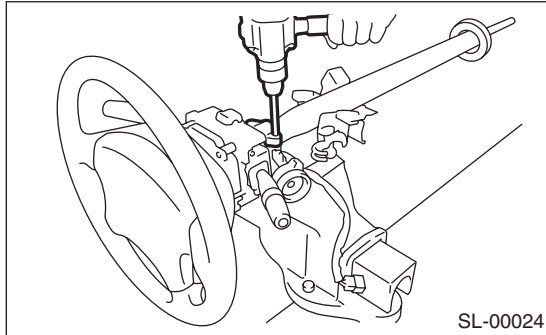

- 4) Remove the ignition key lock.
- 5) Use new bolts. Tighten the bolt until the bolt head is broken (bolt head wrenched off).

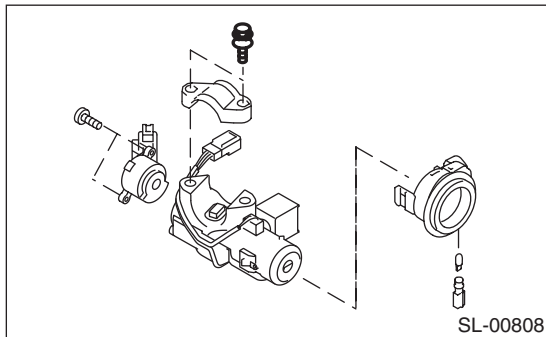

### B: INSPECTION

- 1) Remove the instrument panel lower cover.
- 2) Remove the lower column cover.
- 3) Unfasten the fixing clip which secures harness, and then disconnect the connector of the ignition switch from body harness.
- 4) Turn the ignition key plate to each position and check the continuity between terminals of ignition connector.

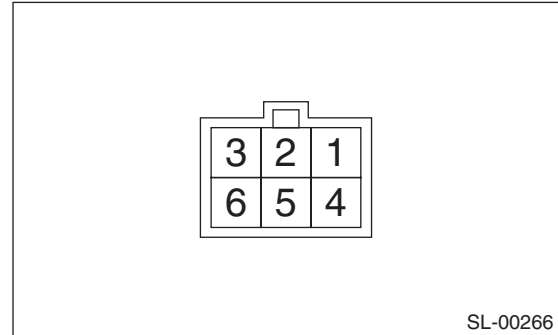

| Switch position | Terminal No.             | Standard             |
|-----------------|--------------------------|----------------------|
| LOCK            | —                        | —                    |
| ACC             | 3 and 5                  | Less than 1 $\Omega$ |
| ON              | 3 and 1 and 4<br>3 and 5 | Less than 1 $\Omega$ |
| ST              | 3 and 2<br>3 and 1 and 6 | Less than 1 $\Omega$ |

- 5) Replace the ignition switch if it is found defective.