

12.Protector Tape

A: INSTALLATION

Adhere the protector tape to position, follow the procedures below.

- 1) Open the rear door and moisten around the adhering position by using liquid such as mild detergent solution.
- 2) Peel away the backing paper of (a).
- 3) Align the application tape to the position shown in the following figure.
- 4) Peel away the film of (a).
- 5) Peel away the backing paper of (b) and adhere the protector tape to the vehicle body.

CAUTION:

Remove the water or air bubbles out of the protector tape by using the plastic or rubber spatula.

- 6) Get rid of water and air bubbles in the protector tape and remove the application tape and the film.

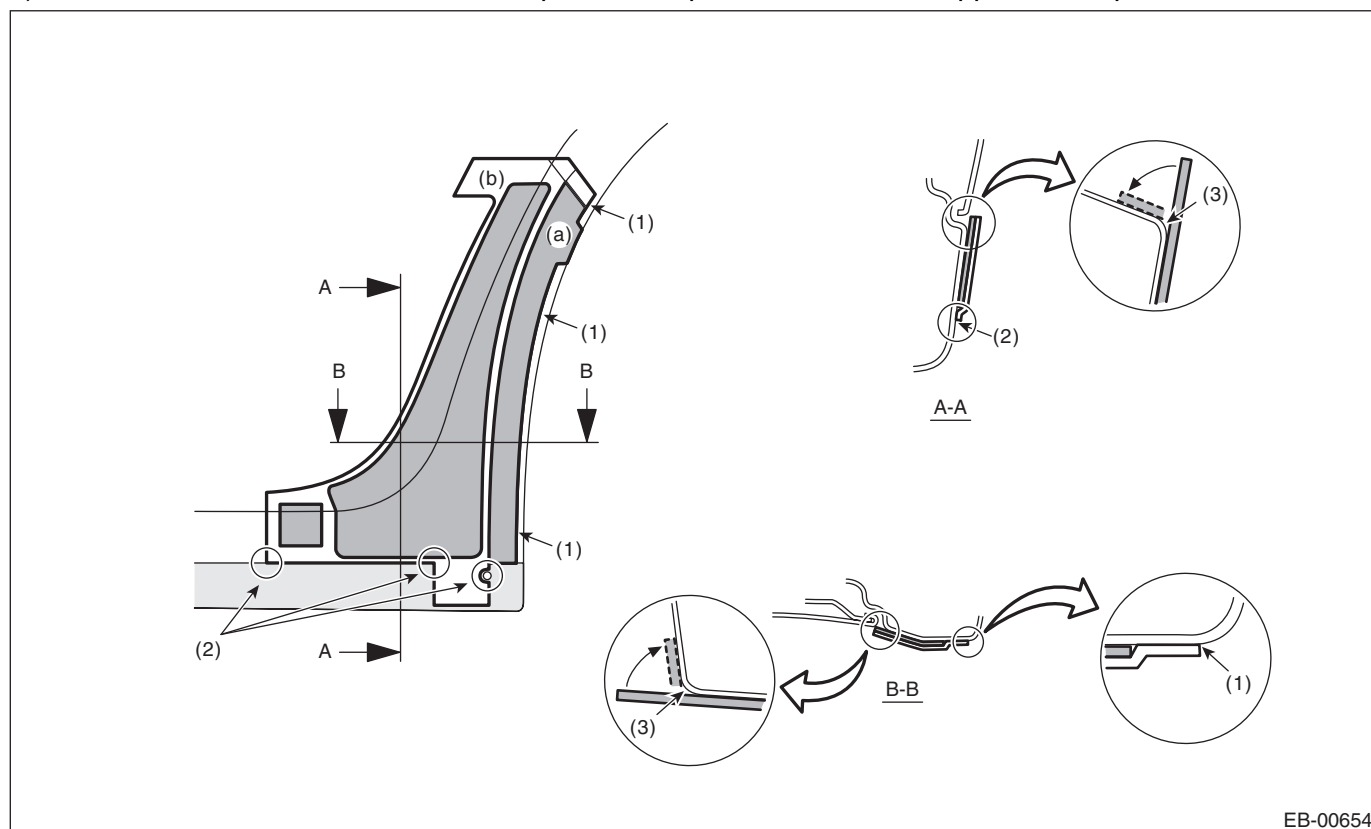

EB-00654

- | | | |
|---|--|---|
| <p>(1) Align the application paper to the rounded edge of rear quarter panel.</p> | <p>(2) Align the PCV coat terminal to application paper.
Align the cutout of the application sheet to the side sill spoiler mounting hole. (Model with side sill spoilers)</p> | <p>(3) Apply the protector tape by aligning it to the rounded edge.</p> |
|---|--|---|

CRUISE CONTROL SYSTEM

CC

	Page
1. General Description	2
2. Cruise Control System	4
3. Cruise Control Module	5
4. Cruise Control Command Switch	6
5. Combination Meter	8
6. Stop Light & Brake Switch	9
7. Clutch Switch	10
8. Transmission Control Module (TCM)	11
9. Inhibitor Switch	12
10. Neutral Position Switch	13