

12.Satellite Safing Sensor

A: REMOVAL

- 1) Turn the ignition switch to OFF.
- 2) Disconnect the ground cable from battery and wait for at least 60 seconds before starting work.
- 3) Remove the rear seat cushion. <Ref. to SE-13, REMOVAL, Rear Seat.>
- 4) Remove the satellite safing sensor cover.

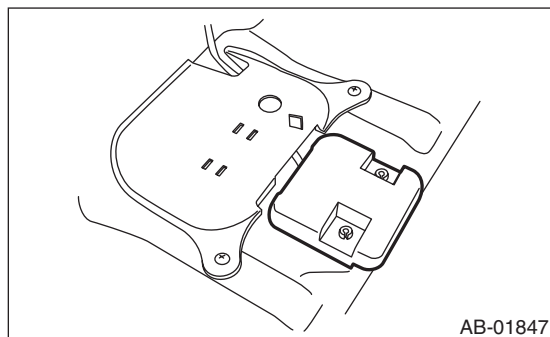

- 5) Remove the nut, and remove the satellite safing sensor.

CAUTION:

Do not separate the satellite safing sensor and bracket. Doing so will cause the airbag system malfunction. If the sensor is removed from the bracket, be sure to replace with a new part.

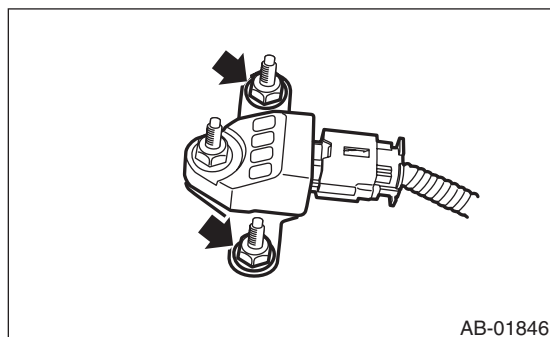

- 6) Disconnect the airbag connector.

B: INSTALLATION

CAUTION:

- Do not reuse the bolt and nut.
- Always replace with the specified new bolts and nuts.**
- When installing the satellite safing sensor cover, push the cover securely until it contacts the floor panel.
 - If the satellite safing sensor cover is too loose at its mounting portion to remove easily, replace with a new satellite safing sensor cover.
 - After installing the satellite safing sensor cover, make sure that the sensor harness does not get caught.
- Install each part in the reverse order of removal.

Tightening torque:

7.5 N·m (0.76 kgf-m, 5.5 ft-lb)

C: INSPECTION

Check for the following, and replace the damaged parts with new parts.

- Mounting bracket or connector of satellite safing sensor is damaged.
- The satellite safing sensor cover is damaged
- Side airbag or curtain airbag has been activated.