

# Switches and Harness

## MANUAL TRANSMISSION AND DIFFERENTIAL

### 7. Switches and Harness

#### A: REMOVAL

##### 1. BACK-UP LIGHT AND NEUTRAL POSITION SWITCH

- 1) Disconnect the ground cable from battery.
- 2) Remove the air intake chamber and intake boot. (non-turbo model) <Ref. to IN(H4SO)-7, REMOVAL, Air Intake Chamber.>
- 3) Remove the intercooler. (Turbo model) <Ref. to IN(H4DOTC)-13, REMOVAL, Intercooler.>
- 4) Disconnect the connector back-up light switch & neutral position switch.

- Non-turbo model

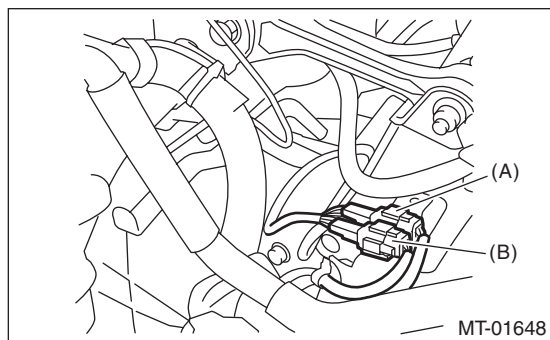

- (A) Neutral position switch connector (Brown)  
(B) Back-up light switch connector (Gray)

- Turbo model

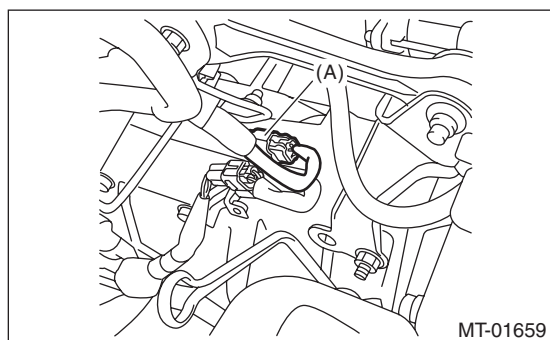

- (A) Neutral position switch and back-up light switch connector

5) Lift up the vehicle.

6) Remove the back-up light switch & neutral position switch with the harness.

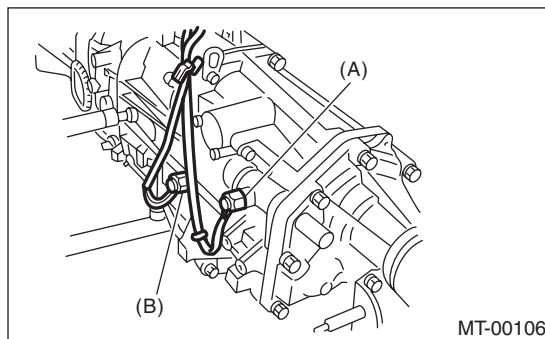

- (A) Neutral position switch  
(B) Back-up light switch

#### B: INSTALLATION

##### 1. BACK-UP LIGHT AND NEUTRAL POSITION SWITCH

- 1) Install the back-up light switch & neutral position switch with the harness.

**Tightening torque:**

**32.3 N·m (3.3 kgf-m, 23.8 ft-lb)**

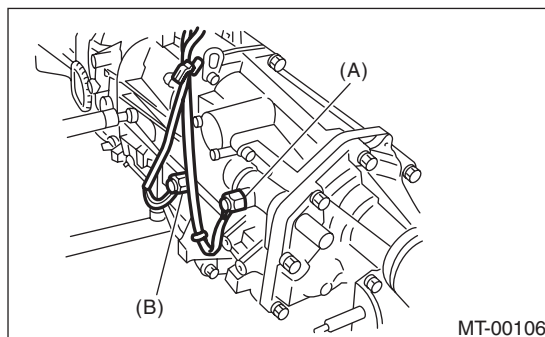

- (A) Neutral position switch  
(B) Back-up light switch

- 2) Connect the connectors of back-up light switch & neutral position switch.
- 3) Install the air intake chamber and intake boot. (non-turbo model) <Ref. to IN(H4SO)-7, INSTALLATION, Air Intake Chamber.>
- 4) Install the intercooler. (Turbo model) <Ref. to IN(H4DOTC)-13, INSTALLATION, Intercooler.>
- 5) Connect the ground cable to battery.

### C: INSPECTION

#### 1. BACK-UP LIGHT SWITCH

Check the back-up light switch. <Ref. to LI-8, INSPECTION, Back-up Light System.>

#### 2. NEUTRAL POSITION SWITCH

- 1) Turn the ignition switch to OFF.
- 2) Disconnect the connector of neutral position switch.
- 3) Measure the resistance between neutral position switch terminals.

- Non-turbo model

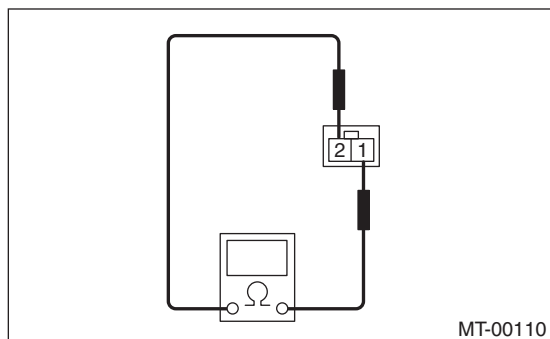

Gear shift position	Terminal No.	Specified resistance
Neutral position	1 and 2	Less than 1 $\Omega$
Other positions		1 M $\Omega$ or more

- Turbo model

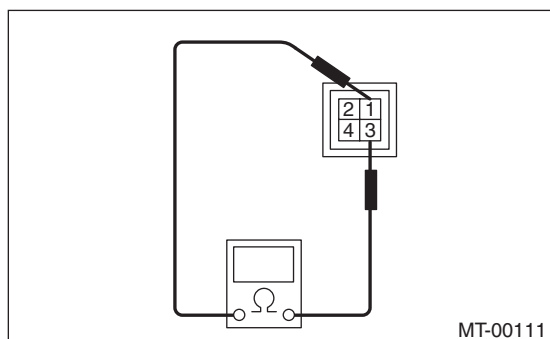

Gear shift position	Terminal No.	Specified resistance
Neutral position	1 and 3	Less than 1 $\Omega$
Other positions		1 M $\Omega$ or more

- 4) Replace faulty parts.