

5. AT Shift Lock Solenoid and “P” Range Switch

A: REMOVAL

- 1) Disconnect the ground cable from battery.
- 2) Remove the grip.
- 3) Remove the parking brake lever boot.
- 4) Remove the console front panel.

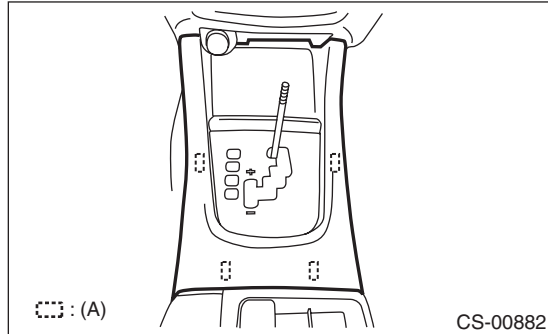

(A) Hook

- 5) Remove the console cover and console box.
<Ref. to EI-48, REMOVAL, Console Box.>
- 6) Remove the indicator assembly.

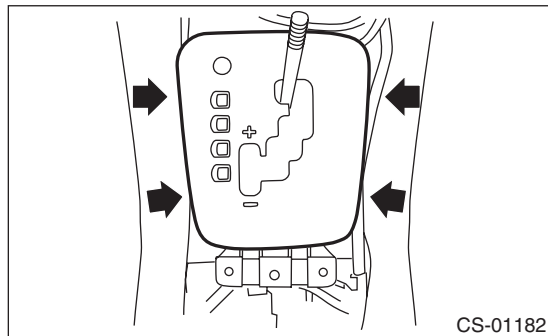

- 7) While pressing the shift lock release button, shift the select lever to the “N” range.
- 8) Remove the spacer bolt and remove the plate guide COMPL.

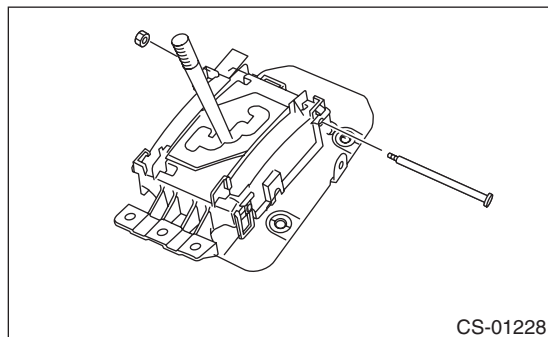

- 9) Using a flat tip screwdriver with a thin tip, remove the connector from the plate COMPL.

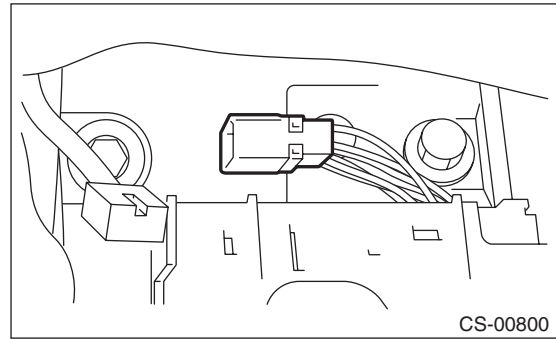

- 10) With detent spring lifted up, push the select lever backward and remove the shift lock solenoid unit.

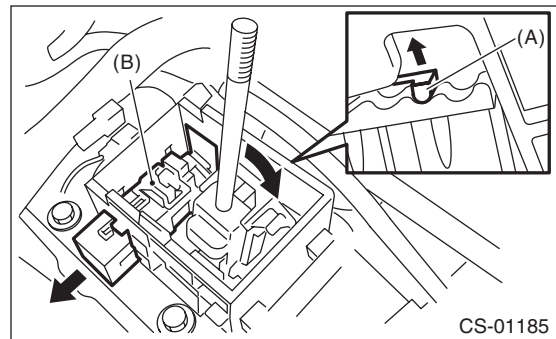

- (A) Detent spring
(B) Shift lock solenoid unit

- 11) Raise the claw of connector.

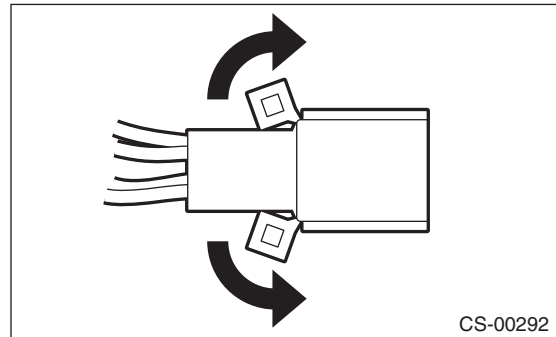

AT Shift Lock Solenoid and “P” Range Switch

CONTROL SYSTEMS

12) Using a flat tip screwdriver with a thin tip, disconnect the terminals of “P” range switch and shift lock solenoid unit from the connector.

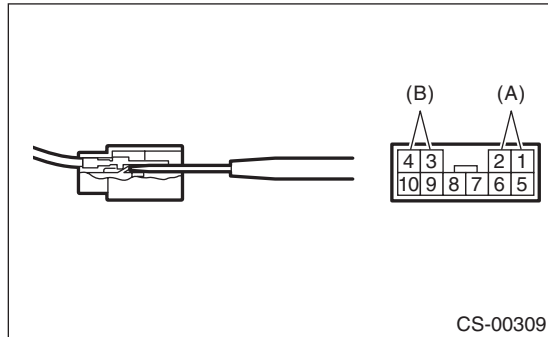

- (A) “P” range switch terminal
- (B) Shift lock solenoid terminal

- Connect the switch and solenoid terminals to the connector.

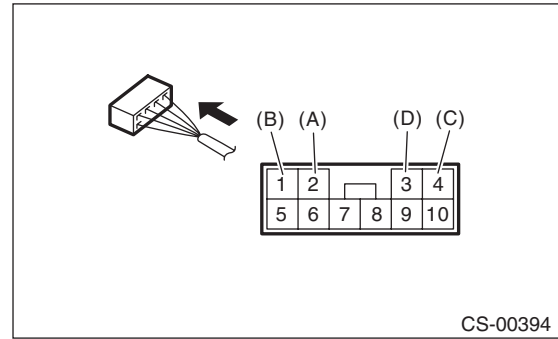

- (A) “P” range switch (color code: red)
- (B) “P” range switch (color code: red)
- (C) Shift lock solenoid (color code: black)
- (D) Shift lock solenoid (color code: blue/red)

B: INSTALLATION

Install in the reverse order of removal.

NOTE:

- Refer to “COMPONENT” for each tightening torque. <Ref. to CS-3, COMPONENT, General Description.>
- When installing the plate guide COMPL, set the select lever to the “D” range (normal mode position), and be careful for the following points.
 - Insert protrusion (B) of the plate guide COMPL into the hole on the shift lock solenoid unit (A).
 - Insert link (D) of the shift lock release into link (C) of the shift lock solenoid unit.

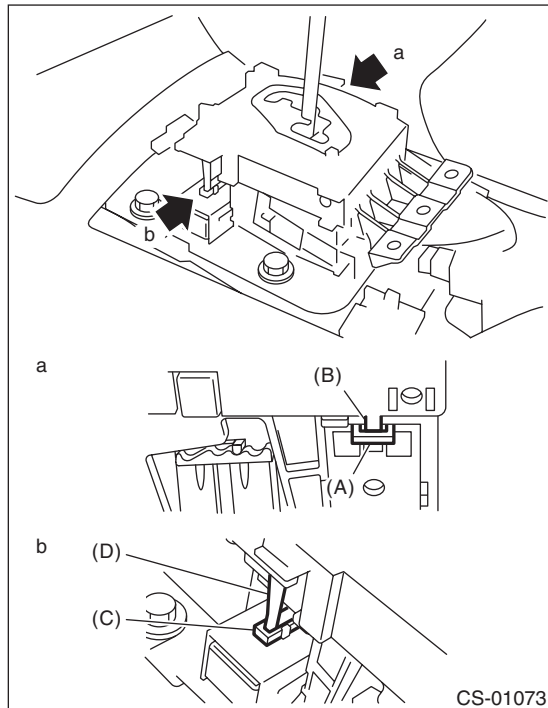

AT Shift Lock Solenoid and “P” Range Switch

CONTROL SYSTEMS

C: INSPECTION

	Step	Check	Yes	No
1	CHECK SHIFT LOCK SOLENOID. Measure the resistance of shift lock solenoid connector terminals. <i>Terminals</i> <i>No. 4 — No. 3:</i>	Is the resistance 19.8 — 24.2 Ω ?	Go to step 2.	Replace the shift lock solenoid.
2	CHECK SHIFT LOCK SOLENOID. Connect the battery to shift lock solenoid connector terminal, and then operate the solenoid. <i>Terminals</i> <i>No. 3 (+) — No. 4 (-):</i>	Does the shift lock solenoid operate normally?	Go to step 3.	Replace the shift lock solenoid.
3	CHECK P RANGE SWITCH. 1) Shift the select lever to “P” range. 2) Measure the resistance between “P” range switch connector terminals. <i>Terminals</i> <i>No. 1 — No. 2:</i>	Is the resistance less than 1 Ω ?	Go to step 4.	Replace the P range switch.
4	CHECK P RANGE SWITCH. 1) Set the select lever to other than “P” range. 2) Measure the resistance between “P” range switch connector terminals. <i>Terminals</i> <i>No. 1 — No. 2:</i>	Is the resistance 1 M Ω or more?	Normal	Replace the P range switch.