

7. Clutch Pipe and Hose

A: REMOVAL

- 1) Remove the air intake chamber. (non-turbo model) <Ref. to IN(H4SO)-7, REMOVAL, Air Intake Chamber.>
- 2) Remove the intercooler. (Turbo model)
<Ref. to IN(H4DOTC)-13, REMOVAL, Intercooler.>
- 3) Drain the clutch fluid. <Ref. to CL-21, Clutch Fluid.>
- 4) Disconnect the clutch pipe from the clutch hose and master cylinder.
- 5) Pull out the clamp, then disconnect the clutch hose from the bracket.

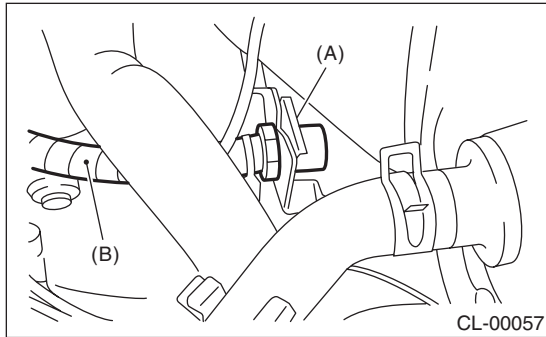

- (A) Clamp
(B) Clutch hose

- 6) Remove the hose from operating cylinder.
- 7) Remove the bracket.

B: INSTALLATION

Install in the reverse order of removal.

NOTE:

- The illustration below is suitable for every model. Perform the same procedures for the other models.
- Bleed air from the clutch fluid. <Ref. to CL-22, Clutch Fluid Air Bleeding.>

Tightening torque:

T1: 15 N·m (1.5 kgf-m, 11.1 ft-lb)

T2: 18 N·m (1.8 kgf-m, 13.3 ft-lb)

T3: 25 N·m (2.5 kgf-m, 18.4 ft-lb)

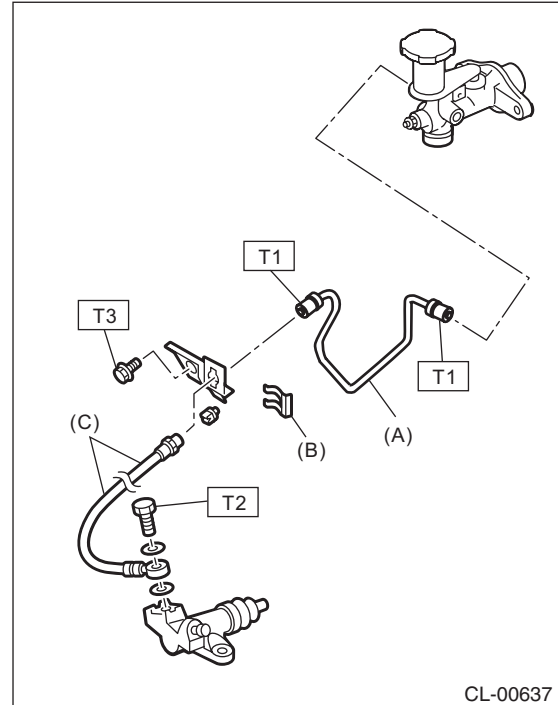

- (A) Clutch pipe
(B) Clip
(C) Clutch hose

C: INSPECTION

Check the pipes and hoses for breaks and damage. Check joints for fluid leakage. If crack, breakage or damage is found, repair or replace the faulty pipe or hose.