

### 25. Drive Plate

#### A: REMOVAL

1) Remove the transmission assembly from the vehicle. <Ref. to 4AT-34, REMOVAL, Automatic Transmission Assembly.>

2) Use the ST to lock the crankshaft, and remove the drive plate.

ST 498497100 CRANKSHAFT STOPPER

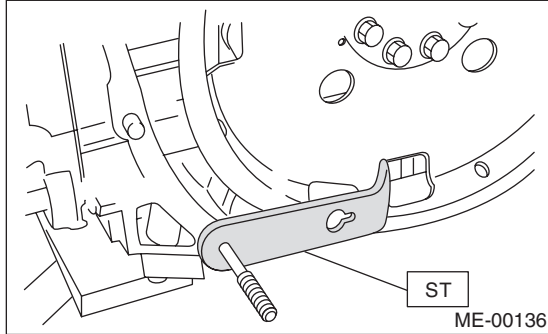

#### B: INSTALLATION

1) Using the ST, lock the crankshaft.

ST 498497100 CRANKSHAFT STOPPER

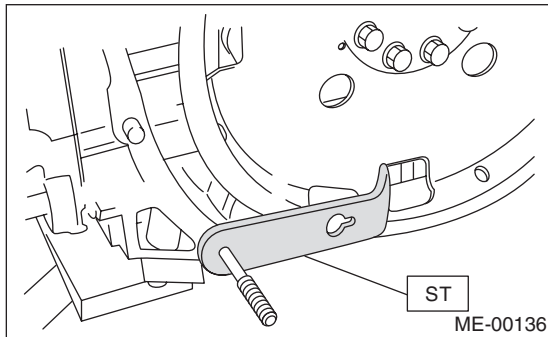

2) Tighten the drive plate in three stages.

(1) Temporarily tighten the drive plate.

#### **Tightening torque:**

**10 N·m (1.0 kgf-m, 7.4 ft-lb)**

(2) Additionally tighten the drive plate mounting bolts.

#### **Tightening torque:**

**40 N·m (4.1 kgf-m, 29.5 ft-lb)**

(3) While checking the tightening angle with the ST, further tighten the drive plate mounting bolts.

#### **Tightening angle:**

**30°±5°**

ST 1854AA000 ANGLE GAUGE

3) Install the transmission assembly to the vehicle. <Ref. to 4AT-37, INSTALLATION, Automatic Transmission Assembly.>