

NOTE

1. Note

A: NOTE

This information will improve the efficiency of maintenance and assure the sound work.

1. FASTENERS NOTICE

Fasteners must be tightened to the specified torque.

Do not apply paint, lubricant, rust retardant or other substance to the surface around bolts, nuts, etc. Doing so will make it difficult to obtain the correct torque and result in looseness and other problem.

2. STATIC ELECTRICITY DAMAGE

Always touch grounded metal for the elimination of static electricity before conducting work.

3. BATTERY

When removing the battery cables, always be sure to turn the ignition switch to OFF.

4. SERVICE PARTS

Use genuine parts for maximum performance and maintenance when conducting repairs. Subaru/FHI will not be responsible for poor performance resulting from the use of parts except for genuine parts.

5. PROTECTING VEHICLE UNDER MAINTENANCE

Make sure to attach the fender cover, seat covers, etc. before work.

6. ENSURING SECURITY DURING WORK

When working in a group of two or more, perform the work with calling each other to ensure mutual safety.

7. LIFT AND JACK

When using a lift or shop jack to raise a vehicle or using rigid rack to support a vehicle, always follow instructions concerning jack-up points and weight limits to prevent the vehicle from falling, which could result in injury. Be especially careful that the vehicle is balanced before raising it. Be sure to set the wheel stoppers when jacking-up only the front or rear side of the vehicle.

CAUTION:

Not to let the side sill cover interfere with the lift arm, use a lift attachment.

NOTE:

- When using a lift, follow its operation manual before work.
- When using, insert the body flange to the attachment groove.
- When the side sill cover contacts the lift arm, use a lift attachment.

- Do not work or leave unattended while the vehicle is supported with jack, support it with rigid racks.
- Be sure to use the rigid racks with rubber attached to cradle to support the vehicle.
- When using a plate lift, use a rubber attachment. (Model with side sill cover)

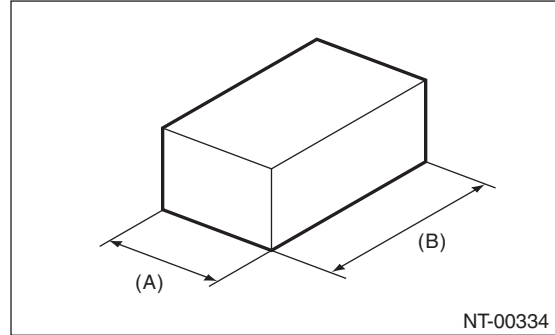

(A) Approx. 100 mm (3.94 in)

(B) 120 — 180 mm (4.72 — 7.01 in)

- Do not use the plate lift whose attachment does not reach the supporting locations.
The figure of vehicle indicates the supporting locations, supporting procedures, etc. for 5 door model, and they are same for 4 door model.
SUPPORT LOCATIONS

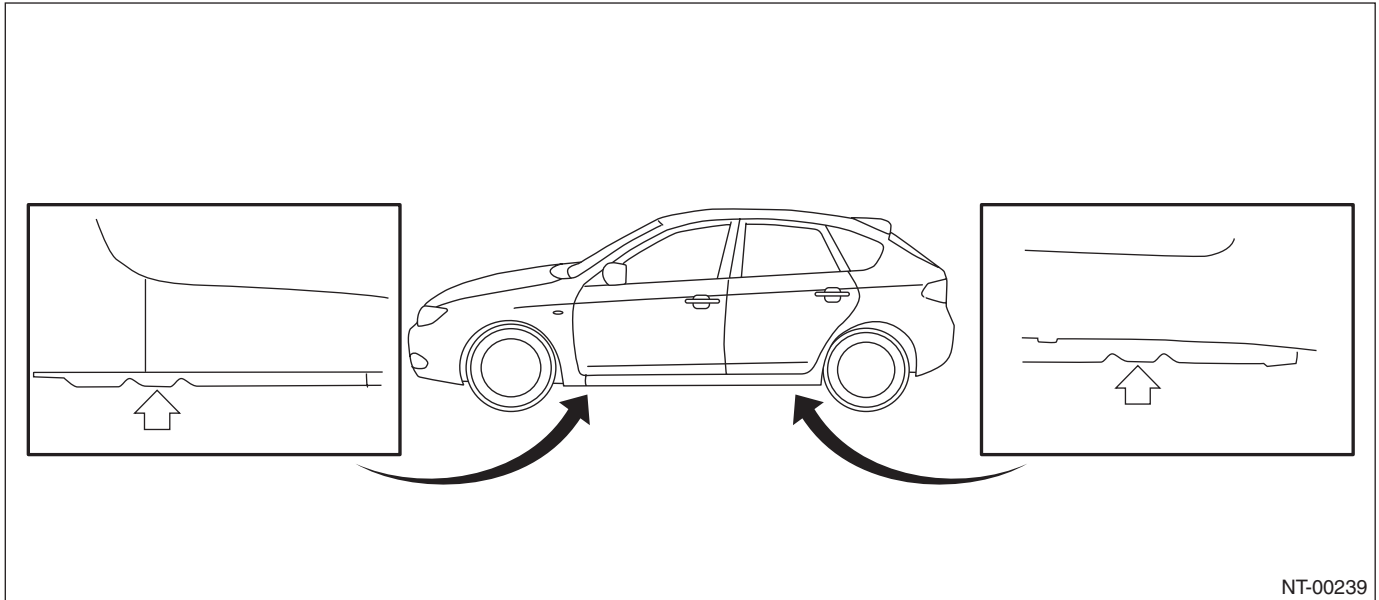

Pantograph jack

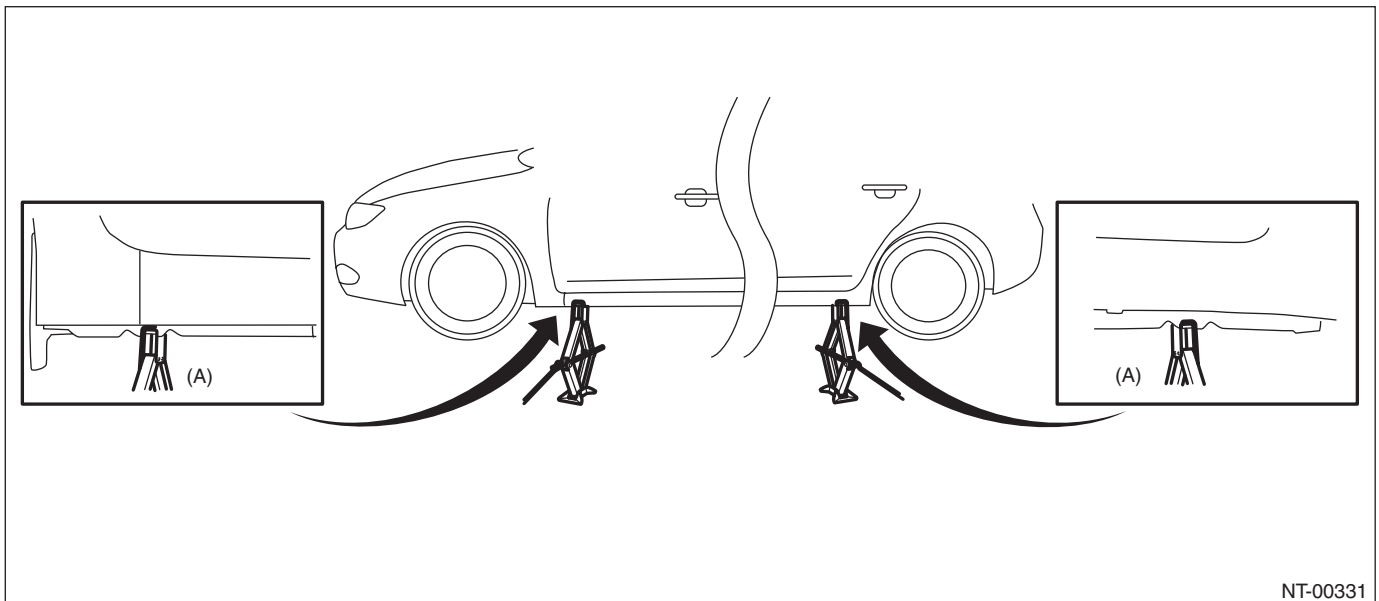

- (A) Set the jacks between cutout portions.

Note

NOTE

Lift

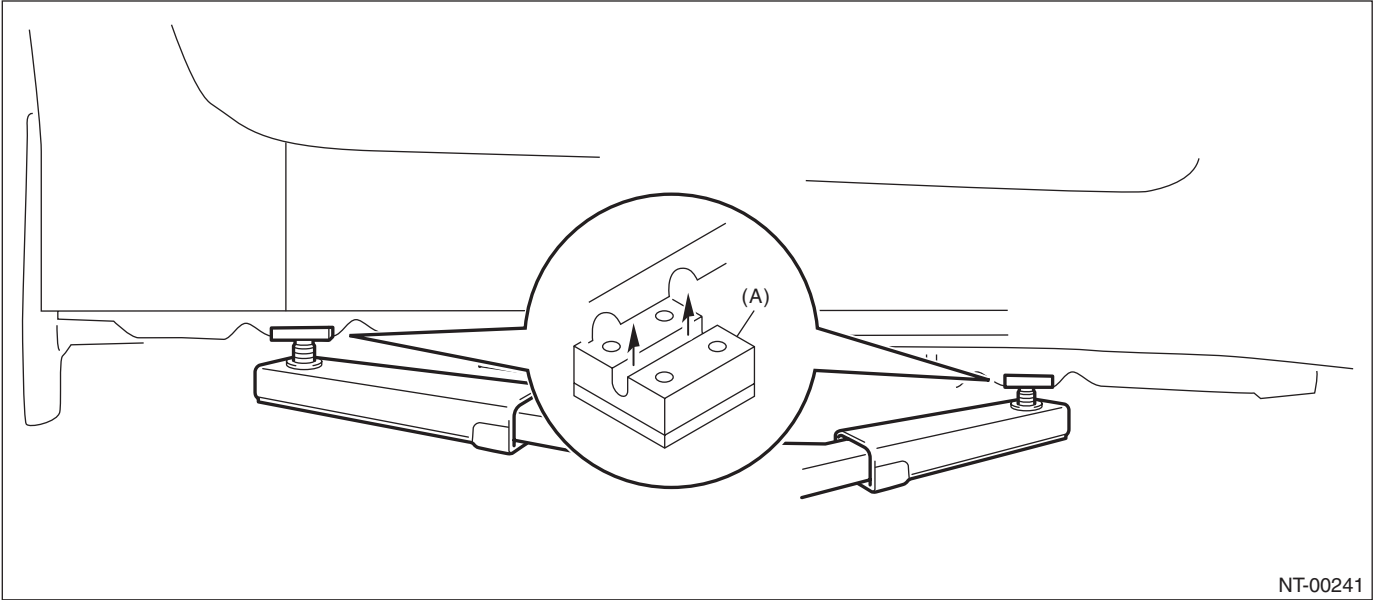

NT-00241

(A) Attachment
Rigid rack

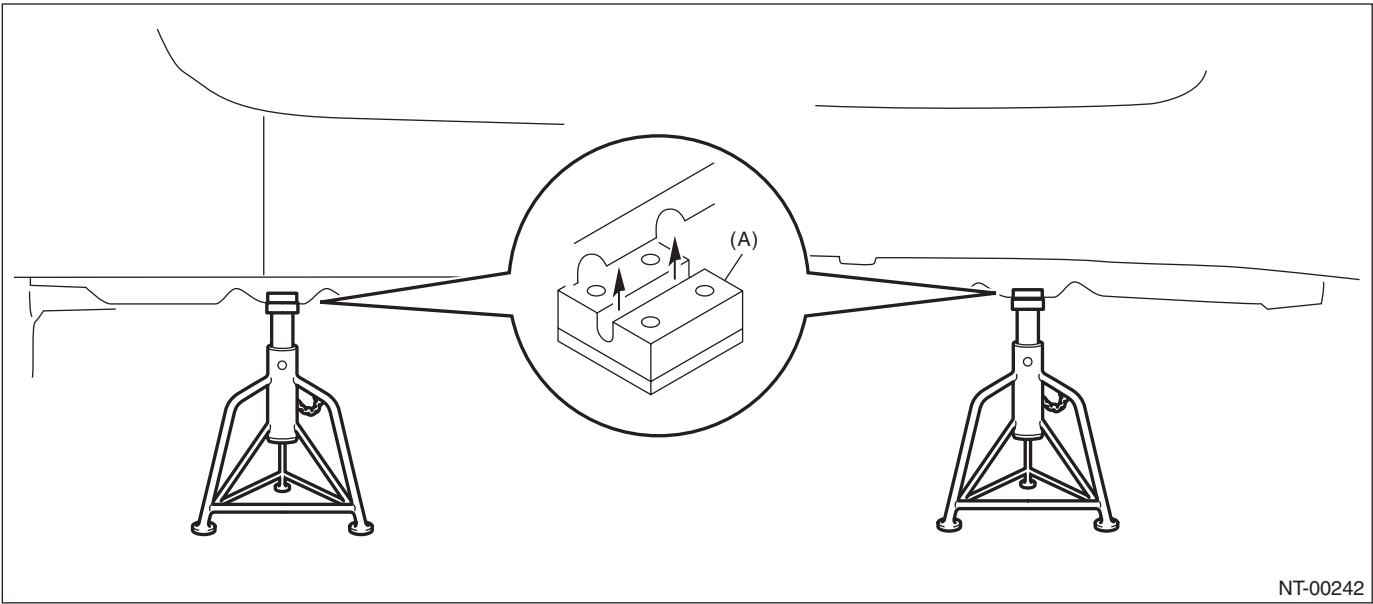

NT-00242

(A) Attachment

Plate lift

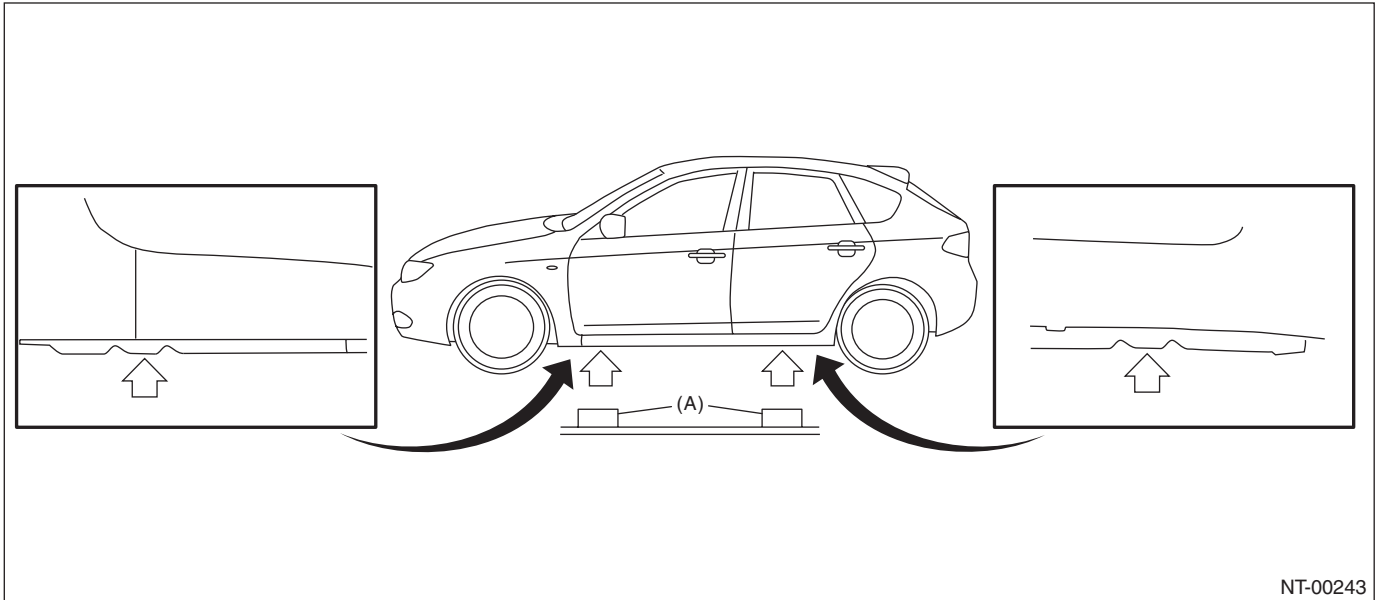

(A) Attachment

- Use the attachment by aligning its position as follows.

- Model without side sill spoiler

For the models without side sill spoiler, align the center of attachment with the center of vehicle cutout portions.

Front

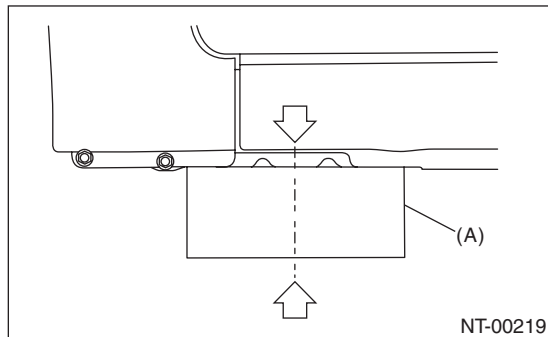

Rear

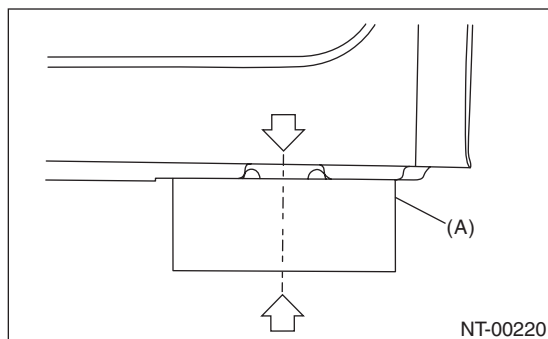

(A) Attachment

- Model with side sill spoiler

For the models with side sill spoiler, align the center of attachment with the center of vehicle cutout portion (the center of spoiler cutout portion).

Front

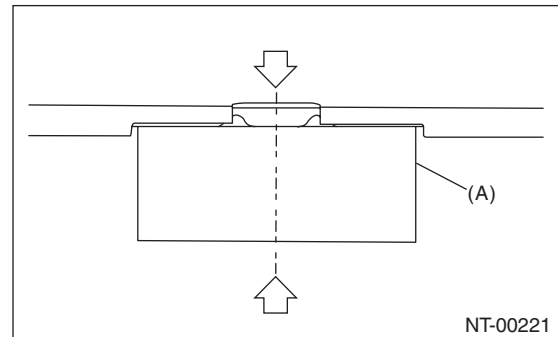

Rear

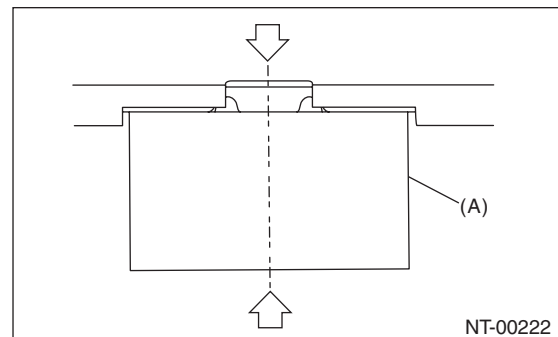

(A) Attachment

NOTE

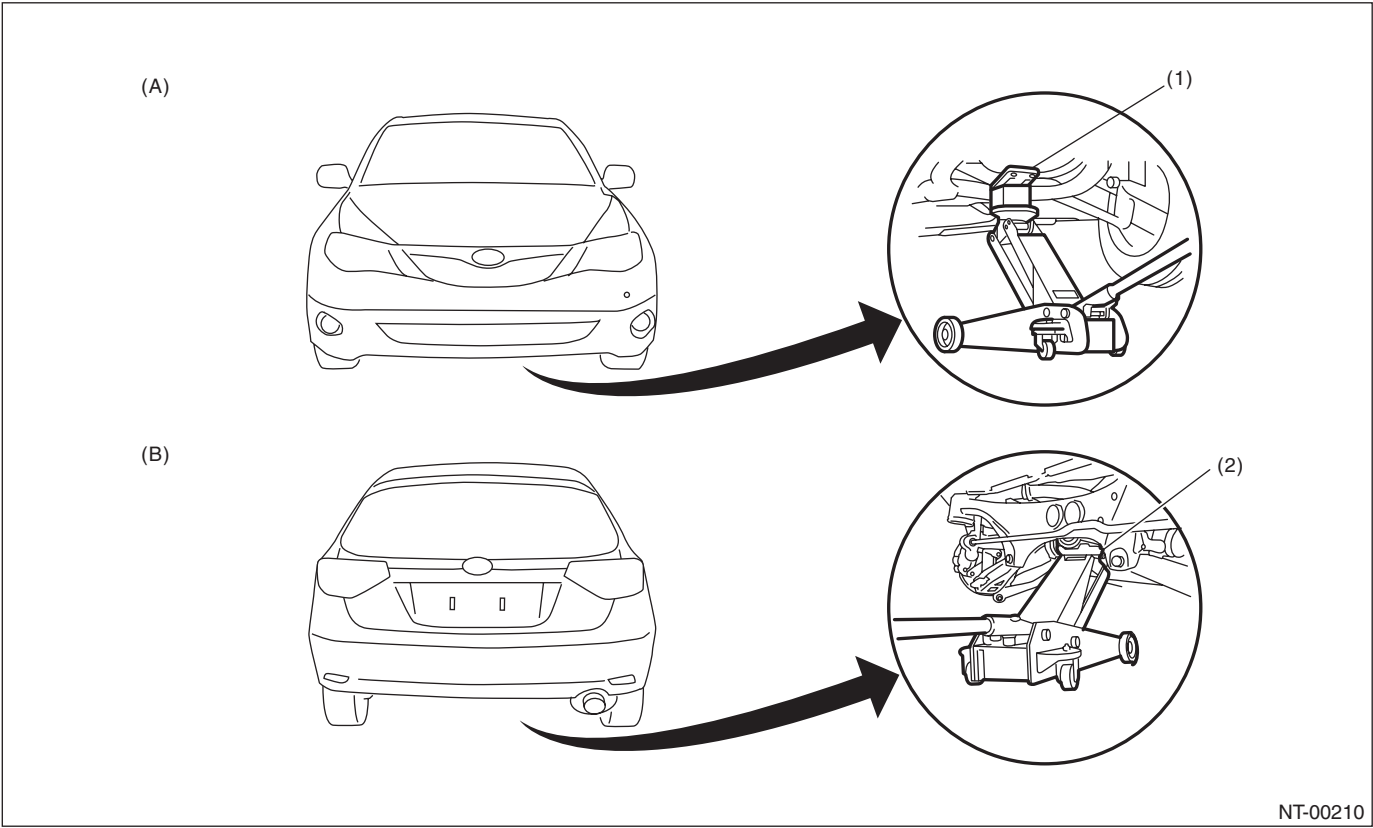

NT-00210

(A) Front

(B) Rear

(1) Front crossmember

(2) Rear differential

8. TIE-DOWNS

The tie-down hooks are used when transporting vehicles and when using the chassis dynamo. Attach tie-down only to the specified locations on the vehicle.

• TIE-DOWN LOCATION

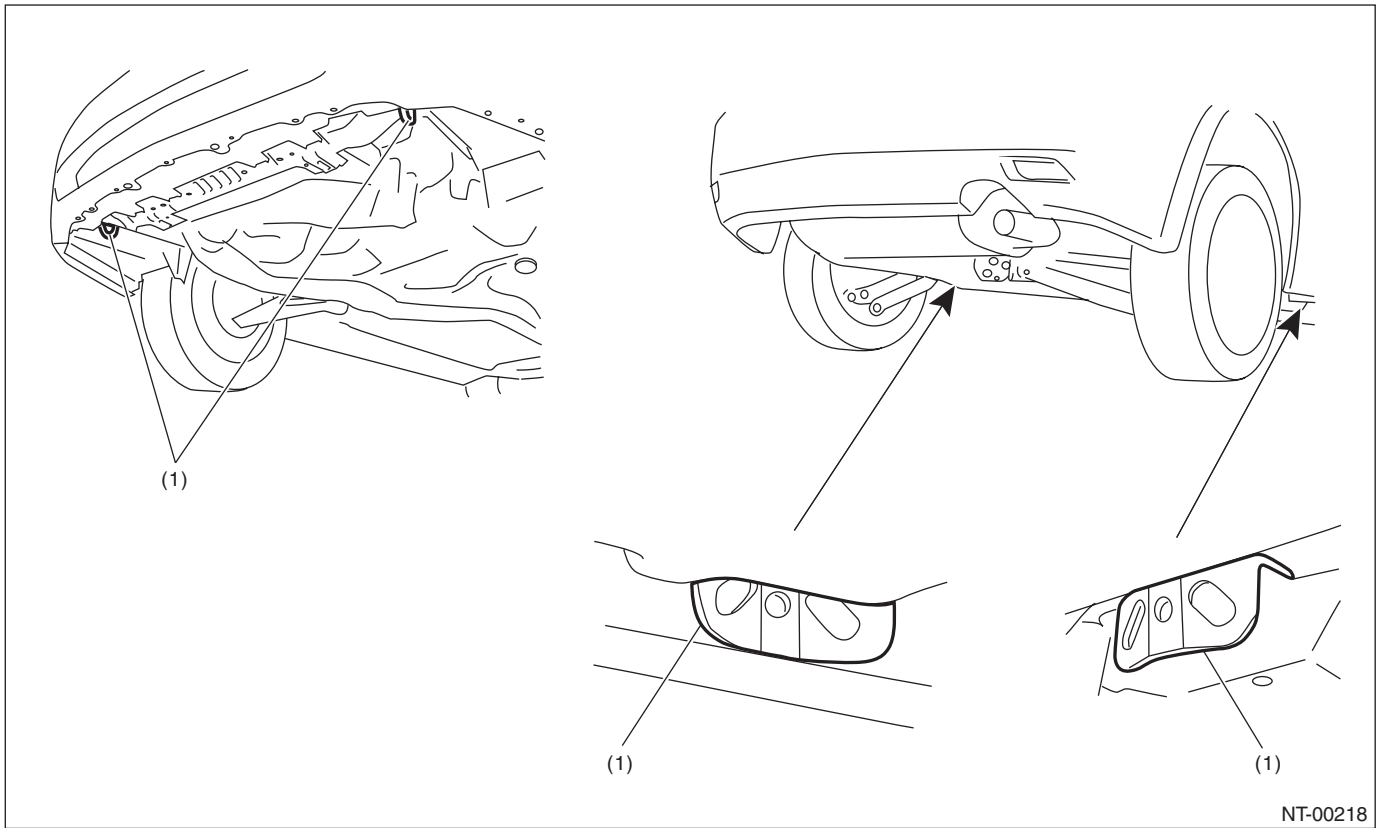

NT-00218

(1) Hook for tie-down

Note

NOTE

- TIE-DOWN HOOK & EYE BOLT

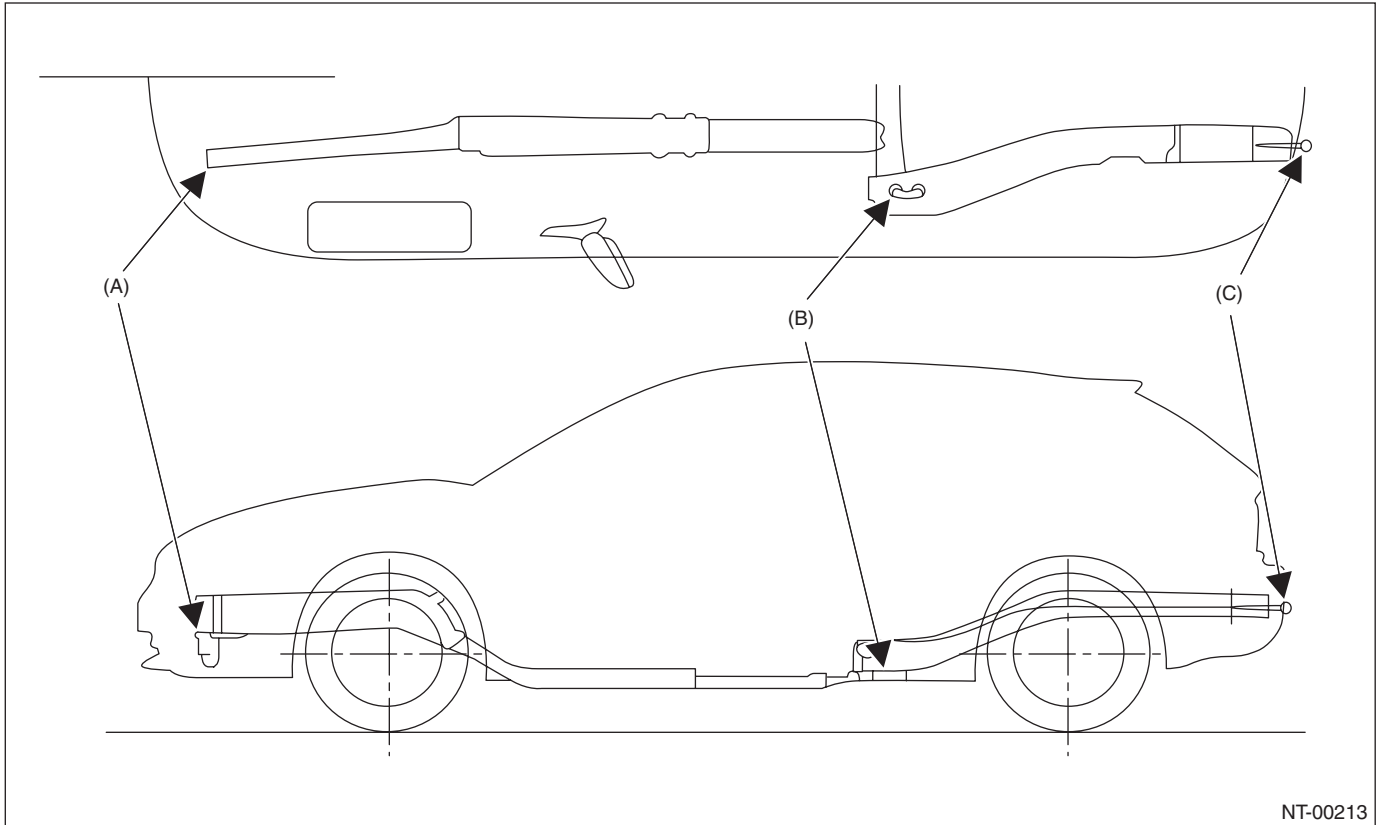

NT-00213

(A) Front tie-down hook

(B) Rear tie-down hook

(C) Eye bolt

• Tie-down direction

CAUTION:

- Pull the tie-down chains LH and RH in the same direction, but front and rear side in the counter direction.
- Directions except the followings (recommended) are inappropriate.

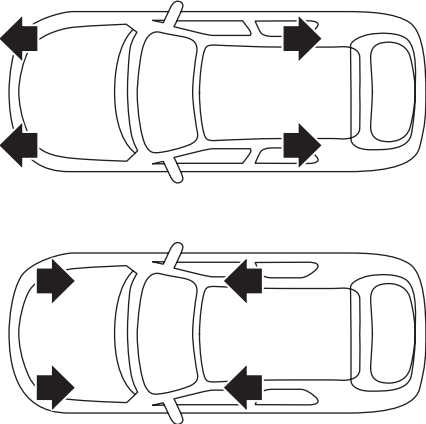
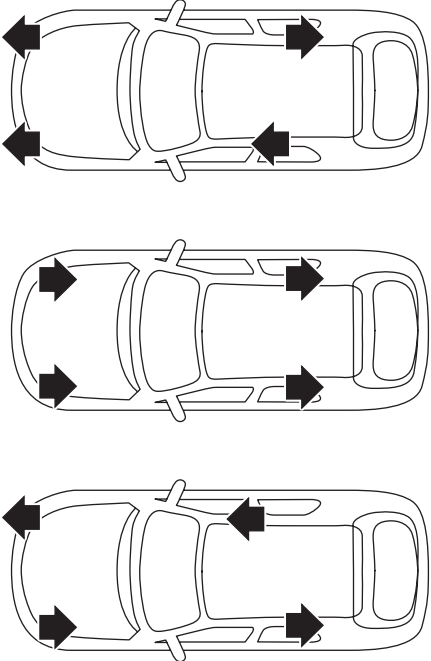
	Recommended	NG
Tie-down direction	 NT-00214	 NT-00215

Note

NOTE

• TIE-DOWN RANGE

For ground transportation

CAUTION:

When the vehicle is tied down from vehicle inside, hook the hooks of tie-down chain on the rear tie-down hooks from vehicle inside. When the vehicle is tied down from vehicle outside, hook the hooks of tie-down chain on the rear tie-down hooks from vehicle outside.

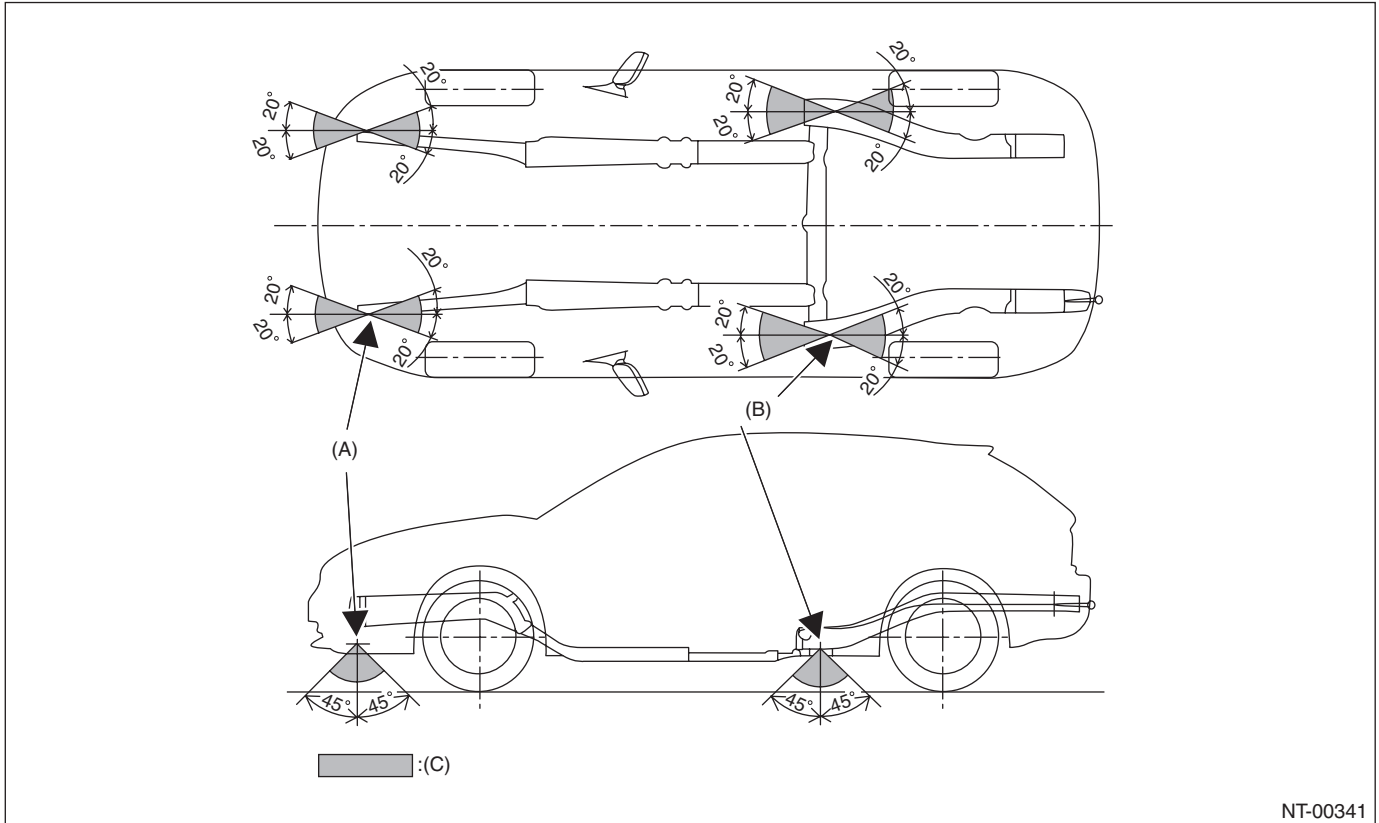

For sea transportation

CAUTION:

The eye bolts are exclusively used for towing and sea transportation tie-down, and do not use them for ground and freight transportation.

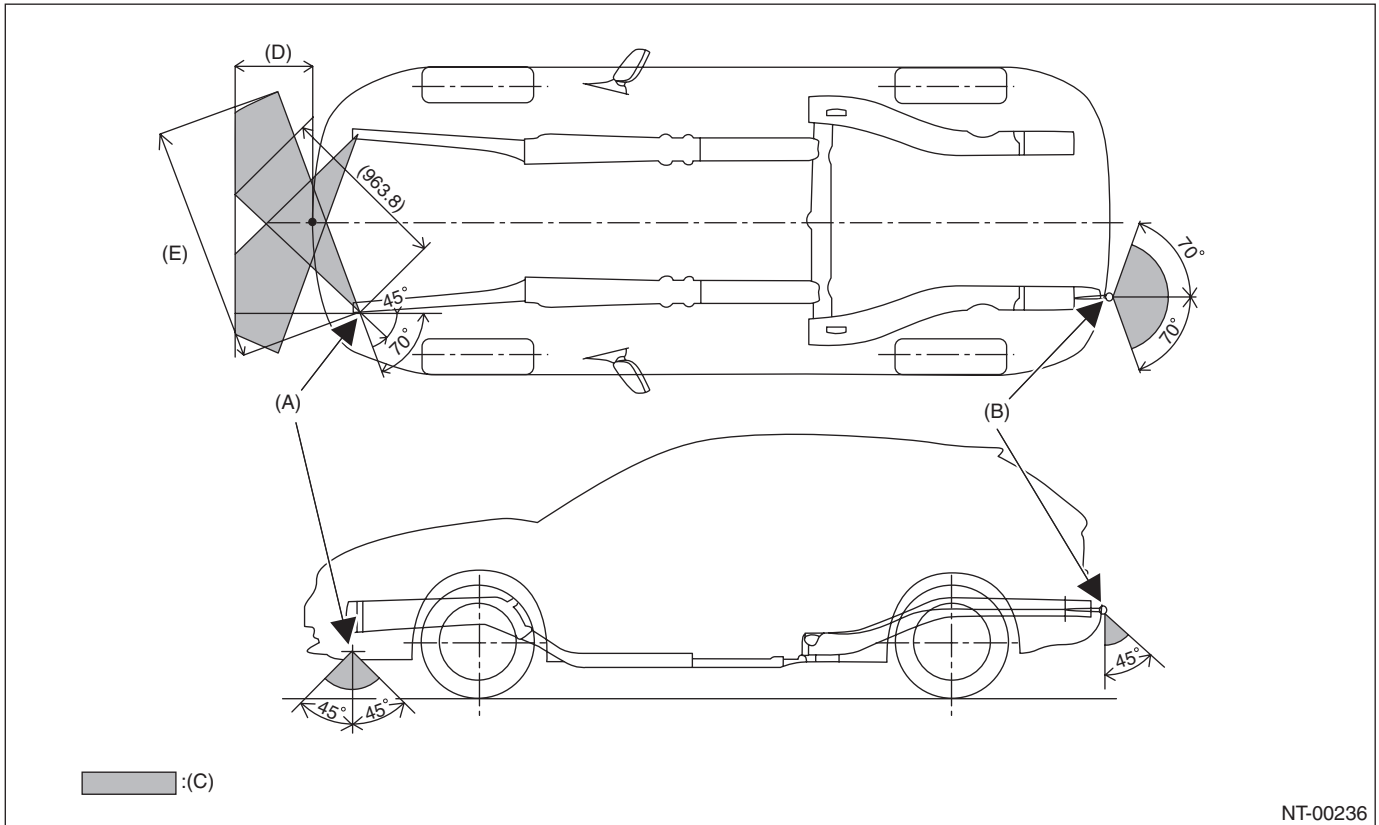

NT-00236

- | | | |
|-------------------------|---|------------------------|
| (A) Front tie-down hook | (C) Chain pulling range at tie-down condition | (E) 1,320 mm (52.0 in) |
| (B) Eye bolt | (D) 400 mm (15.7 in) | |

Note

NOTE

• VEHICLE SINKING VOLUME AT TIE-DOWN CONDITION

CAUTION:

The vehicle sinking volume at tie-down condition should be less than 50 mm (1.97 in) and make sure to fix the vehicle securely.

Check to see if the tensions of chains or belts at tie-down condition are appropriate in the following procedures.

- 1) Measure the distance (A) between the center of wheel and highest arch point.
- 2) Compare the above dimensions of before and after tie-down.
- 3) If the distance is less than 50 mm (1.97 in), it is judged as OK. If the distance is 50 mm (1.97 in) or more, it is judged as NG because the tension is too high.

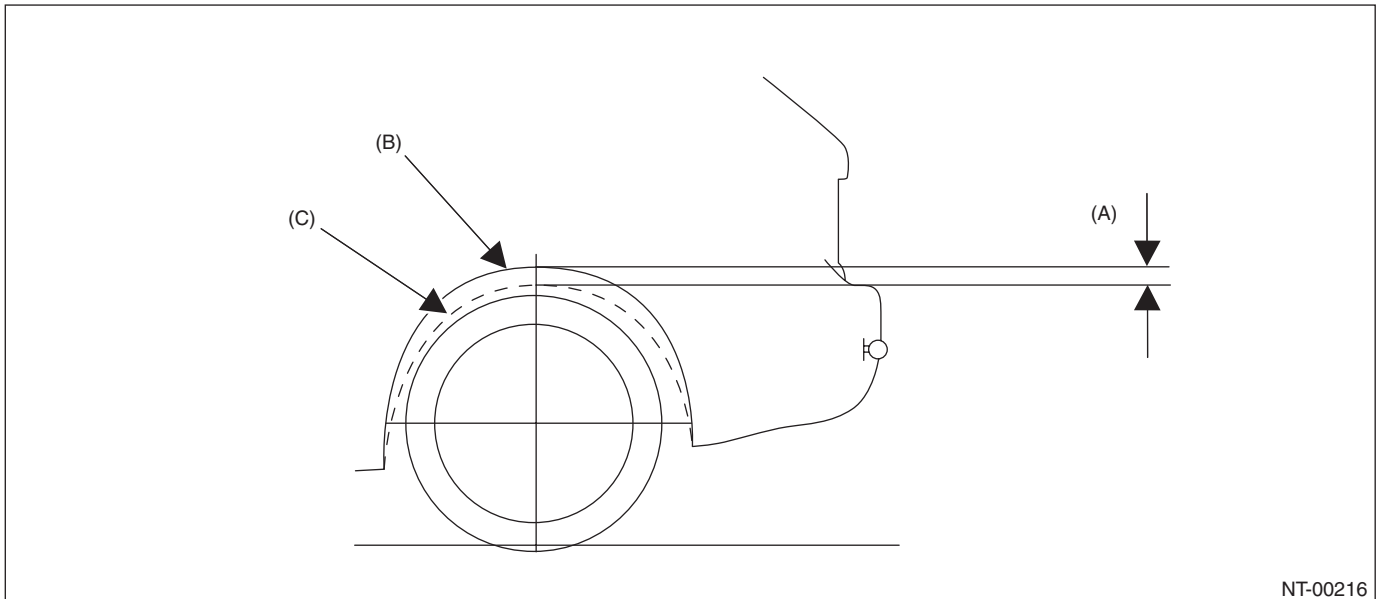

(B) Arch position before tie-down

(C) Arch position after tie-down

• **NOTES FOR THE USE OF TIE-DOWN HOOK**

When the vehicle is tied down from the rear side, use the holes at the rear side, and when the vehicle is tied down from the front side, use the holes at the front side.

When the vehicle is tied down from vehicle inside, hook the hooks of tie-down chain from vehicle inside, and when the vehicle is tied down from vehicle outside, hook the hooks of tie-down chain from vehicle outside.

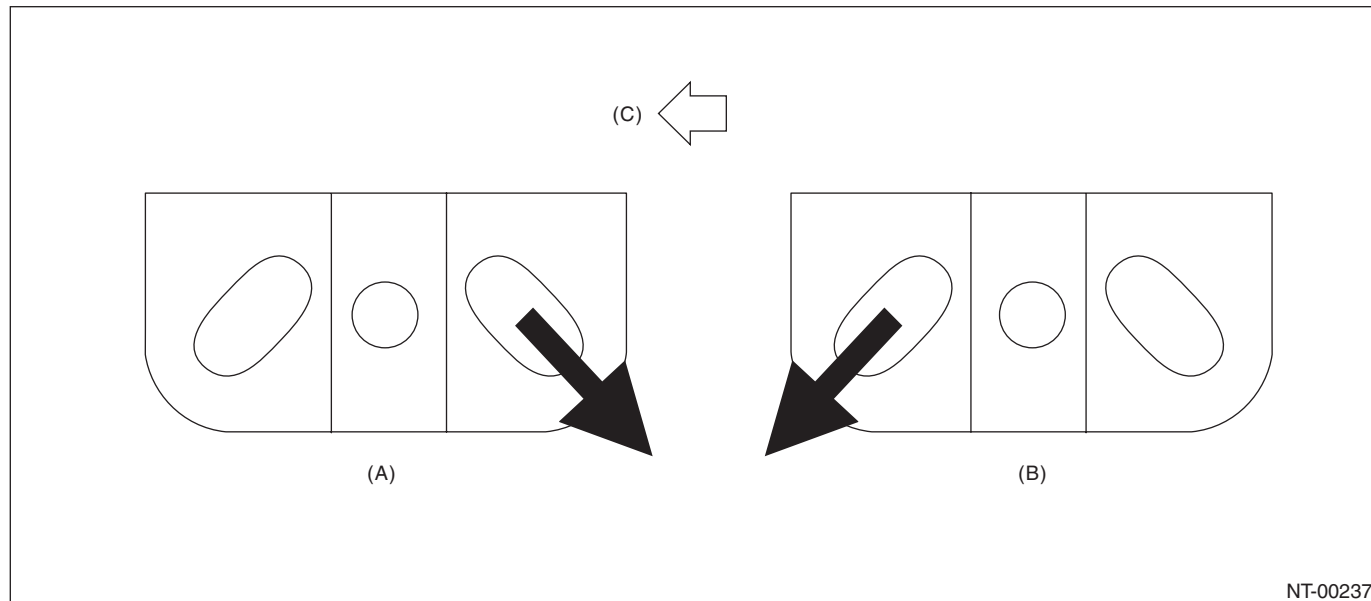

NT-00237

(A) When the vehicle is tied down towards the rear side

(B) When the vehicle is tied down towards the front side

(C) Vehicle front

Note

NOTE

9. TOWING

Avoid towing vehicles except when the vehicle cannot be driven. For models with AWD and AT, use a car carrier truck instead of towing. When towing other vehicles, pay attention to the following to prevent hook or vehicle damage resulting from excessive weight.

- Do not tow other vehicles with a front tie-down hook.
- Make sure the vehicle towing is heavier than the vehicle being towed.

• Front

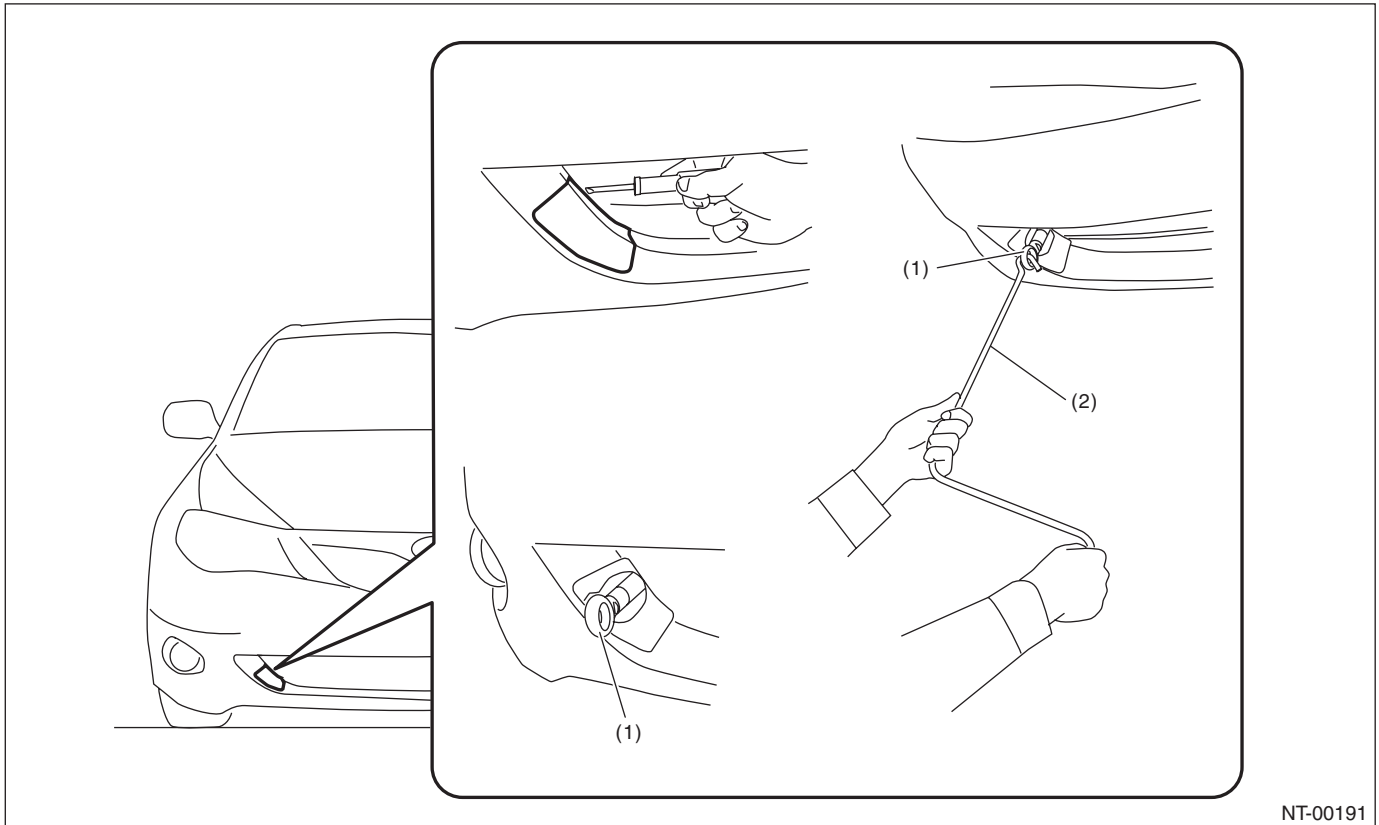

NT-00191

(1) Eye bolt

(2) Jack handle

• Rear

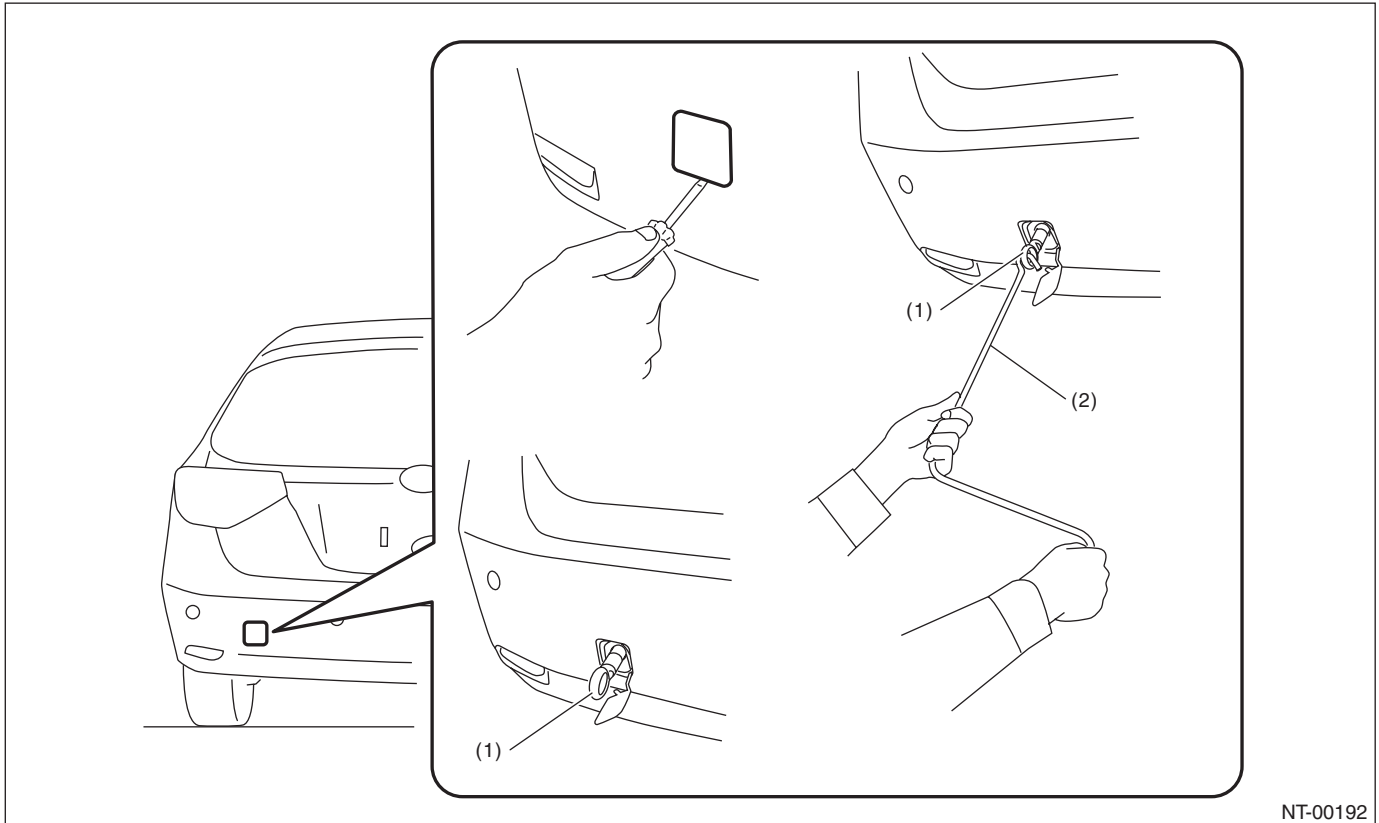

(1) Eye bolt

(2) Jack handle

CAUTION:

- Use the towing hook for towing purpose only.
- After using the towing hook, be sure to remove it. If it remains installed, the airbag may not inflate in head-on collision.
- When tightening the eye bolt using a wheel wrench, be careful not to scratch the bumper.

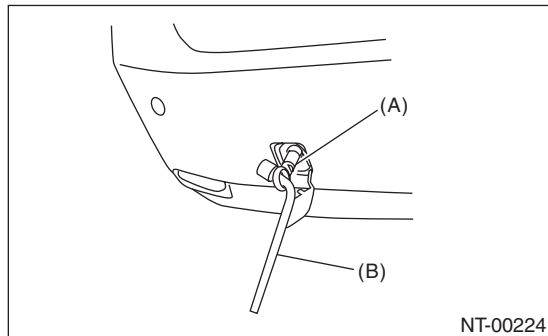



(A) Eye bolt

(B) Wheel wrench

Note

NOTE

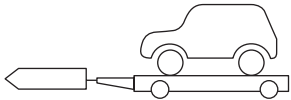
Precautions

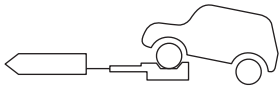
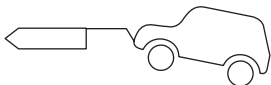
Towing	Precautions	MT	AT
Lifting up four wheels (On a trailer)  NT-00023	Towing the vehicle after lifting up all four wheels is a basic rule for AWD model. CAUTION: When loading on a carrier transport, make sure to follow the procedures for "LOADING ONTO CAR CARRIER TRUCK". <Ref. to NT-17, LOADING ONTO CAR CARRIER TRUCK, NOTE, Note.>	○	○
Rope  NT-00024	<ul style="list-style-type: none"> • Check if both front and rear wheels are rotated normally. • AT model driving conditions: Driving speed of 30 km/h (19 MPH) or less Allow driving distance 50 km (31 miles) or less	○	▲
Raising the front wheels  NT-00025	Prohibited for full-time AWD model.	×	×
Lifting up the front wheels  NT-00026	<ul style="list-style-type: none"> • Prohibited, due to damage on bumper, front grille, etc. • Do not raise the vehicle with bumper. 	×	×

10.LOADING ONTO CAR CARRIER TRUCK

CAUTION:

- When carrying the vehicle onto a car carrier truck, perform the operation being careful with the gap between the height of the carrier's floor and the vehicle lower side because of little clearance under the front bumper.

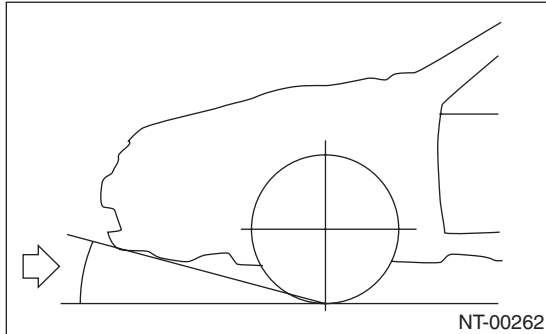

- Use a supporting board (rubber) where the clearance is too small.
- Perform the operation being careful with the position shown in the figure below.

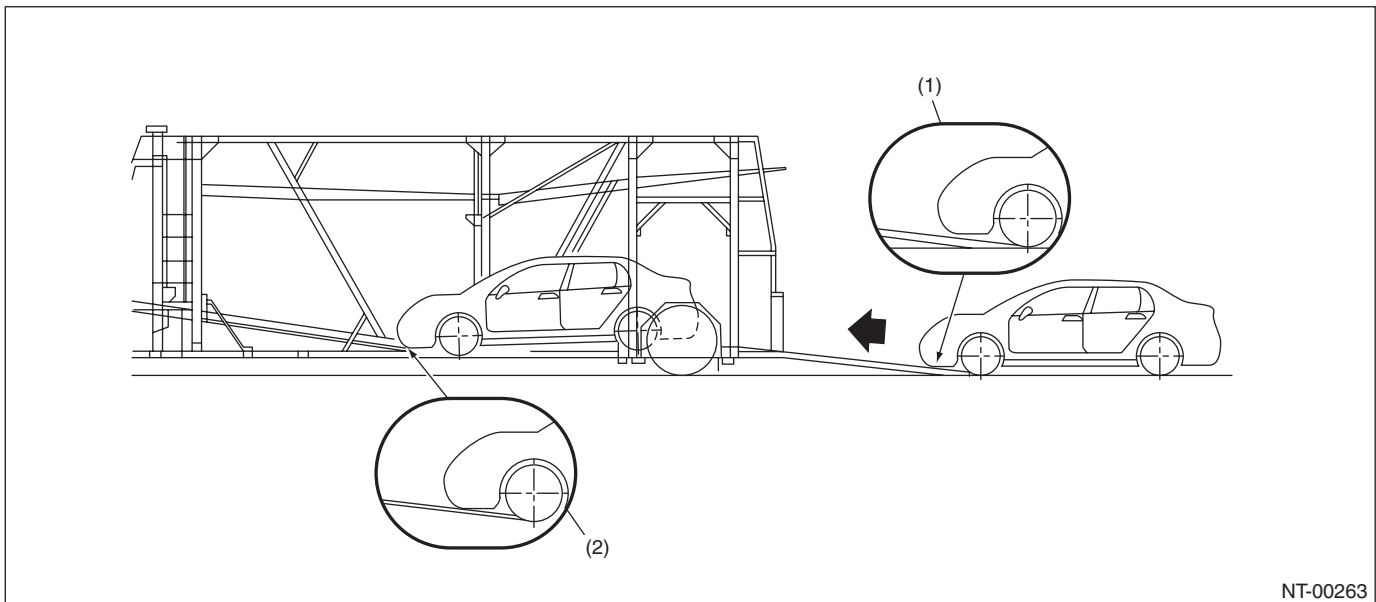

(1) Use a supporting board (rubber) to ensure clearance from the ramp.

(2) Before carrying the vehicle completely, lower the lower center floor until it is level to make clearance.

11.FRONT HOOD DAMPER STAY

1) Always perform works such as inspections and maintenance with both damper stays attached.

CAUTION:

- At the inspection and general maintenance, do not detach the damper stays.

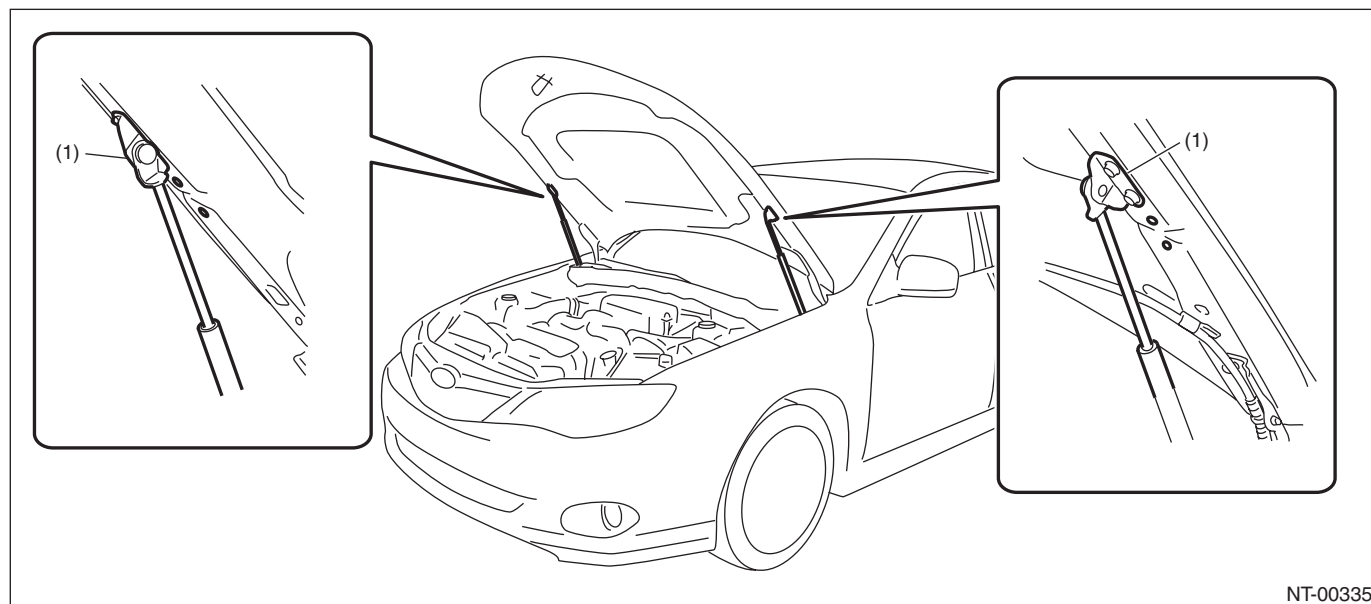

(1) Normal attached position

2) When wider hood opening is necessary, set the damper stay below as shown in the figure.

Tightening torque:

<Ref. to EB-8, FRONT HOOD, COMPONENT, General Description.>

CAUTION:

- Always perform works such as inspections and maintenance with both damper stays attached.
- Do not leave one side of damper stay removed.
- The hood cannot be closed with the hood damper on the full open side. When it is necessary to close, tie the hood striker and the radiator panel with a string etc. to fix them.

- After work, set the damper stays back to the normal position and tighten the bolts to the specified torque.

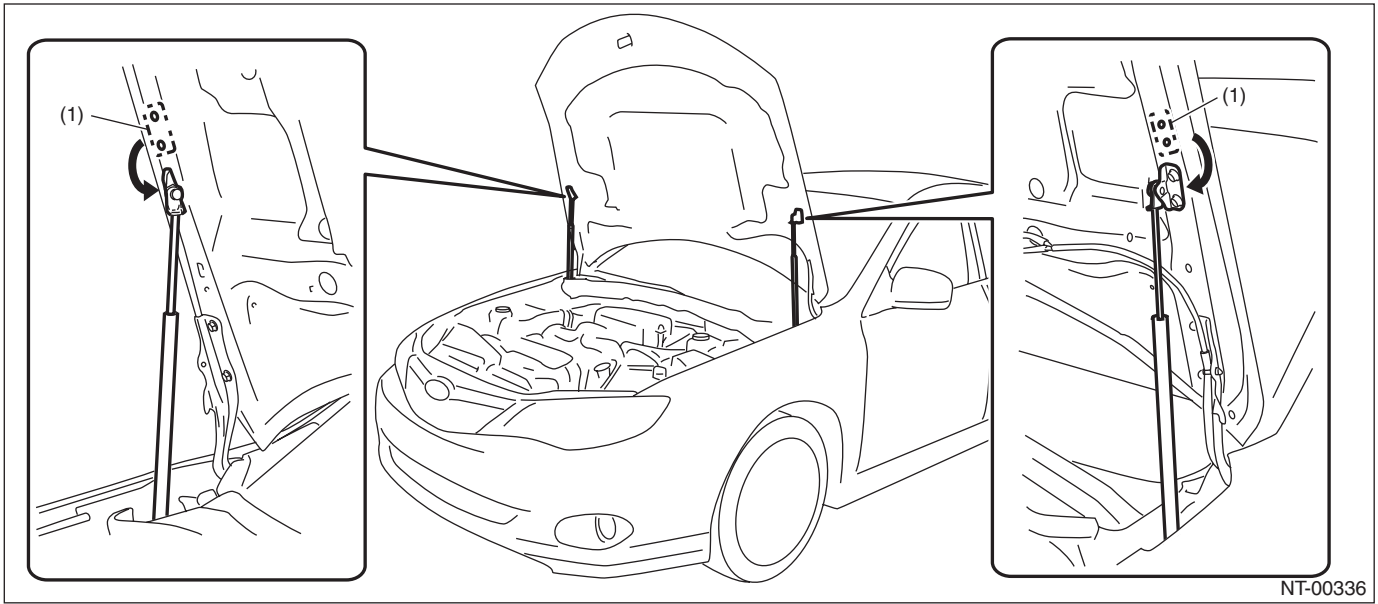

(1) Normal attached position

12. TRAINING

For an information about training, contact a dealer or agent.

13. GENERAL SCAN TOOL

Using general scan tools will greatly improve the efficiency of repairing engine electronic controls. Subaru Select Monitor can be used to diagnose the engine, VDC, AT and other electronically controlled parts.

NOTE

IDENTIFICATION

ID

	Page
1. Identification	2

