

## 7. Knock Sensor

### A: REMOVAL

- 1) Disconnect the ground cable from battery.

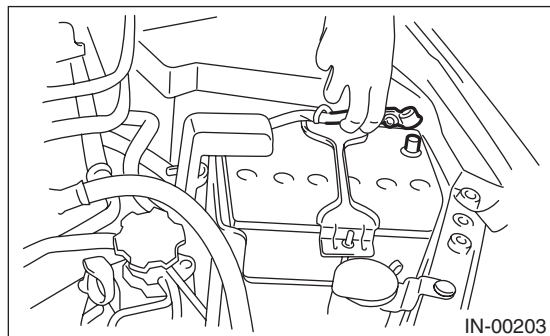

- 2) Remove the intercooler. <Ref. to IN(H4DOTC)-13, REMOVAL, Intercooler.>

- 3) Disconnect the knock sensor connector.

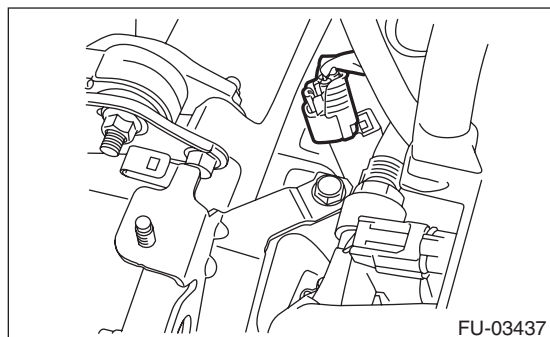

- 4) Remove the knock sensor from cylinder block.

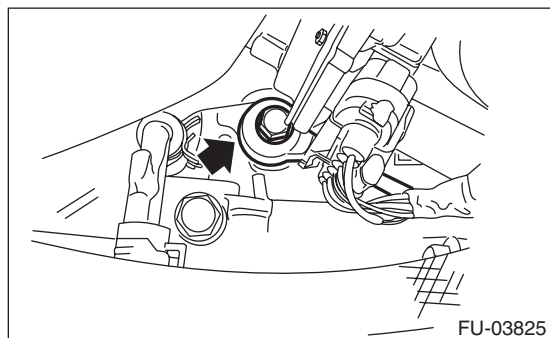

### B: INSTALLATION

- 1) Install the knock sensor to the cylinder block.

#### NOTE:

The portion of the knock sensor cord that is pulled out must be positioned at a 60° angle relative to the engine rear.

#### Tightening torque:

**24 N·m (2.4 kgf-m, 17.7 ft-lb)**

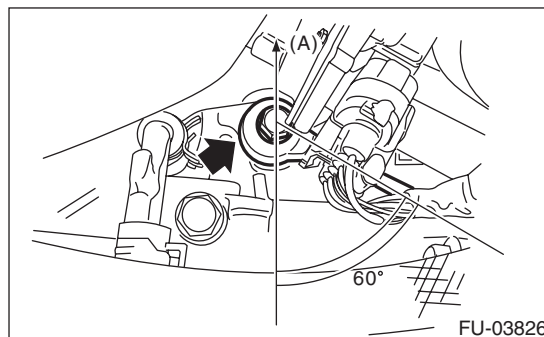

(A) Front side of vehicle

- 2) Connect the knock sensor connector.

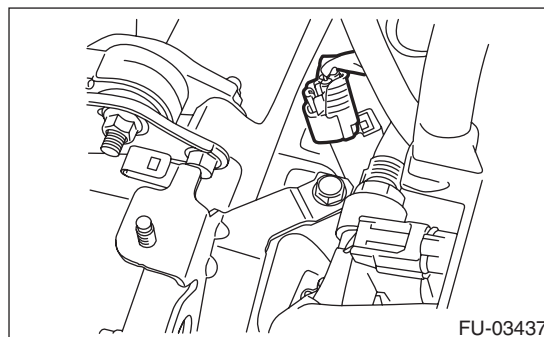

- 3) Install the intercooler. <Ref. to IN(H4DOTC)-13, INSTALLATION, Intercooler.>

- 4) Connect the ground cable to battery.

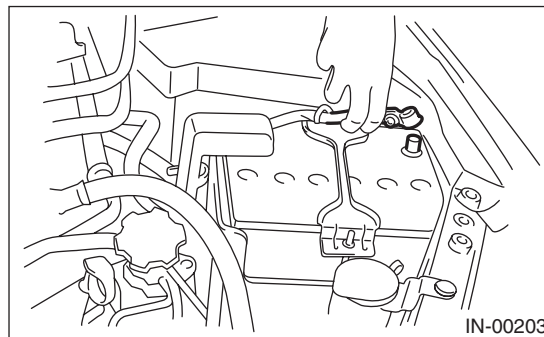

# Knock Sensor

FUEL INJECTION (FUEL SYSTEMS)

## C: INSPECTION

Measure the resistance between knock sensor terminals.

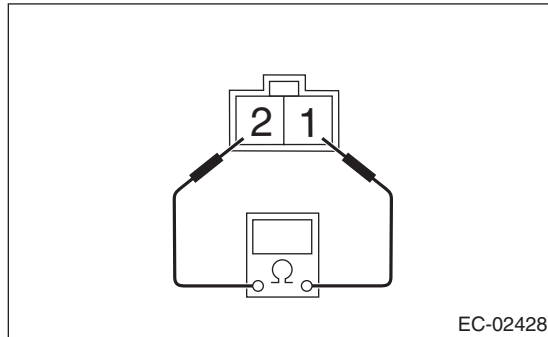

Terminal No.	Standard
1 and 2	560 $\pm$ 28 k $\Omega$