

2. Front Exhaust Pipe

A: REMOVAL

CAUTION:

Vehicle components are extremely hot after driving. Be wary of receiving burns from heated parts.

- 1) Set the vehicle on a lift.
- 2) Disconnect the ground cable from battery.

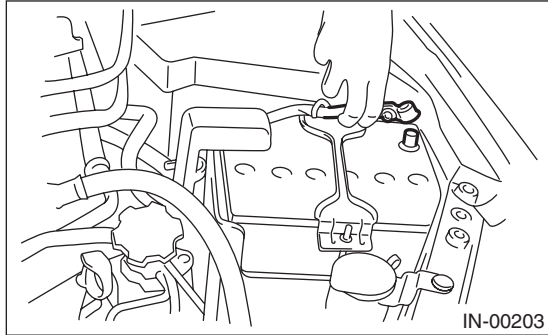

- 3) Lift up the vehicle.
- 4) Remove the under cover.
- 5) Remove the front oxygen (A/F) sensor. <Ref. to FU(H4DOTC)-47, REMOVAL, Front Oxygen (A/F) Sensor.>
- 6) Remove the exhaust manifold RH lower cover and exhaust manifold LH cover.

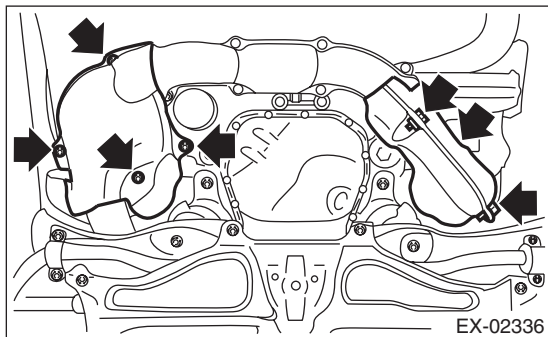

- 7) Remove the bolts and nuts which hold front exhaust pipe assembly onto joint pipe.

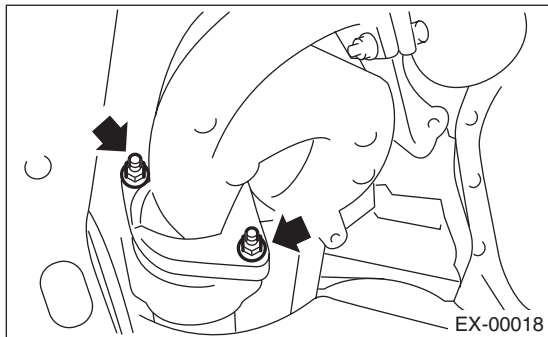

- 8) While holding the front exhaust pipe assembly with one hand, remove the nuts which hold the front exhaust pipe assembly to cylinder head exhaust port.

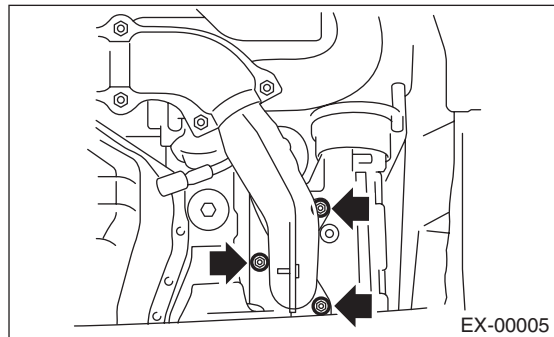
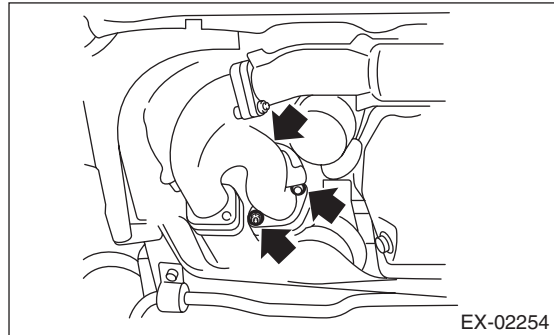

- 9) Remove the front exhaust pipe assembly.
- 10) Remove the exhaust manifold RH upper cover and the front exhaust pipe cover.
- 11) Remove the exhaust manifold from the front exhaust pipe.

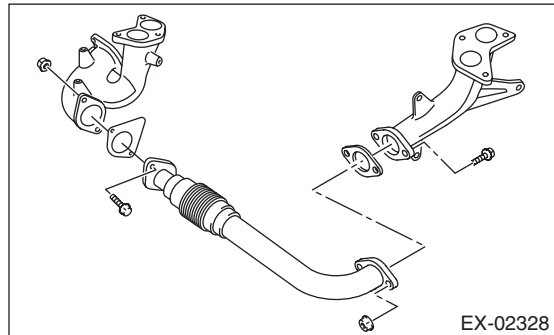

Front Exhaust Pipe

EXHAUST

B: INSTALLATION

1) Install the exhaust manifold to the front exhaust pipe.

NOTE:

Use a new gasket.

Tightening torque:

42.5 N·m (4.3 kgf-m, 31.3 ft-lb)

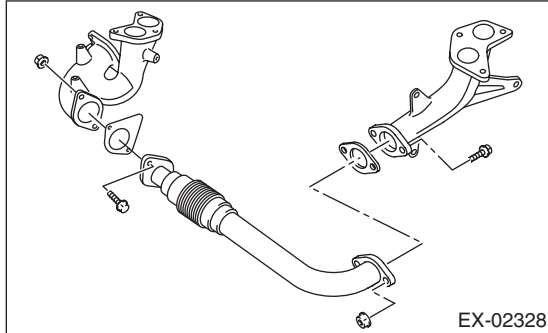

2) Install the front exhaust pipe cover.

Tightening torque:

25 N·m (2.5 kgf-m, 18.4 ft-lb)

3) Install the exhaust manifold RH upper cover.

Tightening torque:

19 N·m (1.9 kgf-m, 14.0 ft-lb)

4) Install the front exhaust pipe assembly.

NOTE:

Use a new gasket.

Tightening torque:

40 N·m (4.1 kgf-m, 29.5 ft-lb)

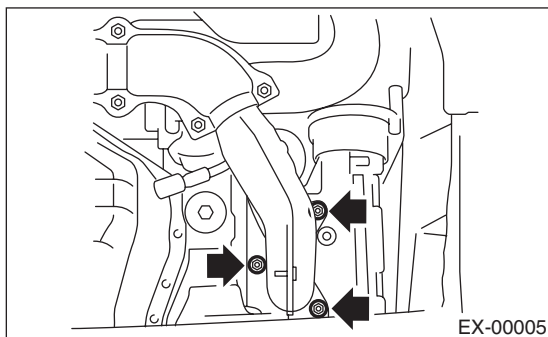
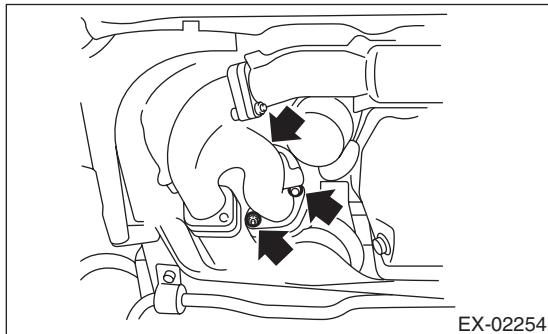

5) Install the joint pipe to the front exhaust pipe assembly.

NOTE:

Use a new gasket.

Tightening torque:

42.5 N·m (4.3 kgf-m, 31.3 ft-lb)

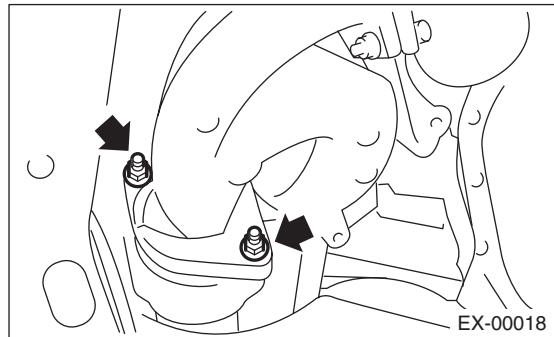

6) Install the exhaust manifold RH lower cover and exhaust manifold LH cover.

Tightening torque:

19 N·m (1.9 kgf-m, 14.0 ft-lb)

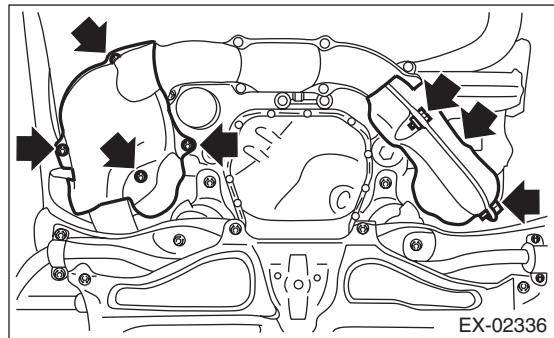

7) Install the front oxygen (A/F) sensor. <Ref. to FU(H4DOTC)-47, INSTALLATION, Front Oxygen (A/F) Sensor.>

8) Install the under cover.

9) Lower the vehicle.

10) Connect the ground cable to battery.

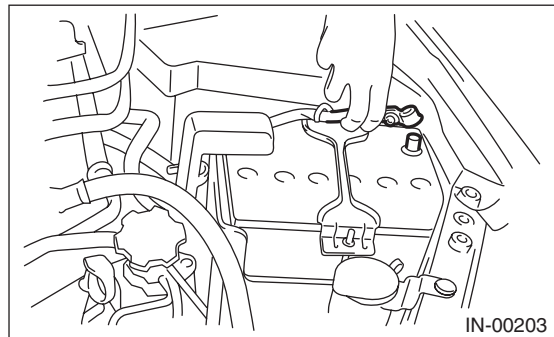

C: INSPECTION

1) Check the connections and welds for exhaust leaks.

2) Make sure there are no holes or rusting.