

# Purge Control Solenoid Valve

EMISSION CONTROL (AUX. EMISSION CONTROL DEVICES)

## 5. Purge Control Solenoid Valve

### A: REMOVAL

#### 1. PURGE CONTROL SOLENOID VALVE 1

1) Disconnect the ground cable from battery.

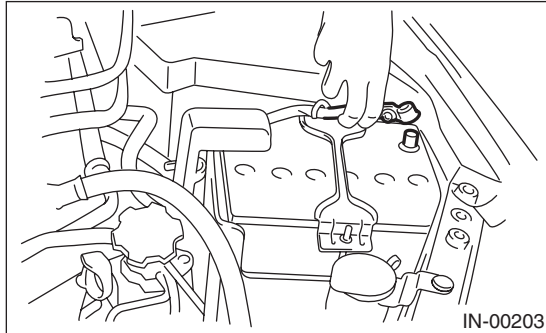

2) Remove the bolts which secure purge control solenoid valve 1 to the intake manifold, and disconnect the connector from the purge control solenoid valve 1.

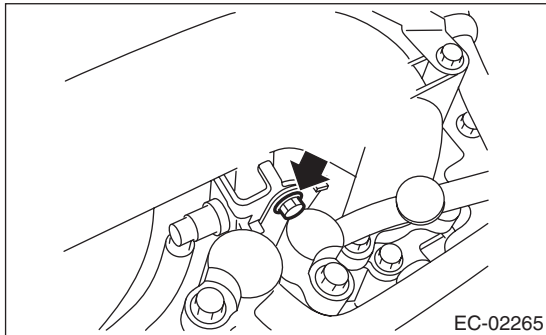

3) Disconnect the evaporation hose from the intake manifold and fuel pipe assembly.

#### 2. PURGE CONTROL SOLENOID VALVE 2

1) Disconnect the ground cable from battery.

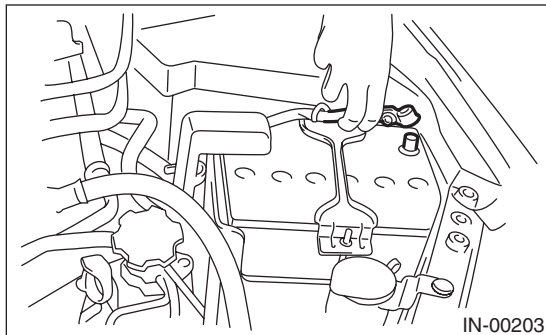

2) Remove the solenoid valve bracket assembly from the intake manifold.

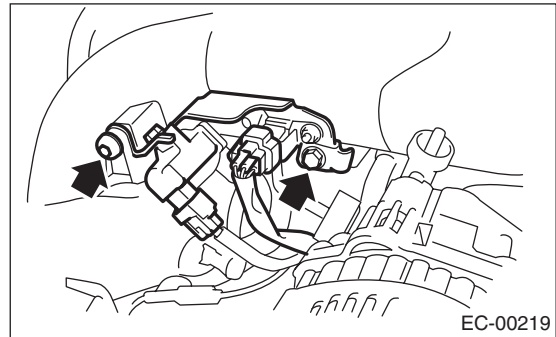

3) Disconnect the connector from purge control solenoid valve 2.

4) Disconnect the evaporation hose from the intake duct and fuel pipe assembly.

5) Remove the purge control solenoid valve 2 from the solenoid valve bracket assembly.

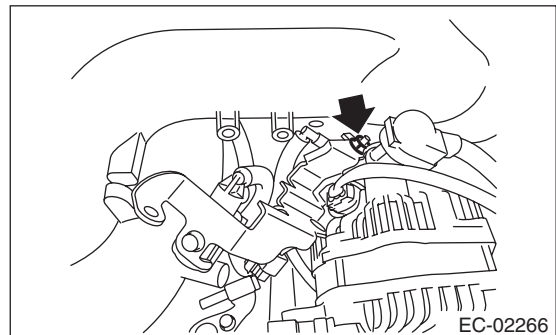

# Purge Control Solenoid Valve

EMISSION CONTROL (AUX. EMISSION CONTROL DEVICES)

## B: INSTALLATION

### 1. PURGE CONTROL SOLENOID VALVE 1

Install in the reverse order of removal.

NOTE:

Connect the evaporation hose as shown in the figure.

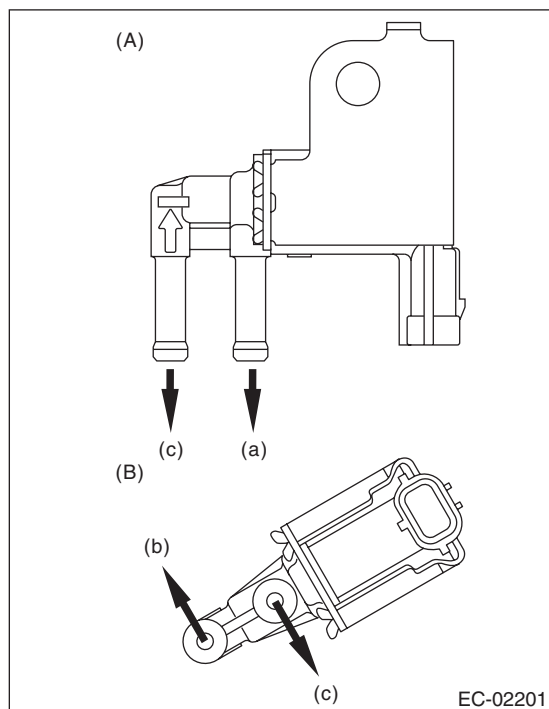

- (A) Purge control solenoid valve 1
- (B) Purge control solenoid valve 2
- (a) To intake manifold
- (b) To intake duct
- (c) To fuel pipe

**Tightening torque:**

**6.4 N·m (0.7 kgf-m, 4.7 ft-lb)**

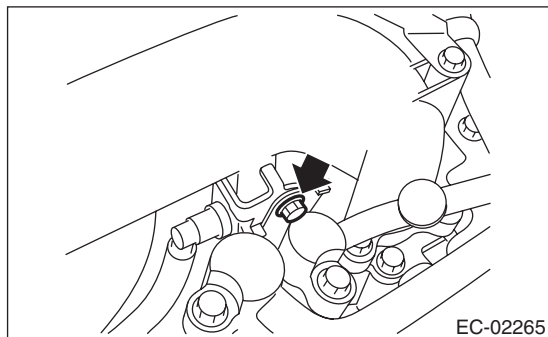

### 2. PURGE CONTROL SOLENOID VALVE 2

Install in the reverse order of removal.

NOTE:

Connect the evaporation hose as shown in the figure.

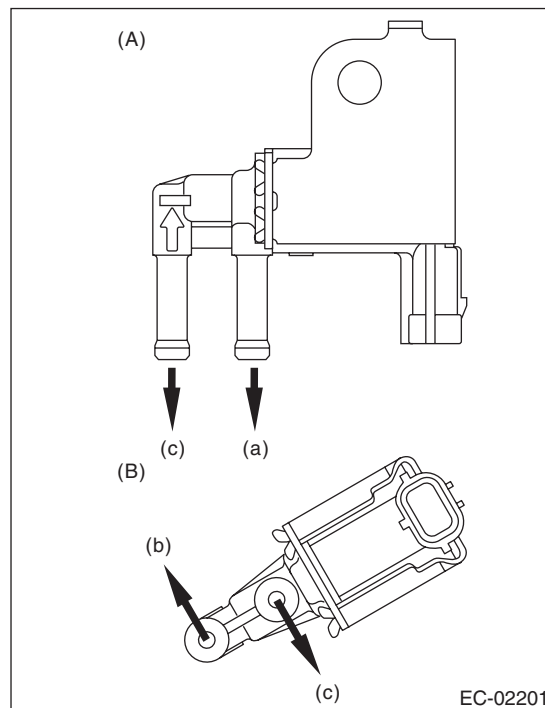

- (A) Purge control solenoid valve 1
- (B) Purge control solenoid valve 2
- (a) To intake manifold
- (b) To intake duct
- (c) To fuel pipe

**Tightening torque:**

**6.4 N·m (0.7 kgf-m, 4.7 ft-lb)**

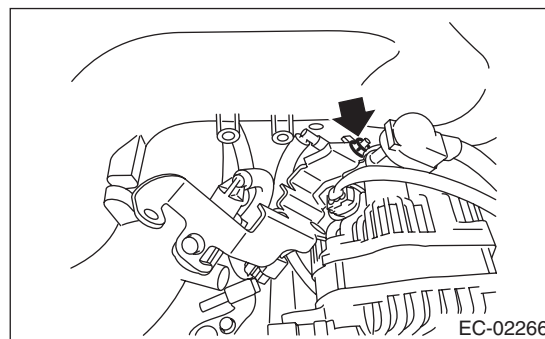

# Purge Control Solenoid Valve

EMISSION CONTROL (AUX. EMISSION CONTROL DEVICES)

## Tightening torque:

T1: 17 N·m (1.7 kgf-m, 12.5 ft-lb)

T2: 19 N·m (1.9 kgf-m, 14.0 ft-lb)

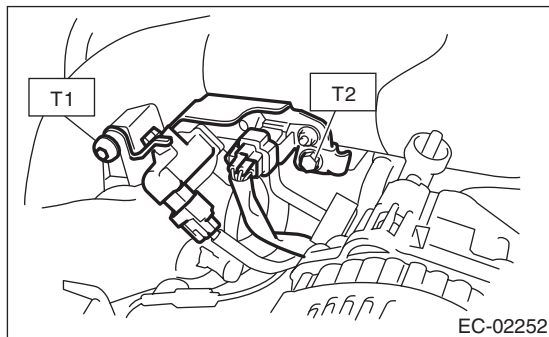

## C: INSPECTION

### 1. PURGE CONTROL SOLENOID VALVE

1) Measure the resistance between the purge control solenoid valve terminals.

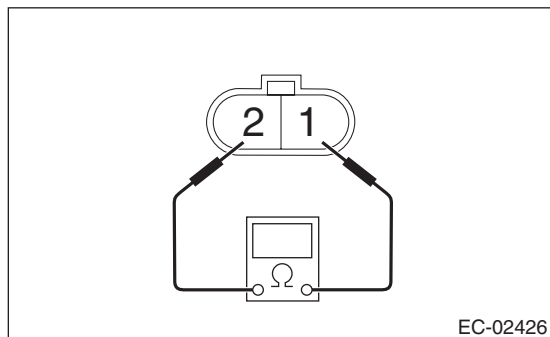

	Terminal No.	Standard
Purge control solenoid valve 1	1 and 2	$32 \pm 2 \Omega$ (20°C (68°F))
Purge control solenoid valve 2		$24 \pm 3 \Omega$ (20°C (68°F))

2) Check that air does not come out of (B) when blowing in (A).

- Purge control solenoid valve 1

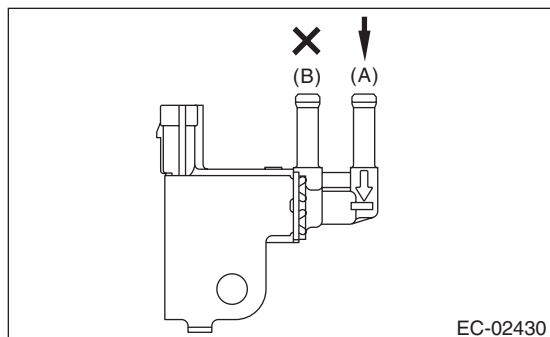

- Purge control solenoid valve 2

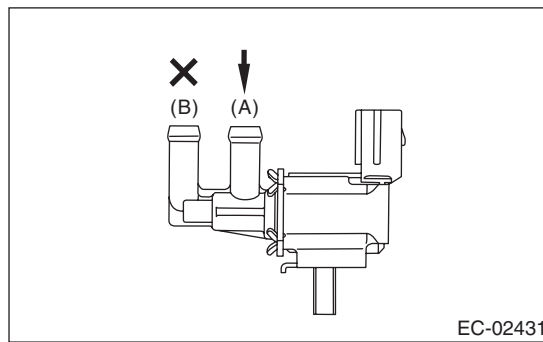

3) Connect the terminal No. 1 to the battery positive terminal and the terminal No. 2 to the battery negative terminal. When supplying air to (A), check that air is discharged from (B).

- Purge control solenoid valve 1

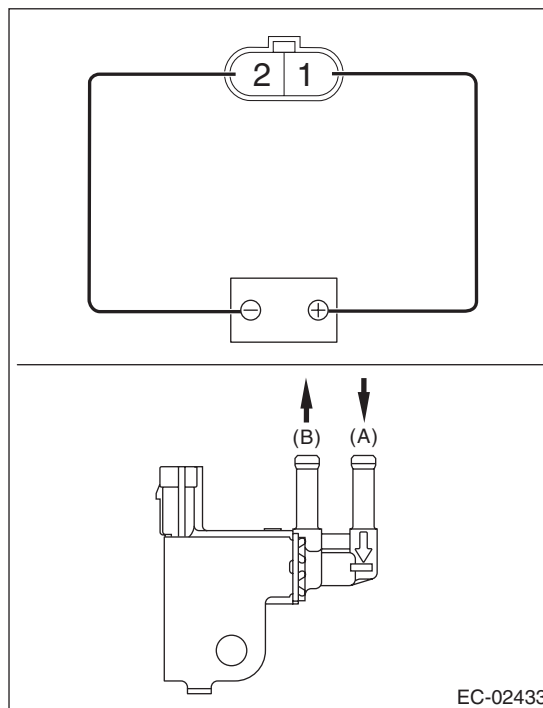

## Purge Control Solenoid Valve

EMISSION CONTROL (AUX. EMISSION CONTROL DEVICES)

---

- Purge control solenoid valve 2

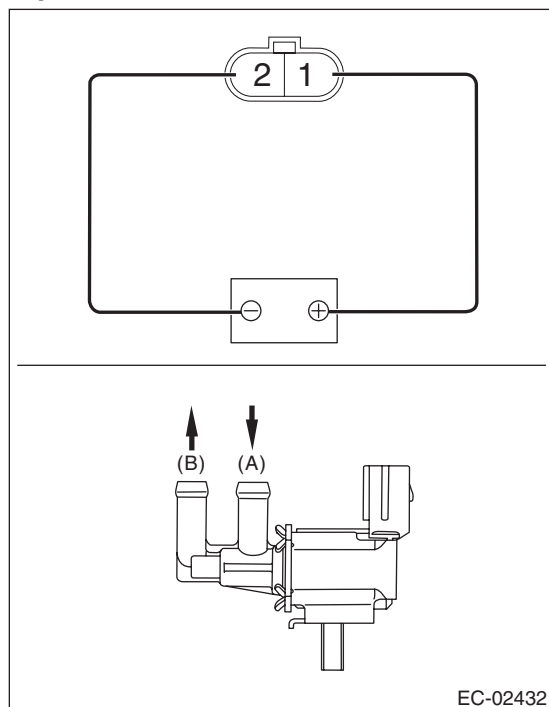

### 2. OTHER INSPECTIONS

Make sure the hoses are not cracked or loose.