

# PCV Hose Assembly

EMISSION CONTROL (AUX. EMISSION CONTROL DEVICES)

## 14.PCV Hose Assembly

### A: REMOVAL

#### CAUTION:

**Do not remove unless the PCV hose, diagnostics connector and PCV valve are damaged.**

- 1) Remove the intake manifold. <Ref. to FU(H4DOTC)-16, REMOVAL, Intake Manifold.>
  - 2) Remove the secondary air combination valve RH. <Ref. to EC(H4DOTC)-25, SECONDARY AIR COMBINATION VALVE RH, REMOVAL, Secondary Air Combination Valve.>
  - 3) Fit the depression in the ST with the protrusion on the clamp securing PCV hose assembly to unlock.
  - 4) Remove the PCV hose assembly.
- ST 18353AA000 CLAMP PLIERS

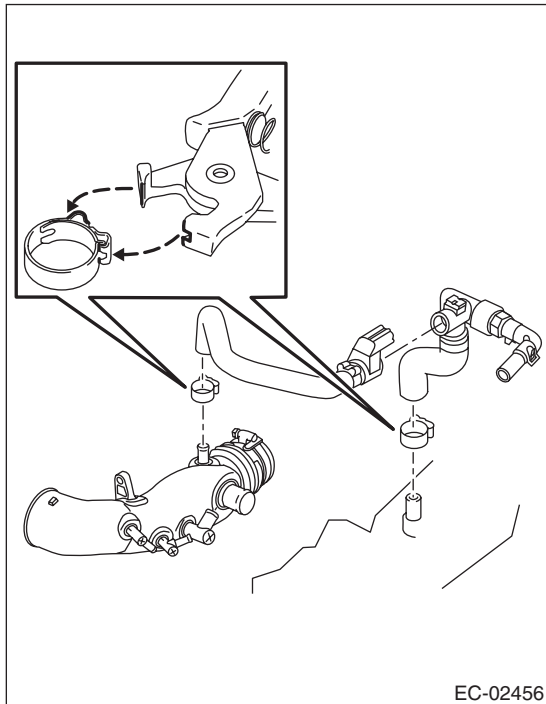

### B: INSTALLATION

- 1) Install the PCV hose assembly, then lock by fitting the ST on the clamp protrusion.

#### NOTE:

Use a new clamp.

ST 18353AA000 CLAMP PLIERS

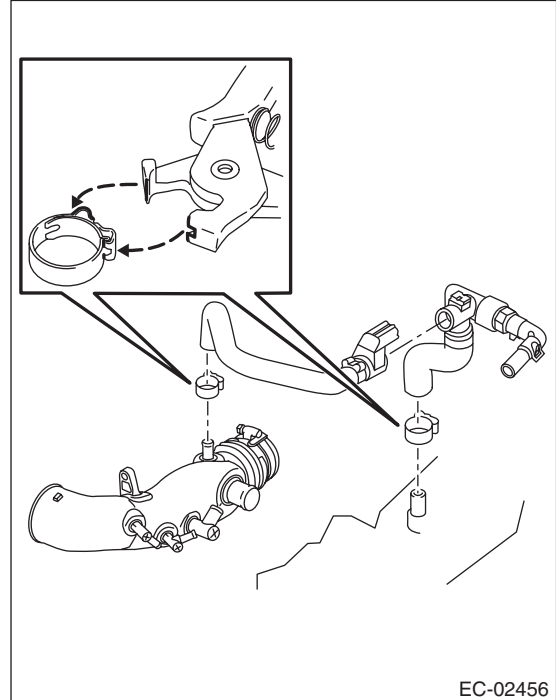

- 2) Install the secondary air combination valve RH. <Ref. to EC(H4DOTC)-26, SECONDARY AIR COMBINATION VALVE RH, INSTALLATION, Secondary Air Combination Valve.>
- 3) Install the intake manifold. <Ref. to FU(H4DOTC)-20, INSTALLATION, Intake Manifold.>

### C: INSPECTION

- 1) Measure the resistance between PCV hose assembly terminals.

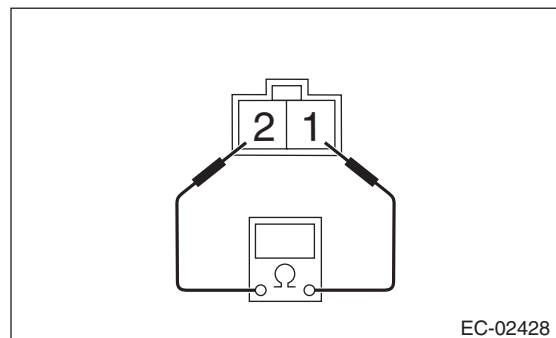

Terminal No.	Standard
1 and 2	Less than 1 $\Omega$

- 2) Make sure that there are no cracks or other damages on PCV hose assembly.