

16.Rear Oxygen Sensor

A: REMOVAL

- 1) Set the vehicle on a lift.
- 2) Disconnect the ground cable from battery.

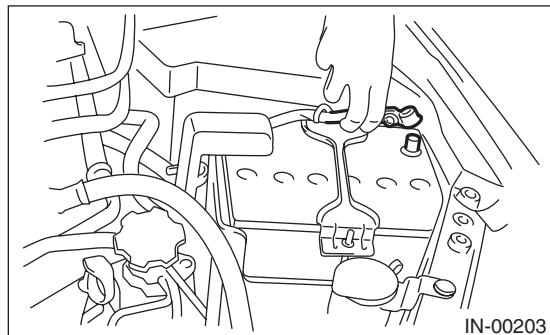

- 3) Remove the air intake duct. <Ref. to IN(H4SO)-8, REMOVAL, Air Intake Duct.>
- 4) Remove the clip fastening the harness and disconnect the rear oxygen sensor connector.

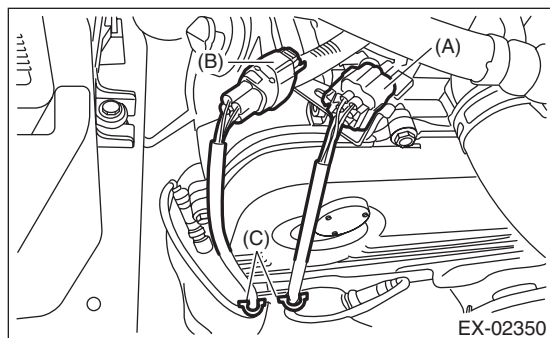

- (A) Front oxygen (A/F) sensor connector
(B) Rear oxygen sensor connector
(C) Clip

- 5) Lift up the vehicle.
- 6) Remove the under cover.
- 7) Apply spray-type lubricant to the threaded portion of rear oxygen sensor, and leave it for one minute or more.
- 8) Remove the rear oxygen sensor.

CAUTION:

When removing the rear oxygen sensor, wait until exhaust pipe cools, otherwise it will damage the exhaust pipe.

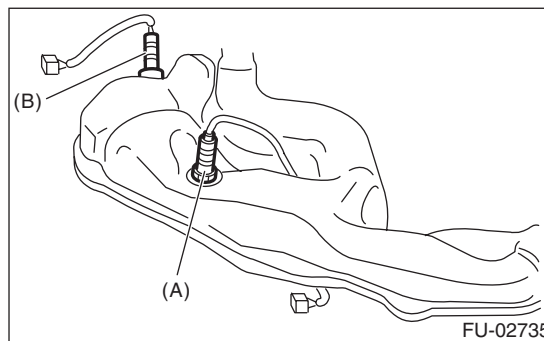

- (A) Front oxygen (A/F) sensor
(B) Rear oxygen sensor

B: INSTALLATION

CAUTION:

If lubricant is spilt onto the exhaust pipe, wipe it off completely with cloth to avoid emission of smoke or causing a fire.

- 1) Before installing rear oxygen sensor, apply the anti-seize compound only to the threaded portion of rear oxygen sensor to make the next removal easier.

CAUTION:

Never apply anti-seize compound to the protector of rear oxygen sensor.

Anti-seize compound:

NEVER-SEEZ NSN, JET LUBE SS-30 or equivalent

- 2) Install the rear oxygen sensor.

Tightening torque:

21 N·m (2.1 kgf-m, 15.5 ft-lb)

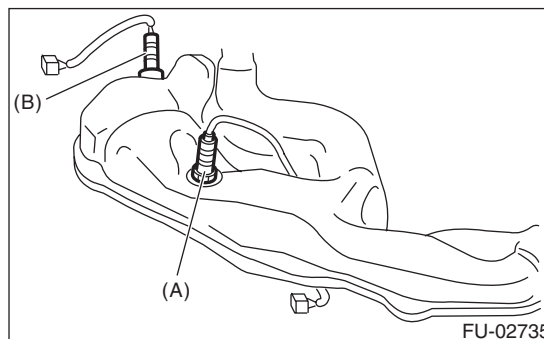

- (A) Front oxygen (A/F) sensor
(B) Rear oxygen sensor

- 3) Install the under cover.
- 4) Lower the vehicle.

Rear Oxygen Sensor

FUEL INJECTION (FUEL SYSTEMS)

5) Connect the rear oxygen sensor connector and fasten the harness with clips.

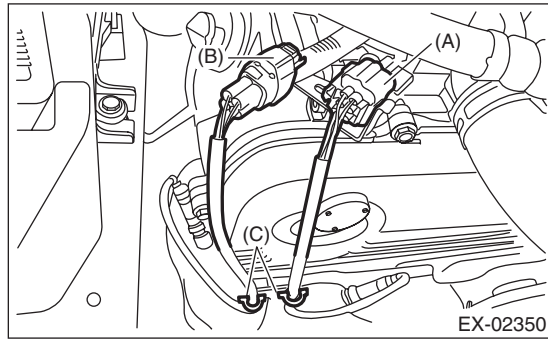

- (A) Front oxygen (A/F) sensor connector
- (B) Rear oxygen sensor connector
- (C) Clip

6) Connect the ground cable to battery.

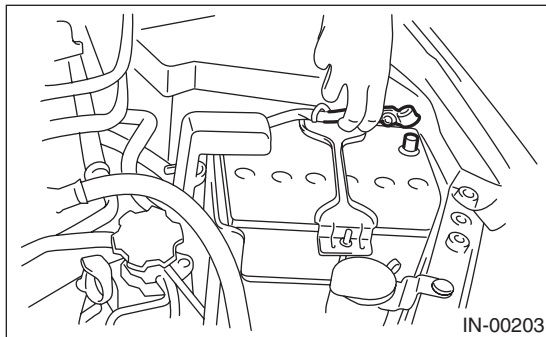

C: INSPECTION

Measure the resistance between rear oxygen sensor terminal.

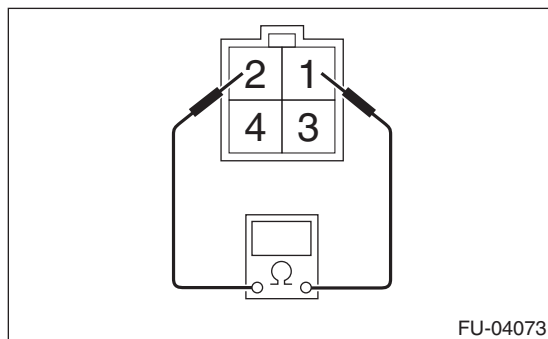

Terminal No.	Standard
1 and 2	$5.6^{+0.8}_{-0.6} \Omega$ (when 20°C (68°F))