

Tire Pressure Monitoring System

WHEEL AND TIRE SYSTEM

8. Tire Pressure Monitoring System

A: REMOVAL

1. TRANSMITTER (SNAP IN TYPE)

- 1) Remove the wheels from the vehicle. <Ref. to WT-6, REMOVAL, Aluminum Wheel.>
- 2) Remove the tires from wheels.

CAUTION:

Use a tire changer when removing the tire from the wheel.

- 3) Loosen the screw to remove the transmitter from the valve stem.

NOTE:

Replace the valve and screw with a new part when reusing transmitter.

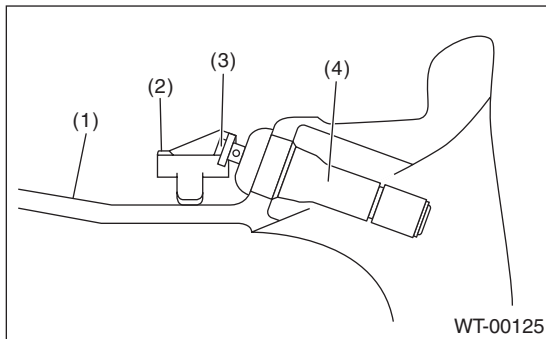

- (1) Wheel
- (2) Transmitter
- (3) Screw
- (4) Valve

- 4) Remove the valve from the wheel.

2. TIRE PRESSURE MONITORING CONTROL MODULE

- 1) Remove the canister. <Ref. to EC(H4SO)-5, REMOVAL, Canister.>
- 2) Remove the connector to remove tire pressure monitoring control module.

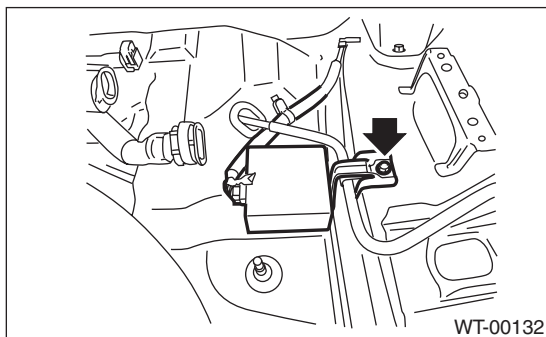

B: INSTALLATION

1. TRANSMITTER (SNAP IN TYPE)

CAUTION:

Use the new transmitter assembly or replace the new valve and screw, when installing.

- 1) Replace the valve and screw with a new part when reusing transmitter.

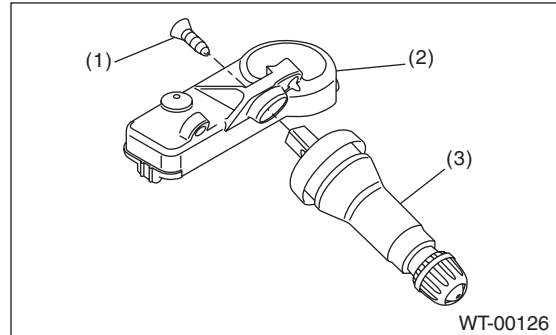

- (1) Screw
- (2) Transmitter
- (3) Valve

Tightening torque:

1.4 N·m (0.14 kgf-m, 1 ft-lb)

- 2) Install the transmitter to the wheel by aligning it with valve hole.

NOTE:

When using the jig that pulls the valve cap by hooking its neck part, use another short-type cap.

- 3) Install the tires to wheels.

CAUTION:

- Use a tire changer when installing tire to wheel.
- To prevent damaging the transmitter, set the tire changer boom in the position as shown in the figure.

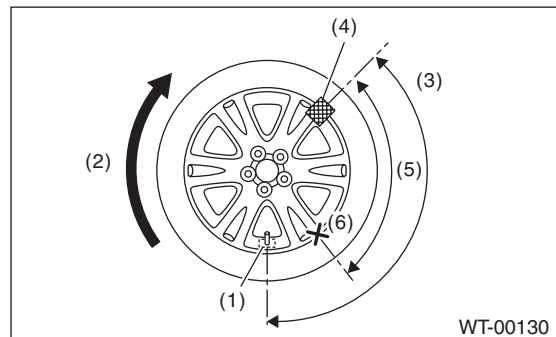

- (1) Transmitter
- (2) Direction of turn table rotation
- (3) 135°
- (4) Tire changer boom
- (5) 90°
- (6) Starting point for fitting the bead to the rim

4) Install the wheels to vehicle. <Ref. to WT-6, INSTALLATION, Aluminum Wheel.>

5) Register the transmitter ID to the tire pressure monitoring control module. <Ref. to TPM(diag)-10, REGISTER TRANSMITTER ID, OPERATION, Subaru Select Monitor.>

2. TIRE PRESSURE MONITORING CONTROL MODULE

Install in the reverse order of removal.

Tightening torque:

7.5 N·m (0.76 kgf-m, 5.5 ft-lb)

C: ADJUSTMENT

Re-register the transmitter ID when transmitter has been replaced. <Ref. to TPM(diag)-10, REGISTER TRANSMITTER ID, OPERATION, Subaru Select Monitor.>