

4. Seat Heater System

A: REMOVAL

1. SEAT HEATER MODULE

- 1) Remove the front seats. <Ref. to SE-6, REMOVAL, Front Seat.>
- 2) Remove the backrest cover of front seat and seat cushion cover. <Ref. to SE-7, DISASSEMBLY, Front Seat.>
- 3) Remove the seat heater module.

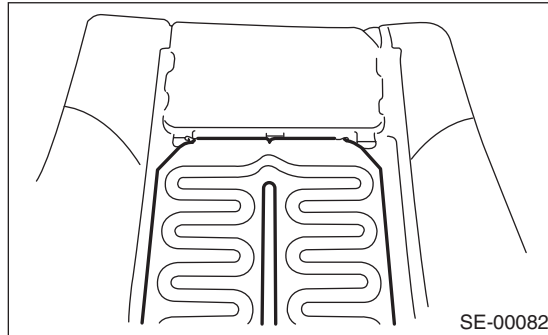

2. SEAT HEATER SWITCH

- 1) Remove the console box. <Ref. to EI-48, REMOVAL, Console Box.>
- 2) Remove the seat heater switch from the console box.

B: INSTALLATION

Install in the reverse order of removal.

C: INSPECTION

1. WIRING DIAGRAM

<Ref. to WI-95, WIRING DIAGRAM, Seat Heater System.>

2. SEAT HEATER MODULE

- 1) Disconnect the seat heater module connector, and check the continuity between terminals of connector.

Connector & terminal

No. 1 — No. 3:

No. 1 — No. 4:

No. 3 — No. 4:

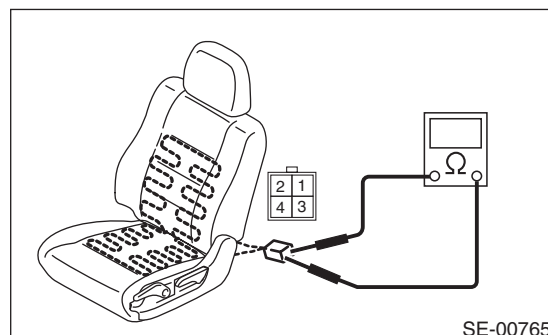

Is there continuity between connector terminals?

- **Continuity exists.**→

Seat heater module is normal. If there is a malfunction, check the seat heater switch and vehicle body side harness.

- **Continuity does not exist.**→

No. 1 — No. 3: → Go to step 2).

No. 1 — No. 4: → Go to step 2).

No. 3 — No. 4: → Replace the seat heater module of seat cushion side.

- 2) Disconnect the seat heater module of backrest side, and check the continuity between connector terminals of the seat heater module unit of backrest side.

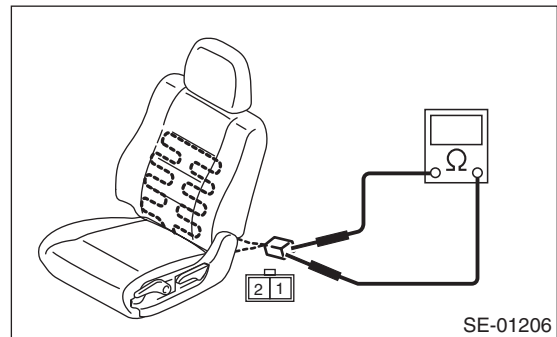

Is there continuity between connector terminals?

- **Continuity exists.**→

Replace the seat heater module of seat cushion side.

- **Continuity does not exist.**→

Replace the seat heater module of backrest side.

3. SEAT HEATER SWITCH

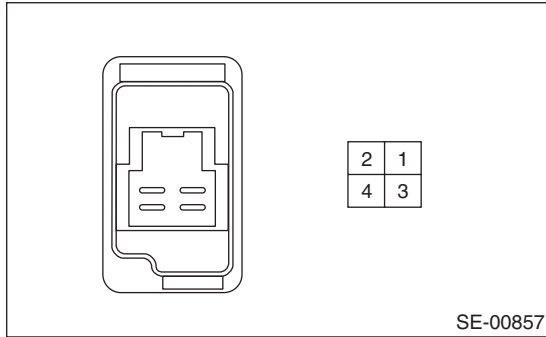

Inspect the continuity between the seat heater switch terminals.

Connector & terminal

HI

No. 2 — No. 1:

No. 2 — No. 3:

No. 1 — No. 3:

No. 4 — No. 3:

LOW

No. 2 — No. 4:

No. 2 — No. 3:

No. 4 — No. 3:

If no continuity exists, replace the seat heater switch with a new part.

	Page
1. General Description	2
2. Door Lock Control System	8
3. Keyless Entry System	13
4. Security System	25
5. Front Inner Remote	31
6. Front Outer Handle	32
7. Front Door Latch and Door Lock Actuator Assembly	33
8. Rear Inner Remote	34
9. Rear Outer Handle	35
10. Rear Door Latch and Door Lock Actuator Assembly	36
11. Rear Gate Opener Button	37
12. Rear Gate Latch and Actuator Assembly	38
13. Trunk Lid Latch and Actuator Assembly	39
14. Front Hood Lock Assembly	40
15. Remote Openers	41
16. Ignition Key Lock	43
17. Key Lock Cylinders	44
18. Security Control Module	45
19. Impact Sensor	46
20. Keyless Entry Control Module	47
21. Keyless Buzzer	48
22. Body Integrated Unit	49
23. Transmitter	50
24. Immobilizer Control Module	52
25. Immobilizer Antenna	53