

# Front Fog Light Assembly

## LIGHTING SYSTEM

### 15. Front Fog Light Assembly

#### A: REMOVAL

- 1) Disconnect the ground cable from battery.
- 2) Disengage the two clips, and then turn over the mud guard.

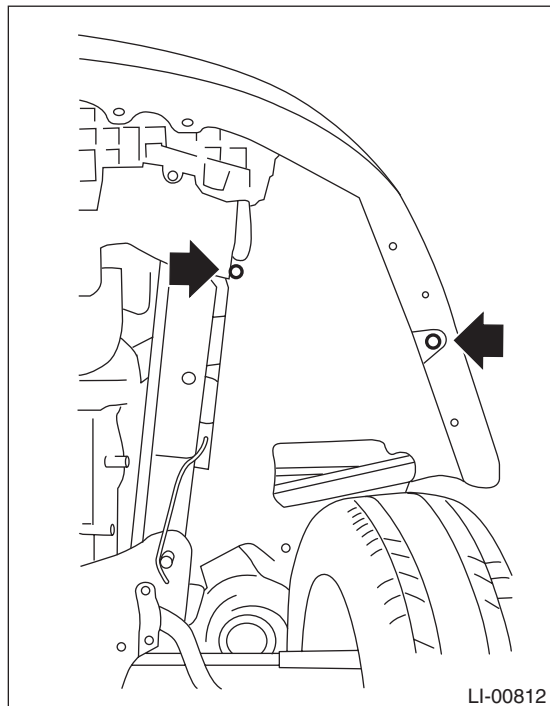

- 3) Disconnect the harness connector.
- 4) Remove the upper clip and the lower bolt and clip, and then remove the fog light assembly.

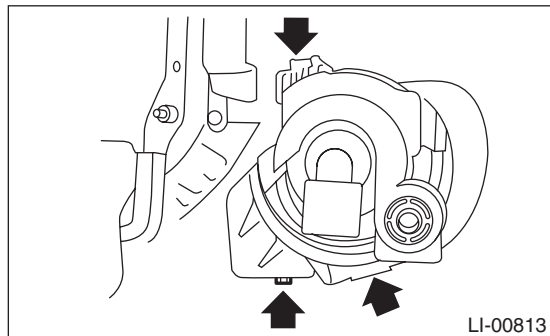

#### B: INSTALLATION

Install in the reverse order of removal.

#### *Tightening torque:*

**7.5 N·m (0.76 kgf-m, 5.5 ft-lb)**

#### C: ADJUSTMENT

##### 1. FOG LIGHT AIMING

- 1) Before checking the fog light beam level, be sure of the following:

- The area around the fog light has not sustained any accident, damage or other type of deformation.
- Vehicle is parked on a level surface.
- The inflation pressure of tires is correct.
- Vehicle's fuel tank is fully filled.

- 2) Bounce the vehicle several times to normalize the suspension.

- 3) Make certain that someone is seated in the driver's seat.

- 4) Disengage the two clips, and then turn over the mud guard.

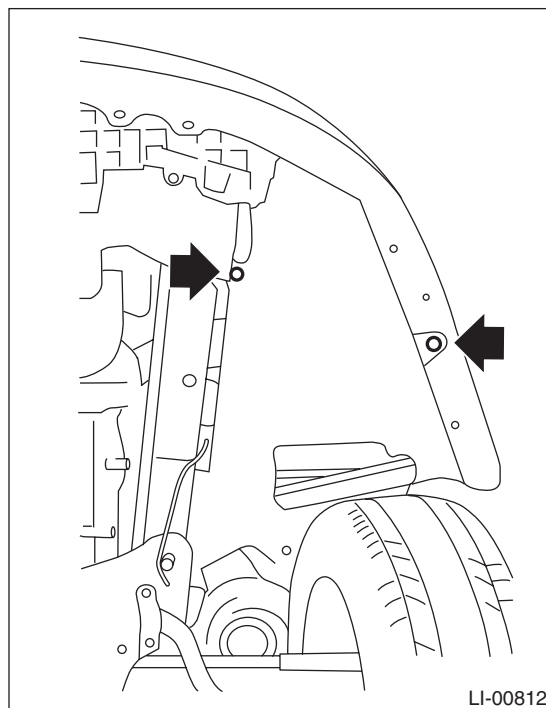

5) Adjust the front fog light pattern by inserting a Philips screwdriver to the adjusting hole.

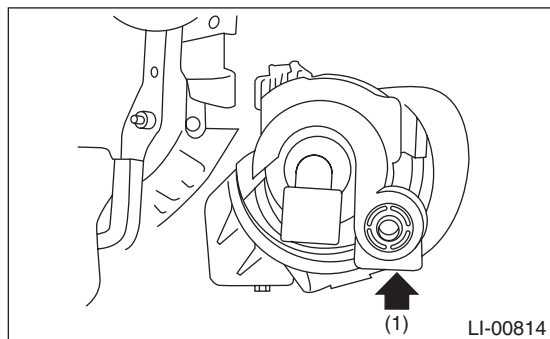

(1) Adjusting hole

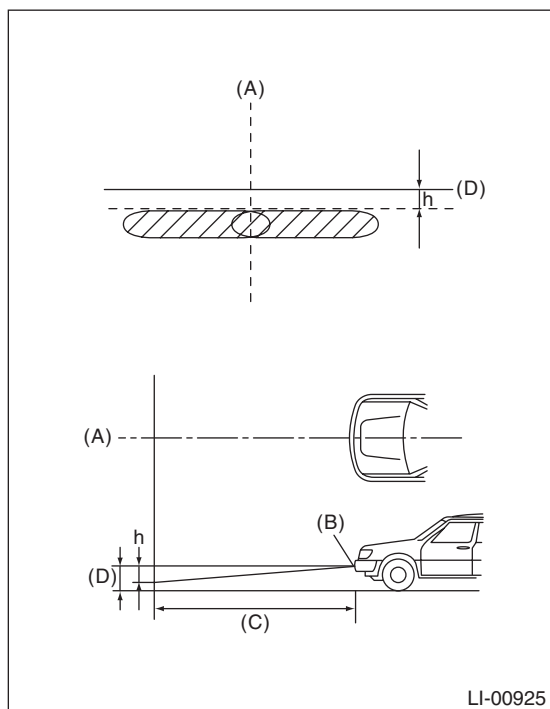

- (A) Vehicle center
- (B) Bulb center marking
- (C) 3 m (10 ft)
- (D) Height of fog light center

h mm (in) at 3 m (10 ft)
60 (2.38)