

25.Heater Duct

A: REMOVAL

1. REAR HEATER DUCT

- 1) Remove the heater cooling unit. <Ref. to AC-35, REMOVAL, Heater and Cooling Unit.>
- 2) Remove the front seats. <Ref. to SE-6, REMOVAL, Front Seat.>
- 3) Remove the front side sill cover.
- 4) Pull off the floor mat to remove the rear heater duct center (A) and rear heater duct LH, RH (B).

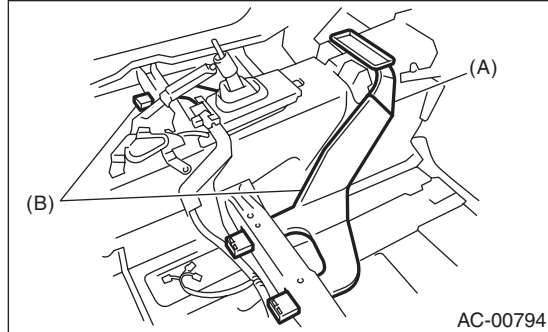

B: INSTALLATION

Install in the reverse order of removal.