

14.Compressor

A: REMOVAL

- 1) Perform compressor oil return operation. <Ref. to AC-25, PROCEDURE, Compressor Oil.>
- 2) Turn the A/C switch to OFF and stop the engine.
- 3) Using the refrigerant recovery system, discharge refrigerant. <Ref. to AC-20, PROCEDURE, Refrigerant Recovery Procedure.>
- 4) Disconnect the ground cable from battery.
- 5) Remove the V-belts. <Ref. to ME(H4DOTC)-40, REMOVAL, V-belt.> <Ref. to ME(H4SO)-39, REMOVAL, V-belt.>
- 6) Remove the generator. <Ref. to SC(H4SO)-16, REMOVAL, Generator.>
- 7) Remove the bolt and remove the low-pressure hose and high-pressure hose.

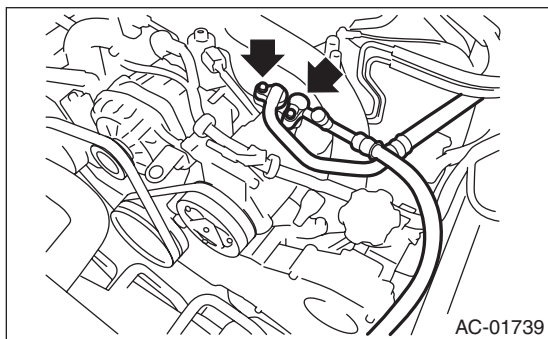

- 8) Disconnect the compressor harness from body harness.
- 9) Remove the bolts and remove the compressor bracket.

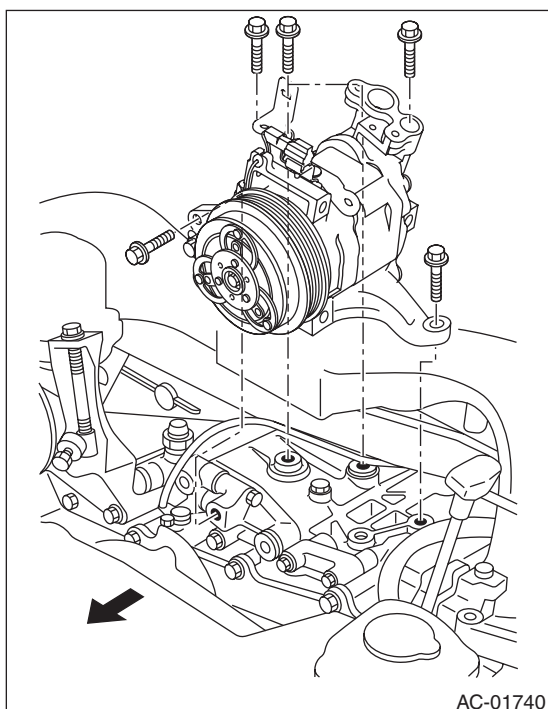

- 10) Remove the bolts, then remove the bracket from the compressor.

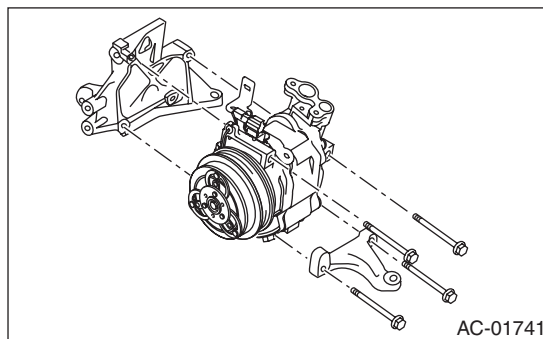

B: INSTALLATION

- 1) Install in the reverse order of removal.
- 2) Replace the O-rings on low/high pressure hoses with new parts, and apply compressor oil.
- 3) After replacing the compressor, adjust the amount of the compressor oil. <Ref. to AC-25, PROCEDURE, Compressor Oil.>
- 4) Charge refrigerant. <Ref. to AC-21, PROCEDURE, Refrigerant Charging Procedure.>

Tightening torque:

Refer to “**COMPONENT**” of “**General Description**”. <Ref. to AC-11, AIR CONDITIONING UNIT, COMPONENT, General Description.>
<Ref. to AC-12, COMPRESSOR, COMPONENT, General Description.>

C: INSPECTION

1. MAGNETIC CLUTCH CLEARANCE

- 1) Check the clearance of entire circumference around the drive plate and pulley.

Specification:

0.3 — 0.6 mm (0.0118 — 0.0236 in)

- 2) If it is not at the standard value, replace the compressor.

2. MAGNETIC CLUTCH OPERATION

- 1) Disconnect the compressor connector.
- 2) Connect the battery positive (+) terminal to the terminal of the compressor connector.
- 3) Check the magnet clutch engagement.
- 4) If there is a malfunction, replace the compressor.