

## 9. Door Sash Tape

### A: REMOVAL

#### 1. FRONT DOOR

- 1) Disconnect the ground cable from battery.
- 2) Remove the front door trim. <Ref. to EI-43, REMOVAL, Door Trim.>
- 3) Remove the outer mirror assembly. <Ref. to GW-15, REMOVAL, Outer Mirror Assembly.>
- 4) Remove the sealing cover. <Ref. to EB-21, REMOVAL, Front Sealing Cover.>
- 5) Remove the front door glass. <Ref. to GW-11, REMOVAL, Front Door Glass.>
- 6) Remove the glass run rubber.
- 7) Remove the B pillar upper clip, and remove the front door weather strip.

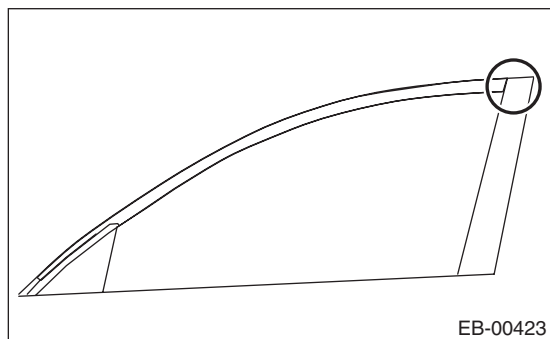

- 8) Remove the screws, and remove the front door weather strip outer.

#### CAUTION:

- When removing the weather strip outer, be careful not to damage the vehicle.
- If the weather strip outer is deformed, always replace with a new part.

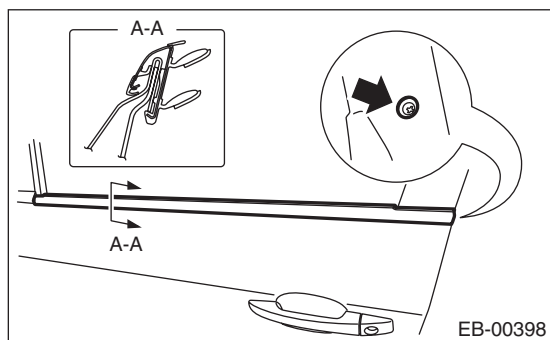

- 9) Peel the door sash tape from the door sash.

#### NOTE:

- If the tape is difficult to remove, warm the tape with a hairdryer, etc. to make the removal easier. Use a household hairdryer. Do not use industrial dryers.
- If tape residue is remaining on the door sash, wipe clean.

#### 2. REAR DOOR

- 1) Disconnect the ground cable from battery.
- 2) Remove the rear door trim. <Ref. to EI-43, REMOVAL, Door Trim.>
- 3) Remove the sealing cover. <Ref. to EB-24, REMOVAL, Rear Sealing Cover.>
- 4) Remove the rear door glass. <Ref. to GW-18, REMOVAL, Rear Door Glass.>
- 5) Remove the glass run rubber.
- 6) Remove the B pillar upper clip, and remove the rear door weather strip.

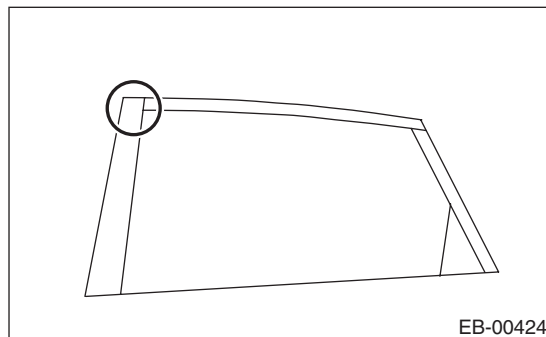

- 7) Loosen the screws and clips to remove the gusset cover outer.

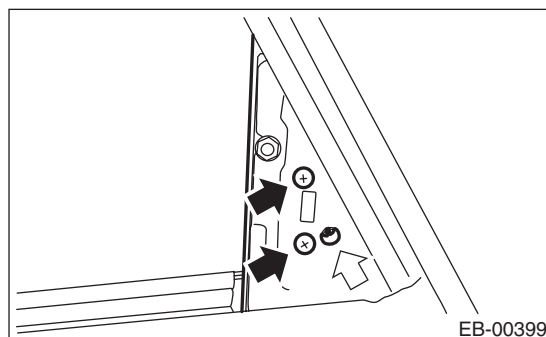

- 8) Remove the rear door weather strip outer.

#### CAUTION:

- When removing the weather strip outer, be careful not to damage the vehicle.
- If the weather strip outer is deformed, always replace with a new part.

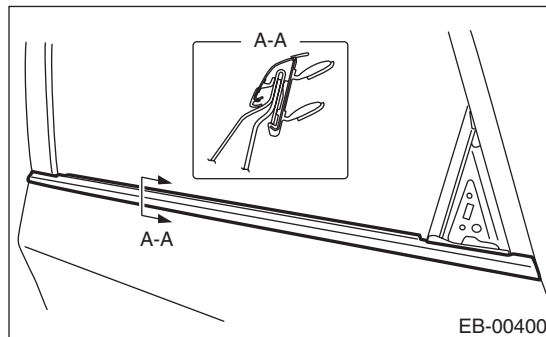

- 9) Peel the door sash tape from the door sash.

# Door Sash Tape

## EXTERIOR BODY PANELS

### NOTE:

- If the tape is difficult to remove, warm the tape with a hairdryer, etc. to make the removal easier. Use a household hairdryer. Do not use industrial dryers.
- If tape residue is remaining on the door sash, wipe clean.

## B: INSTALLATION

### CAUTION:

- When applying tape, use a spatula, etc. to apply evenly, pushing it against the sash to make sure that no air bubbles are formed. If air bubbles are formed, reapply the tape.
- If the tape is wrinkled, etc. during application, replace the tape.
- Turning points and ends of the tape will be a cause for peeling if the pressure is insufficient during application, so make sure to push down on the tape firmly when applying.
- There are locations where the tape ends will overlap each other. When applying the tape, be careful of the order of their application.

#### • Front

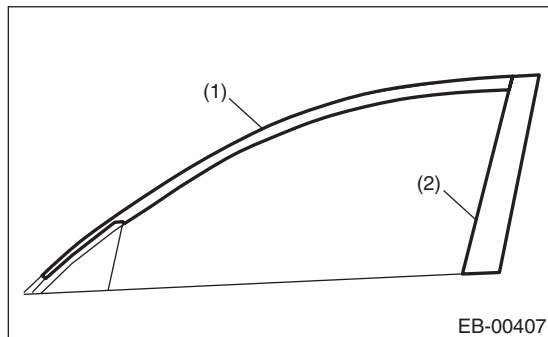

#### • Rear

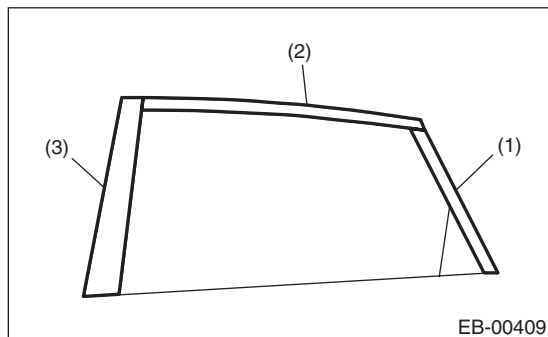

## 1. FRONT DOOR

- 1) Match the upper area of the gusset and the cut area of the tape as shown in the figure. (Position of the arrow)

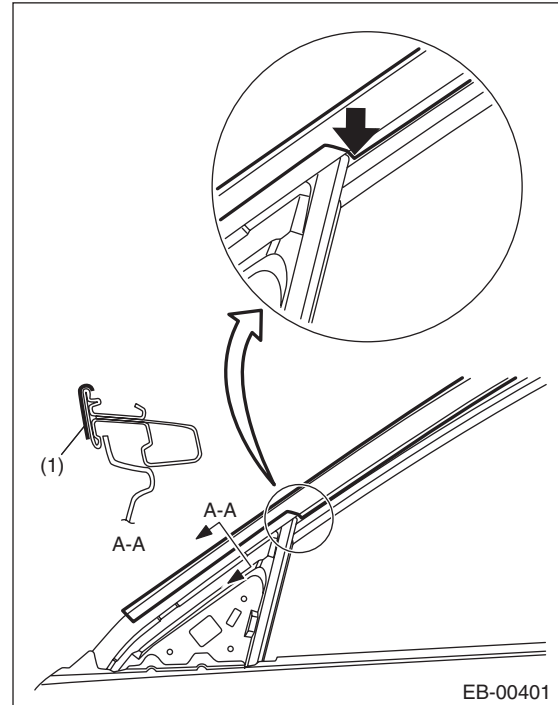

(1) Front door sash tape - front

- 2) Apply tape from the front of the vehicle towards the rear.

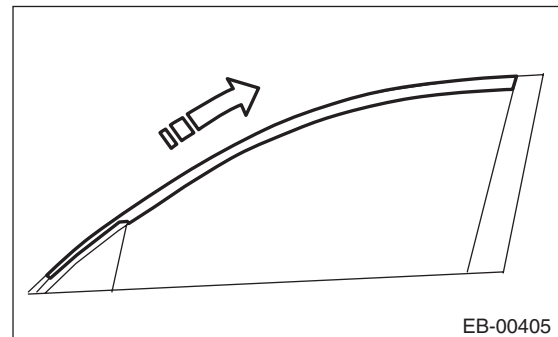

### NOTE:

Apply the tape end at a position within  $2.5 \pm 1.5$  mm ( $0.1 \pm 0.06$  in) from the front door rear sash line.

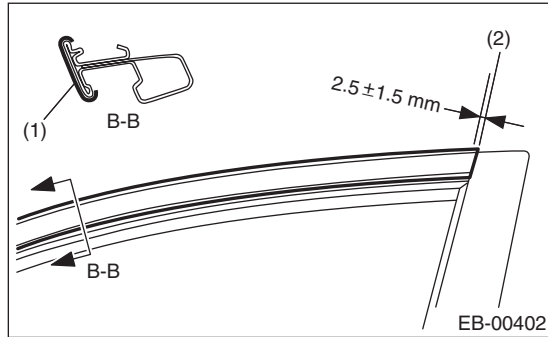

- (1) Front door sash tape - front
- (2) Front door rear sash line

3) Cut off both ends of the front door sash tape — rear.

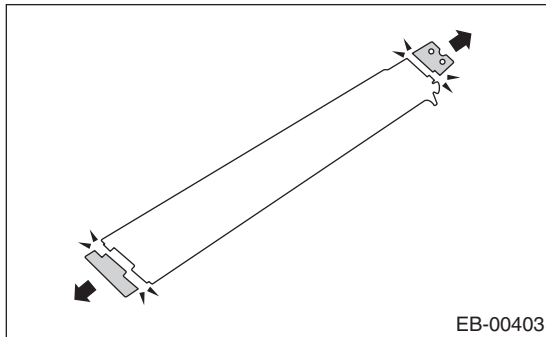

4) Match the sash corner and the cut area of the tape as shown in the figure. (Position of the arrow)

5) The lower end of the tape is to be aligned so that a space of approximately 3.7 mm (0.15 in) remains, so that the attachment holes of the weather strip outer are not blocked. (Position of the arrow)

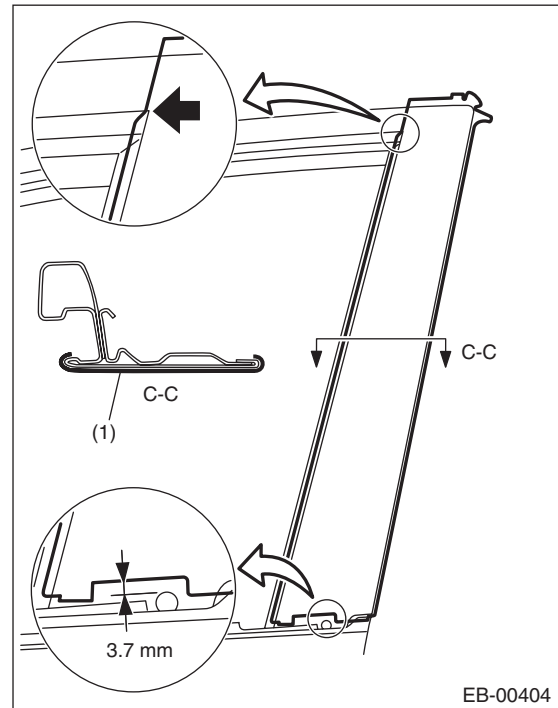

- (1) Front door sash tape — rear

6) Apply tape from the top of the vehicle towards the bottom.

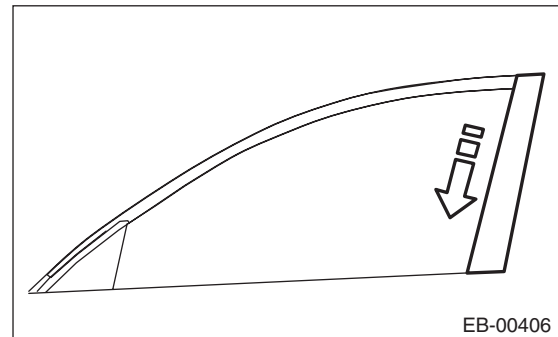

7) Fold the corners at the door upper end area in the order of (1) - (3).

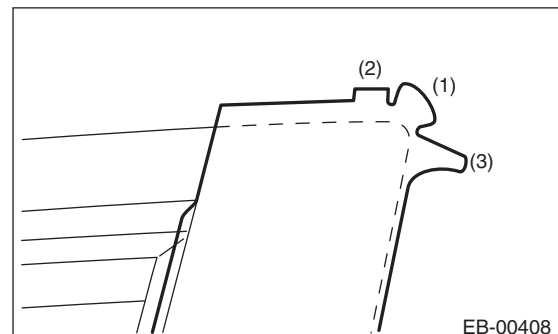

8) Thereafter, install door parts in the reverse order of disassembly.

# Door Sash Tape

## EXTERIOR BODY PANELS

9) Install while paying attention to make a uniform clearance around the front door panel. For the dimension of clearance, refer to "SPECIFICATION" in "General Description". <Ref. to EB-2, SPECIFICATION, General Description.>

### 2. REAR DOOR

1) Apply the tape end at a position within  $2.5 \pm 1.5$  mm ( $0.1 \pm 0.06$  in) from the rear door front sash line.

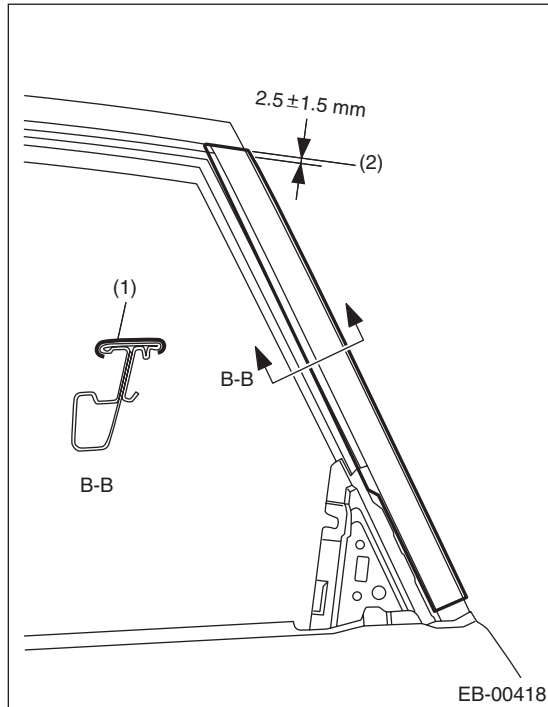

- (1) Rear door sash tape — rear
- (2) Rear door upper sash line

2) Apply tape from the top of the vehicle towards the bottom.

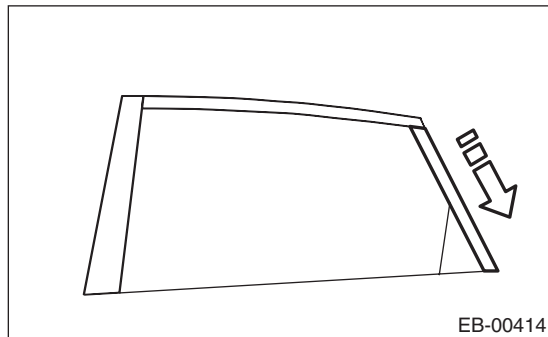

3) Match the rear door upper sash corner and the cut area of the tape as shown in the figure. (Position of the arrow)

### NOTE:

Apply the tape end at a position within  $2.5 \pm 1.5$  mm ( $0.1 \pm 0.06$  in) from the rear door front sash line.

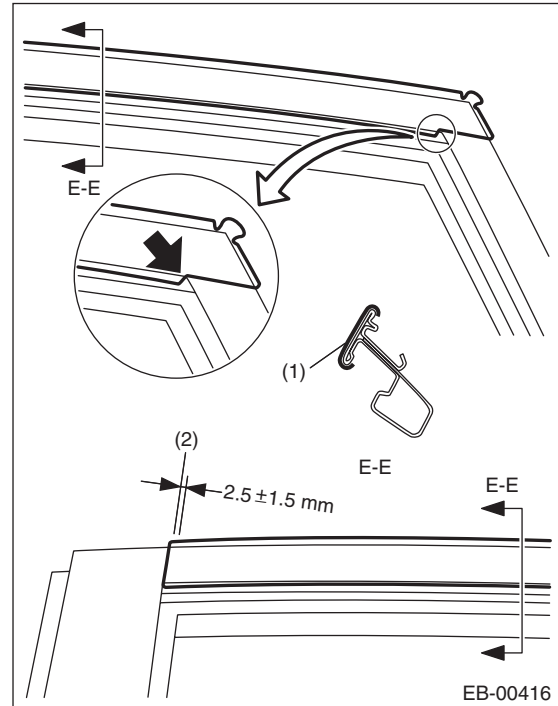

- (1) Rear door sash tape — medium
- (2) Rear door front sash line

4) Apply tape from the rear of the vehicle towards the front.

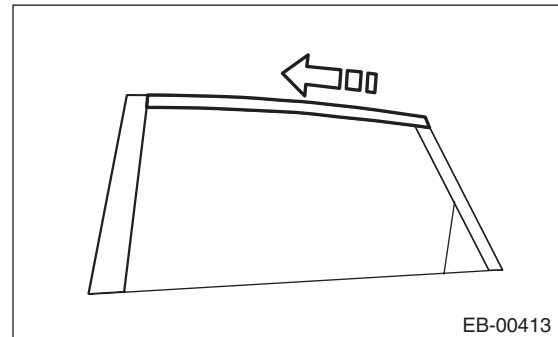

5) Fold the corners at the door upper end area in the order of (1) - (3).

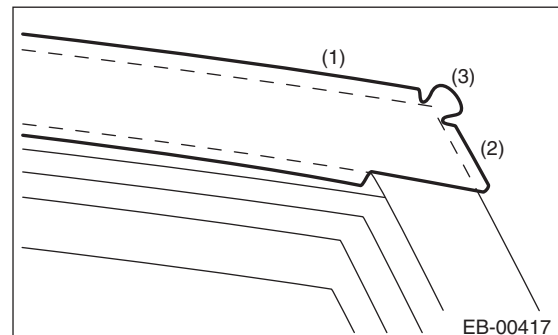

6) Cut off both ends of the rear door sash tape — front.

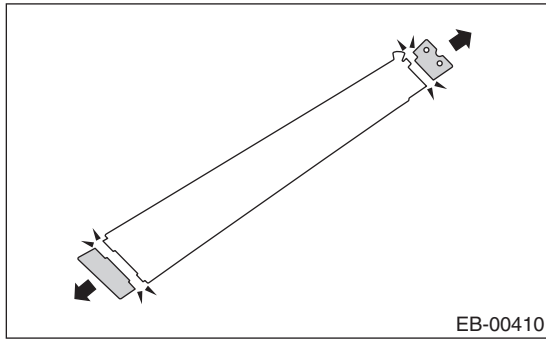

7) Match the sash corner and the cut area of the tape as shown in the figure. (Position of the arrow)  
8) The lower end of the tape is to be aligned so that a space of approximately 3.7 mm (0.15 in) remains, so that the attachment holes of the weather strip outer are not blocked. (Position of the arrow)

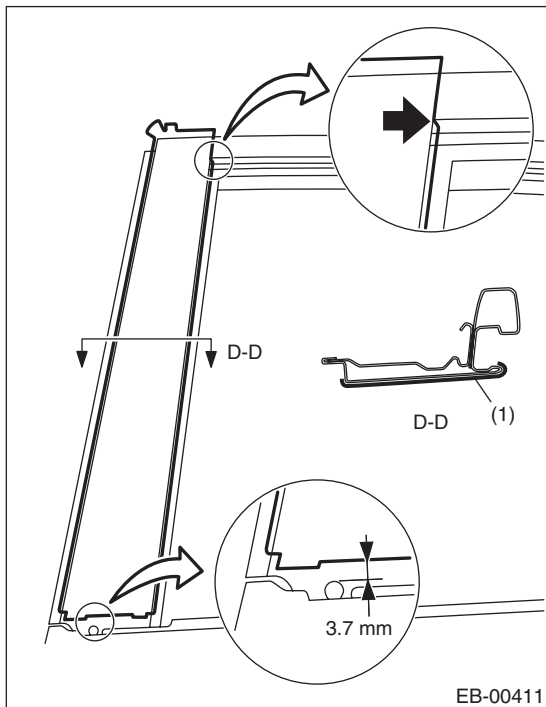

(1) Rear door sash tape — front

9) Apply tape from the top of the vehicle towards the bottom.

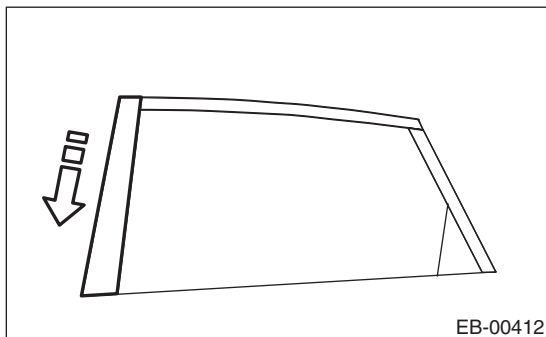

10) Fold the corners at the door upper end area in the order of (1) - (2).

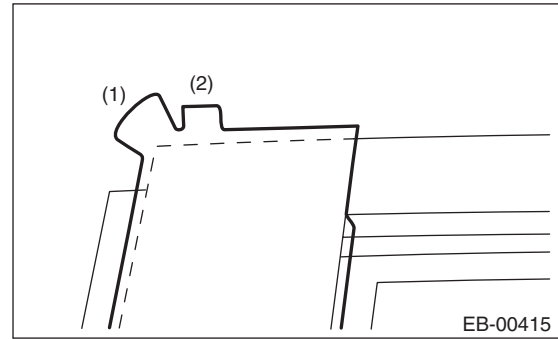

11) Thereafter, install door parts in the reverse order of disassembly.

12) Install while paying attention to make a uniform clearance around the rear door panel. For the dimension of clearance, refer to "SPECIFICATION" in "General Description". <Ref. to EB-2, SPECIFICATION, General Description.>