

# BODY STRUCTURE

# BS

---

	Page
1. Steering Support Beam .....	2
2. Quietness .....	3
3. Body Sealing .....	5
4. Painting .....	6
5. Anti Chipping Coat (ACC) Application .....	8
6. Stone Guard Coat (SGC) Application .....	9
7. Sealer Application .....	10
8. Anti-rust Wax (Bitumen Wax) Application .....	15
9. Polyvinyl Chloride (PVC) Application .....	19
10. Hot Wax Application .....	20
11. Galvanized Sheet Metal Parts .....	21
12. Aluminum Sheet Metal Parts .....	22
13. Ventilation .....	23
14. Child Seat Anchors .....	24

# STEERING SUPPORT BEAM

## BODY STRUCTURE

---

### 1. Steering Support Beam

A steering support beam is provided between the left and right front pillars for reinforced support of the steering column. It also minimizes vibration of the steering column and limits its extension to a minimum in the event of a collision.

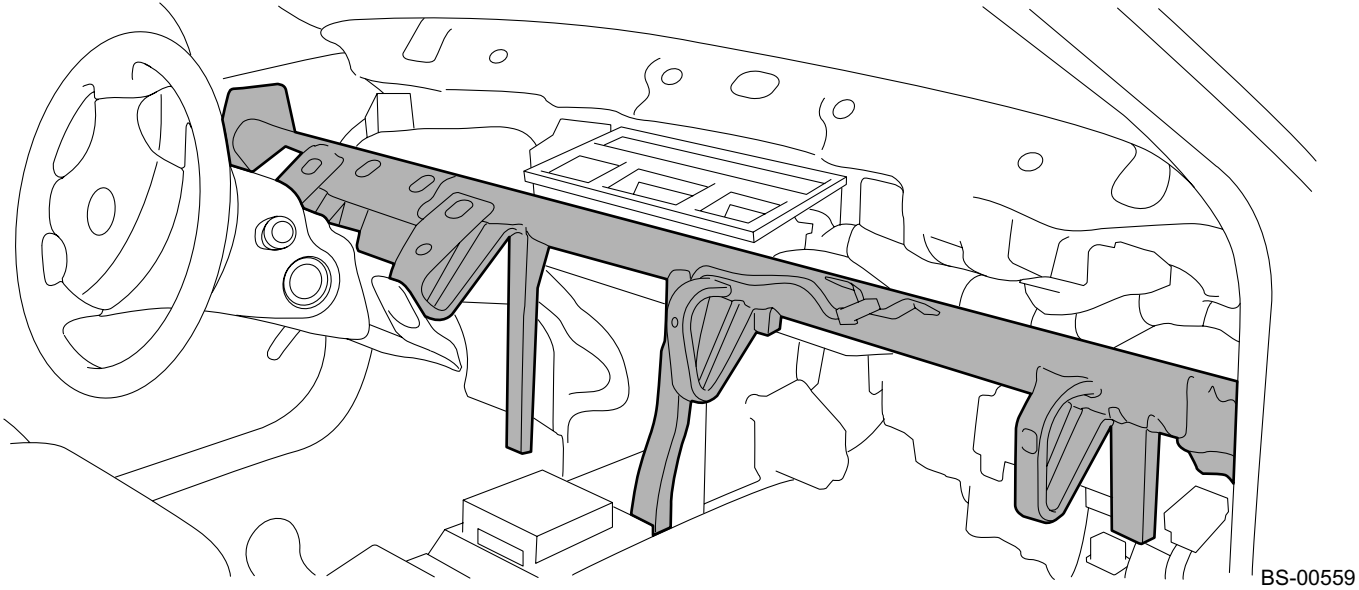

### 2. Quietness

Silencers, dual-wall panels, sound-absorbing materials, etc. are utilized in conjunction with a high-rigidity and vibration/noise-proof body structure in order to ensure quietness of the passenger compartment.

#### A: SILENCER

Silencers (= asphalt sheets) minimize transmission of noise/vibration into the passenger compartment.

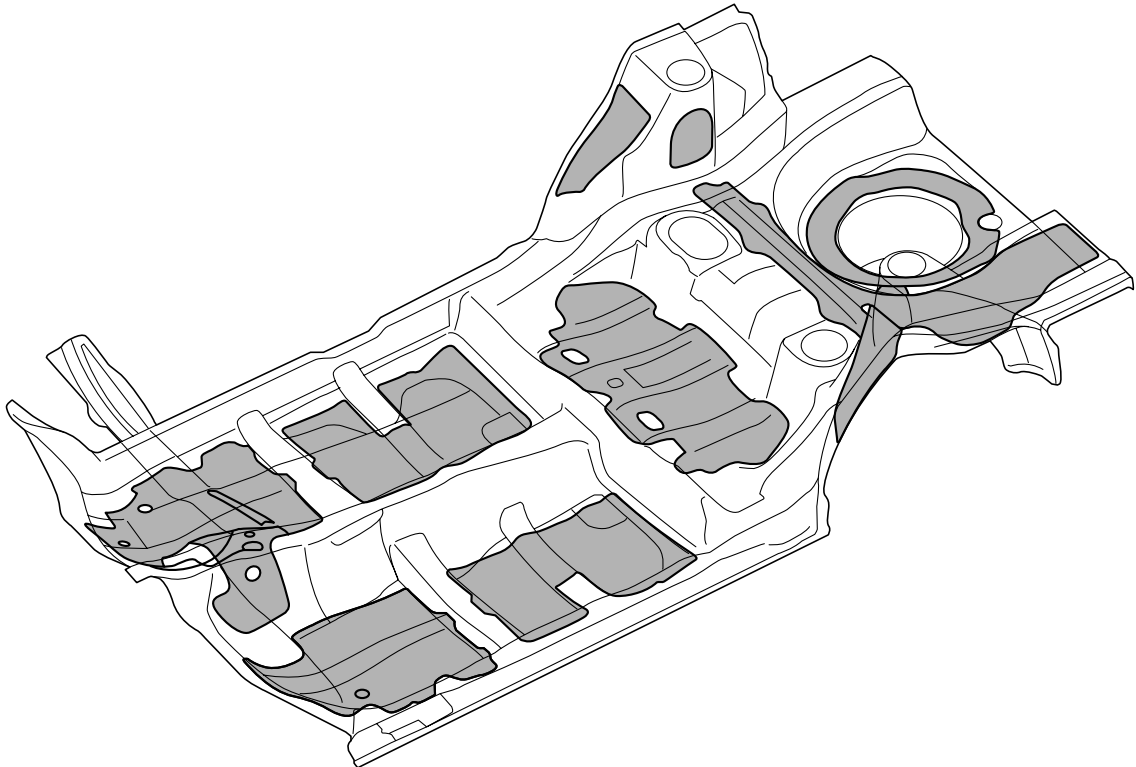

BS-00560

### B: DUAL-WALL

The toeboard is a dual-wall design consisting of an asphalt sheet placed between two steel panels to reduce the transmission of noise and vibration from the engine compartment to the passenger compartment.

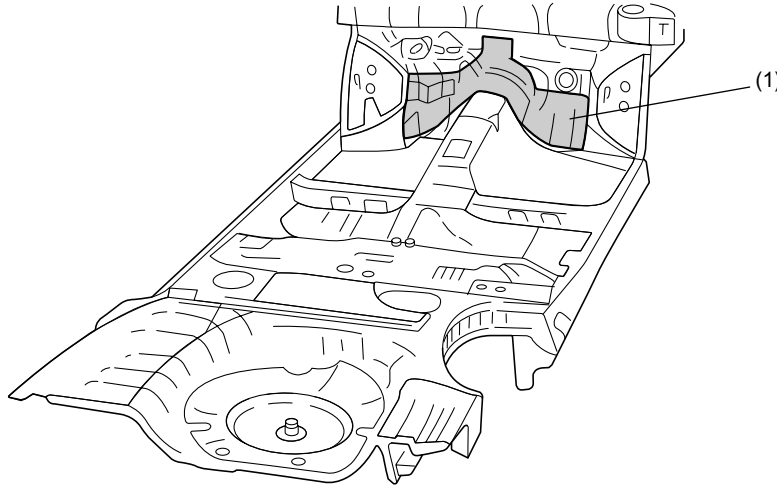

BS-00561

(1) Dual-wall

### **3. Body Sealing**

#### **A: SEALED PARTS**

All gauge holes and other holes used during the body manufacturing process are plugged to prevent entry of water and dust.

Any time the vehicle body has been repaired, the affected holes should be properly plugged with the use of the specified plugs.

**PAINTING**

BODY STRUCTURE

---

**4. Painting**  
**A: SPECIFICATIONS**

Color name	Color code
PREMIUM SILVER (M)	01G
SOLID RED	22G
CRYSTAL GRAY METALLIC (M)	48W
REGAL BLUE PEARL	35J
OBSIDIAN BLACK PEARL	32J
PARCHMENT (M)	41V

(M): Metallic

## B: PAINT FILM STRUCTURE

Color name	Paint film structure	
<ul style="list-style-type: none"> <li>SOLID RED</li> </ul>	<p style="text-align: right;">(1) (2) (3)</p> <p style="text-align: right;">BS-00562</p>	<p>(1) Clear coat (2) Color base (3) Intermediate paint</p> <p><b>(A)</b> Pigment</p>
<ul style="list-style-type: none"> <li>PREMIUM SILVER (M)</li> <li>CRYSTAL GRAY METALLIC (M)</li> <li>PARCHMENT (M)</li> </ul> <p>(M): Metallic</p>	<p style="text-align: right;">(1) (2) (3)</p> <p style="text-align: right;">BS-00563</p>	<p>(1) Clear coat (2) Color base (3) Intermediate paint</p> <p><b>(A)</b> Pigment <b>(B)</b> Aluminum pigment</p>
<ul style="list-style-type: none"> <li>REGAL BLUE PEARL</li> <li>OBSIDIAN BLACK PEARL</li> </ul>	<p style="text-align: right;">(1) (2) (3)</p> <p style="text-align: right;">BS-01489</p>	<p>(1) Clear coat (2) Color base (3) Intermediate paint</p> <p><b>(A)</b> Pigment <b>(B)</b> Colored mica</p>

# ANTI CHIPPING COAT (ACC) APPLICATION

BODY STRUCTURE

---

## 5. Anti Chipping Coat (ACC) Application

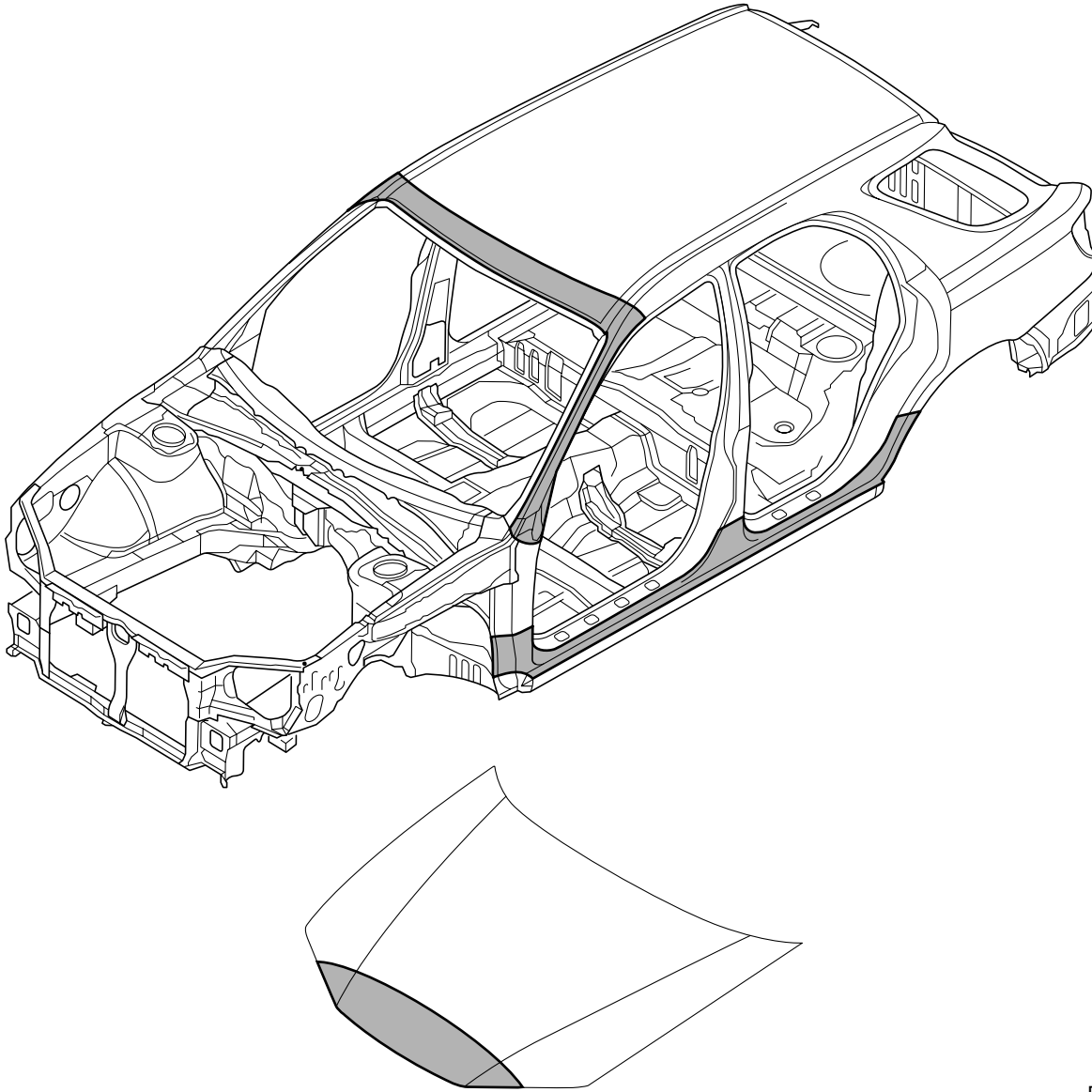

BS-01435

## 6. Stone Guard Coat (SGC) Application

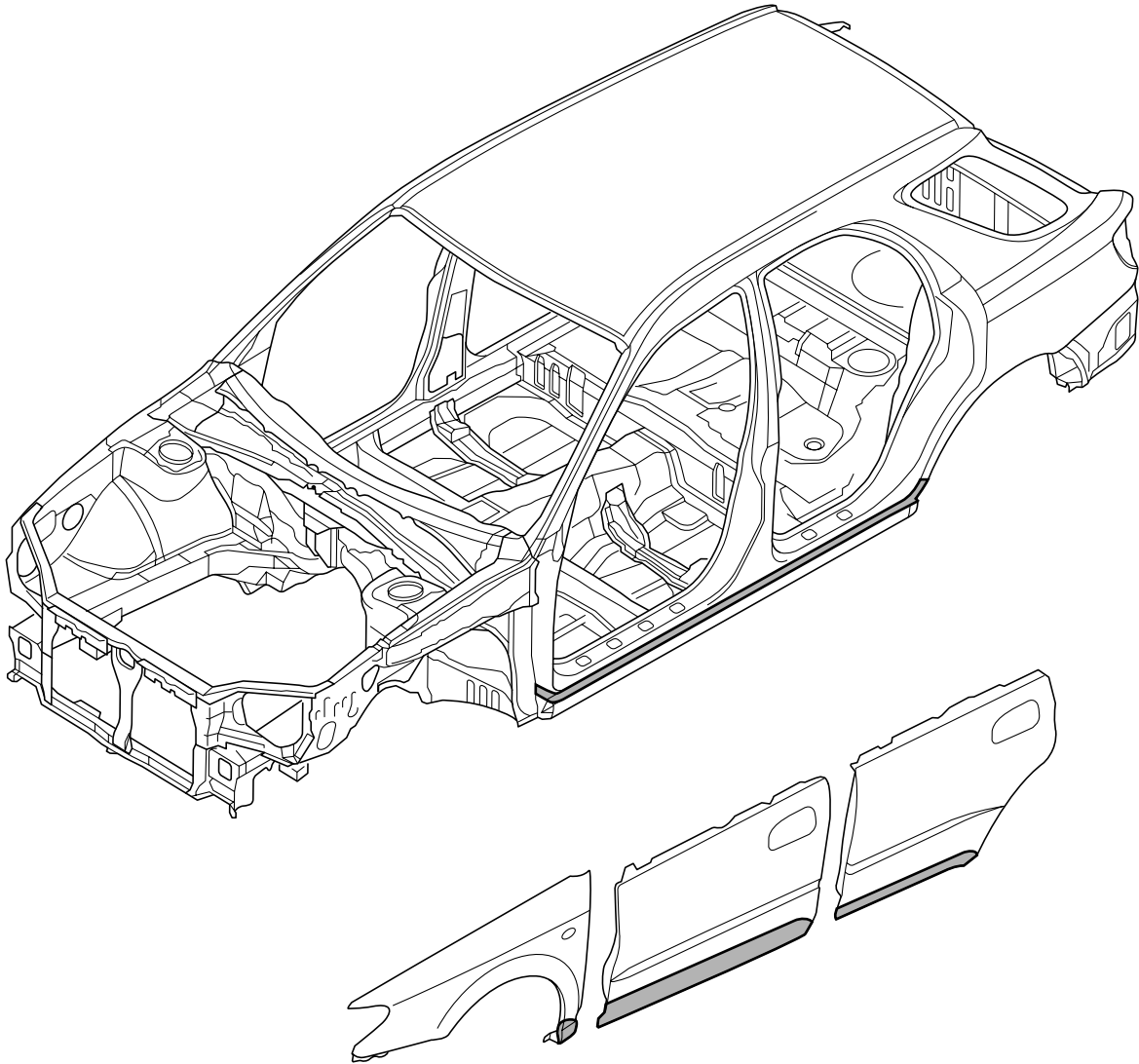

BS-01402

# SEALER APPLICATION

## BODY STRUCTURE

### 7. Sealer Application

#### A: ENGINE COMPARTMENT

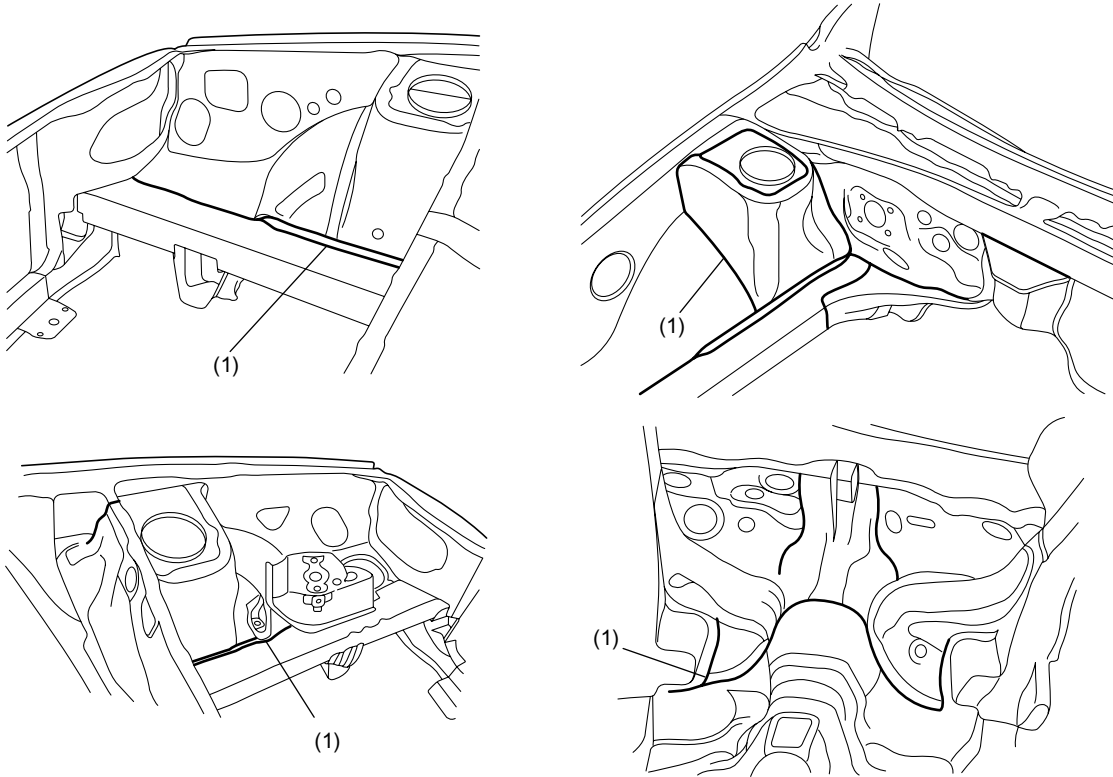

BS-01436

(1) Sealer

#### B: FRONT HOOD

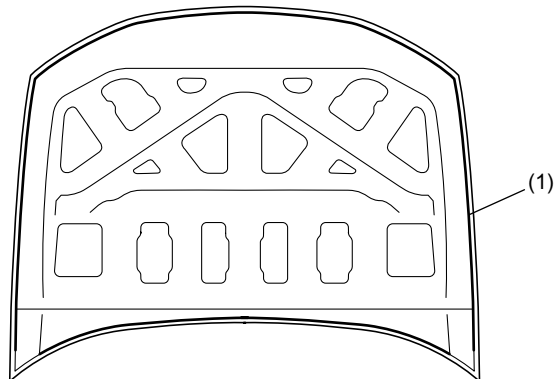

BS-01403

(1) Sealer

## C: DOOR

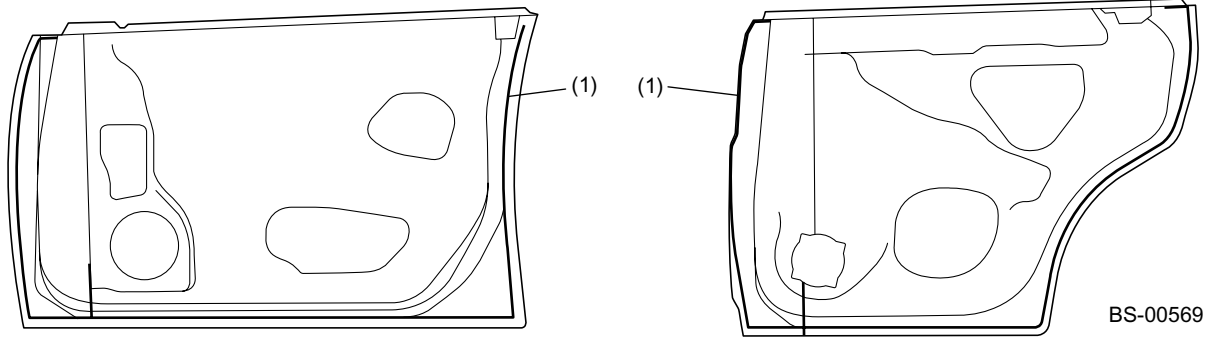

(1) Sealer

## D: REAR GATE

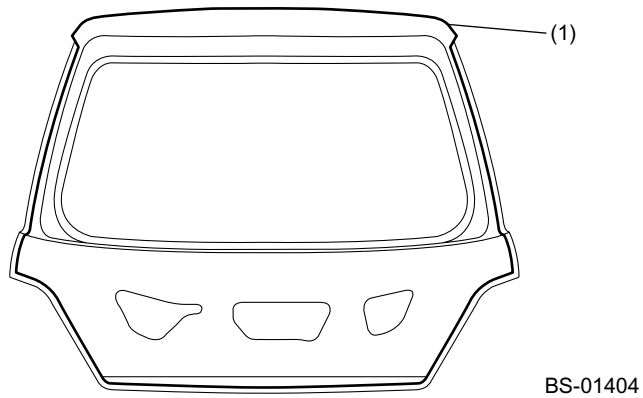

(1) Sealer

# SEALER APPLICATION

## BODY STRUCTURE

### E: REAR END

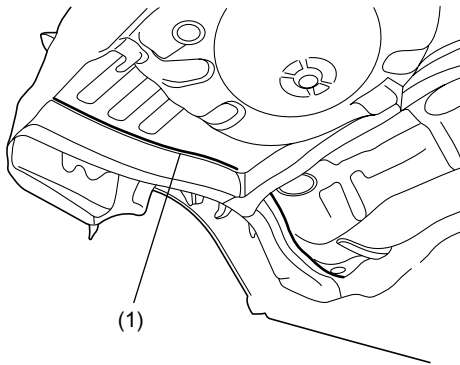
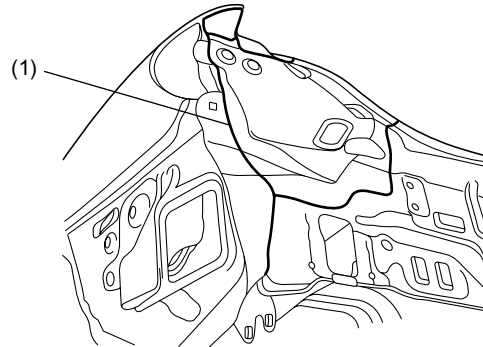
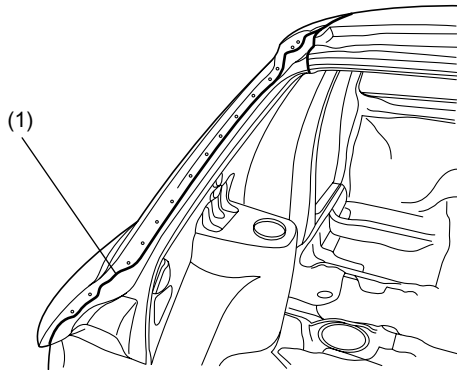

BS-00572

(1) Sealer

### F: ROOF PANEL

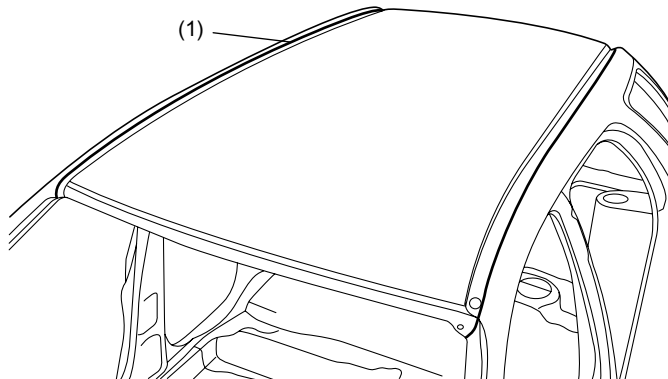

BS-00574

(1) Sealer

## G: FRONT FLOOR

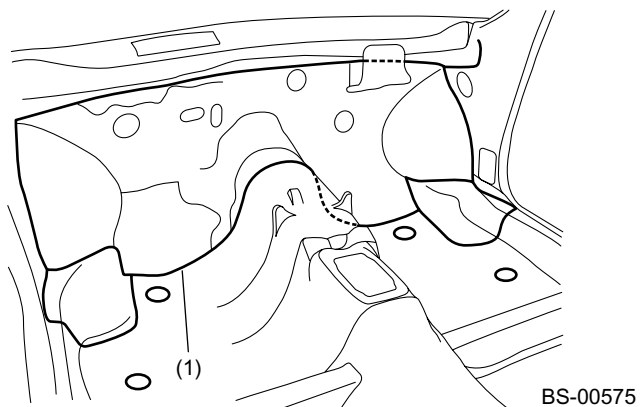

(1) Sealer

## H: REAR FLOOR

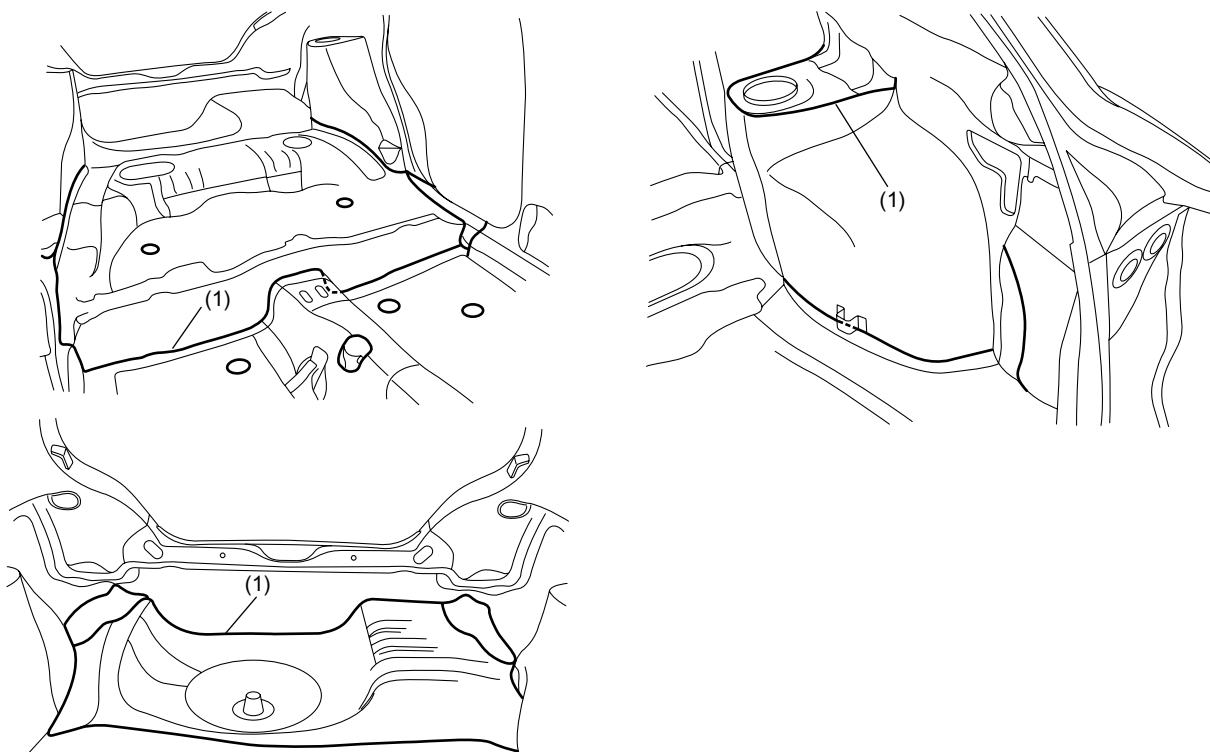

(1) Sealer

# SEALER APPLICATION

## BODY STRUCTURE

### I: UNDERBODY

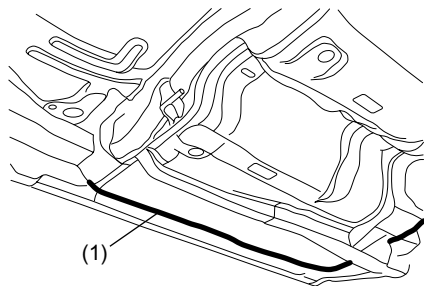
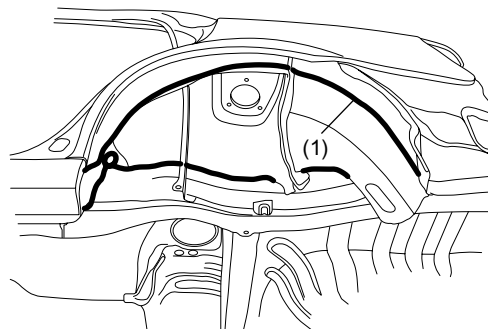
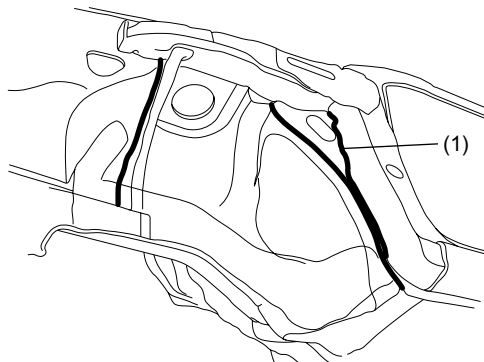

BS-00578

(1) Sealer

### J: FUEL LID

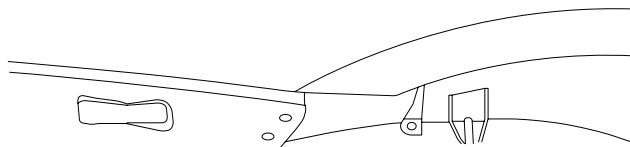
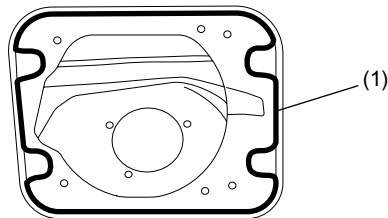

BS-00579

(1) Sealer

## 8. Anti-rust Wax (Bitumen Wax) Application

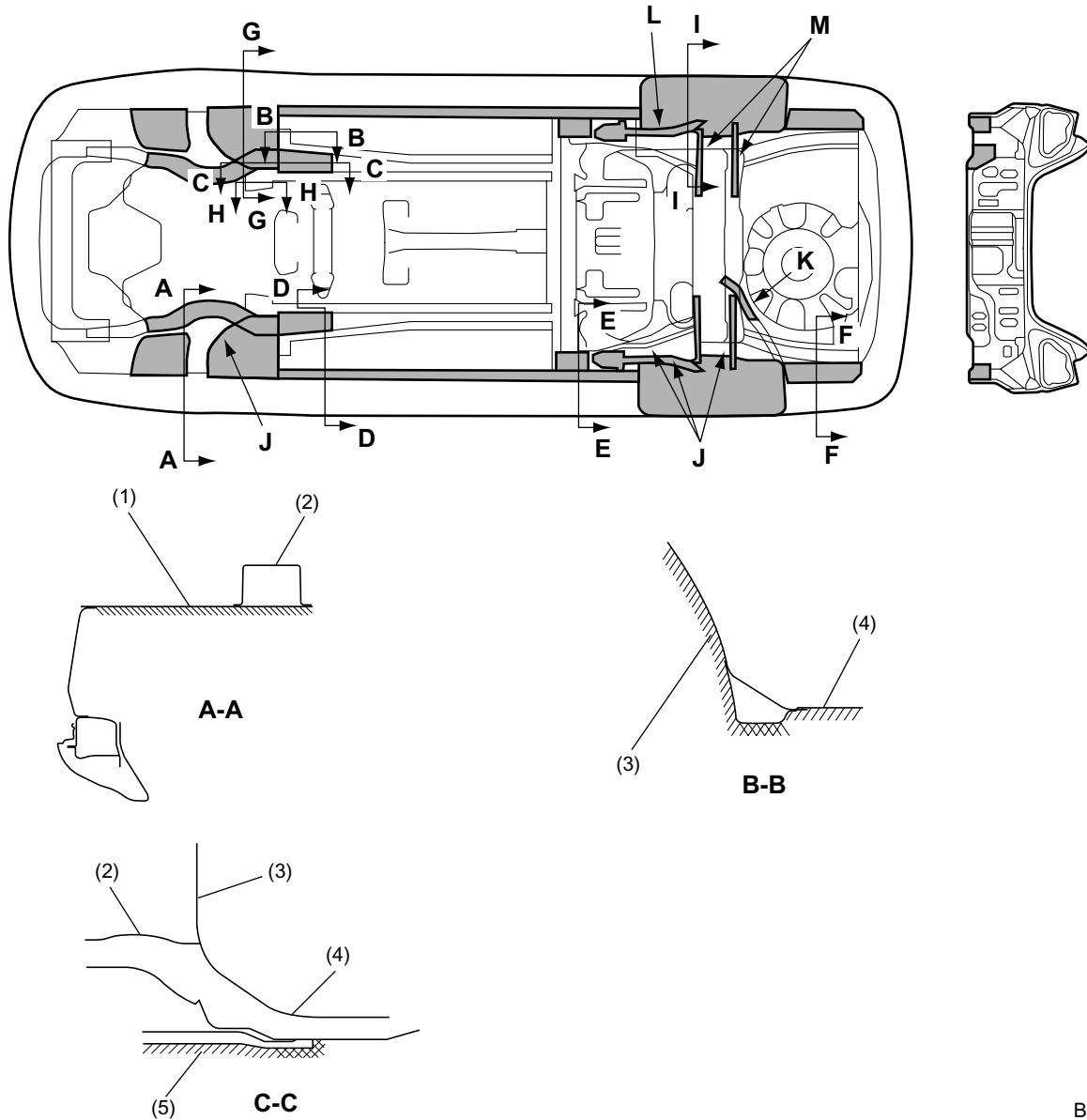

- (1) Front suspension lower bracket
- (2) Front side frame
- (3) Toeboard

- (4) Front floor
- (5) Sub frame

- A-A Body lower surface
- B-B Section A
- C-C Section B

BS-01410

# ANTI-RUST WAX (BITUMEN WAX) APPLICATION

## BODY STRUCTURE

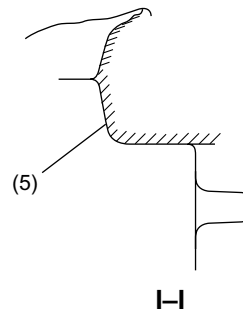
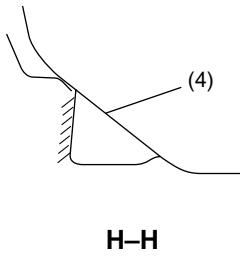
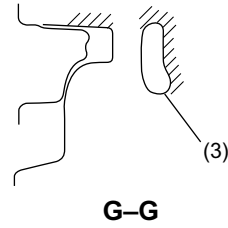
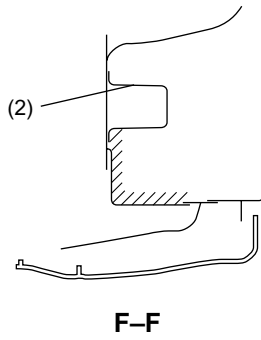
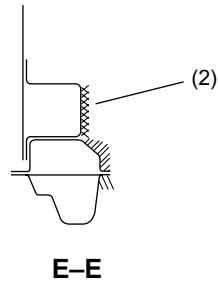
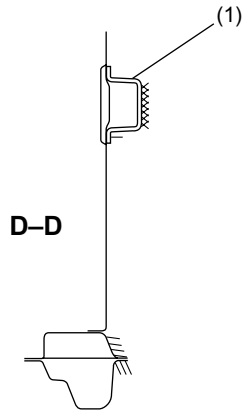

BS-01408

# ANTI-RUST WAX (BITUMEN WAX) APPLICATION

BODY STRUCTURE

---

(1) Front side frame

(2) Rear side frame

(3) Sub frame

(4) Toeboard

(5) Rear wheel apron

**D-D** Section C

**E-E** Section D

**F-F** Section E

**G-G** Section F

**H-H** Section G

**I-I** Section H

# ANTI-RUST WAX (BITUMEN WAX) APPLICATION

## BODY STRUCTURE

---

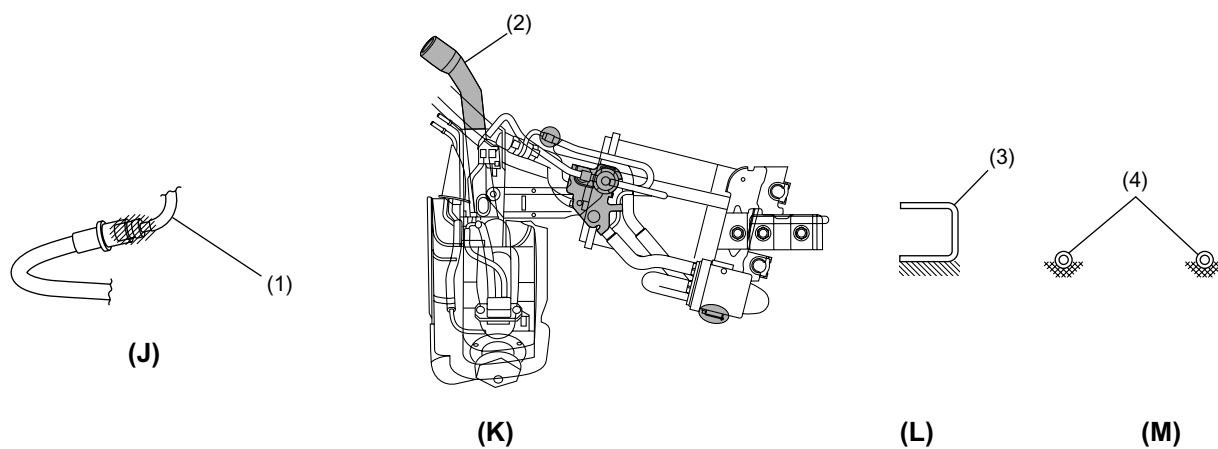

BS-01405

- (1) Brake pipe
- (2) Filler pipe
- (3) Trailing link
- (4) Lateral link

- (J) Detail J
- (K) Detail K

## 9. Polyvinyl Chloride (PVC) Application

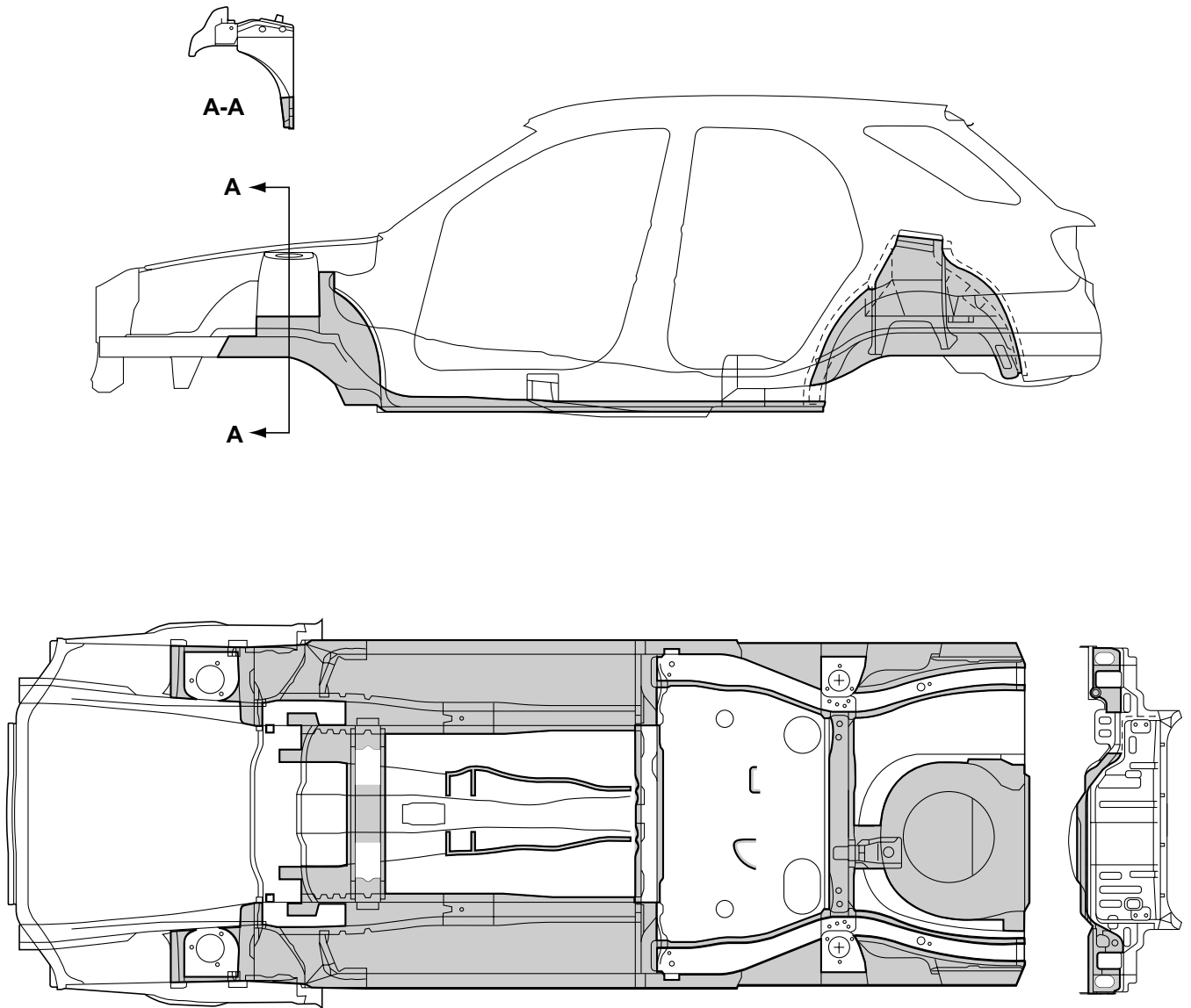

BS-01437

A-A Section A

### 10.Hot Wax Application

Hot wax is applied to the following portions.

- Front cross member
- Tie rod and tie rod ends
- Transverse links
- Front stabilizer
- Axle housing
- Engine lower surface
- Transmission lower surface

## 11.Galvanized Sheet Metal Parts

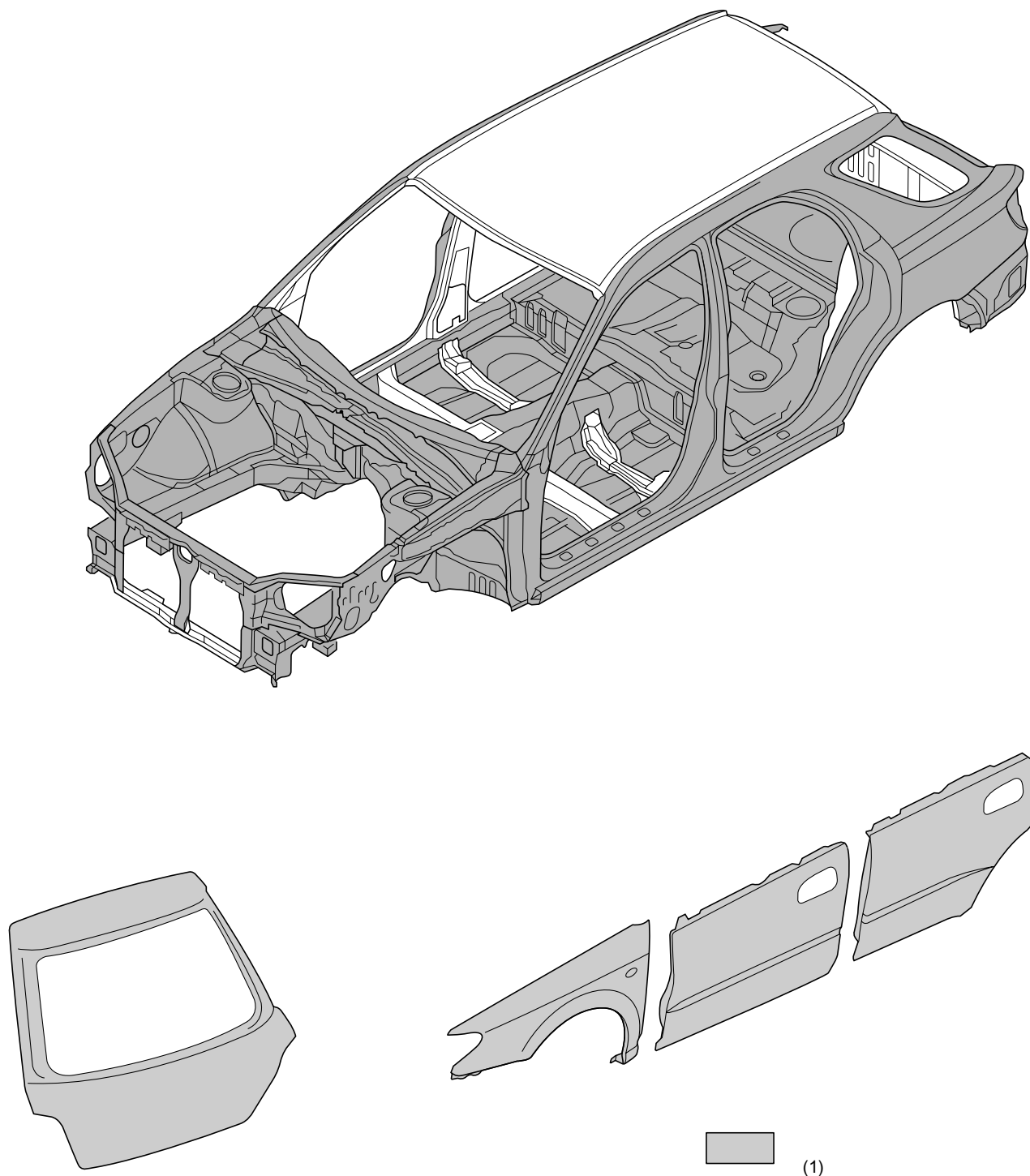

BS-01438

(1) Galvanized on both sides

## 12.Aluminum Sheet Metal Parts

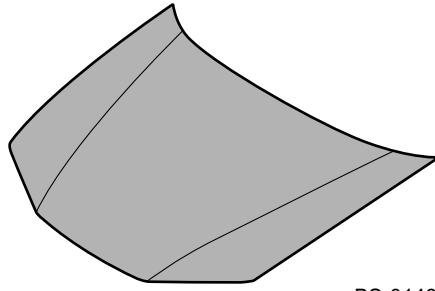

BS-01488

### 13.Ventilation

#### A: OUTLET PORT

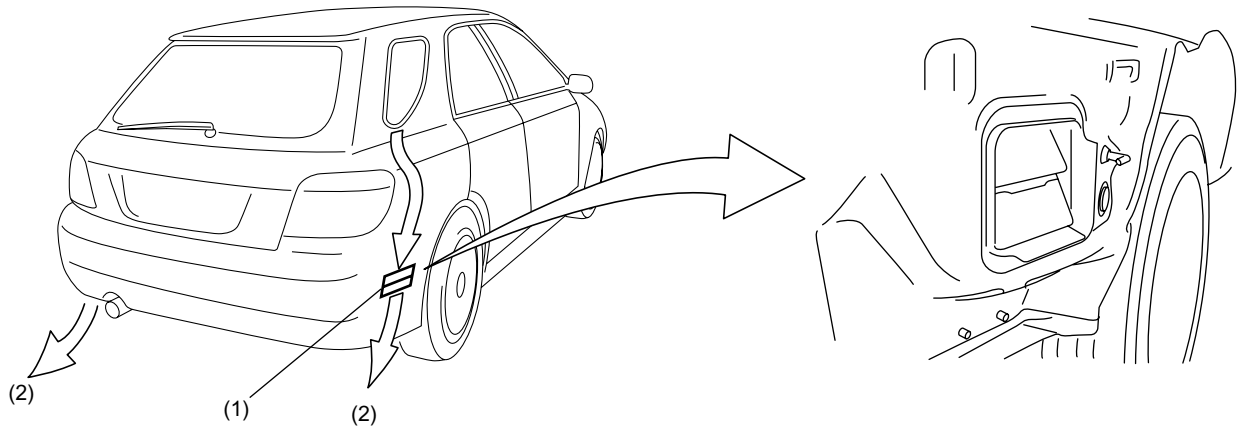

BS-01400

- (1) Outlet port
- (2) Air flow

#### **14.Child Seat Anchors**

Child seat anchors are added to the rear floor panel in order to conform with the FMVSS225 (ISO-FIX) requirements for child restraint anchorage systems.