

SPEED CONTROL SYSTEMS

General Description

SPEED CONTROL SYSTEMS

1. General Description

A: SPECIFICATION

Accelerator pedal	Free play	At pedal pad	0 — 4 mm (0 — 0.16 in)
	Stroke	At pedal pad	52 — 57 mm (2.05 — 2.24 in)

B: COMPONENT

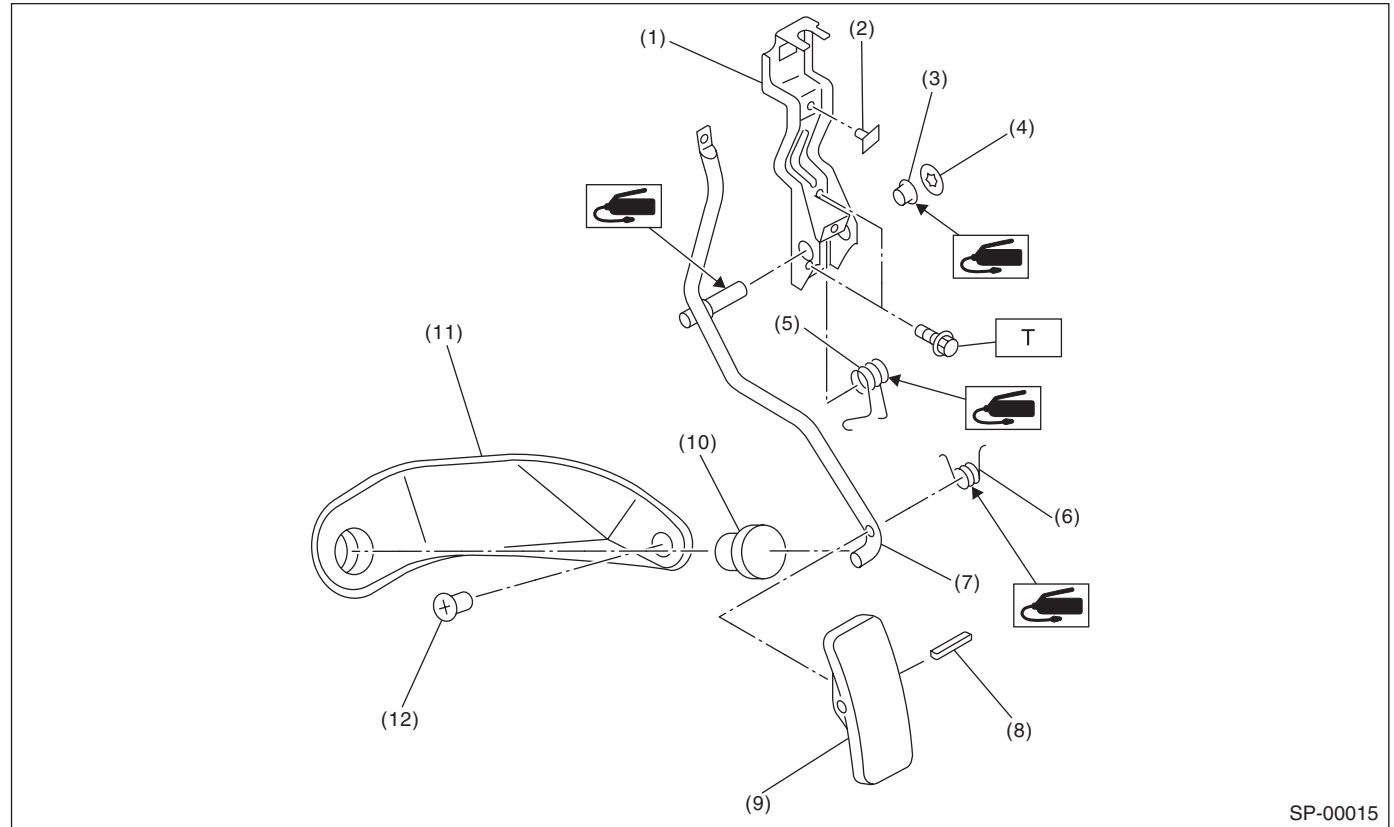

SP-00015

- | | | |
|-------------------------|------------------------------|------------------------|
| (1) Accelerator bracket | (6) Accelerator pedal spring | (11) Accelerator plate |
| (2) Stopper | (7) Accelerator pedal lever | (12) Clip |
| (3) Bushing | (8) Spring pin | |
| (4) Clip | (9) Accelerator pedal | |
| (5) Accelerator spring | (10) Accelerator stopper | |

Tightening torque: N·m (kgf-m, ft-lb)

T: 18 (1.8, 13.0)

C: CAUTION

- Wear work clothing, including a cap, protective goggles, and protective shoes during operation.
- Remove contamination, including dirt and corrosion, before removal, installation or disassembly.
- Keep the disassembled parts in order and protect them from dust and dirt.
- Before removal, installation or disassembly, be sure to clarify the failure. Avoid unnecessary removal, installation, disassembly, and replacement.
- Be careful not to burn your hands, because each part in the vehicle is hot after running.
- Be sure to tighten fasteners including bolts and nuts to the specified torque.
- Place shop jacks or rigid racks at the specified points.

- Before disconnecting electrical connectors of sensors or units, be sure to disconnect the ground cable from battery.

2. Accelerator Pedal

A: REMOVAL

- 1) Disconnect the ground cable from battery.
- 2) Remove the lock nut from accelerator cable bracket.
- 3) Separate the accelerator cable from bracket.
- 4) Remove the accelerator cable end from throttle cam.

NOTE:

Be careful not to kink the accelerator cable.

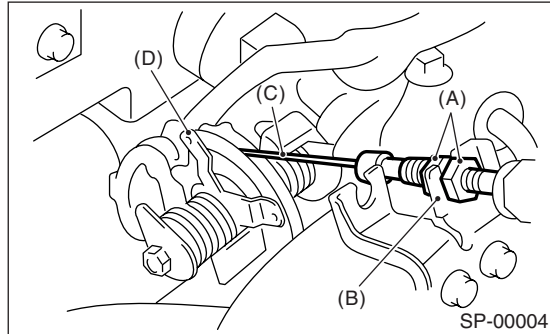

- (A) Lock nut
- (B) Accelerator cable bracket
- (C) Accelerator cable
- (D) Throttle cam

- 5) Remove the clip inside engine compartment.

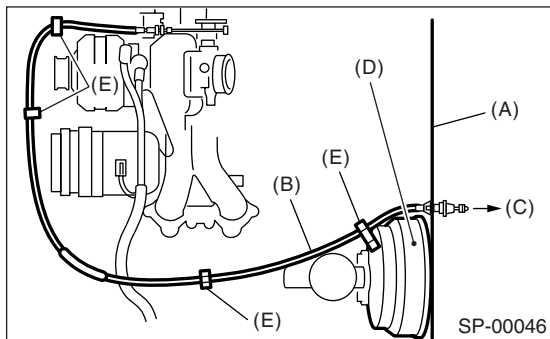

- (A) Toe board
- (B) Accelerator cable
- (C) To accelerator pedal
- (D) Brake booster
- (E) Clip

- 6) Remove the instrument panel lower cover from instrument panel.

- 7) Remove the accelerator pedal connecting bolt from accelerator pedal bracket.

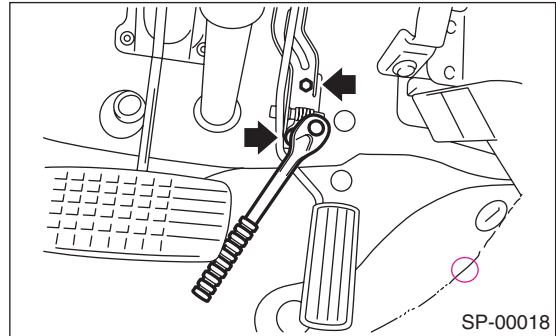

- 8) Disconnect the grommet from toe board.

NOTE:

From inside compartment, push the grommet (A) into hole.

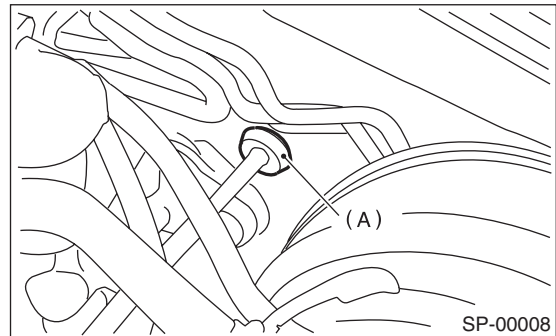

- 9) Pull out the cable from toe board hole.

- 10) Disconnect the accelerator cable bushing from accelerator pedal lever.

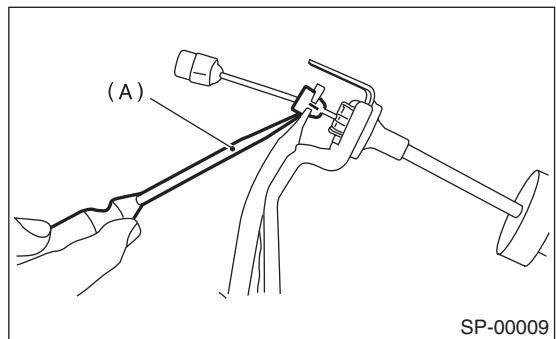

- (A) Flat tip screwdriver

Accelerator Pedal

SPEED CONTROL SYSTEMS

- 11) Disconnect the accelerator cable stopper (A) from bracket.

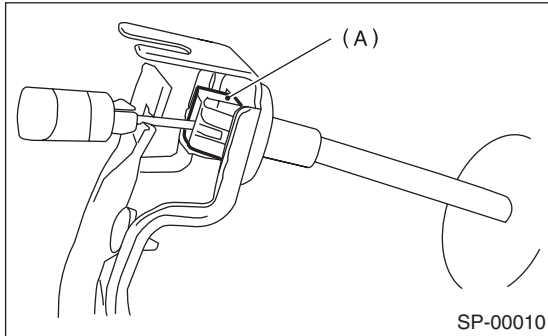

- 12) Separate the accelerator cable and bracket.

B: INSTALLATION

- 1) Install in the reverse order of removal.

NOTE:

- If the cable clamp is damaged, replace it with a new one.
 - Never fail to cover the outer cable end with boot.
 - Be careful not to kink the accelerator cable.
 - For tightening torque, refer to "COMPONENT".
- <Ref. to SP(H4DOTC)-2, COMPONENT, General Description.>

- 2) After the installation, adjust the pedal. <Ref. to SP(H4DOTC)-5, ADJUSTMENT, Accelerator Pedal.>

C: DISASSEMBLY

- 1) Remove the clip, and then remove the accelerator pedal lever from bracket.
- 2) Pull out the spring pin, and then remove the accelerator pedal from accelerator pedal lever.

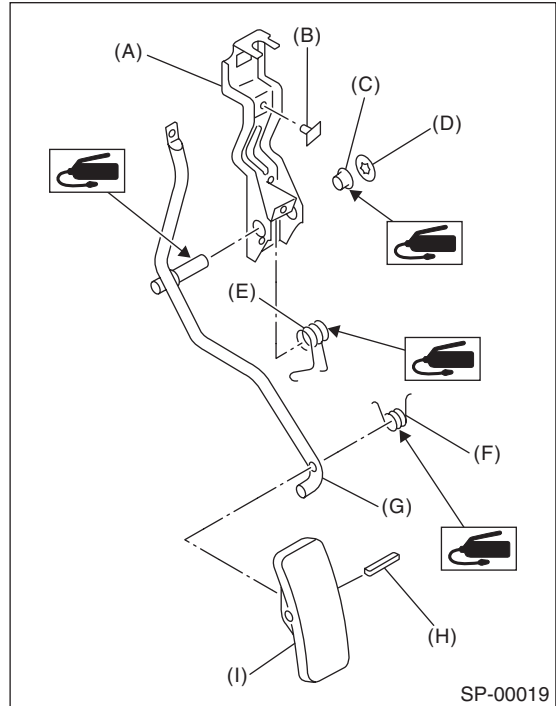

- (A) Accelerator bracket
- (B) Stopper
- (C) Bushing
- (D) Clip
- (E) Accelerator spring
- (F) Accelerator pedal spring
- (G) Accelerator pedal lever
- (H) Spring pin
- (I) Accelerator pedal

D: ASSEMBLY

Assemble in the reverse order of disassembly.

NOTE:

Clean and apply grease to the portions indicated in the figure.

Grease:

SUNLIGHT No. 2 (Part No. 003602010)

E: INSPECTION

1. ACCELERATOR PEDAL

- 1) Lightly move the pedal pad in lateral direction to ensure that pedal deflection is in specified range.
- 2) If excessive deflection is noted, replace the bushing and clip with new ones.

Deflection of accelerator pedal:

Service limit

2.0 mm (0.079 in) or less

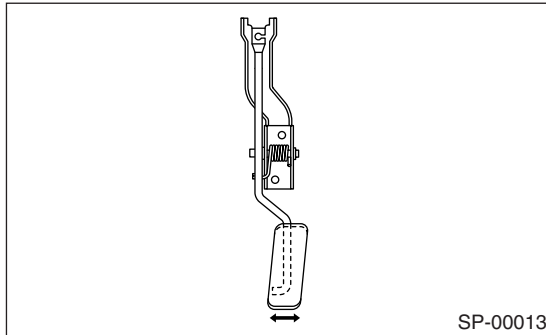

F: ADJUSTMENT

- 1) Check the pedal stroke and free play by operating the accelerator pedal by hand.
- 2) If it is not within specified value, adjust it by turning the nut connecting the accelerator cable to throttle body.

Free play at pedal pad L:

0 — 4 mm (0 — 0.16 in)

Stroke at pedal pad A:

52 — 57 mm (2.05 — 2.24 in)

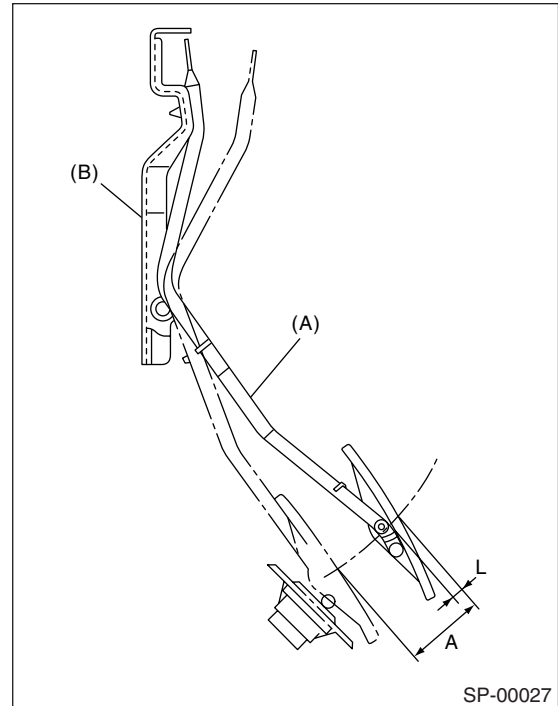

(A) Accelerator pedal

(B) Accelerator pedal bracket

Accelerator cable lock nut tightening torque:

12 N·m (1.2 kgf-m, 9 ft-lb)

3. Accelerator Control Cable

A: REMOVAL

- 1) Remove the accelerator pedal.
<Ref. to SP(H4DOTC)-3, REMOVAL, Accelerator Pedal.>
- 2) Separate the accelerator cable and accelerator pedal.

B: INSTALLATION

- 1) Install in the reverse order of removal.

NOTE:

- If the cable clamp is damaged, replace it with a new one.
 - Never fail to cover the outer cable end with boot.
 - Be careful not to kink the accelerator cable.
 - Do not apply grease to except specified part.
- 2) Apply grease to engine side accelerator cable end.

Grease:

Silicolube G-30M (Part No. 004404002)

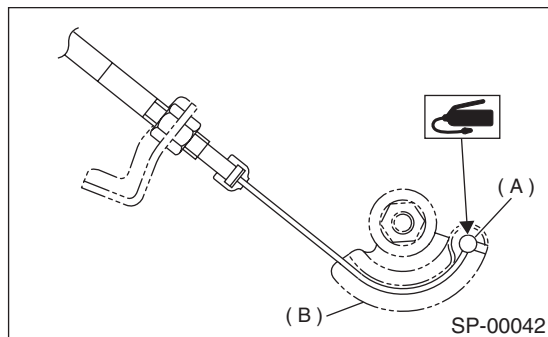

- (A) Accelerator cable end
(B) Throttle cam

- 3) After installation, adjust the pedal. <Ref. to SP(H4DOTC)-5, ADJUSTMENT, Accelerator Pedal.>

C: INSPECTION

- 1) Make sure the inner cable is not twisted or worn.
- 2) Make sure the outer cable is not cracked.