

### 6. Switches and Harness

#### A: REMOVAL

##### 1. BACK-UP LIGHT AND NEUTRAL POSITION SWITCH

- 1) Disconnect the connector battery ground terminal.
  - 2) Remove the air intake duct and cleaner case. (Non-turbo model) <Ref. to IN(H4SO)-6, REMOVAL, Air Cleaner Case.> and <Ref. to IN(H4SO)-7, REMOVAL, Air Intake Duct.>
  - 3) Remove the intercooler (Turbo model). <Ref. to IN(H4DOTC)-11, REMOVAL, Intercooler.>
  - 4) Disconnect the connector back-up light switch and neutral position switch.
- Non-turbo model

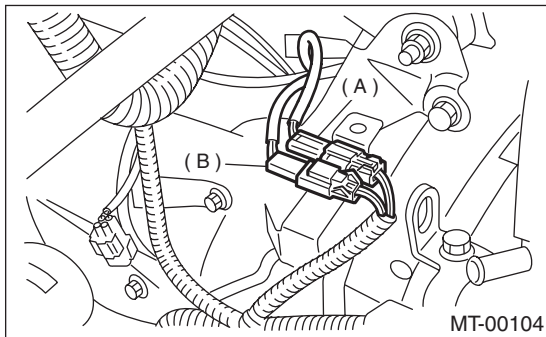

- (A) Neutral switch (Brown)  
(B) Back-up light switch (Gray)

- Turbo model

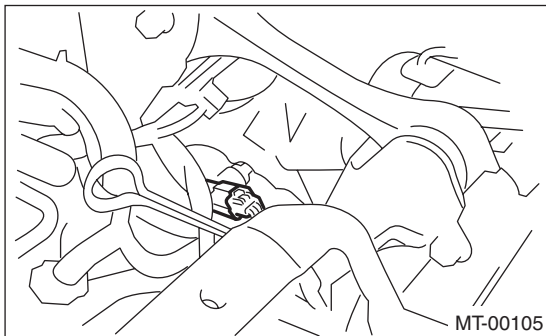

- 5) Lift-up the vehicle.

- 6) Remove the back-up light switch and neutral position switch with harness.

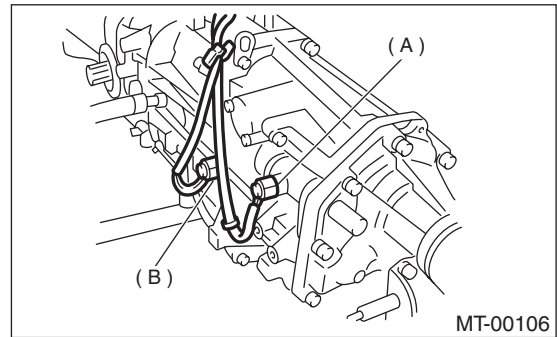

- (A) Neutral switch (Brown connector)  
(B) Back-up light switch (Gray connector)

# SWITCHES AND HARNESS

## MANUAL TRANSMISSION AND DIFFERENTIAL

### B: INSTALLATION

#### 1. BACK-UP LIGHT SWITCH AND NEUTRAL POSITION SWITCH

1) Install the back-up light switch and neutral position switch with harness.

**Tightening torque:**

**24.5 N·m (2.5 kgf-m, 18.1 ft-lb)**

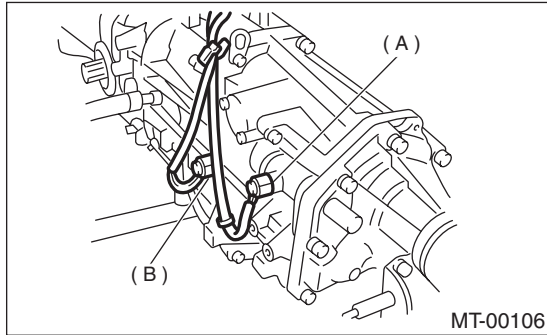

(A) Neutral switch

(B) Back-up light switch

2) Connect the connector of back-up light switch and neutral position switch.

3) Install the air intake duct and cleaner case. (Non-turbo model) <Ref. to IN(H4SO)-6, INSTALLATION, Air Cleaner Case.> and <Ref. to IN(H4SO)-7, INSTALLATION, Air Intake Duct.>

4) Install the intercooler. (Turbo model) <Ref. to IN(H4DOTC)-12, INSTALLATION, Intercooler.>

5) Connect the battery ground terminal.

### C: INSPECTION

#### 1. BACK-UP LIGHT SWITCH

Inspect the back-up light switch. <Ref. to LI-6, INSPECTION, Back-up Light System.>

#### 2. NEUTRAL POSITION SWITCH

1) Turn the ignition switch to OFF.

2) Disconnect the connector neutral position switch.

3) Measure the resistance between neutral position switch terminal.

Non-turbo model

Gear shift position	Terminal No.	Specified resistance
Neutral position	1 and 2	More than 1MΩ
Other positions		Less than 1Ω

Turbo model

Gear shift position	Terminal No.	Specified resistance
Neutral position	1 and 3	More than 1MΩ
Other positions		Less than 1Ω

• Non-turbo model

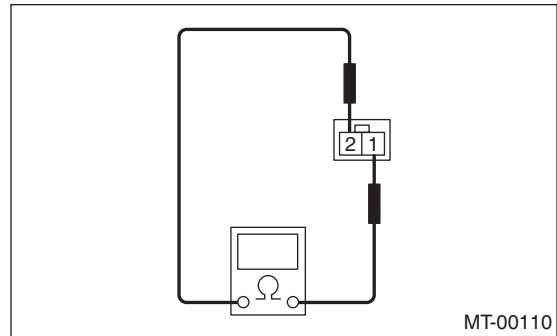

• Turbo model

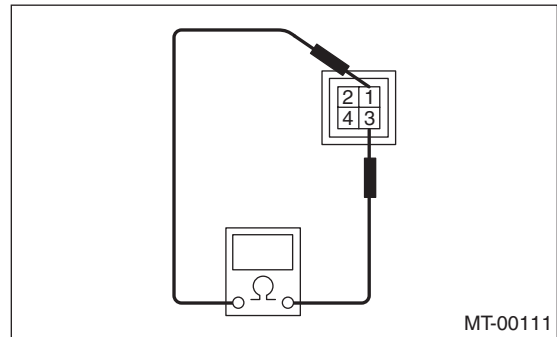

4) Replace defective parts.