

18. Transfer Duty Solenoid and Valve Body

A: REMOVAL

- 1) Set the vehicle on a lift.
- 2) Disconnect the ground cable from battery.
- 3) Remove the air cleaner case. (Non-turbo model)
<Ref. to IN(H4SO)-6, REMOVAL, Air Cleaner Case.>
- 4) Remove the intercooler. (Turbo model)
<Ref. to IN(H4DOTC)-11, REMOVAL, Intercooler.>
- 5) Remove the pitching stopper. <Ref. to AT-45, PITCHING STOPPER, REMOVAL, Transmission Mounting System.>
- 6) Remove the front exhaust pipe with center exhaust pipe. (Non-turbo model)
<Ref. to EX(H4SO)-5, REMOVAL, Front Exhaust Pipe.>
- 7) Remove the center exhaust pipe. (Turbo model)
<Ref. to EX(H4DOTC)-8, REMOVAL, Center Exhaust Pipe.>
- 8) Remove the rear exhaust pipe and muffler.
Non-turbo model
<Ref. to EX(H4SO)-9, REMOVAL, Rear Exhaust Pipe.> and <Ref. to EX(H4SO)-10, REMOVAL, Muffler.>
Turbo model
<Ref. to EX(H4DOTC)-13, REMOVAL, Rear Exhaust Pipe.> and <Ref. to EX(H4DOTC)-14, REMOVAL, Muffler.>
- 9) Raise the vehicle and drain the ATF.

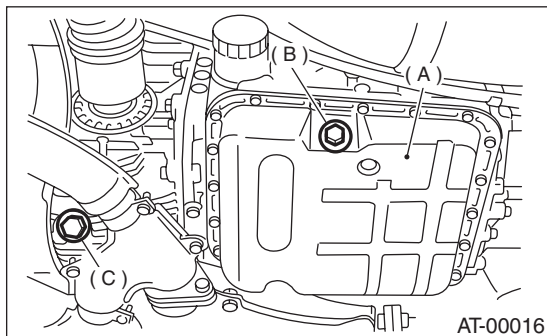

- (A) Oil pan
- (B) Drain plug
- (C) Differential oil drain plug

- 10) Remove the heat shield cover. (if equipped)
- 11) Remove the propeller shaft. <Ref. to DS-14, REMOVAL, Propeller Shaft.>

- 12) Remove the transmission rear crossmember.
 - (1) Support the transmission using a transmission jack and raise slightly.
 - (2) Remove the bolts and nuts as shown in the figure.

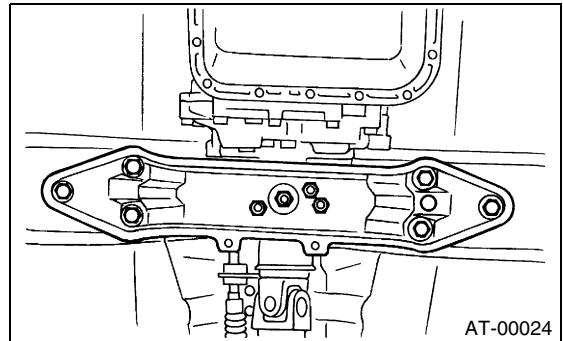

- 13) Remove the rear vehicle speed sensor.

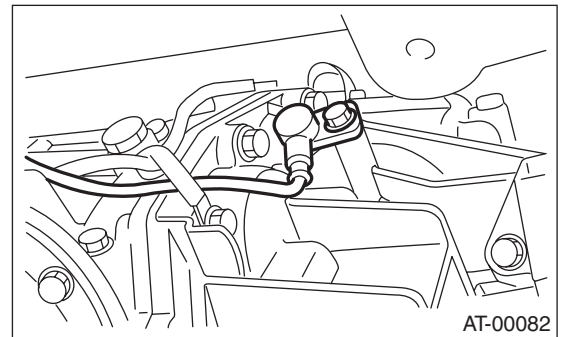

- 14) Remove the select cable nut.

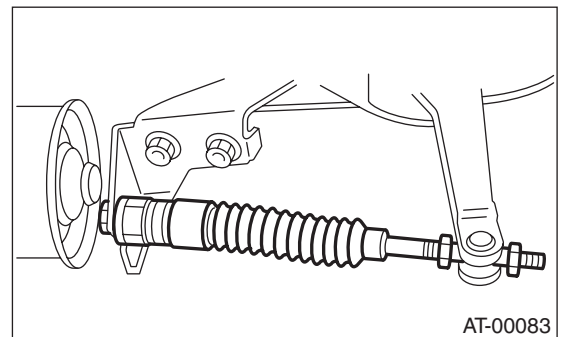

- 15) Move the gear select cable so that extension bolts can be removed.
- 16) Remove the bolts.

TRANSFER DUTY SOLENOID AND VALVE BODY

AUTOMATIC TRANSMISSION

17) Remove the extension case.

NOTE:

Use a container to catch oil flowing from extension.

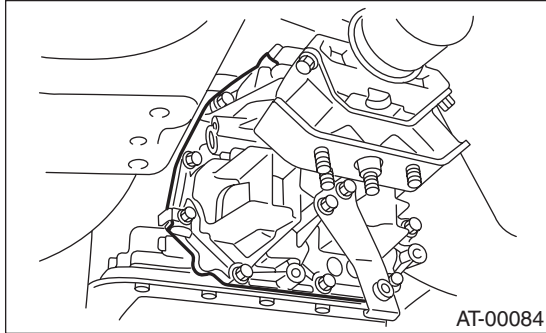

18) Disconnect the transfer duty solenoid connector.

19) Remove the transfer duty solenoid and transfer valve body.

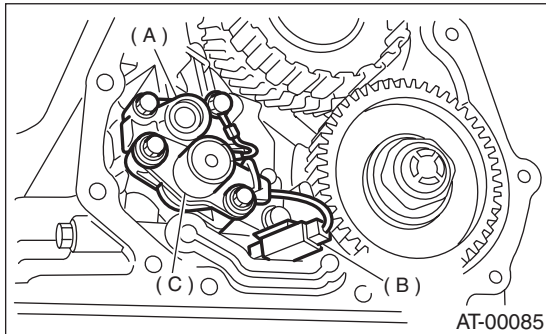

- (A) Transfer valve body
- (B) Transfer duty solenoid connector
- (C) Transfer duty solenoid

B: INSTALLATION

1) Install the transfer duty solenoid and transfer valve body.

(1) Install the transfer duty solenoid and transfer valve body.

Tightening torque:

T: 8 N·m (0.8 kgf-m, 5.8 ft-lb)

(2) Connect the transfer duty solenoid connector.

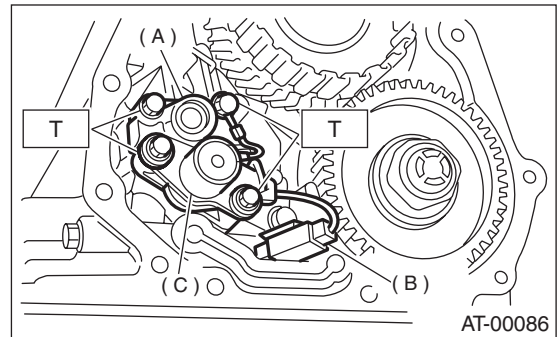

- (A) Transfer valve body
- (B) Transfer duty solenoid connector
- (C) Transfer duty solenoid

2) Install a new gasket and the extension case to transmission case.

(1) Tighten eleven bolts.

Tightening torque:

25 N·m (2.5 kgf-m, 18.1 ft-lb)

(2) Adjust the select cable. <Ref. to CS-30, ADJUSTMENT, Select Cable.>

3) Install the rear vehicle speed sensor.

Tightening torque:

T: 7 N·m (0.7 kgf-m, 5.1 ft-lb)

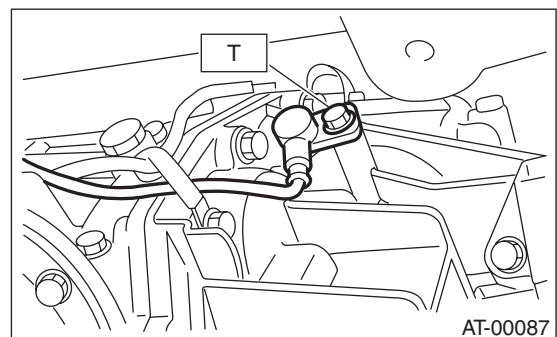

TRANSFER DUTY SOLENOID AND VALVE BODY

AUTOMATIC TRANSMISSION

4) Install the transmission rear crossmember.

(1) Tighten bolts.

13) Check the ATF level. <Ref. to AT-30, ATF.>

Tightening torque:

T1: 35 N·m (3.6 kgf-m, 26 ft-lb)

T2: 70 N·m (7.1 kgf-m, 51 ft-lb)

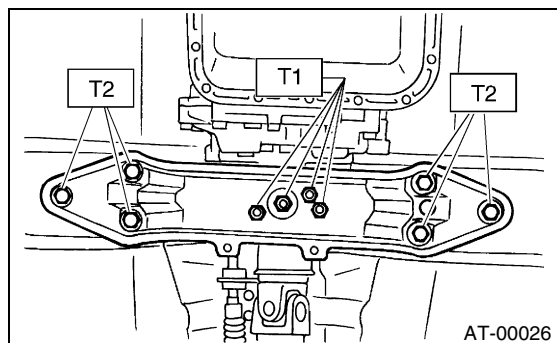

(2) Remove the transmission jack.

5) Install the propeller shaft. <Ref. to DS-15, INSTALLATION, Propeller Shaft.>

6) Install the front, center, rear exhaust pipes and the muffler. (Non-turbo model)

<Ref. to EX(H4SO)-6, INSTALLATION, Front Exhaust Pipe.>A <Ref. to EX(H4SO)-9, INSTALLATION, Rear Exhaust Pipe.> and <Ref. to EX(H4SO)-10, INSTALLATION, Muffler.>

7) Install the center and rear exhaust pipes and the muffler. (Turbo model)

<Ref. to EX(H4DOTC)-9, INSTALLATION, Center Exhaust Pipe.>, <Ref. to EX(H4DOTC)-13, INSTALLATION, Rear Exhaust Pipe.> and <Ref. to EX(H4DOTC)-14, INSTALLATION, Muffler.>

8) Connect the transmission harness connector.

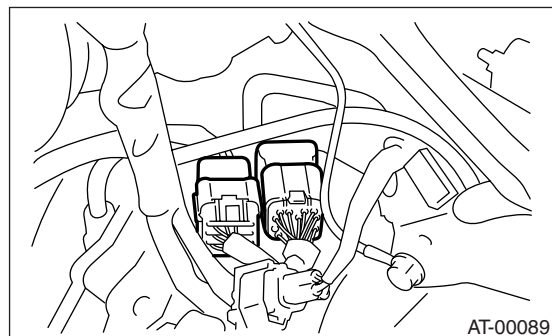

9) Install the pitching stopper. <Ref. to AT-46, PITCHING STOPPER, INSTALLATION, Transmission Mounting System.>

10) Install the air cleaner case. (Non-turbo model)
<Ref. to IN(H4SO)-6, INSTALLATION, Air Cleaner Case.>

11) Install the intercooler. (Turbo model)
<Ref. to IN(H4DOTC)-12, INSTALLATION, Intercooler.>

12) Fill ATF up to the middle of the "COLD" side on level gauge by using the gauge hole. <Ref. to AT-30, ATF.>