

22. Wheel Bearing

A: INSPECTION

1. FRONT WHEEL BEARING

NOTE:

Inspect the condition of front wheel bearing grease.

- 1) Jack up the front of vehicle.
- 2) While holding front wheel by hand, swing it in and out to check bearing free play.
- 3) Loosen the wheel nuts and remove the front wheel.
- 4) If the bearing free play exists in step 2) above, attach a dial gauge to hub COMPL and measure axial displacement in axial direction.

Service limit:

Straight-ahead position within 0.05 mm (0.0020 in)

- 5) Remove stabilizer link from transverse link.
 - 6) Remove transverse link ball joint from housing.
 - 7) While lightly hammering spring pin which secures S.F.J. to transmission spindle, remove it.
 - 8) Extract S.F.J. from the transmission spindle. <Ref. to DS-17, Front Axle.>
 - 9) While supporting front drive shaft horizontally with one hand, turn the hub with the other to check for noise or binding.
- If the hub is noisy or binds, disassemble the front axle and check the oil seals, bearing, etc.

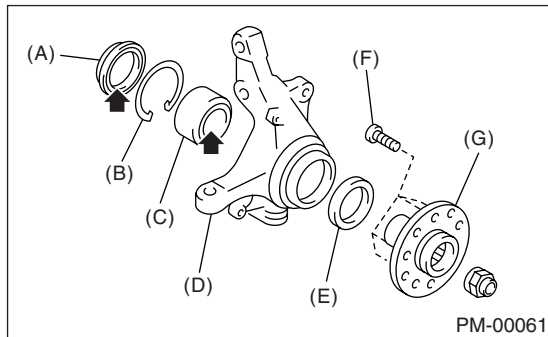

- (A) Inner oil seal
- (B) Snap ring
- (C) Bearing
- (D) Housing
- (E) Outer oil seal
- (F) Hub bolt
- (G) Hub

2. REAR WHEEL BEARING

- 1) Jack up the rear of vehicle.
- 2) While holding rear wheel by hand, swing it in and out to check bearing free play.

- 3) Loosen the wheel nuts and remove the rear wheel.

- 4) If the bearing free play exists in step 2) above, attach a dial gauge to hub COMPL and measure axial displacement in axial direction.

Service limit:

Straight-ahead position within 0.05 mm (0.0020 in)

- 5) Remove the DOJ of rear drive shaft from rear differential. <Ref. to DS-39, Rear Drive Shaft.>

- 6) While supporting rear drive shaft horizontally with one hand, turn the hub COMPL with the other to check for noise or binding.

If the hub COMPL is noisy or binds, disassemble the rear axle and check the oil seals, bearings, etc.

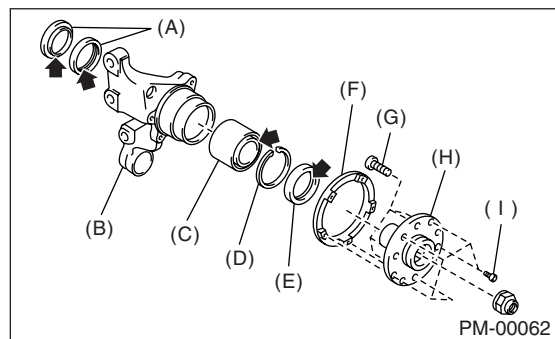

- (A) Inner oil seal
- (B) Rear housing
- (C) Bearing
- (D) Snap ring
- (E) Outer oil seal
- (F) Tone wheel
- (G) Hub bolt
- (H) Hub
- (I) Socket bolt