

2. Air Cleaner

A: REMOVAL

1) Disconnect the ground terminal from battery.

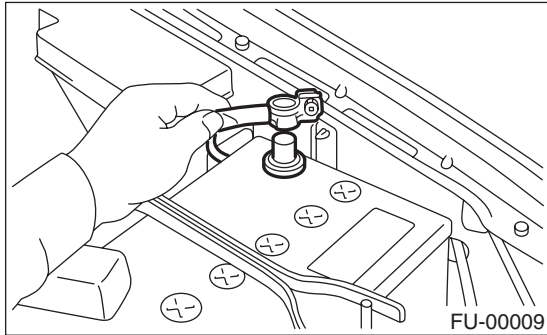

2) Disconnect the connector from mass air flow sensor.

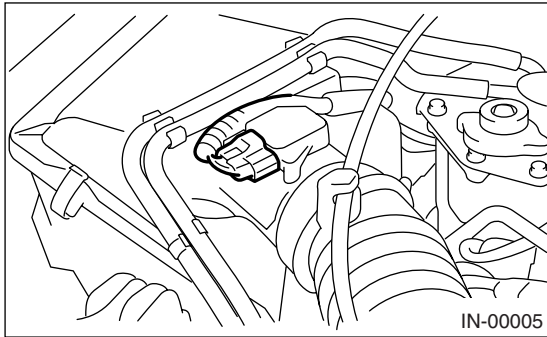

3) Loosen the clamp (A) which connects air intake boot to intake duct.

4) Remove the two clips (B) from air cleaner upper cover.

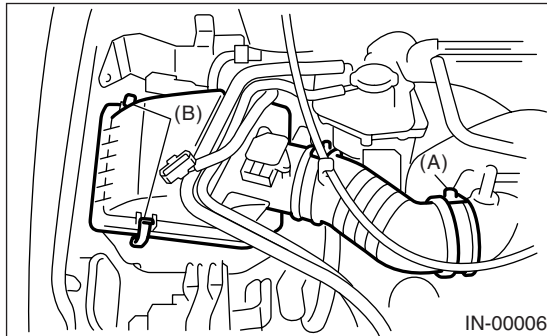

5) Remove the air cleaner upper cover.

6) Remove the air cleaner element.

7) Remove the air cleaner lower case.

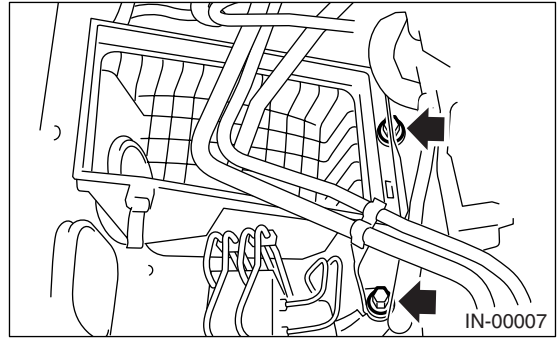

B: INSTALLATION

Install in the reverse order of removal.

Tightening torque:

33 N·m (3.4 kgf-m, 25 ft-lb)

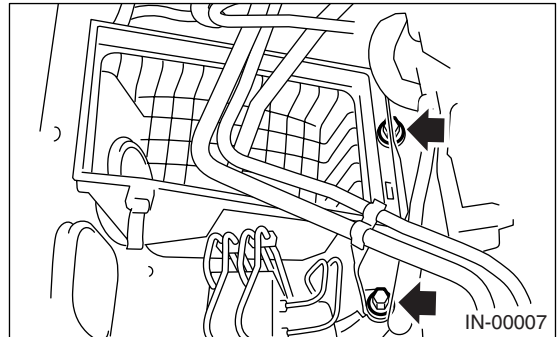

Tightening torque:

2.5 N·m (0.25 kgf-m, 1.8 ft-lb)

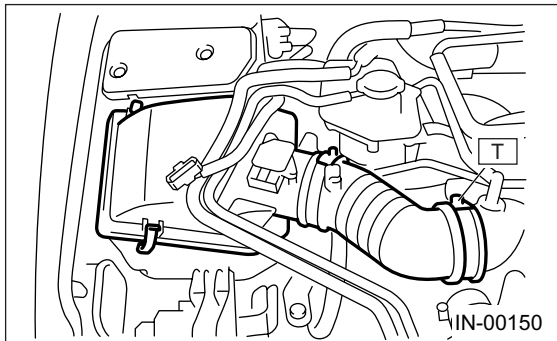

CAUTION:

Before installing the air cleaner upper cover, align holes with protruding portions of air cleaner lower case, then secure the upper cover to lower case.

AIR CLEANER

INTAKE (INDUCTION)

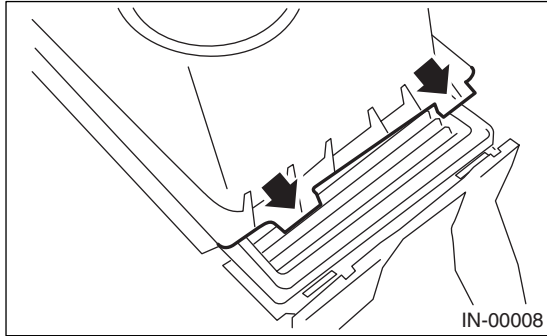

C: INSPECTION

Replace if excessively damaged or dirty.