

MASS AIR FLOW AND INTAKE AIR TEMPERATURE SENSOR

FUEL INJECTION (FUEL SYSTEMS)

9. Mass Air Flow and Intake Air Temperature Sensor

A: REMOVAL

- 1) Disconnect the battery ground cable.

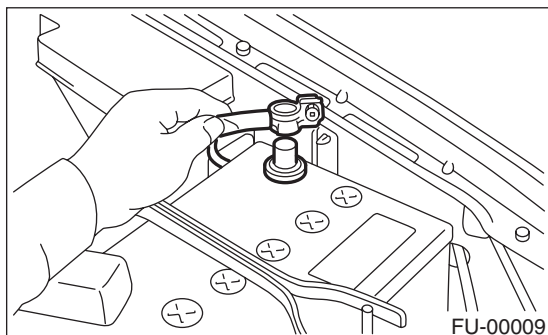

- 2) Disconnect the connector mass air flow and intake air temperature sensor.
- 3) Remove the mass air flow and intake air temperature sensor.

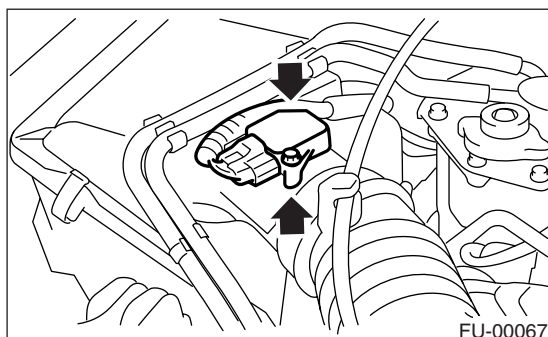

B: INSTALLATION

Install in the reverse order of removal.

Tightening torque:

7.5 N·m (0.76 kgf-m, 5.5 ft-lb)